

JEFFERSON COUNTY PVA

1914 MEADOWCREEK DR

Mailing Address	9208 TIVERTON WAY, LOUISVILLE, KY 40242-3343
Owner	ZOLLER JOHN F JR ESTATE OF
Parcel ID	087G00320000
Land Value	\$30,900
Improvements Value	\$238,580
Assessed Value	\$269,480
Approximate Acreage	0.3175
Property Class	510 RES 1 FAMILY DWELLING
Deed Book/Page	839 748 (N/A Online)
District Number	100023
Old District	13
Fire District	CITY OF LOUISVILLE
School District	Jefferson County
Neighborhood	602107 / MEADOW CREEK
Home Rule City	Urban Service District
Sheriff's Tax Info	View Tax Information
County Clerk	Delinquent Taxes 



087G00320000 11/22/2023

Area Type	Gross Area	Finished Area
Main Unit	-	1,748
Basement	1,624	0
Attic	NONE	0
Attached Garage	240	n/a
Detached Garage	-	n/a

All measurements in square feet.

Property Details

Type	1 : SINGLE FAMILY
Year Built	1961
Exterior Wall	BV BRICK VENEER
Roof	GABLE
Basement Foundation	FULL BSMT, FULL CRAWL
Condition	NORMAL FOR AGE
Heating Type	1 CENTRAL WARM AIR
Central Air	Yes
Fireplace	Yes
Construction Frame	Wood frame
Stories	1.00
Full Bathrooms	1
Half Bathrooms	1

Property Sketch

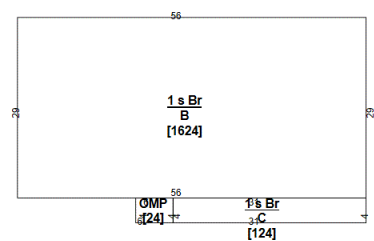

Map Tips

Use the **"Labels"** dropdown menu to display additional map text: house number, dimensions, and more.

Use the **"Layers"** dropdown menu to display recent sales.

Click the  icon below to view the map in LOJIC to view floodplain, zoning, and additional detailed info.

Sales History

Deed Book/Page	Price	Date	Previous Owner
839 748 (N/A Online)	\$0	02/13/2025	ZOLLER JOHN F JR
3445 0429 (N/A Online)	\$0	01/01/1957	OWNER UNKNOWN

Assessment History

Record Year	Land	Improvements	Total	Reason
2025	\$30,900	\$238,580	\$269,480	CR - Computer Reassessment
2022	\$31,930	\$170,980	\$202,910	CR - Computer Reassessment
2017	\$31,000	\$122,980	\$153,980	RC - Residential computer reass
2009	\$25,000	\$121,850	\$146,850	NC - Residential no change
2006	\$25,000	\$121,850	\$146,850	RC - Residential computer reass

Legal Lines

LN	Legal Description
1	LOT 63 MEADOW CREEK SUB

Property is assessed per KRS 132.20 on January 1st of each year. The current year assessments are updated and posted on the website in mid April. Information deemed reliable but not guaranteed. Data last updated: 06/08/2025.