

JEFFERSON COUNTY PVA

1618 CLARICE WAY

Mailing Address 836 OLD GREENVILLE RD,
BOWLING GREEN, KY 42101-7307

Owner MCCONNELL MILDRED T
ESTATE OF

Parcel ID 090A00310000

Land Value \$18,500

Improvements Value \$81,630

Assessed Value \$100,130

Approximate Acreage 0.1652

Property Class 510 RES 1 FAMILY
DWELLING

Deed Book/Page 834 343 (N/A Online)

District Number 100023

Old District 13

Fire District CITY OF LOUISVILLE

School District JEFFERSON COUNTY

Neighborhood 501102 / CARDINAL COURT

Home Rule City Urban Service District

Sheriff's Tax Info [View Tax Information](#)

County Clerk [Delinquent Taxes](#) ↗



090A00310000 11/9/2023

Area Type	Gross Area	Finished Area
Main Unit	-	1,104
Basement	0	-
Attic	NONE	0
Attached Garage	-	n/a
Detached Garage	352	n/a

All measurements in square feet.

Property Details

Type 1 : SINGLE FAMILY

Year Built 1955

Exterior Wall BV BRICK VENEER

Roof HIP

Basement Foundation

Condition NORMAL FOR AGE

Heating Type 1 CENTRAL WARM AIR

Central Air Yes

Fireplace No

Construction Frame Wood frame

Stories 1.00

Full Bathrooms 1

Half Bathrooms 0

Property Sketch

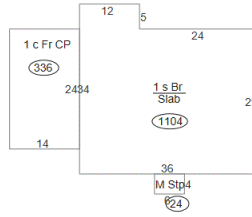

Map Tips

Use the **"Labels"** dropdown menu to display additional map text: house number, dimensions, and more.

Use the **"Layers"** dropdown menu to display recent sales.

Click the  icon below to view the map in LOJIC to view floodplain, zoning, and additional detailed info.

Sales History

Deed Book/Page	Price	Date	Previous Owner
834 343 (N/A Online)	\$0	11/20/2024	MCCONNELL MILDRED T
3335 0025 (N/A Online)	\$0	01/01/1955	OWNER UNKNOWN

Assessment History

Record Year	Land	Improvements	Total	Reason
2021	\$18,500	\$81,630	\$100,130	CR - Computer Reassessment
2017	\$20,000	\$69,230	\$89,230	DC - Decrease by comp-reass
2012	\$25,000	\$65,270	\$90,270	NC - Residential no change
2007	\$25,000	\$65,270	\$90,270	RC - Residential computer reass
2003	\$25,000	\$59,340	\$84,340	RC - Residential computer reass

Legal Lines

LN	Legal Description
1	LOT 67 CLARICE CT SUB

Property is assessed per KRS 132.20 on January 1st of each year. The current year assessments are updated and posted on the website in mid April. Information deemed reliable but not guaranteed. Data last updated: 03/15/2025.