

JEFFERSON COUNTY PVA

5332 WESTHALL AVE

Mailing Address 5332 WESTHALL AVE, LOUISVILLE, KY 40214-3550
Owner CARRITHERS RALPH B & VIRGINIA
Parcel ID 062H00290000
Land Value \$25,000
Improvements Value \$81,150
Assessed Value \$106,150
Approximate Acreage 0.2043
Property Class 510 RES 1 FAMILY DWELLING
Deed Book/Page 5013 0749 (N/A Online)
District Number 100023
Old District 12
Fire District CITY OF LOUISVILLE
School District JEFFERSON COUNTY
Neighborhood 505123 / KENWOOD HEIGHTS ORCHARD HEIGHT
Home Rule City Urban Service District
Sheriff's Tax Info View Tax Information
County Clerk Delinquent Taxes [☞](#)



Area Type	Gross Area	Finished Area
Main Unit	-	1,502
Basement	910	450
Attic	NONE	0
Attached Garage	-	n/a
Detached Garage	-	n/a

All measurements in square feet.

Property Details

Type 1 : SINGLE FAMILY
Year Built 1950
Exterior Wall BV BRICK VENEER
Roof GABLE
Basement Foundation FULL BSMT
Condition POOR FOR AGE
Heating Type 1 CENTRAL WARM AIR
Central Air Yes
Fireplace Yes
Construction Frame Wood frame
Stories 1.50
Full Bathrooms 1
Half Bathrooms 2

[Help](#)

Property Sketch

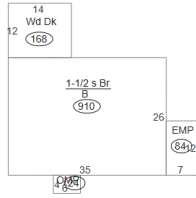

Sales History

Deed Book/Page	Price	Date	Previous Owner
5013 0749 (N/A Online)	\$0	01/01/1978	OWNER UNKNOWN

Assessment History

Record Year	Land	Improvements	Total	Reason
2021	\$25,000	\$81,150	\$106,150	90 - Clerical
2021	\$25,000	\$124,560	\$149,560	CR - Computer Reassessment
2017	\$26,000	\$118,050	\$144,050	RC - Residential computer reass
2009	\$25,000	\$105,270	\$130,270	RC - Residential computer reass
2004	\$26,000	\$96,090	\$122,090	RC - Residential computer reass

Legal Lines

LN	Legal Description
1	60 X 150 W S WESTHALL AVE .21 AC

Property is assessed per KRS 132.20 on January 1st of each year. The current year assessments are updated and posted on the website in mid April. Information deemed reliable but not guaranteed. Data last updated: 11/22/2021.



Built by VIA Studio

Help