

JEFFERSON COUNTY PVA

9807 VALLEY FARMS BLVD

Mailing Address 9807 VALLEY FARMS BLVD,
LOUISVILLE, KY 40272-3271

Owner DECKER EXODUS

Parcel ID 371400260000

Land Value \$25,000

Improvements Value \$163,190

Assessed Value \$188,190

Approximate Acreage 0.2480

Property Class 510 RES 1 FAMILY
DWELLING

Deed Book/Page 722 622 (N/A Online)

District Number 500009

Old District 24

Fire District PLEASURE RIDGE PARK

School District Jefferson County

Neighborhood 508145 / VALLEY FARMS

Home Rule City Jefferson County

Sheriff's Tax Info [View Tax Information](#)

County Clerk [Delinquent Taxes](#) ↗



Area Type	Gross Area	Finished Area
Main Unit	-	1,521
Basement	0	-
Attic	NONE	0
Attached Garage	441	n/a
Detached Garage	-	n/a

All measurements in square feet.

Property Details

Type 1 : SINGLE FAMILY

Year Built 2012

Exterior Wall B2 BRICK

Roof HIP

Basement Foundation

Condition NORMAL FOR AGE

Heating Type 101 FORCED HOT AIR-GAS

Central Air Yes

Fireplace No

Construction Frame Wood frame

Stories 1.00

Full Bathrooms 2

Half Bathrooms 0

[Chat](#)

Property Sketch

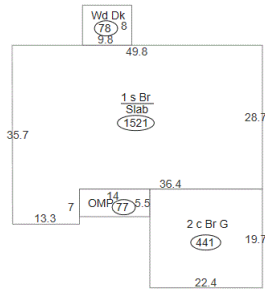

Sales History

Deed Book/Page	Price	Date	Previous Owner
722 622 (N/A Online)	\$0	11/26/2019	DECKER MARY GERALDINE
10229 0607	\$157,630	04/16/2014	GP ENTERPRISES LLC
9913 0278	\$675,000	07/12/2012	KEN THIENEMAN BUILDER INC

Assessment History

Record Year	Land	Improvements	Total	Reason
2021	\$25,000	\$163,190	\$188,190	CR - Computer Reassessment
2017	\$25,000	\$142,850	\$167,850	90 - Clerical
2015	\$32,000	\$125,630	\$157,630	DS - Decrease sale
2014	\$37,000	\$128,300	\$165,300	A - Addition
2013	\$37,000	\$84,080	\$121,080	P - Partial construction

Legal Lines

LN Legal Description

- 1 LOT 26 VALLEY FARMS SUBDIVISION, PH 1, 2 & 3, PB.50 PG.68, 0.2481 AC +/-, OFF BL
- 2 K. 1047 LOT 55

Property is assessed per KRS 132.20 on January 1st of each year. The current year assessments are updated and posted on the website in mid April. Information deemed reliable but not guaranteed. Data last updated: 09/13/2021.



Built by VIA Studio