

JEFFERSON COUNTY PVA

4802 S 4TH ST

Mailing Address 4802 S 4TH ST, LOUISVILLE,
KY 40214-1349

Owner TUNE MARJORIE

Parcel ID 058A00790000

Land Value \$21,000

Improvements Value \$97,550

Assessed Value \$118,550

Approximate Acreage 0.2092

Property Class 510 RES 1 FAMILY
DWELLING

Deed Book/Page 3850 0301 (N/A Online)

District Number 100023

Old District 12

Fire District CITY OF LOUISVILLE

School District Jefferson County

Neighborhood 506123 / WOODLAND

Home Rule City **Urban Service District**

Sheriff's Tax Info **View Tax Information**

County Clerk **Delinquent Taxes** [↗](#)



Area Type	Gross Area	Finished Area
Main Unit	-	1,670
Basement	1,024	0
Attic	NONE	0
Attached Garage	-	n/a
Detached Garage	-	n/a

All measurements in square feet.

Property Details

Type 1 : SINGLE FAMILY

Year Built 1920

Exterior Wall BV BRICK VENEER

Roof GABLE

Basement Foundation FULL BSMT

Condition NORMAL FOR AGE

Heating Type 1 CENTRAL WARM AIR

Central Air Yes

Fireplace Yes

Construction Frame Wood frame

Stories 1.50

Full Bathrooms 1

Half Bathrooms 0

[Help](#)

Property Sketch

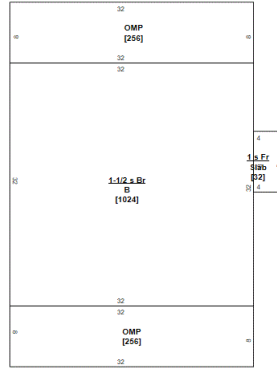

Sales History

Deed Book/Page	Price	Date	Previous Owner
3850 0301 (N/A Online)	\$0	01/01/1963	OWNER UNKNOWN

Assessment History

Record Year	Land	Improvements	Total	Reason
2017	\$21,000	\$97,550	\$118,550	RC - Residential computer reass
2009	\$21,000	\$85,970	\$106,970	RC - Residential computer reass
2005	\$18,500	\$78,590	\$97,090	RC - Residential computer reass
2001	\$18,500	\$66,960	\$85,460	RC - Residential computer reass
1996	\$15,600	\$62,820	\$78,420	RC - Residential computer reass

Legal Lines

LN	Legal Description
1	73 X 125 W S 4TH ST

Property is assessed per KRS 132.20 on January 1st of each year. The current year assessments are updated and posted on the website in mid April. Information deemed reliable but not guaranteed. Data last updated: 02/10/2021.



Built by VIA Studio