

JEFFERSON COUNTY PVA

**2613 CRANSTON DR**

**Mailing Address** 9913 HARLECH LN,  
LOUISVILLE, KY 40299-2866

**Owner** BRODBECK MARTHA

**Parcel ID** 181001690000

**Land Value** \$24,000

**Improvements Value** \$102,240

**Assessed Value** \$126,240

**Approximate Acreage** 0.2157

**Property Class** 510 RES 1 FAMILY  
DWELLING

**Deed Book/Page** 725 947 (N/A Online)

**District Number** 143001

**Old District** 22

**Fire District** JEFFERSONTOWN

**School District** Jefferson County

**Neighborhood** 705102 / CHENOWETH RUN

**Satellite City** Jeffersontown

**Sheriff's Tax Info** [View Tax Information](#)

**County Clerk** [Delinquent Taxes](#) ↗



| Area Type       | Gross Area | Finished Area |
|-----------------|------------|---------------|
| Main Unit       | -          | 925           |
| Basement        | 925        | 0             |
| Attic           | NONE       | 0             |
| Attached Garage | -          | n/a           |
| Detached Garage | -          | n/a           |

All measurements in square feet.

**Property Details**

**Type** 1 : SINGLE FAMILY

**Year Built** 1964

**Exterior Wall** BV BRICK VENEER

**Roof** GABLE

**Basement Foundation** FULL BSMT

**Condition** NORMAL FOR AGE

**Heating Type** 1 CENTRAL WARM AIR

**Central Air** Yes

**Fireplace** No

**Construction Frame** Wood frame

**Stories** 1.00

**Full Bathrooms** 1

**Half Bathrooms** 0

## Property Sketch

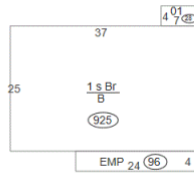

## Sales History

| Deed Book/Page       | Price    | Date       | Previous Owner             |
|----------------------|----------|------------|----------------------------|
| 725 947 (N/A Online) | \$0      | 01/23/2020 | RAY BETTY JOYCE GADDIE     |
| 9128 0750            | \$84,920 | 10/29/2007 | GADDIE MABLE & RAY BETTY J |
| 5884 0778            | \$0      | 08/01/1989 | OWNER UNKNOWN              |

## Assessment History

| Record Year | Land     | Improvements | Total     | Reason                          |
|-------------|----------|--------------|-----------|---------------------------------|
| 2016        | \$24,000 | \$102,240    | \$126,240 | RC - Residential computer reass |
| 2012        | \$18,000 | \$96,840     | \$114,840 | NC - Residential no change      |
| 2008        | \$18,000 | \$96,840     | \$114,840 | RC - Residential computer reass |
| 2005        | \$18,000 | \$66,920     | \$84,920  | RC - Residential computer reass |
| 2001        | \$18,000 | \$63,110     | \$81,110  | RC - Residential computer reass |

## Legal Lines

| LN | Legal Description   |
|----|---------------------|
| 1  | CHENOWETH RUN SEC 4 |

Property is assessed per KRS 132.20 on January 1st of each year. The current year assessments are updated and posted on the website in mid April. Information deemed reliable but not guaranteed. Data last updated: 04/14/2020.

Built by VIA Studio