

"I, Carl F. Beauchamp, certify that on May 13, 1965, I surveyed the property shown on this plat; that the property lines and location of all structures are accurately shown hereon; that no structure located on this property encroaches on any adjacent street or property, and that no structure on adjacent property encroaches on the premises surveyed."

Carl F. Beauchamp

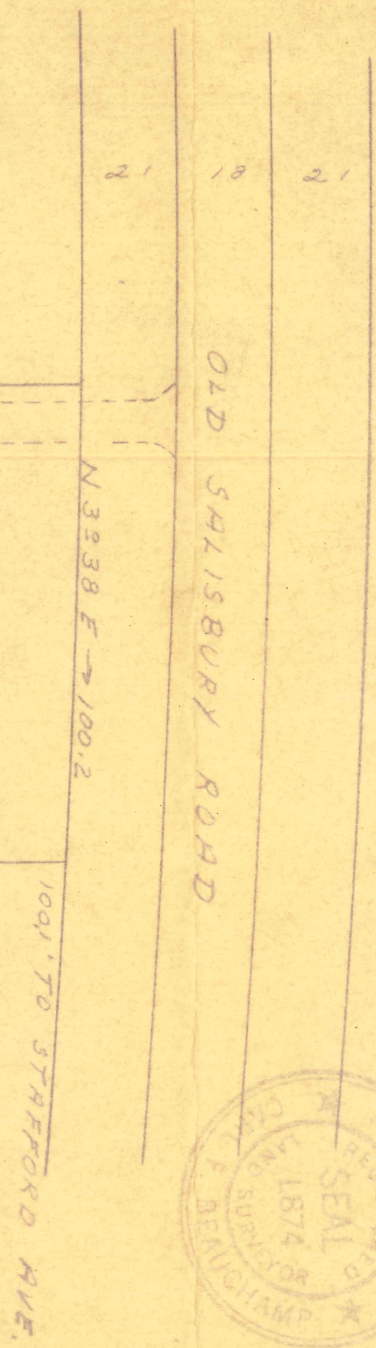

PROPERTY OF

KENNETH R. BIRKLEY (S)

LOT NO. 22 MAP OF STAFFORD ESTATE BLOCK NO. _____

PLAT BOOK 14 PAGE 65 FORSYTH COUNTY, N. C.

SCALE: 1 INCH = 40 FEET

JOB NO. _____