

# Carteret County

## Property Data

Parcel Number: 536803133181000

Inquiry Date: 6/22/2022

DISCLAIMER: For confirmation of the number of buildings on each parcel, please contact the Carteret County Tax Office.

### Property Info

<b>PARCEL NUMBER:</b>	536803133181000
<b>OWNER:</b>	UNITED STATES OF AMERICA
<b>PHYSICAL ADDRESS</b>	140 MORRISTOWN RD STELLA
<b>MAILING ADDRESS:</b>	WASHINGTON DC 20240
<b>LEGAL DESCRIPTION:</b>	L5 STELLA FIELDS P1
<b>DEED REF:</b>	1601-115
<b>PLAT REFERENCE:</b>	29-612
<b>NEIGHBORHOOD:</b>	150006
<b>SALE DATE:</b>	
<b>SALE PRICE:</b>	\$0
<b>ACREAGE:</b>	0.57
<b>LAND VALUE:</b>	\$46,160
<b>BUILDING VALUE:</b>	\$53,712
<b>EXTRA FEATURE VALUE:</b>	\$1,505
<b>PARCEL VALUE:</b>	\$101,377

### Building Info

<b>BATHS:</b>	2
<b>BEDROOMS:</b>	3
<b>CONDITION:</b>	N/A
<b>EXTERIOR WALLS:</b>	26 VINYL N/A
<b>FLOOR FINISH:</b>	14 CARPET 08 VINYL
<b>FOUNDATION:</b>	02 CONC BLOCK
<b>HEAT:</b>	10 HEATPUMP
<b>ROOF COVER:</b>	03 COMP SHNGL N/A
<b>ROOF STRUCTURE:</b>	03 GABLE
<b>TOTAL SQUARE FOOTAGE:</b>	2340
<b>HEATED SQUARE FOOTAGE:</b>	2052
<b>YEAR BUILT:</b>	2001

[Click Here for Advanced Cards](#)

### Sketches

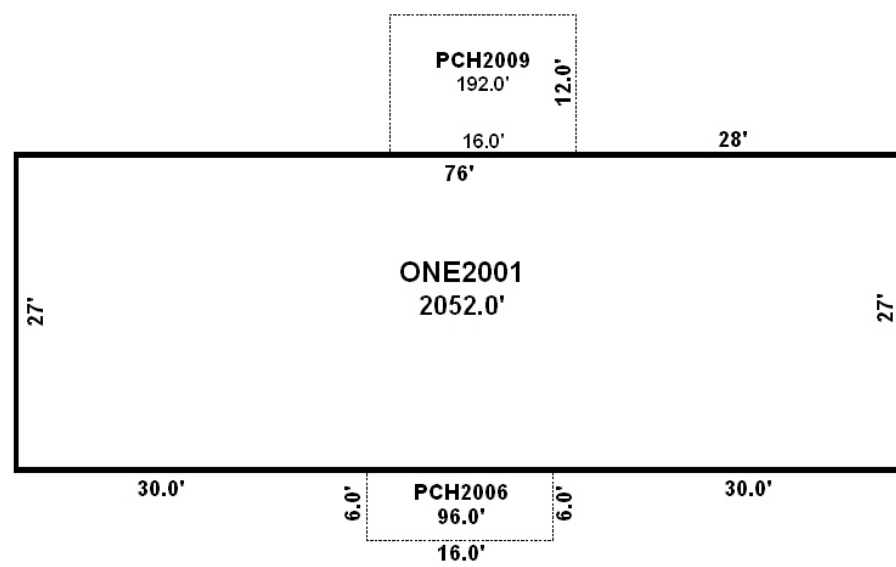

Sketch by Apex IV™

### Photos

