

# Property Information Report

City of Lynchburg Assessor's Office  
 900 Church Street  
 Lynchburg, VA 24504  
 Telephone: (434) 455-3830  
 8:30a.m. - 5:00 p.m. Mon - Fri

**Parcel ID:** 25417048      **Owner:** NEW DAY INVESTMENTS INC  
**Property Address:** 8108 TIMBERLAKE RD 137  
 LYNCHBURG, VA 24502      **Mailing Address:** 1617 LEJACK CIR  
 FOREST, VA 24551-1295

Property Descriptions		Land Information	
<b>Legal Description:</b>	GOLDEN POND, SEC 1, BLDG G, LOT 48	<b>Area:</b>	Legal Acreage: 0.028 GIS Acreage: 0.030
<b>Neighborhood:</b>	366 : GOLDEN POND	<b>Frontage:</b>	16.00ft
<b>Property Class:</b>	103 : RESIDENTIAL - TOWNHOUSE	<b>Depth:</b>	75ft

Special Assessments		School Zones	
<b>Participant in Land Use:</b>	NO	<b>Elementary School:</b>	HERITAGE ELEMENTARY
<b>Land Use Deferral Amount:</b>	--	<b>Middle School:</b>	SANDUSKY MIDDLE
<b>Participant in Rehab Program:</b>	NO	<b>High School:</b>	HERITAGE HIGH
<b>Exempt Amount:</b>	--	<b>Zoning:</b>	<b>Zoning Description:</b>
<b>Participant Until:</b>	--	R-4	Medium-High Density Multi-Family Residential

## Ownership History

Sale Date	Sale Amount	Seller's Name	Buyer's Name	Document No	Deed Bk / Pg	Conveyance
2/8/2010	\$65,000	TIM YOUNG PAINTING LLC	NEW DAY INVESTMENTS INC	100000817		DEED
7/25/2008	\$63,700	BARTELL, THOMAS J & LISA L	TIM YOUNG PAINTING LLC	080006560		DEED
5/1/2006	\$54,000	DALTON, MARK A	BARTELL, THOMAS J & LISA L	060004025		DEED
2/15/2005	\$79,500	HARTLESS, ROBERT E & KAREN L	DALTON, MARK A	050001322		DEED
4/10/2002	\$42,000	COBBS, ANGELA M	HARTLESS, ROBERT E & KAREN L	020003802		DEED
5/15/1995	\$37,000	BROOMELL, MICHAEL K	COBBS, ANGELA M		924 687	DEED
7/2/1990	\$32,000	C H A CONSTRUCTION INC	BROOMELL, MICHAEL K		774 435	DEED
1/1/1976	\$0	CAMPBELL COUNTY ANNEXATION 1976				

## Assessment

Year	Land Value	Improvement value	Total Value	Assessment Date	Notes
2020	\$18,000	\$44,100	\$62,100	7/1/2020	Current Assessment
2019	\$18,000	\$44,100	\$62,100	7/1/2019	Proposed Assessment
2018	\$18,000	\$43,000	\$61,000	7/1/2018	
2017	\$18,000	\$43,000	\$61,000	7/1/2017	
2016	\$18,000	\$43,000	\$61,000	7/1/2016	
2015	\$18,000	\$43,000	\$61,000	7/1/2015	
2014	\$18,000	\$45,800	\$63,800	7/1/2014	
2013	\$18,000	\$45,800	\$63,800	7/1/2013	
2012	\$18,000	\$46,700	\$64,700	7/1/2012	
2011	\$18,000	\$46,700	\$64,700	7/1/2011	
2010	\$18,000	\$45,700	\$63,700	7/1/2010	
2009	\$18,000	\$45,700	\$63,700	7/1/2009	
2008	\$15,000	\$41,100	\$56,100	7/1/2008	
2007	\$15,000	\$41,100	\$56,100	7/1/2007	
2006	\$10,000	\$34,000	\$44,000	7/1/2006	
2005	\$10,000	\$34,000	\$44,000	7/1/2005	
2004	\$7,000	\$35,700	\$42,700	7/1/2004	
2003	\$7,000	\$35,700	\$42,700	7/1/2003	

## Real Estate Property Tax Information

**Total Due:**  
**\$2,426.06**

Current Year	Type	Date Due	Tax Billed	Penalty Billed	Interest Billed	Tax Paid	Penalty Paid	Interest Paid	Date Paid	Balance Due
Installment #:1	Tax	11/16/20	\$172.32	\$17.23	\$3.17	\$0.00	\$0.00	\$0.00		\$192.72
Installment #:2	Tax	01/15/21	\$172.32	\$0.00	\$0.00	\$0.00	\$0.00	\$0.00		\$172.32
Installment #:3	Tax	03/15/21	\$172.32	\$0.00	\$0.00	\$0.00	\$0.00	\$0.00		\$172.32
Installment #:4	Tax	05/17/21	\$172.35	\$0.00	\$0.00	\$0.00	\$0.00	\$0.00		\$172.35

History	Type	Tax Billed	Penalty Billed	Interest Billed	Tax Paid	Penalty Paid	Interest Paid	Date Paid	Balance Due
2019	Tax	\$689.31	\$68.92	\$72.45	\$0.00	\$0.00	\$0.00		\$830.68
2018	Tax	\$677.10	\$67.72	\$156.76	\$0.00	\$0.00	\$0.00		\$901.58
2017	Tax	\$677.10	\$67.72	\$31.66	\$677.10	\$67.72	\$31.66	7/9/2018	\$0.00
2016	Tax	\$677.10	\$50.79	\$14.12	\$677.10	\$50.79	\$14.12	4/17/2017	\$0.00
2015	Tax	\$677.10	\$67.72	\$91.86	\$677.10	\$67.72	\$91.86	4/17/2017	\$0.00
2014	Tax	\$708.18	\$53.11	\$84.01	\$708.18	\$53.11	\$84.01	4/17/2017	\$0.00
2013	Tax	\$708.18	\$35.41	\$13.20	\$708.18	\$35.41	\$13.20	11/18/2014	\$0.00
2012	Tax	\$718.17	\$17.96	\$0.00	\$718.17	\$17.96	\$0.00	5/20/2013	\$0.00
2011	Tax	\$679.35	\$0.00	\$0.00	\$679.35	\$0.00	\$0.00	5/11/2012	\$0.00
2010	Tax	\$668.85	\$16.72	\$0.28	\$668.85	\$16.72	\$0.28	5/17/2011	\$0.00
2009	Tax	\$668.85	\$0.00	\$0.00	\$668.85	\$0.00	\$0.00	9/28/2009	\$0.00
2008	Tax	\$589.05	\$0.00	\$0.00	\$589.05	\$0.00	\$0.00	10/20/2008	\$0.00
2007	Tax	\$589.05	\$14.73	\$2.70	\$589.05	\$14.73	\$2.70	7/2/2008	\$0.00
2006	Tax	\$488.40	\$0.00	\$0.00	\$488.40	\$0.00	\$0.00	5/9/2007	\$0.00
2005	Tax	\$488.40	\$0.00	\$0.00	\$488.40	\$0.00	\$0.00	5/4/2006	\$0.00
2004	Tax	\$473.97	\$0.00	\$0.00	\$473.97	\$0.00	\$0.00	5/18/2005	\$0.00
2003	Tax	\$473.97	\$0.00	\$0.00	\$473.97	\$0.00	\$0.00	5/14/2004	\$0.00
2002	Tax	\$471.75	\$0.00	\$0.00	\$471.75	\$0.00	\$0.00	5/20/2003	\$0.00
2001	Tax	\$471.75	\$11.79	\$2.18	\$471.75	\$11.79	\$2.18	5/20/2003	\$0.00
2000	Tax	\$460.65	\$0.00	\$0.00	\$460.65	\$0.00	\$0.00	5/8/2001	\$0.00

DISCLAIMER: This data is provided without warranty of any kind, either expressed or implied, including but not limited to, the implied warranties of merchantability and fitness for a particular purpose. Any person, firm or corporation which uses this map or any of the enclosed information assumes all risk for the inaccuracy thereof, as the city of Lynchburg expressly disclaims any liability for loss or damage arising from the use of said information by any third party.

**Recent Sales Information by Neighborhood**  
**RESIDENTIAL - TOWNHOUSE Property Class**

Parcel ID	Property Address	Recorded Sale Date	Sale Amount	Seller's Name	Buyer's Name	Document Num
25417005	8108 TIMBERLAKE RD 108	9/15/2020	\$0	CHILDRESS, WILTON B	CHILDRESS, WILTON B ESTATE	200000253
25417040	8108 TIMBERLAKE RD 153	11/8/2019	\$60,000	FORMULA PROPERTIES LLC	VIRTUS INVESTMENTS LLC	190006977
25417029	8108 TIMBERLAKE RD 156	9/27/2019	\$62,500	MACK, PHILLIP J JR	LUC, LOAN TIEU	190005984
25417058	8108 TIMBERLAKE RD 125	7/9/2019	\$65,500	JRF RENTALS LLC	LAMARTINA, THOMAS P & LORI D	190004029
25417053	8108 TIMBERLAKE RD 115	7/2/2019	\$72,000	SANDVIG, TRAVIS J	VALDEZ, ALEXANDRA	190003893
25417061	8108 TIMBERLAKE RD 111	6/26/2019	\$0	DI MEO, PAOLO & DIGIOVANNI, MICHELE	DIGIOVANNI, MICHELE	190003705
25417002	8108 TIMBERLAKE RD 102	9/17/2018	\$48,000	T & B REAL ESTATE LLC	CASH, MATTHEW A	180005861
25417001	8108 TIMBERLAKE RD 100	2/26/2018	\$0	HOSTETLER, RICHARD E	HOSTETLER, RONALD E	180001086
25417006	8108 TIMBERLAKE RD 110	12/8/2017	\$56,000	TAHIR, MUHAMMAD	PAN, DANIEL H & YUHUI	170007788
25417024	8108 TIMBERLAKE RD 146	9/26/2017	\$68,500	EFFORD, BRENDA G	MIDATLANTIC IRA LLC FBO	170006040
25417049	8108 TIMBERLAKE RD 135	6/27/2017	\$67,500	DALTON, MARK A	LOPER, GEORGE & LISBETH	170003989
25417025	8108 TIMBERLAKE RD 148	5/2/2017	\$945,000	FORMULA PROPERTIES LLC	FPJ INVESTMENTS LLC	170002619
25417055	8108 TIMBERLAKE RD 119	5/2/2017	\$945,000	FORMULA PROPERTIES LLC	FPJ INVESTMENTS LLC	170002619
25417063	8108 TIMBERLAKE RD 107	5/2/2017	\$945,000	FORMULA PROPERTIES LLC	FPJ INVESTMENTS LLC	170002619
25417061	8108 TIMBERLAKE RD 111	10/28/2016	\$65,000	MCKINNEY, JONATHAN S	DI MEO, PAOLO & DIGIOVANNI, MICHELE	160006793
25417037	8108 TIMBERLAKE RD 159	9/26/2016	\$70,000	REVIS, KENNITH M & MARION R	SHELTON, JAMES B & PATRICIA A	160005937
25417001	8108 TIMBERLAKE RD 100	9/19/2016	\$44,000	OCEAN INVESTMENTS INC	HOSTETLER, RICHARD E	160005764
25417001	8108 TIMBERLAKE RD 100	9/1/2016	\$34,500	SOUTHWOOD MANAGEMENT INC	OCEAN INVESTMENTS INC	160005301
25417001	8108 TIMBERLAKE RD 100	8/19/2016	\$28,500	ANDERSON, JEFFREY A	SOUTHWOOD MANAGEMENT INC	160005012
25417060	8108 TIMBERLAKE RD 113	7/21/2016	\$70,400	MURPHY, DANIEL G & SUSAN M	NICHOLS, BRANDON J	160004314
25417021	8108 TIMBERLAKE RD 140	4/22/2016	\$46,000	HARTLESS, LARRY K	PETERS AND PETERS ENTERPRISES INC	160002245
25417053	8108 TIMBERLAKE RD 115	12/15/2015	\$75,000	PLANICZKA, JOSEPH F & REBECCA M	SANDVIG, TRAVIS J	150007458
25417004	8108 TIMBERLAKE RD 106	11/5/2015	\$55,000	MAYER, SAMUEL W & MAYER, AIMEE A	NNJ BUSINESS VENTURES LLC	150006743
25417027	8108 TIMBERLAKE RD 152	11/5/2015	\$55,500	GRAVES, SCOTT M	NNJ BUSINESS VENTURES LLC	150006742
25417010	8108 TIMBERLAKE RD 118	1/21/2015	\$71,000	BRAXTON, SHANTA T	ROGERS, ANDREW A & CATALINA V	150000328
25417006	8108 TIMBERLAKE RD 110	9/5/2014	\$20,500	AHMAD, NAEEM & SAIMA N	TAHIR, MUHAMMAD	140005074
25417007	8108 TIMBERLAKE RD 112	8/29/2014	\$49,000	VASSAR, TIFFANY M	NNJ BUSINESS VENTURES LLC	140004975
25417009	8108 TIMBERLAKE RD 116	7/31/2014	\$63,000	FRANCIS, JAMES	JOHNSON, LAMONT V	140004351
25417012	8108 TIMBERLAKE RD 122	1/15/2014	\$0	CLAY, STEVEN A	STEVEN & JENNIFER CLAY LLC	140000228
25417056	8108 TIMBERLAKE RD 121	12/2/2013	\$56,000	DAVIS, JOSHUA E & BILLIE JO	T & B REAL ESTATE LLC	130008678

DISCLAIMER: This data is provided without warranty of any kind, either expressed or implied, including but not limited to, the implied warranties of merchantability and fitness for a particular purpose. Any person, firm or corporation which uses this map or any of the enclosed information assumes all risk for the inaccuracy thereof, as the city of Lynchburg expressly disclaims any liability for loss or damage arising from the use of said information by any third party.

**Improvement: RESIDENTIAL 2.0 STORY**

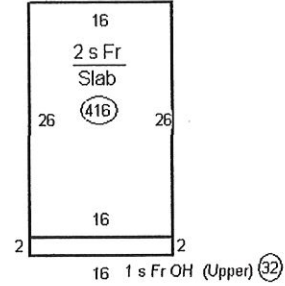

**2.0 STORY**

**Year:** 1984  
**Size:** 864  
**Basement Sq Ft:** 0  
**Fin Basement Sq Ft:** 0  
**Fin Attic Sq Ft:** 0  
**Tot Fin Sq Ft:** 864  
**# Of Rooms:** 4  
**# Of Bedrooms:** 2  
**# Of Full Baths:** 1  
**# Of Half Baths:** 1

**Frame::** Wood frame  
**Exterior Wall:** Vinyl Siding  
**Roof Type:** Gable  
**Roof Material:** Comp sh to 235#  
**Heat Type:** Heat Pump  
**Air Conditioned:** Y  
**Fireplaces:** N

# The City of Lynchburg, VA

## Legend

- Addresses
- Street Labels
- Legal Lot Lines
- ☒ Vacated Right of Way
- ☐ Parcels
- ☐ Owner Undetermined
- ☐ Survey Gap
- ☐ Assessed By County

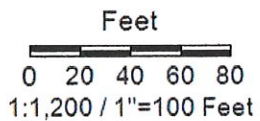
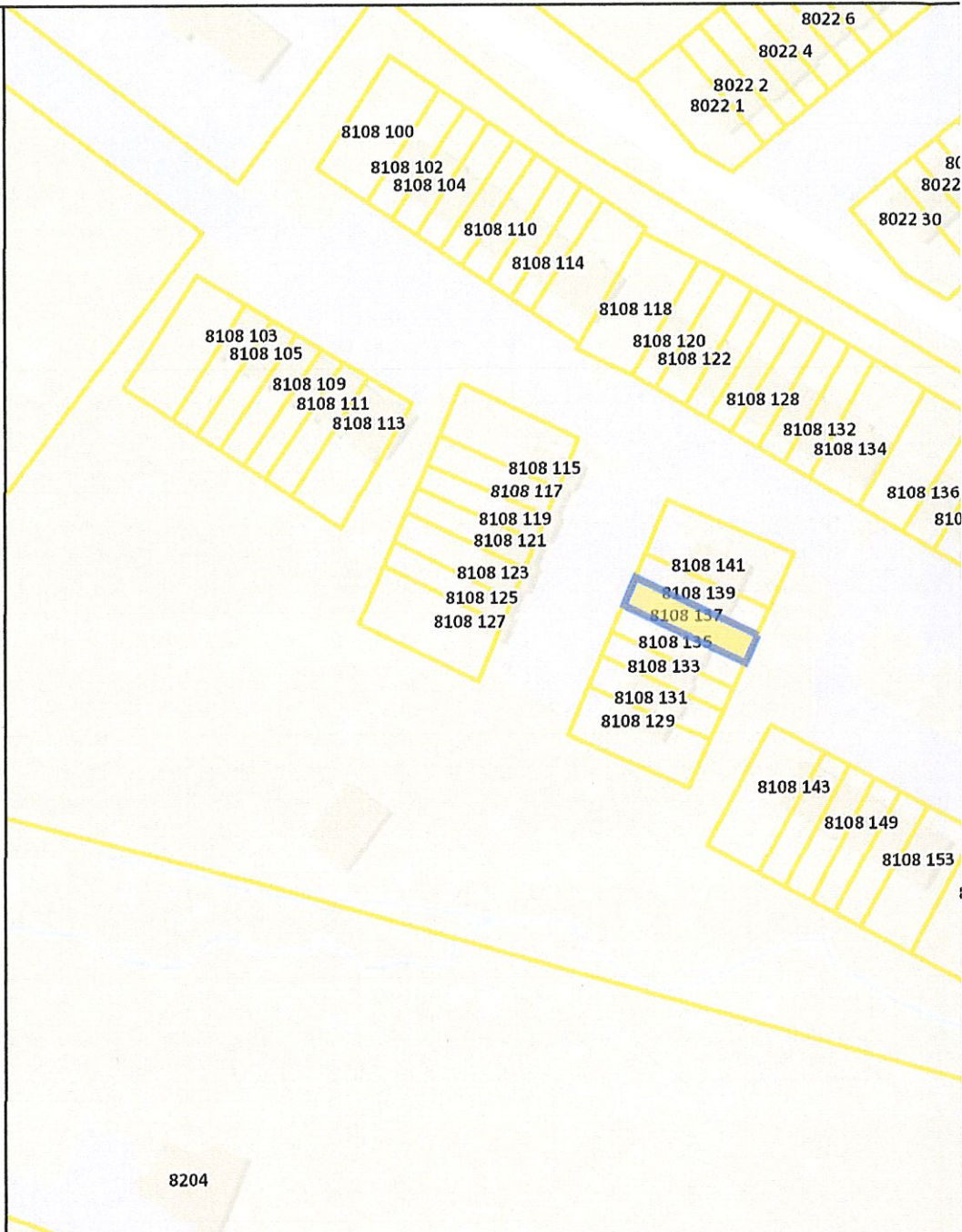

## Parcels

DISCLAIMER: This drawing is neither a legally recorded map nor a survey and is not intended to be used as such. The information displayed is a compilation of sources, and the City of Lynchburg is not responsible for its accuracy or how current it may be.

Search Results Details Map

Map Layers Results

- Apps/ParcelViewer**
- Corporate Limit
- Addresses
- Street Labels
- Street Labels - Planned/Paper
- Property Information**
- Property Labels**
- Property Notes**
- Property Notes
- Parcel ID
- Legal Lot Number
- Legal Subdivision Name
- Legal Block Number
- Parcel Dimension
- Easements**
- Ingress Egress
- Prescriptive
- Private Road
- Stream Restoration
- Main Utility Easement
- Acquisition Easements**
- Other
- Property Boundaries**
- Legal Lot Lines
- Vacated Right Of Way
- Parcels
- Parcel Exceptions**
- Owner Undetermined
- Survey Gap
- Assessed By County
- Agricultural Land Use
- Zoning Information**
- Conditional Use Permits
- Conditional Use Permit Area
- Zoning Variance
- Zoning Labels
- Zoning
- Scenic Corridor
- Fifth St Revitalization
- Airzone Label
- Airzone Radii

Analyze Navigate Share Help



**Parcels**

**Parcel ID:** 25417048  
**Owner:** NEW DAY INVESTMENTS INC  
**Address:** 8108 TIMBERLAKE RD 137  
**Current Value:** \$62,100  
**2019 Value:** \$62,100

[Property Details](#) | [Planning Information](#) | [My City Services](#) | [View In 3D](#)

[Parcel Details](#) | [Dimensions](#) | [What's Nearby?](#)

62.5 ft