

## SURRY COUNTY HEALTH DEPARTMENT IMPROVEMENTS PERMIT

Owner Eddie Shumate Permit No. 011051597-02  
 Location Twin Oak Trk Stanley Mill 7th private Dr. directly  
Access from Beach Rd - Go to end  
 Parcel ID # 3051 Lot Size 15.75 A

Note: This permit DOES NOT authorize the construction or installation of a septic tank system or any wastewater system. An **Authorization for Wastewater System Construction** must be obtained from the Health Department prior to the construction/installation of a system or the issuance of a building permit.

### SEPTIC TANK SYSTEM DESIGN

|  |  |
|--|--|
| Use of Structure <u>House</u>  | Size of Tank <u>1000</u>               |
| No. of Bedrooms: <u>3</u>  | Size of Pump Tank <u>—</u>             |
| Water Supply: Private System <input checked="" type="checkbox"/>                       | LTAR <u>.4</u>                         |
| Public System <input type="checkbox"/>   | Design Wastewater Flow <u>360</u>      |
| No. of Employees <u>—</u> No. of Seats <u>—</u>  | Nitrification Field <u>900</u> Sq. Ft. |
| Basement: yes <input type="checkbox"/> no <input checked="" type="checkbox"/>          | No. of Lines <u>3</u>                  |
| Basement plumbing: yes <input type="checkbox"/> no <input checked="" type="checkbox"/> | Width of Lines <u>3'</u>               |
|  | Length of Lines <u>100'</u>            |
|  | Depth of Stone <u>12"</u>              |

PERMIT SPECIFICATIONS: Follow contours of front - keep well 100' from bank, line for  
repair area. Do not encroach drain field area  
Permit valid for 5 yrs after date issued

An Improvements Permit shall not expire and shall not be affected by changes in ownership. **THIS PERMIT IS SUBJECT TO REVOCATION IF SITE PLANS OR INTENDED USE CHANGE. ALTERATION OF THE SITE OR SOIL CONDITIONS MAY REQUIRE THE REVOCATION OF THIS PERMIT.**

Eddie Shumate 7-21-98  
 Owner/Date

Michelle Hancer RS  
 Env. Health Specialist

| OPERATIONS PERMIT AND<br>FINAL SEPTIC TANK SYSTEM DESIGN |                          |
|--|--------------------------|
| Size of Tank   | <u>1000</u>              |
| Dist. to prop. line                                      | <u>10'</u>               |
| Dist. to well  | <u>100'</u>              |
| Dist. to foundation                                      | <u>7'</u>                |
| Nitrification Field                                      | <u>900</u> Sq. Ft.       |
| No. of Lines   | <u>3</u>                 |
| Width of Lines   | <u>3'</u>                |
| Length of Lines  | <u>100'</u>              |
| Depth of Stone   | <u>12"</u>               |
| Contractor   | <u>Brent Grit</u>        |
| Completion Date  | <u>8-13-98</u>           |
| Env. Health Specialist                                   | <u>Joe Holden L.S.J.</u> |

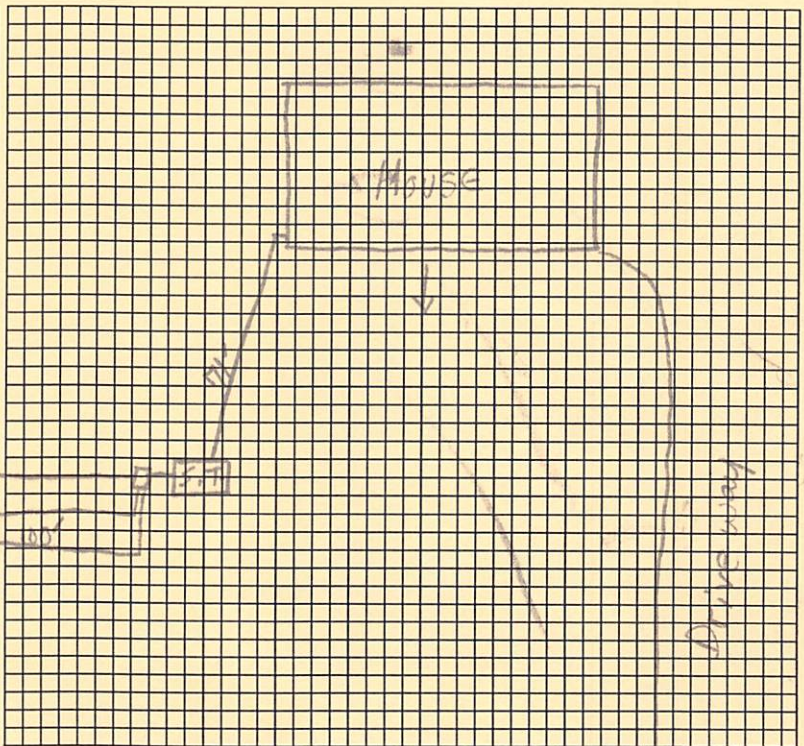

Shumate, Eddie