

SKETCH ADDENDUM

Borrower or Owner			
Property Address 3608 Hollow Springs Road			
City	Bradyville	County	Cannon
State	Tn	Zip Code	37026
Client	Vandy		

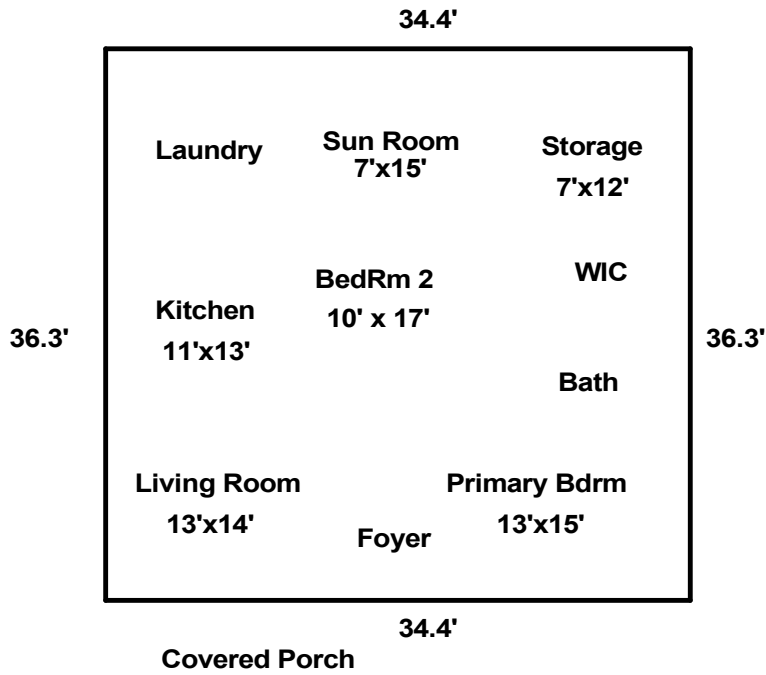

SUMMARY	SQ FT AREA	PERIMETER	AREA CALCULATION DETAILS
Living Area First Floor	1249	141	First Floor $34.4 \times 36.3 = 1248.7$