

Gary Mace Property
 487 & 401 Hollis Creek Road tracts 2 & 4
 tax map 45 parcel 32.00 & 34.00
 Cannon Co., TN



Vicinity Map n.l.s.

High Intensity Soil Map

Notes:

Sketch Map Method By RTK Networking Mode

This map may/maynot be compiled utilizing existing information from surveys. This map is intended for the purposes of septic system permitting and is to be used for no other purpose. The accuracy of the location information of the soil area is not intended to be relevant to the survey information.

Legend:

- WID - with interceptor drain; recommend installing 15' or more away upslope of disposal system
- Edge of evaluation
- - wood stakes for ground control purposes only

Any disturbance to these soils after this date can void their favorability.

Soil site stakes on ground are for ground control purposes only and do not necessarily designate favorability.

The Soil Consultant's signature does not constitute approval by the Environmental Dept.

Date: 10-19-23

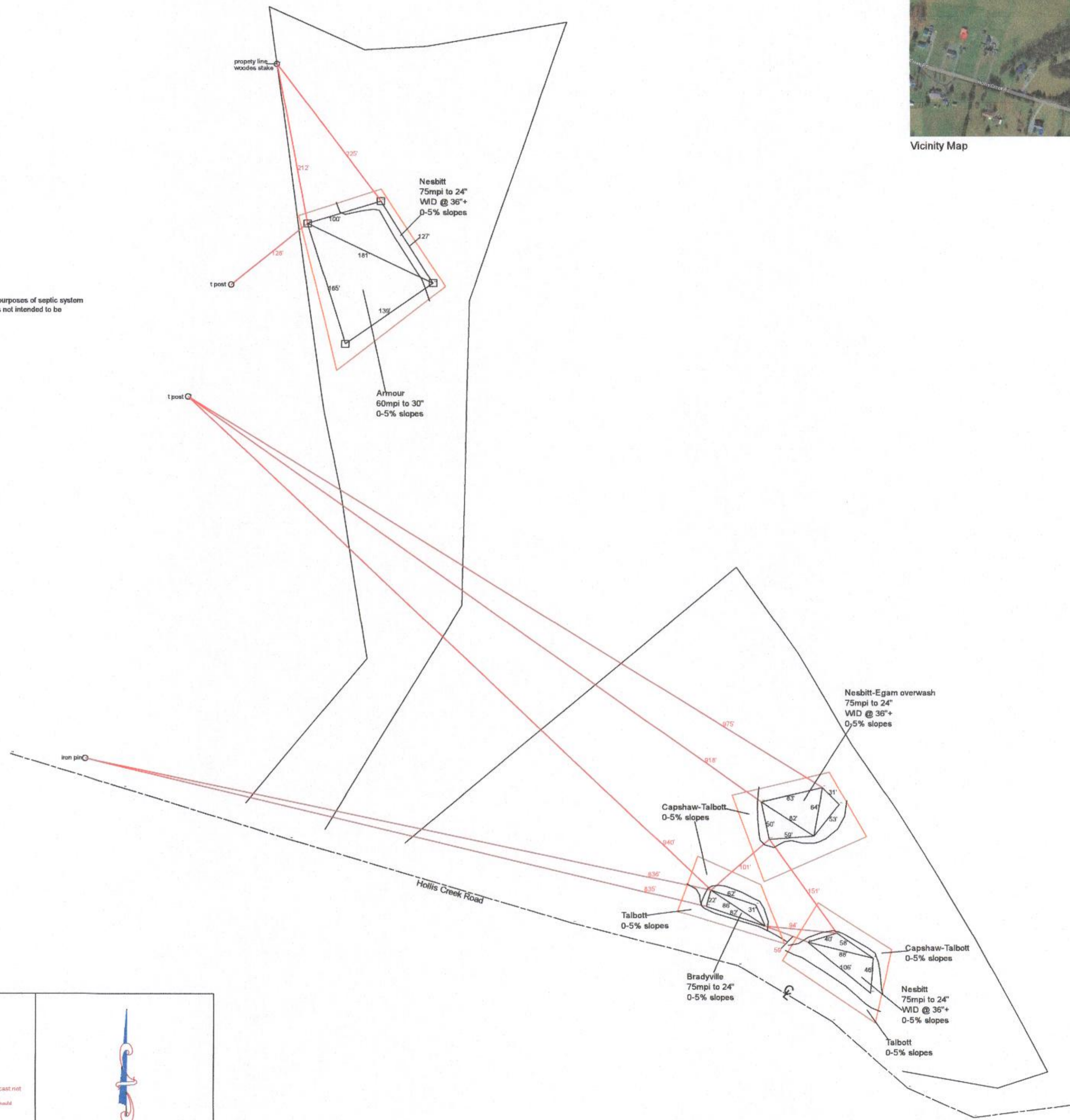

I, Randy S. Dickerson affirm that this soil map meets the standards established in the Regulations to Govern Subsurface Sewage Disposal, the Soils Handbook, and the Soils Taxonomy. No other warranties are made or implied.

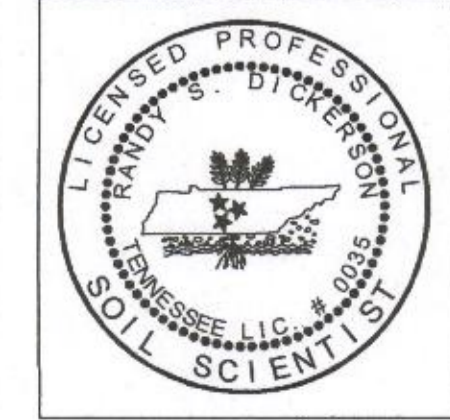

The Soils Group, inc.
 Wastewater Consultants
 2159 C-4 N. Thompson Lane
 Murfreesboro, TN 37129
 615-848-2780 fax 615-848-2782 email: thesoilsgroup@comcast.net
This drawing may have been electronically produced from survey information provided and has been reviewed for the purpose of soil mapping and should not be used for any other purpose.
 JOB NUMBER: 1017 DRAWING BY: RDW

