

TRACT 7

566°24'06"E  
3190.3'

8  
83.87 ACRES

TRACT 12

11  
37.08 ACRES

569°23'30"E  
3037.8'

Come out 75' LEFT = 1°25'  
Shower has run S 63° E or S 62°30' E  
WOULD GO 15' TO RT

19  
93.64 ACRES

562°30'09"E  
2876.2'

10  
73.14 ACRES

JANNY AKE  
169-141

DIVISION OF A PORTION OF THE  
HARRY LEE CARTER PROPERTY

12TH CIVIL DISTRICT  
FRANKLIN COUNTY, TENNESSEE

AND BEING A PORTION OF THE FOURTH TRACT DESCRIBED IN DB 82 P. 418 ROSET

SHEET 4

DALE BRADLEY  
RT 2 Box 2350  
WINCHESTER  
37398

CLASS E SURVEY  
TO PERSONS PRESENTLY INTERESTED.  
I DECLARE THAT THIS IS A TRUE AND ACCURATE  
PLAT OF THE INDICATED PROPERTY TO THE BEST  
OF MY KNOWLEDGE.  
RM Ryan  
10-30-89

W.J. SUMMERS ET AL  
145-439

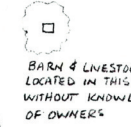
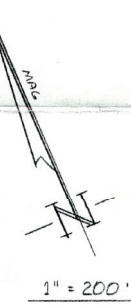

BARN & LIVESTOCK  
LOCATED IN THIS AREA  
WITHOUT KNOWLEDGE  
OF OWNER'S

MOBILE HOME  
LOCATED IN RR ROW

POINT AT MILE MARKER 9

HERSCHEL COFFELT  
98-597

LINE RUNS WITH APPROX. FOOT OF MOUNTAIN

