

NOTE: BEARINGS RELATIVE TO TENNESSEE  
STATE PLANE COORDINATE SYSTEM - NAD83/2011

DATE OF OBSERVATION 03/18/2023

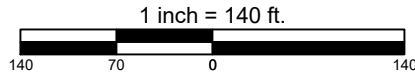

#### Utility Disclaimer

Surveyor has not physically located the underground utilities. Above grade and underground utilities shown were taken from visible appurtenances at the site, public records and/or maps prepared by others. Surveyor makes no guarantee that the underground utilities shown comprise all such utilities in the area, either in service or abandoned. Surveyor further does not warrant that the underground utilities are in the exact location indicated. Therefore, reliance upon the type, size and location of utilities shown should be done so with this circumstance considered. Detailed verification of existence, location and depth should also be made prior to any decision relative thereto is made. Availability and cost of service should be confirmed with the appropriate utility company. In Tennessee, it is a requirement, per "The Underground Utility Damage Prevention Act", that anyone who engages in excavation must notify all known underground utility owner, no less than three (3) nor more than ten (10) working days prior to the date of their intent to excavate and also to avoid any possible hazard or conflict. Tennessee One Call 811.



DocuSigned by:

509F4C57426D4E0...

5/8/2023



#### SURVEYOR'S CERTIFICATE:

I, Christopher Blake Sexton, Registered Land Surveyor, Tennessee RLS #2400, do hereby certify that the survey shown hereon was made by myself or under my direct supervision on 18 March 2023, and the same is true and correct to the best of my knowledge and belief. I further certify this is a Category IV remote sensing survey, and is in compliance with the current Tennessee minimum standards of practice as defined under rule 0820-03-07C (5). The horizontal datum is NAD 1983, which was derived using a GPS network RTK observation taken by a dual frequency Carlson BRX7 with a published positional accuracy of 8mm horizontal and 15mm vertical. The unadjusted ratio of precision of the data shown hereon (in relative positioning accuracy given at the 95% confidence level) is at least 1:10,000.

DocuSigned by:

509F4C57426D4E0...

5/8/2023

Christopher Blake Sexton, RLS  
Tennessee License Number: 2400

Date

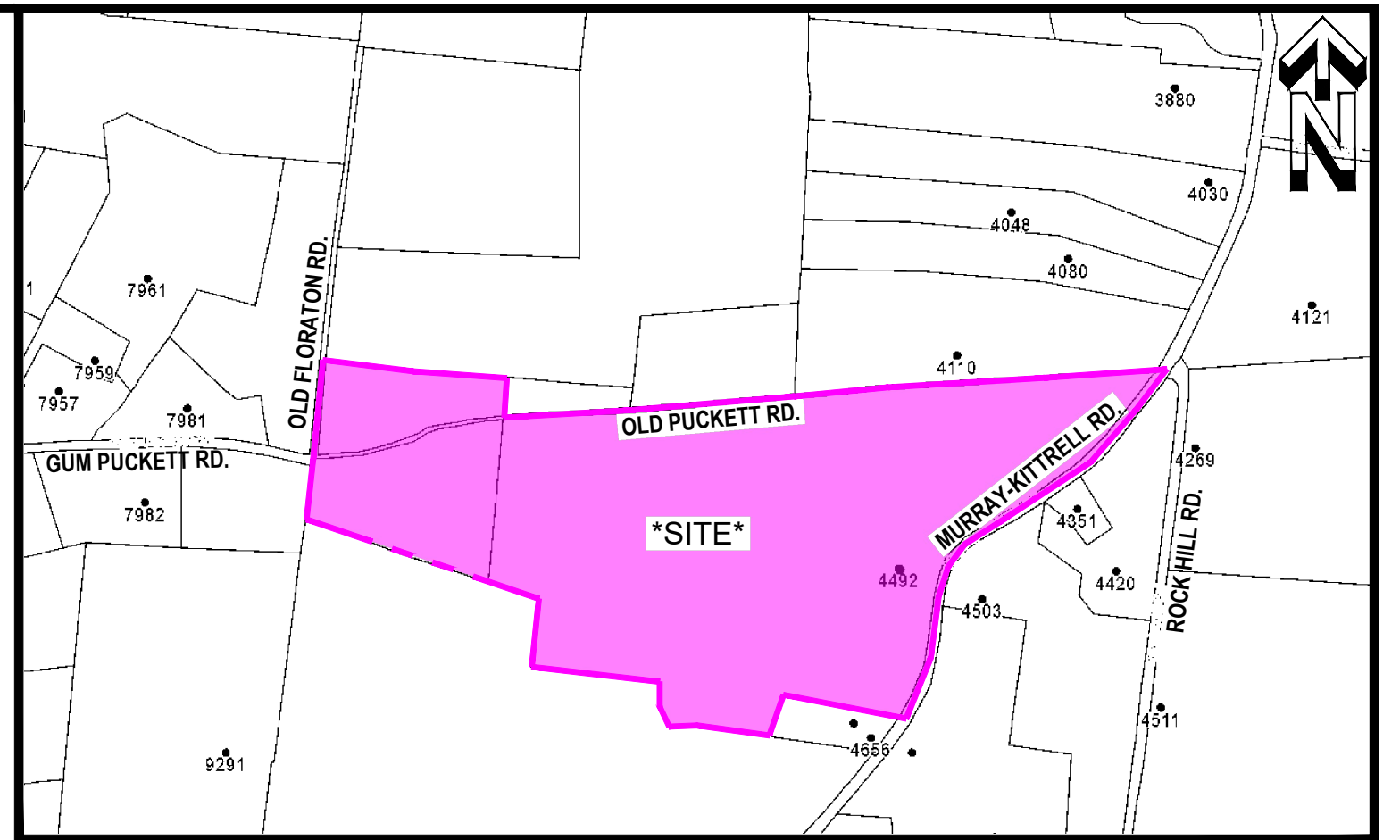

VICINITY MAP  
NOT TO SCALE

