

LEGEND

- 5/8" CAPPED REBAR (NEW) RLS # 2712
- △ MONUMENT NEITHER SET NOR FOUND
- 1/2" CAPPED REBAR (OLD) RLS # 365
- ◆ 1/2" UNCAPPED REBAR (OLD)
- ⊕ 1.5" IRON PIPE (OLD)
- WOOD POST (OLD)
- ▼ STEEL T-POST (OLD)
- ▲ CONTROL POINT
- ⋈ POWER POLE
- ⊙ PLANTED STONE (OLD)
- DOGWOOD
- FENCE
- E — OVERHEAD ELECTRIC
- — — PROPERTY BOUNDARY

LINE	BEARING	DISTANCE
L1	S 73°57'14" E	30.94'
L2	S 87°02'02" E	110.46'
L3	S 88°07'04" E	278.51'
L4	S 83°53'14" E	81.52'
L5	N 03°18'16" E	30.00'
L6	S 02°46'14" E	218.65'
L7	S 86°42'44" E	63.78'
L8	S 03°17'16" W	123.57'
L9	N 86°42'44" W	18.54'
L10	S 87°28'16" E	33.32'
L11	N 03°17'20" E	210.56'

MOORE
LAND SURVEYS
208 N. CHANCERY ST.
MCMINNVILLE, TN
931.473.1088
MICHAEL@
MOORELANDSURVEYS.COM

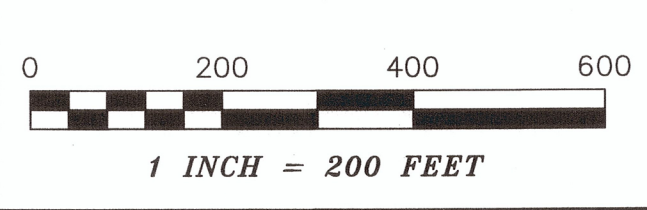

NOTE: This survey was performed with RTK GPS positional data observed on the date of 12-15-22 utilizing a Topcon HiPer HR dual frequency receiver. The grid coordinates of the control point (N:507377.00, E:1959232.98, hub nail with plastic disc) were derived using a VRS network of CORS stations projected to TN SPC83; Datum: NAD 83_NO_TRANS; Geoid: g2017au7. The positional accuracy of the GPS vectors does not exceed H: 5 mm + 0.5 ppm. The combined grid factor used for this survey is 0.999989875 centered upon the control point listed herein.

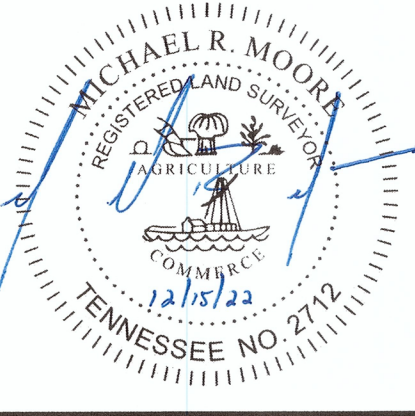

SURVEYOR'S CERTIFICATE
I hereby certify, to the best of my knowledge and belief, that the survey shown hereon represents a Category IV Survey and is in compliance with the current Tennessee Minimum Standards of Practice.
Date: 12/15/22
Registered Land Surveyor

HALE ESTATE		
DRAWN BY	DATE	600 Brown Road
EHJ	12/15/22	Woodbury, TN 37190
DB 67 - PG 323 P/O	Cannon County	
Tax ID: 072 008.00	5th Civil District	
SCALE	ACREAGE	PROJECT NO.
1" = 200'	102.01 AC.±	21076