

NOTES

1. In Tennessee, it is a requirement per "The Underground Utility Damage Prevention Act" that anyone who engages in excavation must notify all known underground utility owners, no less than three nor more than ten working days of their intent to excavate. A list of these utilities may be obtained from the County Register of Deeds. Those utilities that participate in the Tennessee One Call system can be notified by calling toll free 1-800-351-1111.
2. Underground utilities shown were located using available above ground evidence, as well as information obtained from the respective utility companies. The existence or nonexistence of the utilities shown and any other utilities which may be present on this site or adjacent sites should be confirmed with the utility owner prior to commencing any work.
3. It is the responsibility of each residential builder to design and construct a suitable grading and drainage scheme which will convey surface water, without ponding in the lot or under the house, from his structure to the drainage system constructed by the subdivision developer.
4. Parcels may be subject to additional easements, and/or restrictions, by record or prescription, that a complete title search may reveal.

GLOBAL POSITION SYSTEM SURVEY NOTES

1. For boundary and topographic aspects of this survey, RTK positioning system (GPS) survey equipment: TOPCON Hiper V-Model #100137-04 (Dual frequency). The GPS portion of this survey was performed using RTK (Real-Time Kinematic) surveying methods. Topographic features shown were obtained by using the TDOT CORS station TN3A for horizontal and for vertical control.
2. The relative positional accuracy is stated in the Category "IV" survey certification located above the surveyor's seal on this drawing.
3. The dates that fieldwork was performed for this survey was: January - February 2026.
4. The datum(s) for the TDOT CORS Network Station 3A that was used:
HORIZ.: NAD83(2011) EPOCH 2010
VERT.: NAVD 1988
5. Fixed Control Station designation with positional data:
TDOT CORS STATION-TN3A
STATE PLANE (TN 4100-US SURVEY FT.)- NORTHING: 553,312.4528
EASTING: 1,860,677.584
ELEVATION: 650.209 FT.
6. Geoid model used- GEOID03
7. Combined grid factors for TDOT CORS Station TN3A:
0.999921865 (STATE PLANE-TN 4100-US SURVEY FT.)

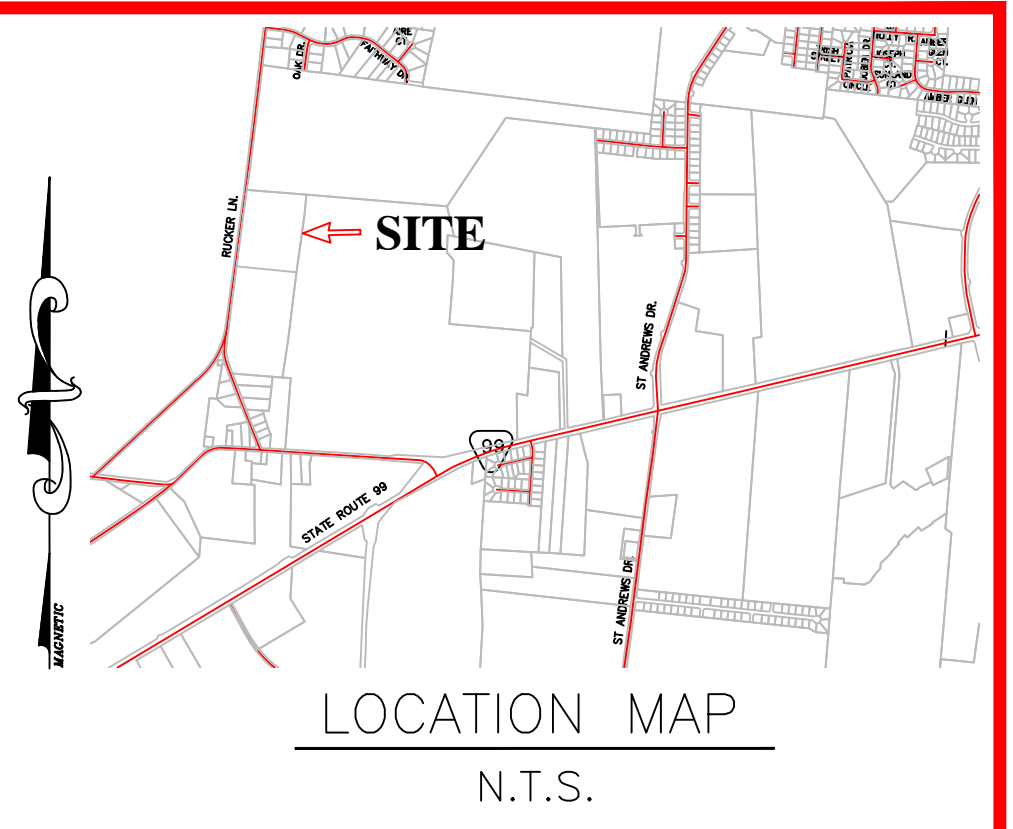

LEGEND

- IPS ○ IRON PIN SET (1/2" REBAR WITH STAMPED PLASTIC CAP-H/S ENGR.)
- IPF ○ IRON PIN FIND
- SURVEY POINT
- EXISTING ELECTRIC POLE
- EXISTING ELECTRIC LINE
- EXISTING FENCE

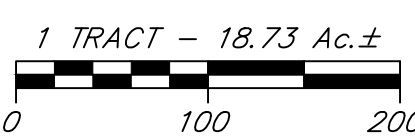
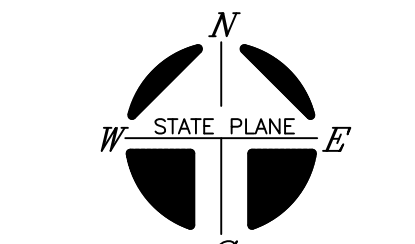

THIS PARCEL IS NOT INCLUDED IN AREAS DESIGNATED AS "SPECIAL FLOOD HAZARD" ON THE NATIONAL FLOOD INSURANCE PROGRAM MAP NUMBER: 420148022551 DATED: MAY 9, 2023 ZONE: X

I HEREBY CERTIFY THAT THIS IS A CATEGORY "IV" SURVEY AND THE PRECISION OF THE GPS PORTION OF THIS SURVEY (IN RELATIVE POSITIONING ACCURACY GIVEN AT THE 95% CONFIDENCE LEVEL) IS 1:10,000 AS SHOWN HEREON AND THAT THIS SURVEY WAS DONE IN COMPLIANCE WITH CURRENT TENNESSEE MINIMUM STANDARDS OF PRACTICE FOR LAND SURVEYORS.

AUCTION SURVEY

OWNER: ROGER E SMITH
ETUX: PATRICIA DAVIS
ADDRESS: 1167 RUCKER LANE
MURFREESBORO, TN 37128
TAX MAP: 115, PARCEL: 18.00
RECORD BOOK: 2395, PAGE: 2082

NOTE: THIS PARCEL IS SUBJECT TO ALL EASEMENTS AS SHOWN AND ANY OTHER EASEMENTS AND/OR RESTRICTIONS EITHER RECORDED OR BY PRESCRIPTION THAT A COMPLETE TITLE SEARCH MAY REVEAL.

PROPERTY SURVEY
TRACT 6
THE ESTATE OF HELEN T. SMITH
12th CIVIL DISTRICT - RUTHERFORD COUNTY - TN.

DATE: April, 2026 SCALE: 1"=100' SH. 1 OF 1

2115 N.W. BROAD STREET, MURFREESBORO, TN 37129
SURVEYING : 893 - 4084, FAX: 893 - 0080