

WE REQUIRE 30 WORKING DAYS ON ALL APPLICATIONS.

MAILING ADDRESS:
Sumner County Environmental Dept.
Administration Building, Room #114
355 North Belvedere Drive
Gallatin, TN 37066
451-5858

APPLICATION FOR ENVIRONMENTAL SERVICES DIVISION OF GROUNDWATER PROTECTION

1. SERVICE REQUESTED: Septic Permit Re-inspection Letter _____ Modification Permit _____ Water Sample _____ Repair _____

2. LAND OWNER: Name Tom Huff Jr. APPLICANT: Name Cavalier Home Care ORIGINAL OWNER: Name Maudie Chorman
Property Address Lot #3 Quail Run Current Address P.O. Box 488 (ONLY IF APPLYING FOR RE-INSPECTION LETTER)
Portland, TN. 37148 Portland, TN. 37148
Day Phone # 375-0313 Day Phone # 375-0313

3. Is the lot in a subdivision? Yes Name Quail Run Estates Section _____ Tract or Lot # 3

If not in a subdivision, give specific directions: _____

911 Address: 155 Breeder Road -

(MAP AND PARCEL NUMBERS ARE REQUIRED, IF YOUR PROPERTY IS NOT IN A SUBDIVISION)

Map # _____ Parcel # _____

4. FOR RE-INSPECTION ONLY: Will Pick Up _____ Please Mail _____
A) Age of house _____ B) Is house vacant _____, if yes how long? _____
C) Was original system inspected by health department? _____ (IF KNOWN)
D) Date of previous repairs _____ Inspected? _____
E) Waste water "backing up" into plumbing fixtures? _____ Is it surfacing on the ground? _____
F) Is all the waste water, including the washing machine, routed into the septic tank? _____
G) How many acres? _____

5. FOR WATER SAMPLE ONLY:
A) Is there an outside faucet? _____ B) Sanitary seal on casing? _____
C) Is the well chlorinated? _____ D) Is casing 6 inches above ground? _____

6. FOR SEPTIC PERMIT ONLY:
A) How many acres 2.1 B) Number of bedrooms 3 C) How many occupants 3
D) Excavated basement NO, IF YES: Will there be plumbing in the basement? _____
Plumbing in basement such as washing machine _____, bathroom _____, other _____
E) Water: Public X Well _____ Spring _____
F) Is lot staked YES G) Is the house site staked YES, IF NOT when will it be? _____
(STAKING OUT THE HOUSE SITE IS REQUIRED BEFORE PROCESSING THIS APPLICATION)
H) Installer of septic, if known? _____

7. Make rough sketch on the back of this page showing property lines, house site, well location, spring location, planned driveway and utilities.

8. If paying by check, we REQUIRE 2 CHECKS, for permits and re-inspection letters ONLY:

1. PAYABLE TO: Treasurer, State of Tennessee - \$100.00
2. PAYABLE TO: Sumner County Environmental - \$ 25.00

If paying for a water sample:

1. PAYABLE TO: State of Tennessee - \$ 25.00 (Bacteria)
- \$ 50.00 (Fecal)

FOR REPAIR PERMITS THERE IS NO CHARGE
ALL FEES ARE DUE IN ADVANCE AND ARE NON-REFUNDABLE.

9. I certify that the above information is true and correct to the best of my knowledge, and if other than landowner, I have been authorized to submit this application.

Signature _____

Date 8/13/97

(FOR OFFICE USE ONLY) Receipt #'s & Date Applied

83-0001775

**TENNESSEE DEPARTMENT OF ENVIRONMENT AND CONSERVATION
DIVISION OF GROUND WATER PROTECTION
PERMIT FOR CONSTRUCTION OF SUBSURFACE SEWAGE DISPOSAL SYSTEM**

Issued to: <u>Cavalier Homes</u> <small>Owner, Developer, Contractor, Installer, Etc.</small> Location: <u>Lot 3 Quail Run</u> <u>Breeder Rd</u> <u>Portland</u> Installation: <input checked="" type="checkbox"/> 1. New Installation <input type="checkbox"/> 2. Repair to Existing System Establishment: <input checked="" type="checkbox"/> 1. Residential: # Bedrooms <u>3</u> <input type="checkbox"/> 2. Other: _____ <small>(specify)</small> Gal/Day: _____	Evaluation Based Upon: <input checked="" type="checkbox"/> 1. Soil typing by Soil Scientist <input type="checkbox"/> a. General <input checked="" type="checkbox"/> b. High Intensity <input type="checkbox"/> c. Extra High Intensity <input type="checkbox"/> 2. Soil Percolation Test <input type="checkbox"/> 3. Environmental Specialty Estimated Absorption Rate: <u>60000</u> MPI	Type of System: <input type="checkbox"/> 1. Conventional <input type="checkbox"/> 2. Low Pressure Pipe <input type="checkbox"/> 3. Mound <input type="checkbox"/> 4. Lagoon <input checked="" type="checkbox"/> 5. Large Diameter Graveless Pipe <u>10"</u> <input type="checkbox"/> a. Sand backfill required <input type="checkbox"/> 6. Other: _____
Approval based upon: Statute No. <u>T.C.A. 68-221-403</u> <input type="checkbox"/> (c) Percolation test <input type="checkbox"/> (d) Grandfather clause, Current standards except those specified <input type="checkbox"/> (f) 12" (karst) and 6" (non-karst) buffer required <input type="checkbox"/> (i) 9" buffer required (24"-36" total soil depth) <input type="checkbox"/> (k) Grandfather clause — meets June 30, 1990 standards (repair only) <input type="checkbox"/> Other: _____		

This system shall consist of a two compartment septic tank holding 1600 gallons, with 330 linear feet in 4+ trenches, 18 inches wide and 24 inches deep. (Depth of gravel: _____ inches)

Also required:
 1. Soil Improvement Practice (SIP)
 2. Flow Diversion Valve
 3. Sewage Pump
 4. Other: _____

All installers of subsurface sewage disposal systems must hold a valid annual license from the Tennessee Department of Environment and Conservation.

The recipient of this permit agrees to construct or have constructed the above described system in accordance with T.C.A. 68-221-401 et. seq. and The Regulations To Govern Subsurface Sewage Disposal Systems. If any part of the system is covered before being inspected and approved, it shall be uncovered by the recipient at the direction of personnel of the Department of Environment and Conservation. Any cutting, filling or alterations of the soil conditions on the aforementioned property after this day may render this approval null and void.

Cavalier Home Center Date 9-4-97
(Signature of Recipient)
 Issued at Gallatin Tennessee, in Sumner County
 By Bobo E.S. III Date 9/2/97
(Name and Title) (Date of Issue)

This permit is valid for 3 years from date of issue.

Notes: Install to contour of slope stay 25' from soil area w/ curtain drain. Connect Curtain Drain to positive outlet in Back

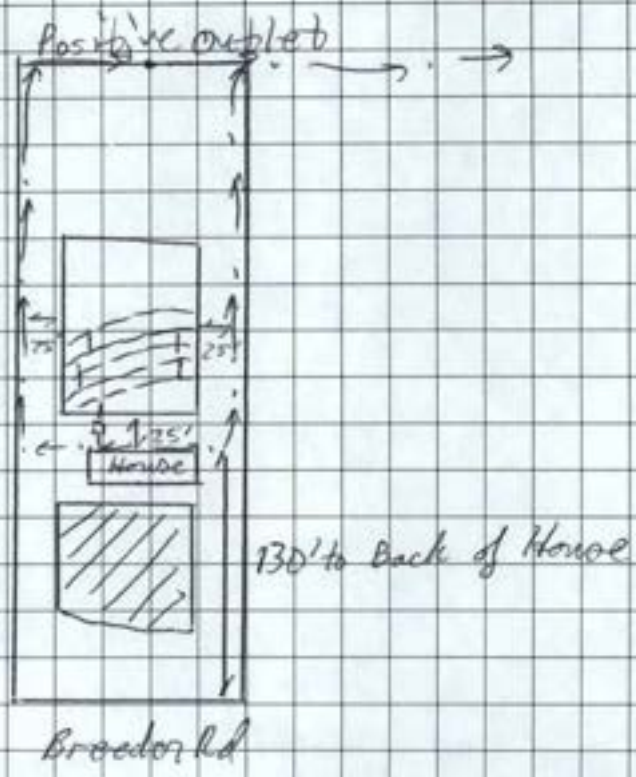

X Cross-section
 + SIP
 --- Field Line
 ——— Solid Line

This is a permit to construct and is not intended to imply approval of any work proposed or completed on this lot.



CERTIFICATE OF COMPLETION OF SUBSURFACE SEWAGE DISPOSAL SYSTEM

Cavalier Homes
 Owner, Developer, Contractor, Installer, Etc.
 Lot #3 Quail Run S/D
 Breeder Rd. Portland

Type of system
 1. Conventional
 2. Low Pressure Pipe
 3. Mound
 4. Lagoon
 5. Large Diameter Gracless Pipe 10"
 (a) Sand backfill required Yes () No (x)
 6. Other
 GCP (type) 1000 (volume) Septic Tank
 Estimated Absorption Rate: ~~60~~ 60 w/d (minutes per inch)
 New Installation () Repair () Other
 Installed by: Ray Eidson

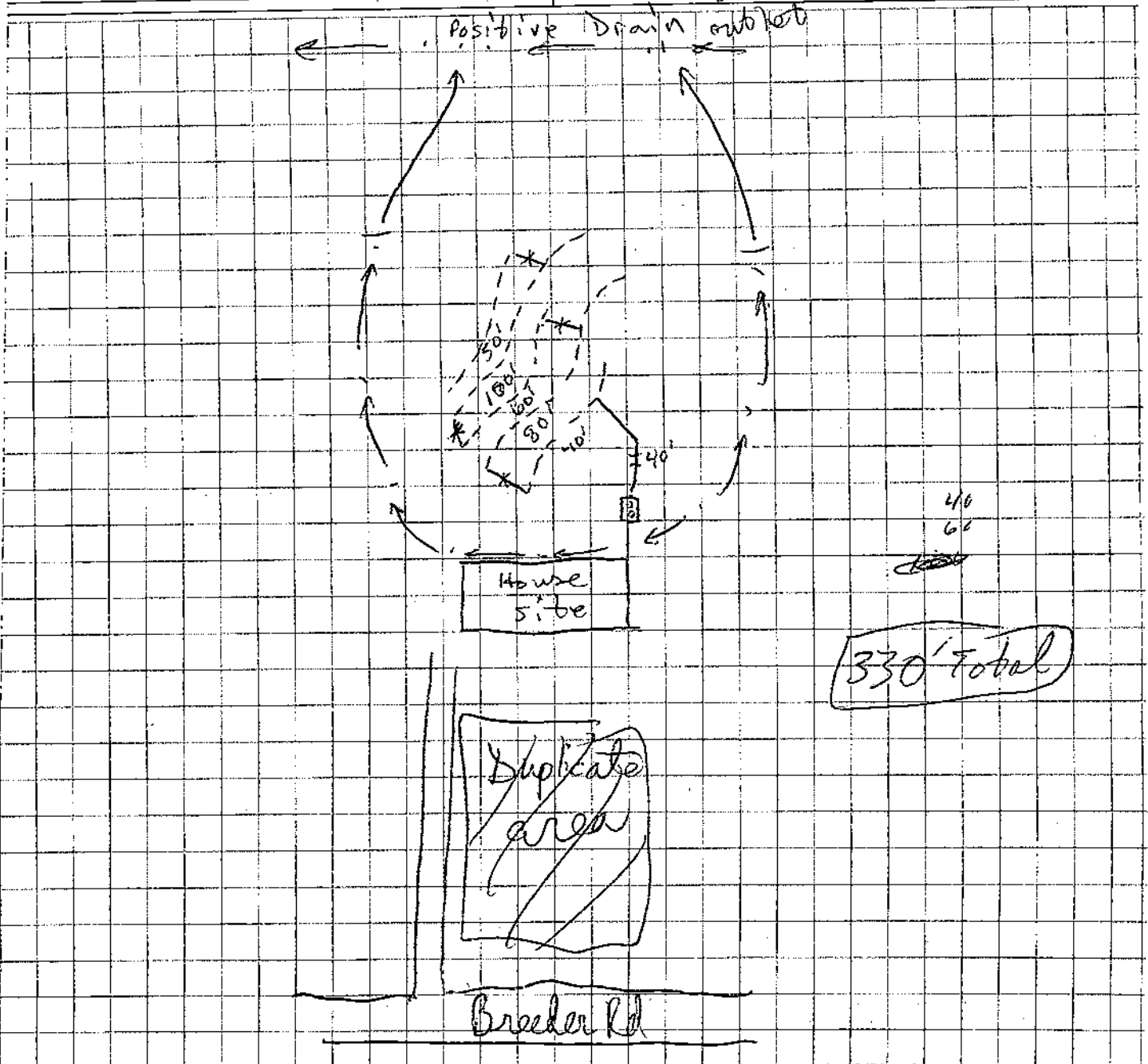

Construction Approved By:

Bo Top E.S. III
(Name and Title)

10/3/97
(date)