

TOTAL AREA: 17.64 ACRES ±

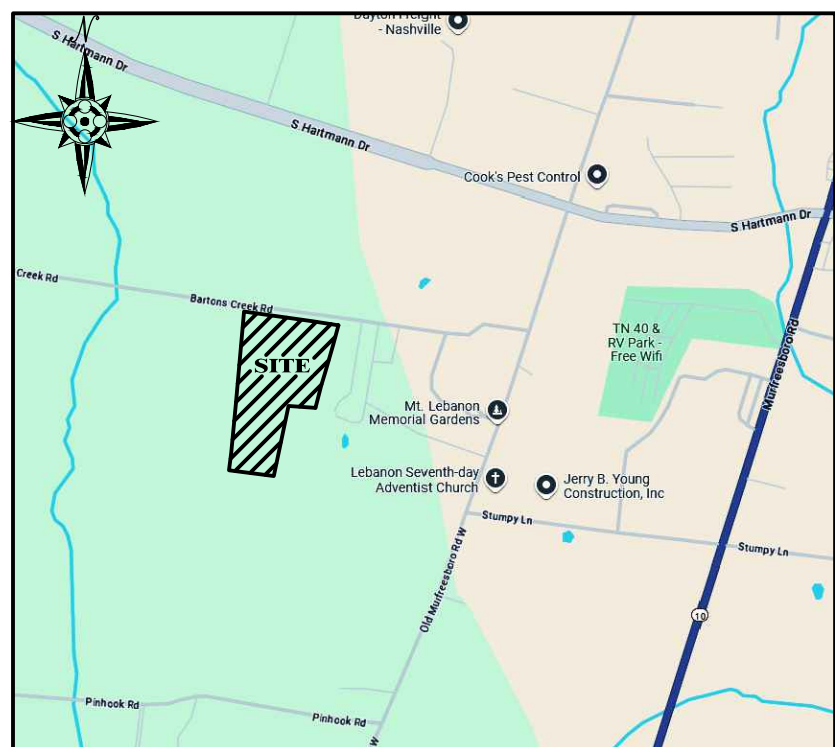

VICINITY MAP: NOT TO SCALE

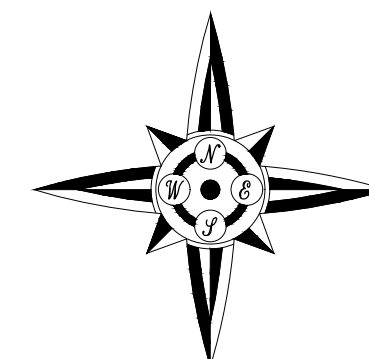

SOURCE OF NORTH  
TN STATE PLANE  
(NAD 83)  
100 0 100  
GRAPHIC SCALE: 1" = 100'



**NOTES:**

- The survey, shown hereon, represents Parcel 1.00, of Map 92, T.A.O.W.C.T..
- Bearings for this survey were obtained from State Plane Coordinates.
- All corners are 1/2" rebar with cap set by this surveyor, unless noted otherwise.
- The underground utilities have not been physically located. Above grade and underground utilities shown were taken from visible appurtenances at the site, public records, and or maps prepared by others. This surveyor makes no guarantee that the underground utilities shown represent all such utilities in the area or that the underground utilities shown are in the exact location indicated. The appropriate utility provider must be contacted to confirm availability and location of utilities.
- Any and all utilities may carry one or more easements. Property owner must contact the appropriate utility authority for the exact location of these easements.
- FEDERAL FLOOD NOTE: This property is not in an area designated as a special flood hazard area as graphically indicated on NFIP Maps No. 47189C0190E, Effective Date: 04-25-2024.
- This survey was performed without benefit of title search; therefore this property is subject to any findings that a current and accurate title search might reveal.
- This map may not be altered without consent of this surveyor.
- Property Address: 360 Bartons Creek Road, Lebanon, TN.

**Certificate of Accuracy**

I hereby certify that this is a Category 1 survey shown and described hereon and is a true and accurate survey to the best of my knowledge. The unadjusted closure ratio of the survey shown hereon meets and/or exceeds 1:10,000.

Brian Ward Keith, TN RLS# 2459  
Office Phone 615-443-7796  
1012 Sparta Pike  
Lebanon, TN 37087

Date



MAP 92, PARCEL 85.00  
MARGIE L. TRICE  
DB.1922, PG.408, R.O.W.C.T.

**OWNER INFORMATION:**  
OWNER: KENNETH E. CUNNINGHAM  
ADDRESS: 360 BARTONS CREEK ROAD  
WATERTOWN, TN 37184  
MAP 92, PARCEL 1.00  
DEED BOOK 204, PAGE 234  
REGISTERS OFFICE OF  
WILSON COUNTY TENNESSEE

**K&A Land Surveying**

1012 Sparta Pike Lebanon TN, 37087  
Office Phone- 615-443-7796

**BOUNDARY SURVEY OF THE  
KENNETH E. CUNNINGHAM PROPERTY  
MAP 92, PARCEL 1.00  
21ST CIVIL DISTRICT of WILSON COUNTY, TENNESSEE**

**DATE: AUGUST 16, 2024 JOB#24-1016-5287**