

# UNIONVILLE DEASON ROAD

SURVEY FOR:

## Unionville Deason Division

ADDRESS: 2250 Unionville Deason Rd  
Bell Buckle, TN 37020

TITLE SOURCE: Deed Book 390; Page 110

TAX MAP: Map 030; Parcel 026.00  
Soil Scientist for tracts 2 & 3 Tim Baxter, Jasper Tn.

TOTAL ACREAGE: 33.78

LOCATED: 8th Civil District  
Bedford County, TN

NOTES:

This parcel is subject to all easements as shown and any other easements and/or restrictions either recorded or by prescription that a complete title search may reveal.

Information concerning major utilities shown hereon are based on visible evidence noted during the survey or information provided by utility companies. Verification of existence, size, location, depth and availability of service should be confirmed by local utility agencies.



GRAPHIC SCALE

### LOCATION MAP

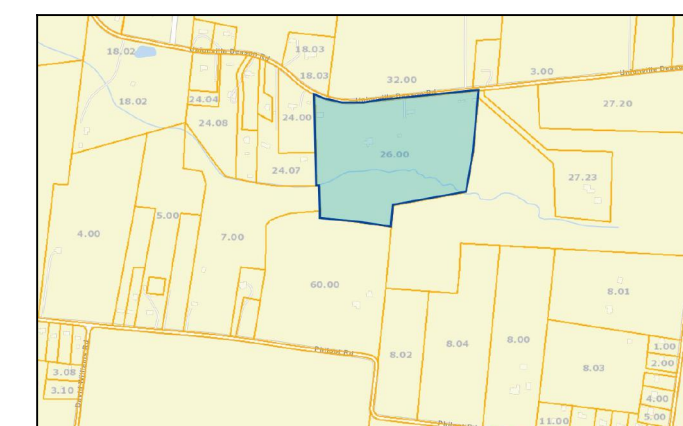

### NORTHCUTT SURVEYING, INC.

207 N Spring St. Suite B

Shelbyville, TN 37160

Phone (931) 684-2741

Email: northcuttsurvey@gmail.com

SCALE: 1"= 100'	APPROVED BY: LBN	DATE SURVEYED: 05/08/2024
DRAWN BY: KJS	SHEETS 1 OF 1	DATE DRAWN: 05/10/2024

SURVEY FOR: DRAWING NO.

Unionville Deason Division

W.O. #24-106

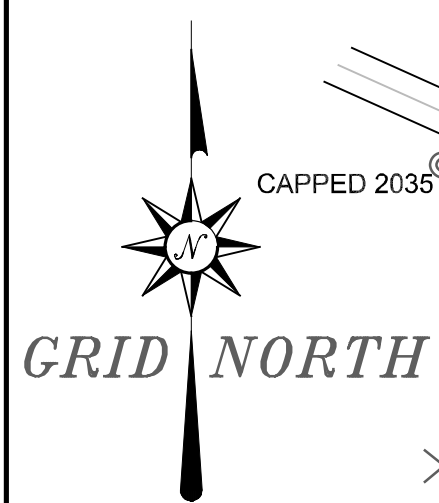

Johns Property  
Deed Book 336; Page 73

Brown Property  
Deed Book 361; Page 97

Batts Property  
Deed Book 347; Page 78

1  
8.76 Acres  
381737 Sq. Feet

2  
5.01 Acres  
217856 Sq. Feet

3  
6.20 Acres  
270181 Sq. Feet

4  
7.79 Acres  
339373 Sq. Feet

5  
6.02 Acres  
262449 Sq. Feet

Lesieur Property  
Deed Book 367; Page 773

I, Lincoln Northcutt a registered land surveyor in the State of Tennessee, certify: (1) that to the best of my knowledge, this is a true and accurate survey and (2) that it meets or exceeds the current minimum standards and applications of a category IV (Remote Sensing) survey as set forth by rule T.C.A. 0820-03-.07C(5). ACCURACY 1 IN 7,500.

REGISTERED LAND SURVEYOR (DATE)

CURVE	RADIUS	ARC LENGTH	CHORD LENGTH	CHORD BEARING	DELTA ANGLE
C1	740.52'	421.08'	415.43'	S 79°48'02" E	32°34'47"

### LINE CHART

LINE	BEARING	DISTANCE
L1	S 07°58'57" W	185.73'
L2	S 82°06'14" W	200.08'
L3	S 82°48'18" W	104.47'
L6	N 80°42'26" W	155.85'
L7	N 82°13'10" W	170.11'
L8	N 83°30'59" W	93.30'
L9	N 01°43'50" W	67.42'
L10	N 88°30'32" W	37.19'
L11	S 12°58'07" W	6.76'
L12	S 82°21'41" E	83.40'
L13	N 82°46'19" E	193.18'
L14	S 06°29'26" E	66.28'
L15	S 41°22'31" W	169.45'
L16	N 69°02'20" W	122.46'
L17	N 12°18'01" E	127.83'
L18	N 82°46'19" E	67.31'
L19	S 03°20'15" E	173.54'
L20	N 03°20'15" W	169.32'

### CURVE CHART

CURVE	RADIUS	ARC LENGTH	CHORD LENGTH	CHORD BEARING	DELTA ANGLE
C1	740.52'	421.08'	415.43'	S 79°48'02" E	32°34'47"

### LEGEND

These standard symbols will be found in the drawing.

- ⊗ METAL PIPE
- IRON ROD SET
- ⊕ WOODEN FENCE POST
- ⦿ UTILITY POLE
- ⊙ IRON ROD OLD
- ⊕ WATER METER
- ⊗ EXISTING SEPTIC TANK

