

Building Sketch

Borrower	Private			
Property Address	2125 Marengo Plantation Ln			
City	Woodford	County	Spotsylvania	State VA Zip Code 22580
Lender/Client	Private			

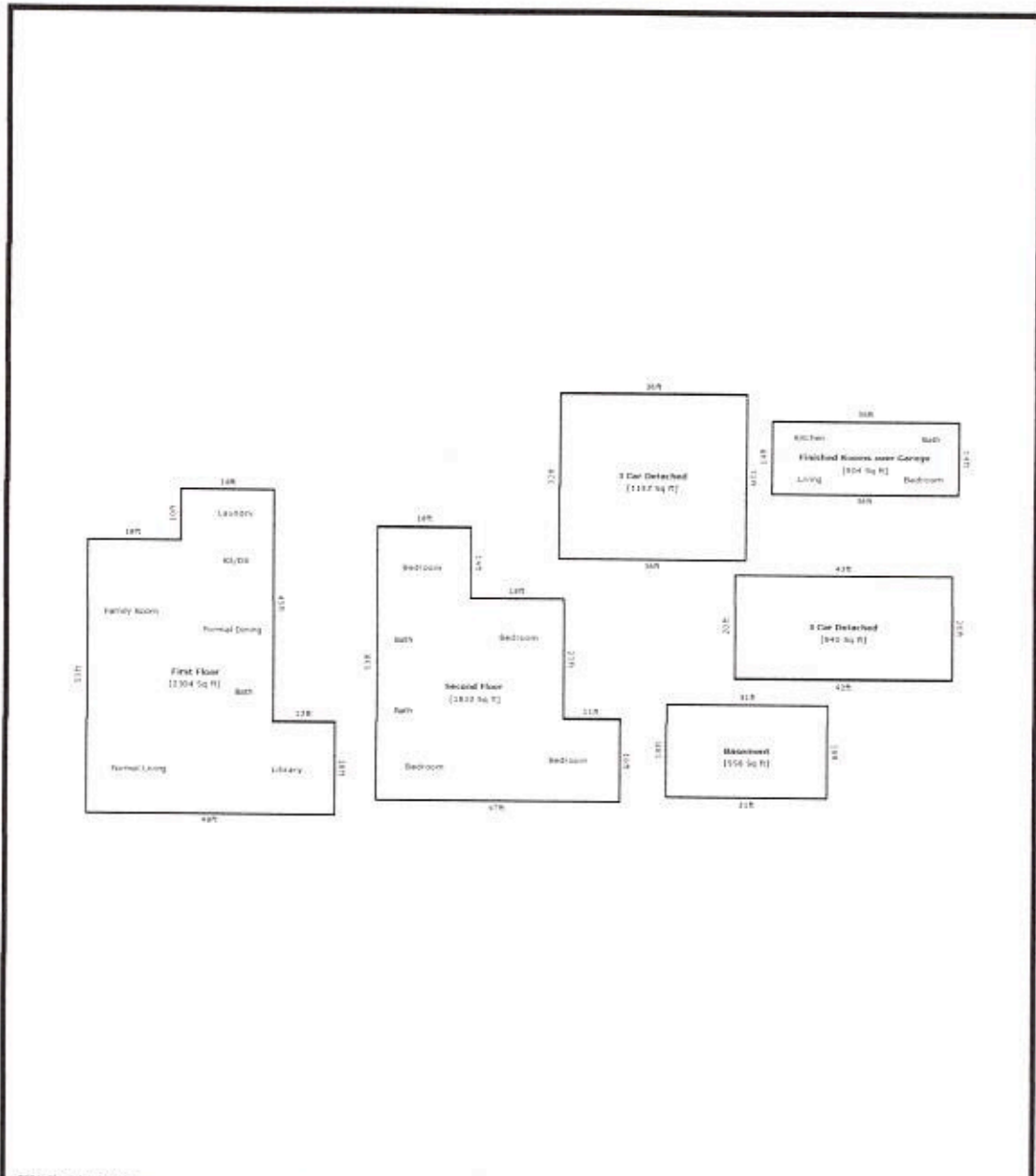

TOTAL Sketch by site mode

Area Calculations Summary

Living Area	Area	Calculation Details
First Floor	2304 Sq ft	$18 \times 12 = 216$ $36 \times 53 = 1908$ $10 \times 18 = 180$
Second Floor	1832 Sq ft	$18 \times 14 = 252$ $39 \times 36 = 1404$ $16 \times 11 = 176$
Total Living Area (Rounded):	4136 Sq ft	
Non-living Area		
Basement	558 Sq ft	$18 \times 31 = 558$