

Howell, Beth (MRC)

From: Craig Palubinski [craigp@bayshoredesign.com]
Sent: Tuesday, October 11, 2011 11:24 AM
To: Howell, Beth (MRC)
Subject: Chaney jpa
Attachments: Chaney jpa.PDF

Hi Beth,

Please find enclosed a jpa for Conrad and Kathleen Chaney – bulkhead and pier in Westmoreland County.

Thanks,
Craig

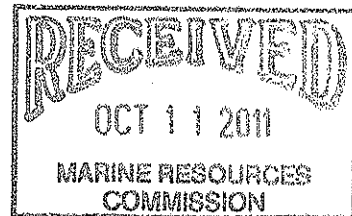

Part 1 – General Information

PLEASE PRINT OR TYPE ALL RESPONSES: If a question does not apply to your project, please print N/A (not applicable) in the block or space provided. If additional space is needed, attach 8-1/2" x 11" sheets of paper.

County or City in which the project is located: WESTMIDZELAND
 Waterway at project site: SHANNON BRANCH OF N.W. YEDCONICO RIVER

1. Applicant's name and complete mailing address: Contact Information:
 (If multiple applicants, each must sign the applicant signature page)
CONRAD M. & KATHLEEN M. CHANEY
3153 GEORGE WAIN LAKE
SILVER SPRING, MD 20904
 Home () _____
 Work (301) 437-1470
 Fax () _____
 Cell/ Pager () _____
 e-mail _____

2. Property owner(s) name and complete address, if different from applicant Contact Information:
SAME AS ABOVE
 Home () _____
 Work () _____
 Fax () _____
 Cell/ Pager () _____
 e-mail _____

3. Authorized agent name and complete mailing address (if applicable): Contact Information:
BOYSHOZE DESIGN, LLC
P.O. BOX 339
WINDSALE, VA 22488
 Home () _____
 Work (804) 472-4439
 Fax (804) 472-3030
 Cell/ Pager () _____
 e-mail CRAC@BOYSHOZEDESIGN.COM

4. Provide a detailed description, in the space below, of the project. For example, a description may be "construction of a timber bulkhead, 125 linear feet long, 6 feet high etc". Be sure to include how the construction site will be accessed, especially if clearing and/or grading will be required.

- CONSTRUCT A 92' TIMBER BULKHEAD WITH BACKFILL PLACING JOE OF ERODING BANK. ESTABLISH VEGETATED COVER ON BACKFILL AREAS

- CONSTRUCT A 6" x 100" OPEN FILE PIECE WITH A 10" x 10" "EL" PLATFORM AND MODIFYING FILES.

FOR AGENCY USE ONLY	
<div style="border: 2px solid black; padding: 10px; width: fit-content; margin: auto;"> <p style="font-size: 2em; font-weight: bold; margin: 0;">RECEIVED</p> <p style="font-size: 1.2em; margin: 0;">OCT 11 2011</p> <p style="font-size: 0.8em; margin: 0;">MARINE RESOURCES COMMISSION</p> </div>	Notes: JPA # <p style="font-size: 1.5em; margin: 0;">11-1512</p>

Part 1 - General Information (continued)

5. Have you obtained a contractor for the project? ___ Yes* No. *If your answer is "Yes" complete the remainder of this question and submit the Applicant's and Contractor's Acknowledgment Form (enclosed)

Contractor's name and complete mailing address:

Contact Information:

Home () _____

Work () _____

Fax () _____

Cell/ Pager () _____

6. List the name, address and telephone number of the newspaper having general circulation in the area of the project. Failure to complete this question may delay local and State processing.

Name and complete mailing address:

Telephone number

WESTMORELAND NEWS
P.O. BOX 699
MONTICELLO, VA 22520

(804) 493-8096

7a. Give the following project location information:

Street Address (911 address if available) 922 SKIPJACK ROAD - KIMSALE

Lot/Block/Parcel# PARCEL 122A - TAX MAP 49

Subdivision KIMSALE AREA

City / County WESTMORELAND CO.

7b. If the project is located in a rural area, please provide driving directions.

RT. 604 (SANDY POINT ROAD) NORTH APE RT. 202 IN
CARMEL CHURCH; RIGHT ON RT. 604 (SKIPJACK ROAD);
FOLLOW TO HOUSE # 922 ON THE RIGHT (JUST BEFORE
WAUCHTEL DRIVE).

Note: if the project is in an undeveloped subdivision or property, clearly stake and identify property lines and location of the proposed project. A supplemental map showing how the property is to be subdivided should also be provided.

Part 1 - General Information (continued)

8. What is the primary and secondary purpose of the project? For example, the primary purpose may be "to protect property from erosion due to boat wakes" and the secondary purpose may be "to provide safer access to a pier."

- PROTECT SHORELINE
- WATER ACCESS

9. Proposed use (check one):

- Single user (private, non-commercial, residential)
- Multi-user (community, commercial, industrial, government)

10. Describe the measures that will be taken to avoid and minimize impacts, to the maximum extent practicable, to wetlands, surface waters, submerged lands, and buffer areas associated with any disturbance (clearing, grading, excavating) during and after project construction.

Please be advised that unavoidable losses of tidal wetlands and/or aquatic resources may require compensatory mitigation. SEE DRAWING SET

11. Have you previously had a site visit, applied to, or obtained a permit from any agency (Federal, State, or Local) for any portion of the project described in this application or any other project at the site?

Yes* No * if you answered "Yes", provide the following information:

<u>Agency / Representative</u>	<u>Activity</u>	<u>Application No.</u>	<u>Action** & Date</u>
--------------------------------	-----------------	------------------------	----------------------------

(**Issued, Denied, Withdrawn, or Site Visit)

Part 1 - General Information (continued)

12. Is this application being submitted for after-the-fact authorization for work which has already begun or been completed? ___ Yes No. If yes, be sure to clearly depict the portions of the project which are already complete in the project drawings.

13. Approximate cost of the entire project (materials, labor, etc.): \$ 20,000

Approximate cost of that portion of the project which is below mean low water: \$ 10,000
(PER DULY)

14. List the name and complete mailing address, including zip code, of each adjacent property owner to the project. (NOTE: a property owner/ applicant cannot be their own adjacent property owner. You must give the next owner down the river, creek, etc).

SEE SHEET 1 OF DRAWING SET

Part 2 - Signatures

1. Applicants and property owners (if different from applicant).

NOTE: REQUIRED FOR ALL PROJECTS

PRIVACY ACT STATEMENT: The Department of the Army permit program is authorized by Section 10 of the Rivers and Harbors Act of 1899, Section 404 of the Clean Water Act, and Section 103 of the Marine Protection Research and Sanctuaries Act of 1972. These laws require that individuals obtain permits that authorize structures and work in or affecting navigable waters of the United States, the discharge of dredged or fill material into waters of the United States, and the transportation of dredged material for the purpose of dumping it into ocean waters prior to undertaking the activity. Information provided in the Joint Permit Application will be used in the permit review process and is a matter of public record once the application is filed. Disclosure of the requested information is voluntary, but it may not be possible to evaluate the permit application or to issue a permit if the information requested is not provided.

I hereby apply for all necessary permits for the activities I have described herein. I agree to allow the duly authorized representatives of any regulatory or advisory agency to enter upon the premises of the project site at reasonable times to inspect and photograph site conditions.

In addition, I certify under penalty of law that this document and all attachments were prepared under my direction or supervision in accordance with a system designed to assure that qualified personnel properly gather and evaluate the information submitted. Based on my inquiry of the person or persons who manage the system or those persons directly responsible for gathering the information, the information submitted is, to the best of my knowledge and belief, true, accurate, and complete. I am aware that there are significant penalties for submitting false information, including the possibility of fine and imprisonment for knowing violations.

CONRAD M. CHANEY

Applicant's Name (printed/typed)

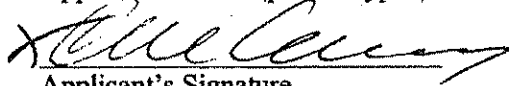

Applicant's Signature

KATHLEEN M. CHANEY

(use if more than one applicant)

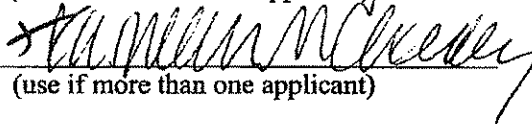

(use if more than one applicant)

9-29-11

Date

Property owner's name (if different)

(use if more than one owner)

Property owner's signature

(use if more than one owner)

Date

2. Applicants having agents (if applicable)

CERTIFICATION OF AUTHORIZATION
EDUARDO M. & KATHLEEN M.

I, CHANEY, hereby certify that I have authorized FALLBINSKI
(Applicant's name) (Agent's name)

to act on my behalf and take all actions necessary to the processing, issuance and acceptance of this permit and any and all standard and special conditions attached.

We hereby certify that the information submitted in this application is true and accurate to the best of our knowledge.

[Signature]
(Agent's Signature)

9-29-11
(Date)

[Signature]
(Applicant's Signature)

[Signature]
(Use if more than one applicant)

9-29-11
(Date)

**Army Corps of Engineers Regional Permit 17 Certificate of Compliance
(for private, noncommercial piers and open-sided boathouses only)**

Yes No 1. Is the proposed pier for private use only?

Yes No 2. Does the proposed pier extend less than 1/4 the width of the waterway as measured from MHW to MHW or OHW to OHW (including channelward wetlands) based on the narrowest distance across the waterway regardless of the orientation of the proposed pier? (MHW = mean high water line; OHW = ordinary high water line)

Yes No 3. Does the proposed pier and/or mooring structures extend less than 300 feet from mean high water or ordinary high water?

N/A Yes No 4. If the proposed structure crosses wetland vegetation, is it an open-pile design that is no more than a maximum 5-foot wide and a not less than a minimum 4-foot high between the decking and the wetlands substrate?

N/A Yes No 5. If the proposed pier is to include an attached open-sided roof designed to shelter a single boat slip or lift, is it less than 700 square feet?

Yes No 6. Have you confirmed that the proposed construction will not be constructed in one of the reaches, as listed in Provision (g) of the permit, which serve as habitat for federally listed threatened or endangered species?

N/A Yes No 7. If the proposed pier and/or mooring piles is in one of the waterways, which have Corps Federal Project Channels as listed in Provision (h), is there the required 85-foot setback from the toe of the slope of the federally maintained channel unless otherwise noted?

N/A Yes No 8. If the proposed work is in portions of any waterways listed in Special Condition 3, have you obtained an easement to cross government property from the Army Corps of Engineers Real Estate Branch?

IF YOU HAVE ANSWERED "NO" TO ANY OF THE QUESTIONS ABOVE, THE REGIONAL PERMIT 17 WILL NOT APPLY AND YOU WILL NEED TO SUBMIT A JOINT PERMIT APPLICATION AND OBTAIN A SEPARATE PERMIT FROM THE CORPS BEFORE COMMENCING CONSTRUCTION.

IF YOU HAVE ANSWERED "YES" TO ALL OF THE QUESTIONS ABOVE, YOU ARE IN COMPLIANCE WITH THE REGIONAL PERMIT 17. PLEASE SIGN BELOW. THIS SIGNED CERTIFICATE IS YOUR LETTER OF AUTHORIZATION FROM THE CORPS. YOU WILL NOT RECEIVE ANY OTHER WRITTEN AUTHORIZATION FROM THE CORPS. YOU MAY NOT PROCEED WITH CONSTRUCTION UNTIL YOU HAVE OBTAINED ALL OTHER NECESSARY STATE AND LOCAL PERMITS.

I CERTIFY THAT I HAVE READ AND UNDERSTAND ALL CONDITIONS OF THE REGIONAL PERMIT 17 (RP-17), DATED AUGUST 14 2003, ISSUED BY THE ARMY CORPS OF ENGINEERS, NORFOLK DISTRICT, NORFOLK, VIRGINIA.

Signature of Property Owner or Agent
9-29-11
Date

Proposed work to be located at:
FAZZEL IZZA - COFLE DISTRICT
TAX MAP 49, WESTMORZELAND
CD, VA.

Copies of the RP-17 can be obtained on our website at www.nao.usace.army.mil/Regulatory/RP-17_2003.pdf or by contacting the Corps at (757) 201-7652.

Part 3 – Appendices

Please complete and submit the appendix questions applicable to your project, and attach the required vicinity map(s) and drawings to your application. If an item does not apply to your project, please write "N/A" in the space provided.

Appendix A: Projects for Access to the water (private and community piers, boathouses, marinas, moorings, boat ramps, aquaculture facilities, etc). Answer all questions that apply.

1) Briefly describe your proposed project.

— CONSTRUCT A 6' X 100' OPEN PILE PIER WITH A 10' X 10' "EL" PLATFORM AND MOORING PILES

2) For private, noncommercial piers:

What is the overall length of the structure? 100 feet.

channelward of Mean High Water? 100 feet.

channelward of Mean Low Water? 0 feet

What is the total size of any and all L- or T-head platforms? 100 sq. ft.

For boathouses, what is the overall size of the roof structure? — sq. ft. Will your boathouse have sides? — Yes — No. N/A

(Note: to meet the exemption for VMRC permits, private piers must not exceed 6 feet in width and L-head or T-head protrusions must not exceed 250 square feet in size; private boathouse roof dimensions must not exceed 700 square feet in size, the boathouse must be open-sided and the project must be unopposed by the adjacent property owners, pursuant to Section 28.2-1203(5) of the Code of Virginia).

3) Provide the type, size, and registration number of the vessel(s) to be moored at the pier or mooring buoy.

Type	Length	Width	Draft	Registration
<u>PIER</u>				

4) For Marinas, Commercial Piers, Community Piers and other non-private piers, provide the following information:

- A) Have you obtained approval for sanitary facilities from the Virginia Department of Health? — (required pursuant to Section 28.2-1205C of the Code of Virginia).
- B) Will petroleum products or other hazardous materials be stored or handled at your facility? —
- C) Will the facility be equipped to off-load sewage from boats? —
- D) How many wet slips are proposed? —. How many are existing? —
- E) What is the area of the piers and platforms that will be constructed over
 - Tidal wetlands — square feet
 - Submerged lands — square feet

Part 3 – Appendices (continued)

Appendix B: Projects for Shoreline Stabilization in tidal wetlands and tidal waters (including riprap revetments, marsh toe stabilization, bulkheads, breakwaters, beach nourishment, groins, jetties, etc). Answer all questions that apply. Please provide any reports from the Shoreline Erosion Advisory Service. (NOTE: Information on non-structural, vegetative alternatives for shoreline stabilization is available at <http://ccrm.vims.edu/specreps/thinkgreen.pdf>)

1) For riprap, **bulkheads**, marsh toe, breakwaters, groins, jetties, what is the overall length of the structure(s)? 92 linear feet.

2) What is the maximum encroachment channelward of mean high water? 2.5 feet.
channelward of mean low water? 0 feet.

3) Please calculate the square footage of encroachment over:

vegetated wetlands 0 square feet
nonvegetated wetlands ~170 square feet
subaqueous bottom 0 square feet

BEACH 0 S.F.

4) For bulkheads, is any part of the project maintenance or replacement of a previously authorized, currently serviceable, existing structure? ___ Yes No. If yes, is it possible to construct the new bulkhead no further than two (2) feet channelward of the existing bulkhead? _____.

5) Describe the type of construction and all materials to be used, including source of backfill material, if applicable (e.g. vinyl sheet-pile bulkhead, timber stringers and butt piles, 100% sand backfill from upland source; broken concrete core material with Class II quarry stone armor over filter cloth).

NOTE: Drawings must include construction details, including dimensions, design and all materials, including fittings if used. JUNGLE & GRAZING TIMBER

6) If using stone, broken concrete, etc., for your structure(s), what is the average weight of the:

Core (inner layer) material _____ pounds per stone Class size _____
Armor (outer layer) material _____ pounds per stone Class size _____

7) For beach nourishment, including that associated with breakwaters, groins or other structures, provide the following:

Volume of material _____ cubic yards channelward of mean low water

_____ cubic yards landward of mean low water

Area to be covered _____ square feet channelward of mean low water

_____ square feet landward of mean low water

Source of material, composition (e.g. 90% sand, 10% clay) _____ and method of transportation and placement _____

_____. Describe any proposed vegetative stabilization measures to be used, including planting schedule, spacing, monitoring, etc. _____



Westmoreland County, Virginia

Land Use Administration

P. O. Box 1000
Montross, VA 22520
Phone 804-493-0120 FAX 804-493-0604

Building Official
Zoning Official
Planning Commission
Board of Zoning Appeals
Board of Building Appeals
Wetlands Board

APPLICATION FOR WETLANDS BOARD APPROVAL

Wetlands Case #: _____ Date Received: _____

Fee: \$500 Paid: Cash Check # _____ (submit with application - non-refundable)

Assigned to the agenda for: NOVEMBER 21, 2011 Deferral fee being 28% of the original fee: 5090

Property Address: 922 SKIPJACK ROAD - KILNSALE, VA 22488

Tax Map Identification: 49-1ZZA Acreage: 0.8674 # Lots 1

Subdivision: _____ Magisterial District: CDFLE

Existing Zoning District: D-1 Proposed Zoning District: _____

Applicant/Owner: CONRAD M. & KATHLEEN M. CHANEY Email: _____

Applicant/Owner Signature: [Signature] Date: 9-29-11 (If more than one owner attach and additional signature page)

Applicants' Address: 3153 GERSHUIN LN. State: MD Zip: 20904

Phone #: 301/437-1470 SILVER SPRING Phone #: _____

Agent: BAYSHORE DESIGN, LLC Email: CTRALGP@BAYSHORE

Agent Signature: [Signature] Date: 9-29-11

Agent Address: P.O. BOX 339 KILNSALE State: VA Zip: 22488

Phone #: 804/472-4439 Phone #: _____ FAX #: 804/472-2036

Project Description: CONSTRUCT A 92' TIMBER BULKHEAD WITH BACKFILL ALONG TOE OF ERODING BANK. ESTABLISH VEG. COVER ON BACKFILL AREAS.

THIS APPLICATION IS INVALID IF NOT SIGNED BY ALL PROPERTY OWNERS OR THEIR AUTHORIZED AGENTS. PROPERLY COMPLETED AND EXECUTED APPLICATIONS, SUPPORT MATERIAL AND FEE MUST BE RECEIVED BY THE APPROPRIATE DEADLINE FOR CONSIDERATION AT THE NEXT AVAILABLE MEETING.

OFFICE USE ONLY

Hearing Date: _____

Proposed Environmental impacts: _____

Vegetated Wetlands: _____ SF Non-Vegetated Wetlands: _____ SF

Sub-Aqueous Bottom: _____ SF Inter-tidal Mud Flat: _____ SF

This application has been found: 1. Complete and accepted 2. Incomplete and not accepted.

Accepted: _____ (Date) Denied: _____ (Date)

By: _____ Title: _____ Date: _____

N
 EBB ROAD

PROPOSED 92' TIMBER BULKHEAD (STAKED & FLAGGED)

PT. TO PT.	DIST.	PT. TO PT.	DIST.
1-2	88'	A-1	18'
2-3	92'	2-3	20'
3-4	93'	3-4	24'
4-5	77'	4-5	24'
5-6	58'	5-6	20'

SHANNON BRANCH
 - N.W. YEDCOMB RIVER -

PROPOSED 100' OPEN PILE PIER WITH MOORING PILES

APPROX. 625' ACROSS (SHORE TO SHORE)

BULKHEAD BACKFILL TO BE SEEDED (PESQUE), STRAW-MULCHED AND COVERED WITH MESH FABRIC

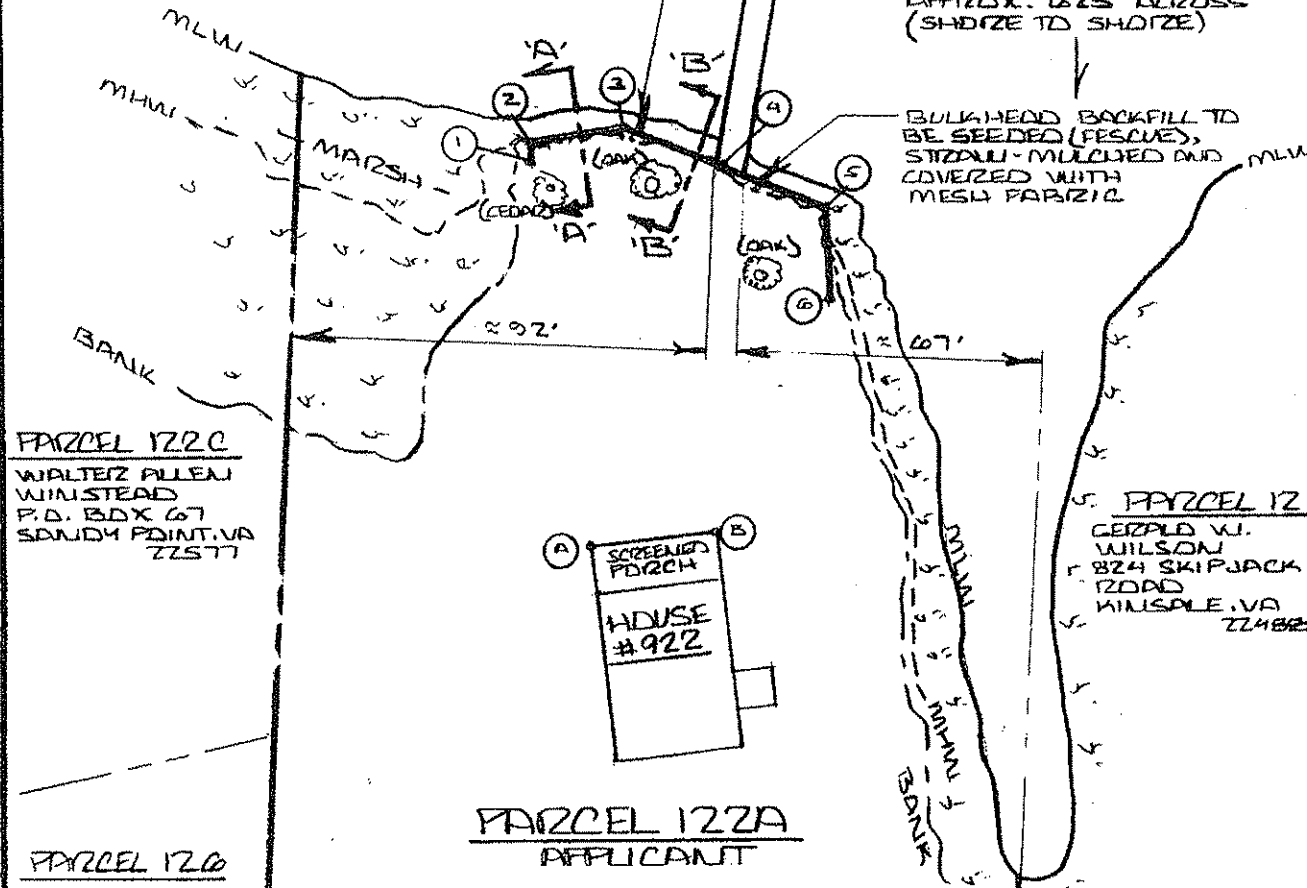

PARCEL 122C
 WALTER ALLEN WINSTEAD
 P.O. BOX 67
 SANDY POINT, VA 22577

PARCEL 121
 GEORGE W. WILSON
 824 SKIPJACK ROAD
 KINSALE, VA 22408

PARCEL 122A
 APPLICANT

PARCEL 120

SITE PLAN
 SCALE: 1" = 40'

RECEIVED
 OCT 11 2011
 MARINE RESOURCES COMMISSION

© 2011 - BAYSHORE DESIGN LLC. ALL RIGHTS RESERVED. WITHOUT LIMITATION, ANY REPRODUCTIONS, REVISIONS, OR MODIFICATION OF THESE DOCUMENTS WITHOUT THE EXPRESS WRITTEN CONSENT OF BAYSHORE DESIGN LLC IS PROHIBITED BY LAW.

PROPOSED TIMBER BULKHEAD & OPEN PILE PIER
 CONRAD M. & KATHLEEN M. CHANEY
 3153 GERSHWINI LANE
 SILVER SPRING, MD 20904

LOCATION: 922 SKIPJACK ROAD - KINSALE, PARCEL 122A - CDPL DISTRICT TAX MAP 40, WESTMORELAND CO., VA
 PURPOSE: PROTECT SHORELINE & WATER ACCESS
 SHT: 1 OF 5 DATE: 9-29-11 BAYSHORE DESIGN, LLC

KINSALE QUADRANGLE
VIRGINIA - MARYLAND
7.5 MINUTE SERIES (TOPOGRAPHIC-BATHYMETRIC)

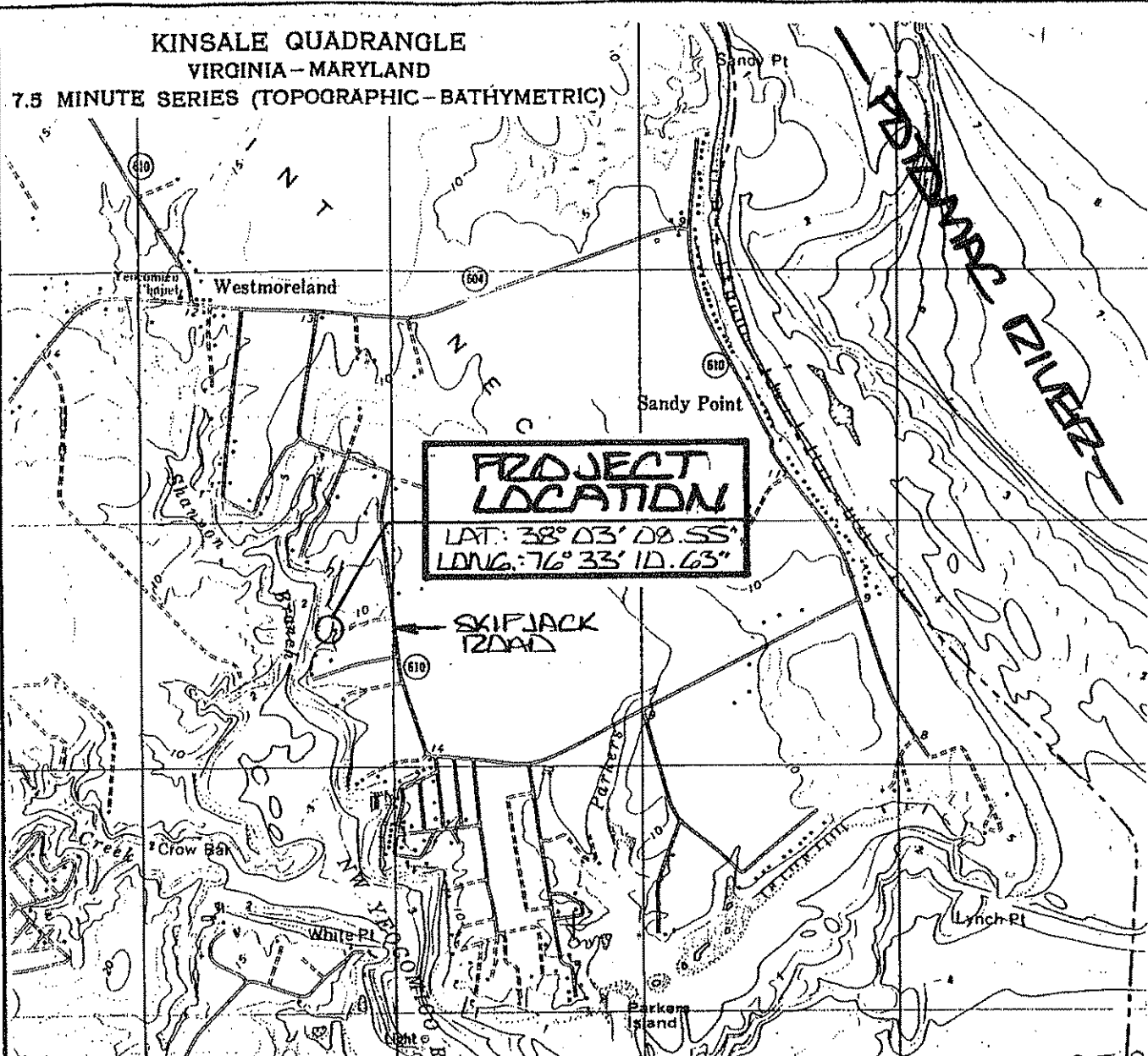

PROJECT LOCATION
 LAT: 38° 03' 08.55"
 LONG: 76° 33' 10.63"

VICINITY MAP

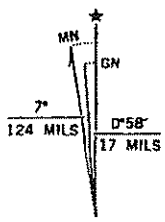
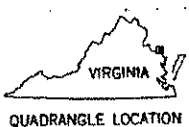

UTM GRID AND 1968 MAGNETIC NORTH DECLINATION AT CENTER OF SHEET

© - 2011 BAYSHORE DESIGN, LLC

SCALE 1:24000

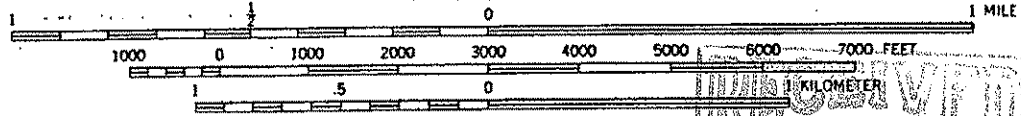

CONTOUR INTERVAL 10 FEET
 DASHED LINES REPRESENT 5-FOOT CONTOURS
 NATIONAL GEODETIC VERTICAL DATUM OF 1929
 BATHYMETRIC CONTOUR INTERVAL 1 METER WITH SUPPLEMENTARY
 0.5 METER CONTOURS - DATUM IS MEAN LOW WATER
 THE RELATIONSHIP BETWEEN THE TWO DATUMS IS VARIABLE
 THE MEAN RANGE OF TIDE IS APPROXIMATELY 0.3 METER

OCT 11 2011

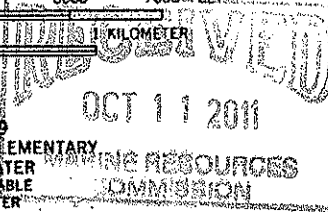

PROPOSED BULKHEAD AND PIER
CHANNEY - FAZZEL IZZA - SKIFFACK RD.
N.W. YEDDNICA RIVER - WESTMORELAND CO.
SHT: 20FS DATE: 9-29-11 BAYSHORE DESIGN, LLC

SECTION 'A'-'A'

EXISTING GRADE WITH VEGETATED COVER TO REMAIN

BACKFILL AREAS TO BE SEED (FESCUE), STRAW-MULCHED AND COVERED WITH MESH FABRIC

PROPOSED TIMBER BULKHEAD

- 6" TO 8" PILES, \approx 5' TO 6' O.C.
- 3" X 6" STRINGERS
- 2" X 8" T & G SHEET PILES
- 5/8" DIA. BOLTS
- 2" X 8" CAP

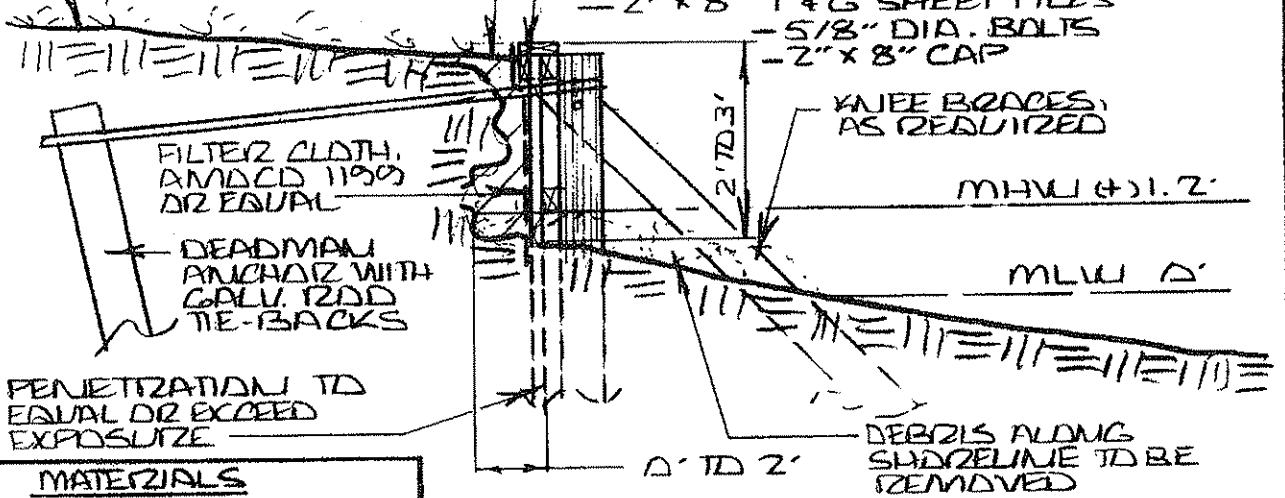

MATERIALS

- ALL LUMBER AND PILES TO BE PRESSURE TREATED
- ALL NAILS, BOLTS AND HARDWARE TO BE GALV.

SECTION 'B'-'B'

SCALE: 3/8" = 1'

EXISTING GRADE WITH VEG. COVER TO REMAIN

BACKFILL AREAS TO BE SEED (FESCUE), STRAW-MULCHED AND COVERED WITH MESH FABRIC

PROPOSED TIMBER BULKHEAD, TYP.

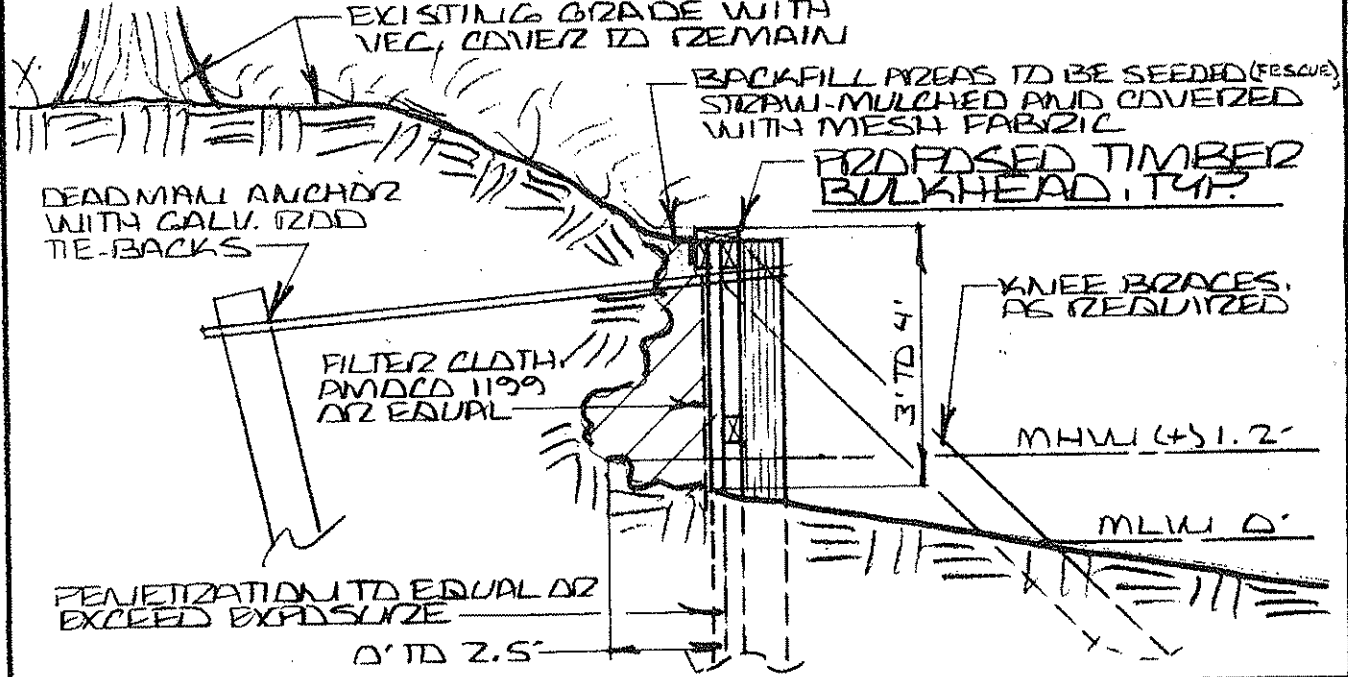

PROPOSED BULKHEAD AND PIER
 CHANEY — PARCEL 122A-SKIPJACK RD.
 N.W. 4ED RIVIER WESTMORELAND CO
 SET 3 OF 5 DATE: 9-29-11 BAYSHORE DESIGN, LLC

© 2011 BAYSHORE DESIGN, LLC

REVIEWED
 OCT 11 2011
 MARINE RESOURCES COMMISSION

MODRINO FILE:
2 PLACES

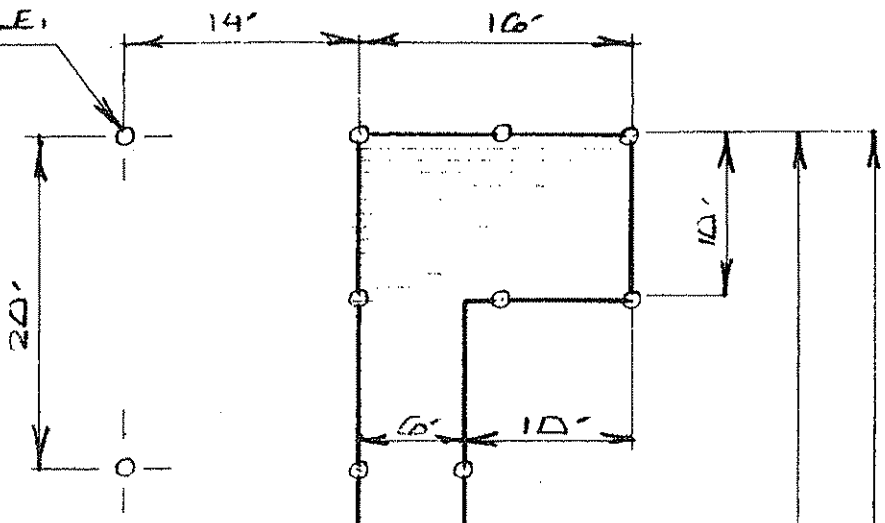

PROPOSED PIER

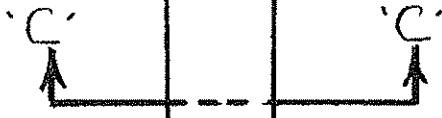

PIER PLAN VIEW

SCALE: 3/32" = 1'

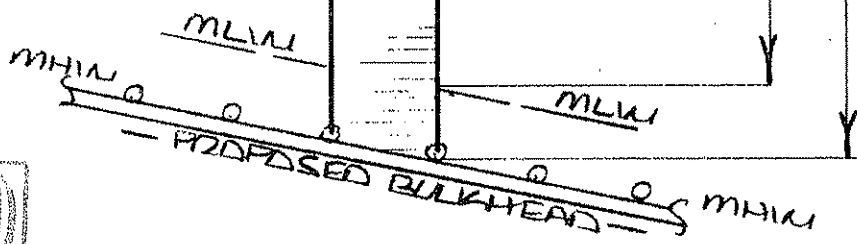

RECEIVED
 OCT 11 2011
 MARINE RESOURCES
 COMMISSION

PROPOSED BULKHEAD AND PIER
 CHANEY — PARCEL 122A SKIPJACK RD.
 N.W. 4EDCOM CO RIVER - WESTMORELAND CO.
 SHT: 4 OF 5 DATE: 9.29.11 BAYSHORE DESIGN, LLC

© 2011 BAYSHORE
 DESIGN, LLC

RECEIVED
 OCT 11 2011
 MARINE RESOURCES
 COMMISSION

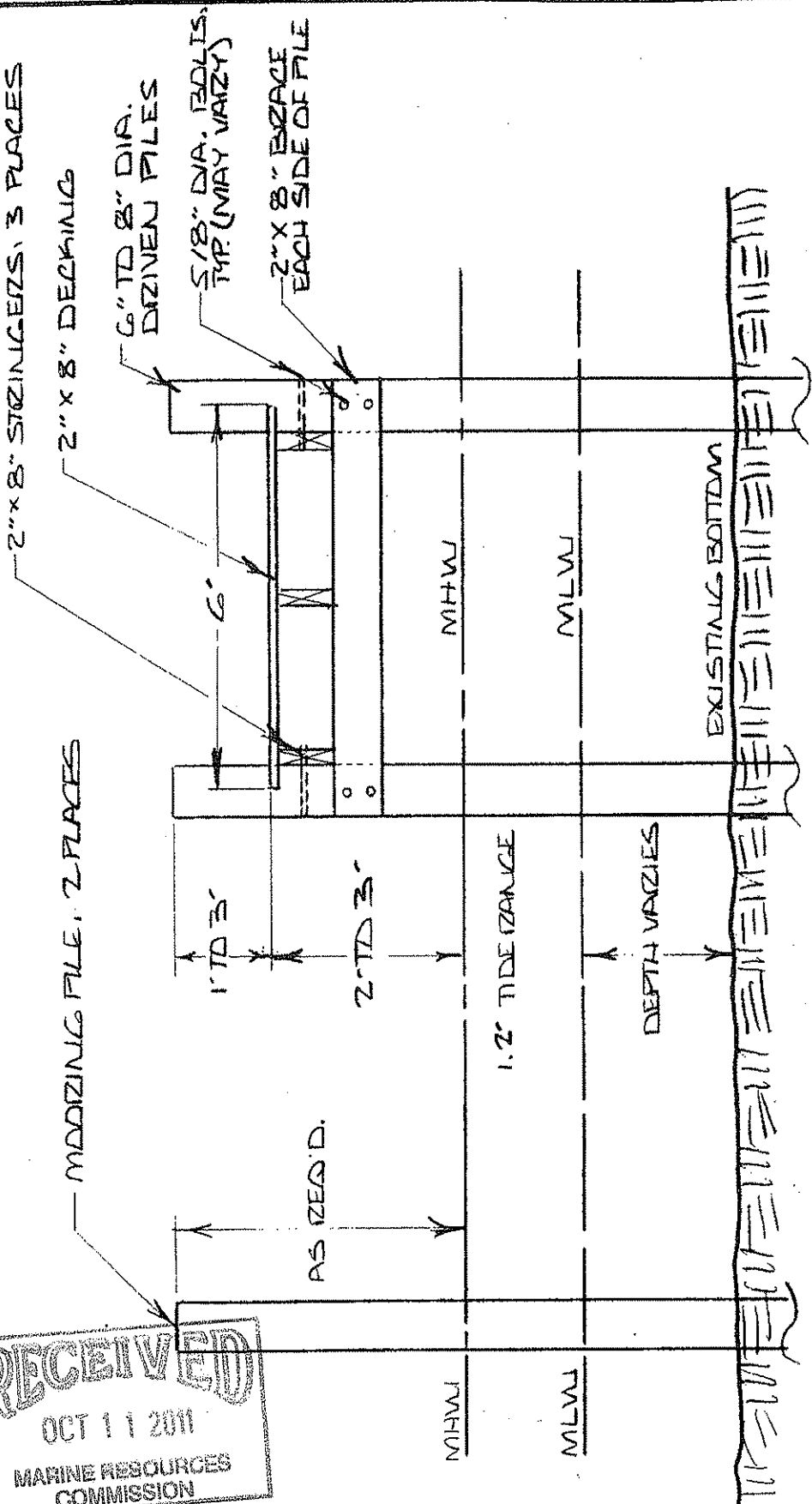

SECTION 'C.C.'
 SCALE: NONE

© - 2011 - BAYSHORE DESIGN, LLC

MATERIALS

1. ALL PILES AND LUMBER TO BE PRESSURE TREATED.
2. ALL NAILS, BOLTS AND HARDWARE TO BE HOT DIPPED GALVANIZED.

PROPOSED BULKHEAD AND PIER
 CHANNEY — PARCEL 122A-SHIPYACK RD.
 N.W. MEADOWCROFT BLVD - WESTMINSTER CO.
 SHT. 5 OF 5 DATE: 9-27-11 BAYSHORE DESIGN, LLC