

EXISTING DRAINFIELD

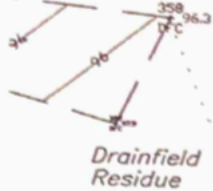

Drainfield Residue



Drainfield Parcel B

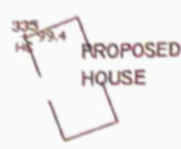

PROPOSED HOUSE

Note-Well Stake not used



PROPOSED WELL

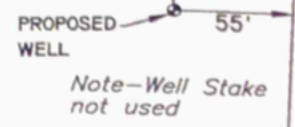

PROPOSED WELL

Note-Well Stake not used



PROPOSED HOUSE

PARCEL C
5.011 Ac.

PROPOSED RESERVE D/F

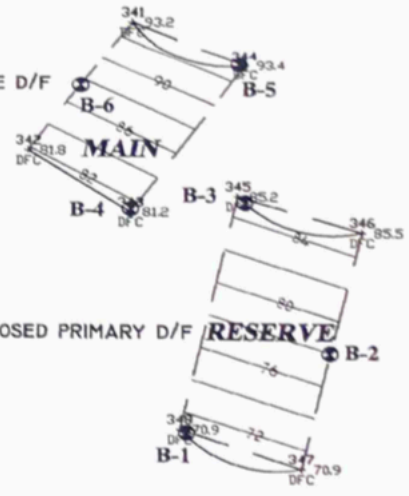

PROPOSED PRIMARY D/F

RESERVE

E ACCESS EASEMENT
TING GRAVEL ROAD)

SANITARY SURVEY NOTE -
No wells, drainfields, or houses are
within 200 feet of proposed drainfield
system components or wells other than
those indicated by this Plan.

NOTE-Refer to the Health Department Information Plat
& Division Plat for detailed descriptions.

S 00°34'55" E 160.25'
I.P.F. AT BASE OF TALL PIPE

S 00°40'16" E 326.46'

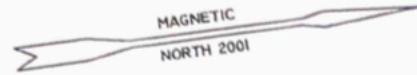

MAGNETIC
NORTH 2001

IRON ROD
(S 55° 09' 26" W 0.41'
FROM I.R.F.)



Scale 1" = 60 ft.
Site Sketch & Boring Location Plat
Forrest R. or Betty J. Ross Prop
TM# 23-94 & 23-95B
Parcel C
Madison County, Virginia