



### CRS Data

#### LOCATION

<b>Property Address</b>	No Address Available SC
<b>Subdivision</b>	Gauley Falls
<b>County</b>	Pickens County, SC

#### PROPERTY SUMMARY

<b>Property Type</b>	Open Space
<b>Land Use</b>	Vacant Land
<b>Improvement Type</b>	
<b>Square Feet</b>	

#### GENERAL PARCEL INFORMATION

<b>Parcel ID/Tax ID</b>	4175-01-15-1947 R0016278
<b>Alternate Parcel ID</b>	
<b>Account Number</b>	R0016278
<b>District/Ward</b>	W14
<b>2010 Census Trct/Blk</b>	101/1
<b>Assessor Roll Year</b>	2016

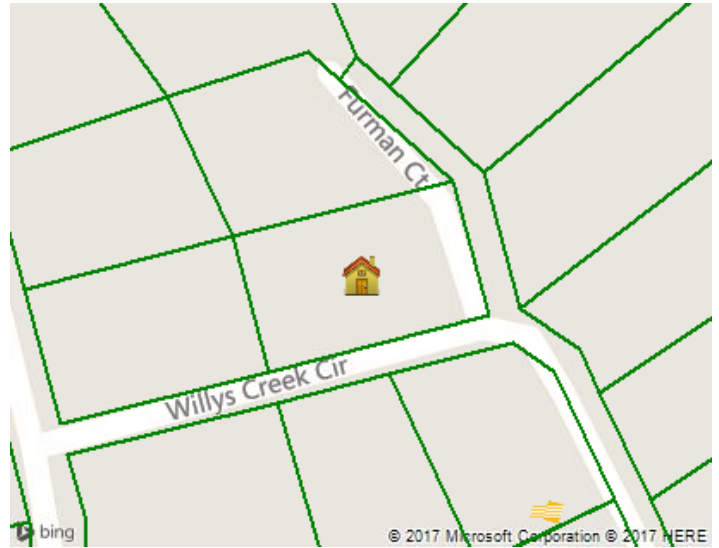

#### CURRENT OWNER

<b>Name</b>	Ely Annette
<b>Mailing Address</b>	Po Box 1022 Pickens, SC 29671-1022

#### SALES HISTORY THROUGH 03/08/2017

Date	Amount	Buyer/Owners	Buyer/Owners 2	Instrument	No. Parcels	Book/Page Or Document#
12/29/2015	\$1	Ely Annette				1741/62
8/3/2007	\$25,000	Ely Annette Ely Julia W				1122/47
6/7/2007	\$12,000	Henderson James P Henderson Patsy A				1107/191
5/20/1984	\$11,000	McAbee Marvin L McAbee Betty		Warranty Deed		14K/884

#### TAX ASSESSMENT

Appraisal	Amount	Assessment	Amount
<b>Appraisal Year</b>	2016	<b>Assessment Year</b>	2016
<b>Appraised Land</b>	\$20,000	<b>Assessed Land</b>	
<b>Appraised Improvements</b>		<b>Assessed Improvements</b>	
<b>Total Tax Appraisal</b>	\$20,000	<b>Total Assessment</b>	\$1,200
		<b>Exempt Amount</b>	
		<b>Exempt Reason</b>	

#### TAXES

Tax Year	City Taxes	County Taxes	Total Taxes
2017			\$262.54
2015			\$265.76
2014			\$263.36
2013			\$343.84

#### MORTGAGE HISTORY

No mortgages were found for this parcel.

**PROPERTY CHARACTERISTICS: BUILDING**

No Buildings were found for this parcel.

**PROPERTY CHARACTERISTICS: EXTRA FEATURES**

No extra features were found for this parcel.

**PROPERTY CHARACTERISTICS: LOT**

<b>Land Use</b>	Vacant Land	<b>Lot Dimensions</b>
<b>Block/Lot</b>	15/42	<b>Lot Square Feet</b>
<b>Latitude/Longitude</b>	34.997895°/-82.765741°	<b>Acreage</b>

**PROPERTY CHARACTERISTICS: UTILITIES/AREA**

<b>Gas Source</b>	<b>Road Type</b>
<b>Electric Source</b>	<b>Topography</b>
<b>Water Source</b>	<b>District Trend</b>
<b>Sewer Source</b>	<b>Special School District 1</b>
<b>Zoning Code</b>	<b>Special School District 2</b>
<b>Owner Type</b>	

**LEGAL DESCRIPTION**

<b>Subdivision</b>	Gauley Falls	<b>Plat Book/Page</b>
<b>Block/Lot</b>	15/42	<b>District/Ward</b> W14
<b>Description</b>	Gauley Falls Lot 42 Sec 3 Plat 25/211 //Tax Millage Rate:	

**FLOOD ZONE INFORMATION**

<b>Zone Code</b>	<b>Flood Risk</b>	<b>BFE</b>	<b>Description</b>	<b>FIRM Panel ID</b>	<b>FIRM Panel Eff. Date</b>
X	Minimal		Area of minimal flood hazard, usually depicted on FIRMs as above the 500-year flood level.	45077C0135D	04/16/2008