



## CRS Data

### LOCATION

<b>Property Address</b>	104 River Rd Cleveland, SC 29635
<b>Subdivision</b>	River Bluff
<b>County</b>	Pickens County, SC

### PROPERTY SUMMARY

<b>Property Type</b>	Open Space
<b>Land Use</b>	Vacant Land
<b>Improvement Type</b>	
<b>Square Feet</b>	

### GENERAL PARCEL INFORMATION

<b>Parcel ID/Tax ID</b>	5107-00-19-8390 R0034704
<b>Alternate Parcel ID</b>	H02-00-0580
<b>Account Number</b>	R0034704
<b>District/Ward</b>	A11
<b>2010 Census Trct/Blk</b>	41.02/1
<b>Assessor Roll Year</b>	2016

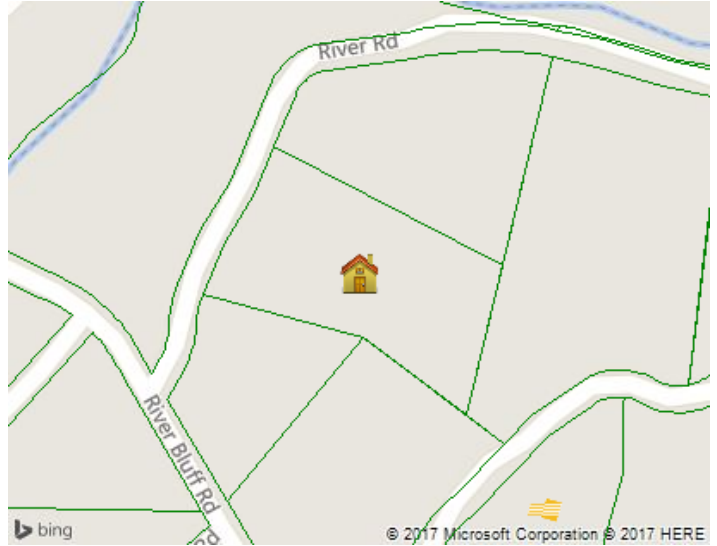

### CURRENT OWNER

<b>Name</b>	Howard E Jean
<b>Mailing Address</b>	708 Crescent Ave Greenville, SC 29601-4350

### SALES HISTORY THROUGH 03/08/2017

Date	Amount	Buyer/Owners	Buyer/Owners 2	Instrument	No. Parcels	Book/Page Or Document#
6/6/2014	\$1	Howard E Jean				1611/233
6/6/2014	\$1	Howard Samuel Hunter Jr				1611/230
1/10/2008	\$1	Howard Jean G			2	1161/13
6/18/2004	\$17,600	Howard S Hunter Sr Howard Elizabeth Jean		Warranty Deed		833/17

### TAX ASSESSMENT

Appraisal	Amount	Assessment	Amount
<b>Appraisal Year</b>	2016	<b>Assessment Year</b>	2016
<b>Appraised Land</b>	\$35,000	<b>Assessed Land</b>	
<b>Appraised Improvements</b>		<b>Assessed Improvements</b>	
<b>Total Tax Appraisal</b>	\$35,000	<b>Total Assessment</b>	\$2,100
		<b>Exempt Amount</b>	
		<b>Exempt Reason</b>	

### TAXES

Tax Year	City Taxes	County Taxes	Total Taxes
2017			\$455.03
2015			\$460.67
2014			\$313.87
2013			\$263.16

**MORTGAGE HISTORY**

No mortgages were found for this parcel.

**PROPERTY CHARACTERISTICS: BUILDING**

No Buildings were found for this parcel.

**PROPERTY CHARACTERISTICS: EXTRA FEATURES**

No extra features were found for this parcel.

**PROPERTY CHARACTERISTICS: LOT**

<b>Land Use</b>	Vacant Land	<b>Lot Dimensions</b>	
<b>Block/Lot</b>	19/34	<b>Lot Square Feet</b>	144,619
<b>Latitude/Longitude</b>	35.063374°/-82.664379°	<b>Acreage</b>	3.32

**PROPERTY CHARACTERISTICS: UTILITIES/AREA**

<b>Gas Source</b>		<b>Road Type</b>	
<b>Electric Source</b>		<b>Topography</b>	
<b>Water Source</b>		<b>District Trend</b>	
<b>Sewer Source</b>		<b>Special School District 1</b>	
<b>Zoning Code</b>		<b>Special School District 2</b>	
<b>Owner Type</b>			

**LEGAL DESCRIPTION**

<b>Subdivision</b>	River Bluff	<b>Plat Book/Page</b>	
<b>Block/Lot</b>	19/34	<b>District/Ward</b>	A11
<b>Description</b>	River Bluff Lot 034 Sec 1 Phase I Plat 31/168 /H02-00-0580 /Tax Millage Rate:		

**FLOOD ZONE INFORMATION**

<b>Zone Code</b>	<b>Flood Risk</b>	<b>BFE</b>	<b>Description</b>	<b>FIRM Panel ID</b>	<b>FIRM Panel Eff. Date</b>
X	Minimal		Area of minimal flood hazard, usually depicted on FIRMs as above the 500-year flood level.	45077C0060D	04/16/2008