



CRS Data

LOCATION

Property Address	No Address Available SC
Subdivision	River Bluff
County	Pickens County, SC

PROPERTY SUMMARY

Property Type	Open Space
Land Use	Vacant Land
Improvement Type	
Square Feet	

GENERAL PARCEL INFORMATION

Parcel ID/Tax ID	5107-00-19-6150 R0034668
Alternate Parcel ID	
Account Number	R0034668
District/Ward	A11
2010 Census Trct/Blk	101/2
Assessor Roll Year	2016

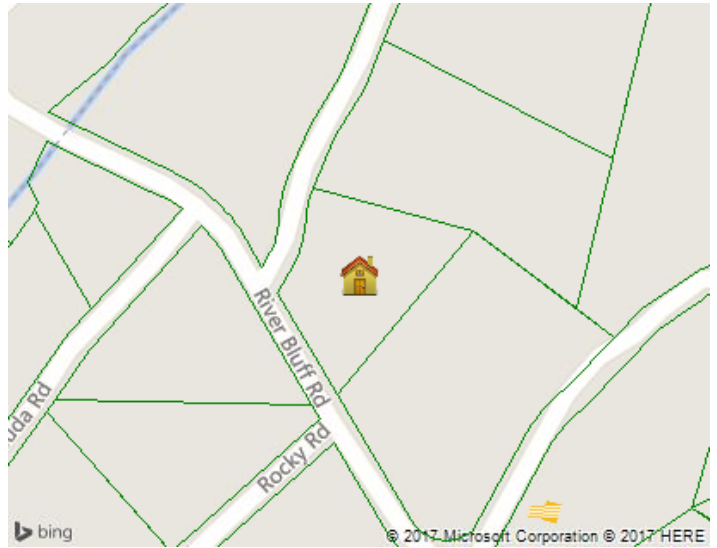

CURRENT OWNER

Name	Howard James G
Mailing Address	708 Crescent Ave Greenville, SC 29601-4350

SALES HISTORY THROUGH 03/08/2017

Date	Amount	Buyer/Owners	Buyer/Owners 2	Instrument	No. Parcels	Book/Page Or Document#
6/6/2014	\$1	Howard James G				1611/240
6/6/2014	\$1	Howard Samuel Hunter Jr Trustee Jean G Howard Rev				1611/237
1/10/2008	\$1	Howard Jean G			2	1161/13
6/18/2004	\$11,000	Howard S Hunter Sr		Warranty Deed		833/30

TAX ASSESSMENT

Appraisal	Amount	Assessment	Amount
Appraisal Year	2016	Assessment Year	2016
Appraised Land	\$25,000	Assessed Land	
Appraised Improvements		Assessed Improvements	
Total Tax Appraisal	\$25,000	Total Assessment	\$1,500
		Exempt Amount	
		Exempt Reason	

TAXES

Tax Year	City Taxes	County Taxes	Total Taxes
2017			\$325.02
2015			\$329.05
2014			
2013			\$161.28

MORTGAGE HISTORY

No mortgages were found for this parcel.

PROPERTY CHARACTERISTICS: BUILDING

No Buildings were found for this parcel.

PROPERTY CHARACTERISTICS: EXTRA FEATURES

No extra features were found for this parcel.

PROPERTY CHARACTERISTICS: LOT

Land Use	Vacant Land	Lot Dimensions	
Block/Lot	19/33	Lot Square Feet	84,942
Latitude/Longitude	35.062820°/-82.665066°	Acreage	1.95

PROPERTY CHARACTERISTICS: UTILITIES/AREA

Gas Source		Road Type	
Electric Source		Topography	
Water Source		District Trend	
Sewer Source		Special School District 1	
Zoning Code		Special School District 2	
Owner Type			

LEGAL DESCRIPTION

Subdivision	River Bluff	Plat Book/Page	
Block/Lot	19/33	District/Ward	A11
Description	River Bluff Lot 033 Sec 1 Phase I Plat 31/168 //Tax Millage Rate:		

FLOOD ZONE INFORMATION

Zone Code	Flood Risk	BFE	Description	FIRM Panel ID	FIRM Panel Eff. Date
X	Minimal		Area of minimal flood hazard, usually depicted on FIRMs as above the 500-year flood level.	45077C0060D	04/16/2008
X	Minimal		Area of minimal flood hazard, usually depicted on FIRMs as above the 500-year flood level.	45077C0070D	04/16/2008