



## COUNTY OF HENRICO - FINANCE DEPARTMENT REAL ESTATE ASSESSMENT DIVISION

Address: 4301 E. Parham Rd.  
Henrico, VA 23273-2745  
Phone: 804-501-4300  
Fax: 804-501-5420

### Base Information

<b>Parcel ID</b>	762-771-9383	<b>Parcel Address</b>	4100 OLD SPRINGFIELD RD
<b>Vision PID #</b>	45478	<b>Appraiser</b>	T
<b>State Code</b>	Resid (Sub)	<b>Neighborhood</b>	3E095
<b>Use Code</b>	023 Vacant < 5 Acres	<b>Acreeage</b>	
<b>Tax Type</b>	Taxable	<b>Owner (Jan 1)</b>	HASE GEORGE A III
<b>Zoning</b>	A-1	<b>Owner (Cur)</b>	HASE GEORGE A III
<b>Tax Dist</b>	Regular	<b>Mailing Address</b>	
<b>Magisterial</b>	Brookland	<b>Zip</b>	
<b>Subdivision</b>	Acreeage	<b>Old Map #</b>	00210A0000 0022
<b>Section</b>		<b>Pre 1992 Map #</b>	90 B1 3
<b>Block</b>		<b>Map Page #</b>	29
<b>Lot</b>	.50 acres		

### Image

Photo Not Available

### Last Transfer

Sale Date	Sale Price	Deed Book	Page	Previous Owner	Sale Comment
11/29/1962	\$300	1085	0580		

Last Photo Update Unknown

### Current Assessment

Year	Date	Land	Land Use	Improvements	Total
2021	01/28/2021	\$3,000		\$0	\$3,000

Photo Not Available

### Land Information

Type	# Units	Unit Type	Sqft	Zoning
AE	.12	ACREAGE	5,227	A-1
AF	.38	ACREAGE	16,553	A-1

### Notes

no data found

### Sketch Details

no data found

### Map

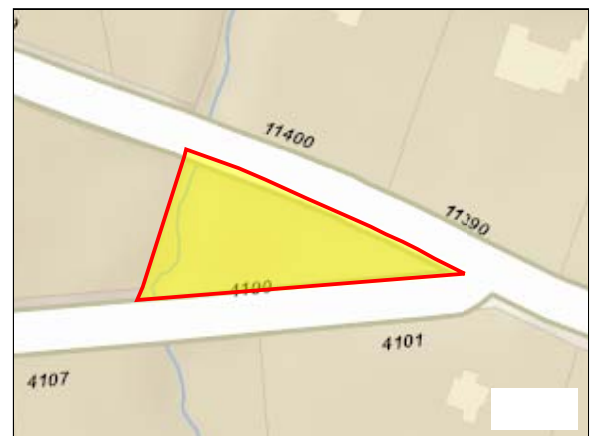

**Legal Disclaimer:** Non-confidential real estate assessment records are public information under Virginia law, and Internet display of non-confidential property information is specifically authorized by Virginia Code 58.1-3122.2. While the Real Estate Division has worked to ensure that the assessment data contained herein is

3/9/2021

Base

accurate, Henrico County assumes no liability for any errors, omissions, or inaccuracies in the information provided or for any reliance on any maps or data provided herein. Please consult County records in the Real Estate Division for official information.

Click [Real\\_Estate\\_Comments](#) to submit comments or corrections.