



Summary

Parcel ID 0660295
Tax ID 0660295
Neighborhood 3
Property Address 507 9 N
Legal Description LOT 507 BLK 7 SUBDIVISION: NORTHWEST B VILLAGE
Acresage N/A
Class 1 - 1 Single Family Urban
Tax District/Area 01

View Map



Owner

Primary Owner
Palmer William Or Phyllis
507 N 9th Ave
Hopewell, VA 23860

Site Description

Zoning R3

Land

Table with 14 columns: Land Type, Soil ID, Actual Front, Acresage, Effect. Front, Effect. Depth, Prod Factor, Depth Factor, Meas Sq Ft, Base Rate, Adj Rate, Extended Value, Influ. Factor, Value. Row 1: Homesite, 60.000, 0.000, 60.000, 100.000, 1.00, 0.78, 14,000.00, 14,000.00, 14,000.00, L -4%, 14,000.00

Land Detail Value Sum 14,000.00

Residential Dwellings

Card 01
Residential Dwelling 1
Occupancy
Story Height 1.0
Roofing Material: Asphalt shingles
Attic None
Basement Type None
Basement Rec Room None
Finished Rooms 6
Bedrooms 3
Family Rooms 0
Dining Rooms 1
Full Baths 1; 3-Fixt.
Half Baths 0; 0-Fixt.
4 Fixture Baths 0; 0-Fixt.
5 Fixture Baths 0; 0-Fixt.
Kitchen Sinks 1; 1-Fixt.
Water Heaters 1; 1-Fixt.
Central Air No
Primary Heat Space heater
Extra Fixtures 0
Total Fixtures 5
Fireplace No
Features None
Porches and Decks Enclosed Frame Porch 128
Yd Item/Spc Fture/Outbldg None
Last Updated 2/18/2019

Table with 5 columns: Construction, Exterior Cover, Floor, Base Area (sf), Fin. Area (sf). Row 1: Wood frame, Vinyl siding, 1.0, 1098, 1098. Row 2: Crawl, 1098, 0. Row 3: Total, 1098, 1098

**Improvements**

Card 01

ID	Use	Const Type	Grade	Year Const	Eff Year	Cond	Base Rate	Features	Adj Rate	Size/ Area	Cost Value	Phys Depr	Obsol Depr	Mrkt Adj	% Comp	Value
D	DWELL		D	1939	1970	F	0.00		0	1098	95090	55	0	78	100	33400

**Transfers**

Date	Owner 1	Owner 2	Book & Page	Document #	Amount
11/13/2006	ARD OZELL E OR LOUISE R			060004309	\$45,000
8/19/1975	TEJERA MARY		145/833		\$6,000
1/1/1932	PRINCE GEORGE DEED			PRI GEO	\$0

**Valuation**

Assessment Year		01/01/2019	01/01/2017	01/01/2015	01/01/2013	01/01/2011
Reason for Change		Reassessment	Reassessment	Reassessment	Reassessment	Reassessment
VALUATION	Land	\$14,000	\$13,900	\$13,900	\$13,900	\$14,500
(Assessed Value)	Improvements	\$33,400	\$45,600	\$48,600	\$49,400	\$52,200
	<b>Total</b>	<b>\$47,400</b>	<b>\$59,500</b>	<b>\$62,500</b>	<b>\$63,300</b>	<b>\$66,700</b>

**Photos**



**Sketches**

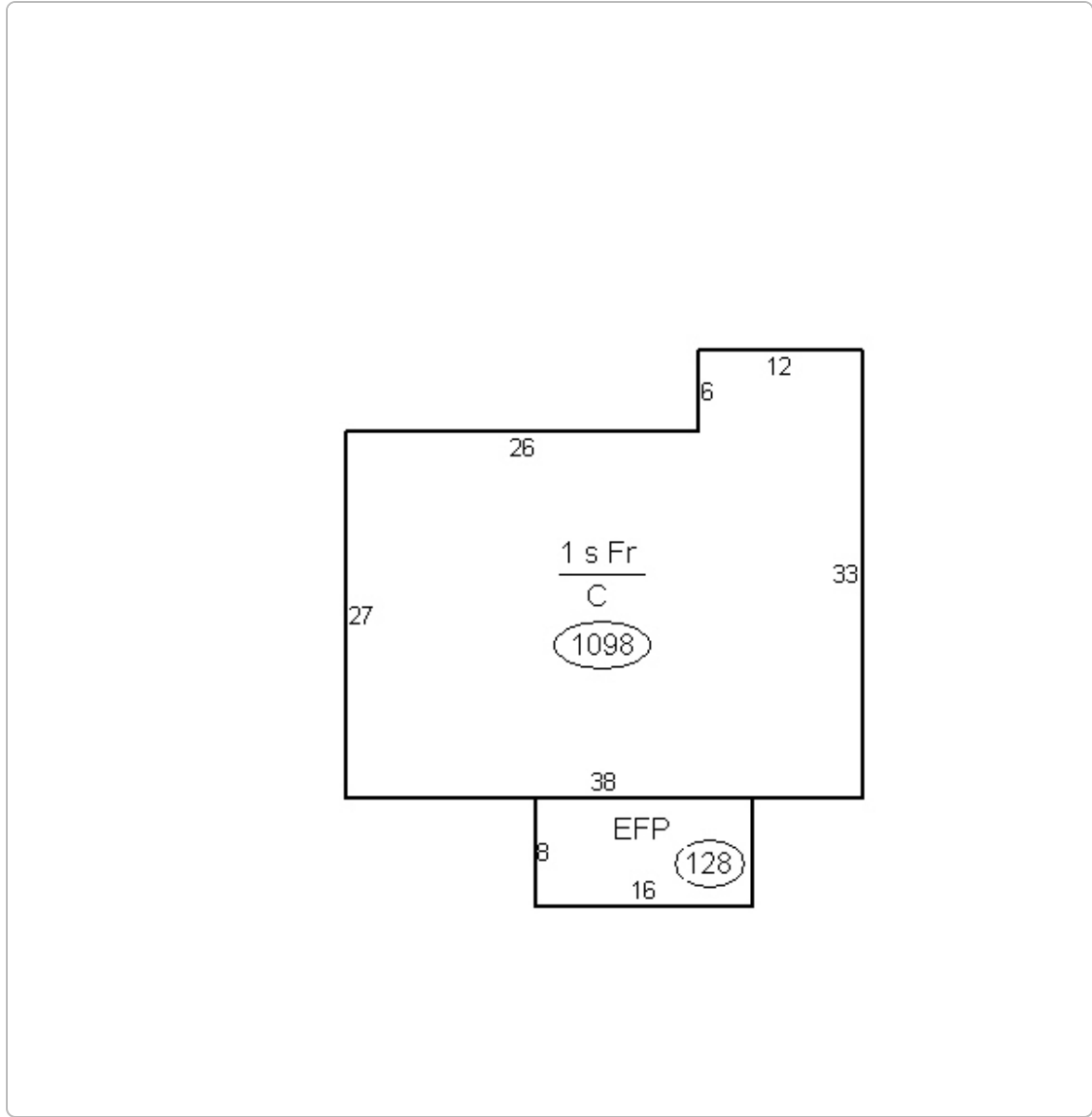

No data available for the following modules: Commercial Buildings.

The City of Hopewell Assessor's Office makes every effort to produce the most accurate information possible. No warranties, expressed or implied, are provided for the data herein, its use or interpretation.

[User Privacy Policy](#)  
[GDPR Privacy Notice](#)

Last Data Upload: 11/12/2020, 5:08:26 AM

Version 2.3.93

