

2616 Newbourne St, Richmond, VA 23223-4520, Richmond City

	Beds N/A	Bldg Sq Ft 4,320	Lot Sq Ft 6,200	Sale Price N/A
	Baths N/A	Yr Built 1954	Type RELIGIOUS	Sale Date 05/15/1995

OWNER INFORMATION

Owner Name	Pentecostal Tabernacle Church(Te)	Mailing Zip	08081
Mailing Address	7 Log Cabin Rd	Mailing Zip + 4 Code	5656
Mailing City & State	Sicklerville, NJ	Owner Occupied	No

LOCATION INFORMATION

MLS Area	10	Carrier Route	C031
Magisterial	East End	Zoning	R-5
Subdivision	Woodville	Census Tract	202.00
Zip Code	23223	Neighborhood Name	Woodville
Zip + 4	4520		

TAX INFORMATION

PID	E012-0318-009	% Improved	73%
Parcel ID	E0120318009	Lot	4
Legal Description	WOODVILLE L4&5 0050.00X0124.0 0 0000.000		

ASSESSMENT & TAX

Assessment Year	2020	2019	2018
Assessed Value - Total	\$48,000	\$48,000	\$47,000
Assessed Value - Land	\$13,000	\$13,000	\$12,000
Assessed Value - Improved	\$35,000	\$35,000	\$35,000
Market Value - Total	\$48,000	\$48,000	\$47,000
Market Value - Land	\$13,000	\$13,000	\$12,000
Market Value - Improved	\$35,000	\$35,000	\$35,000
YOY Assessed Change (%)	0%	2.13%	
YOY Assessed Change (\$)	\$0	\$1,000	

Tax Year	Total Tax	Change (\$)	Change (%)
2017	\$864		
2018	\$2,184	\$1,320	152.78%
2019	\$2,088	-\$96	-4.39%

CHARACTERISTICS

Lot Acres	0.1423	Year Built	1954
Lot Sq Ft	6,200	Bldg Area - Finished Sq Ft	4,320
Lot Frontage	50	Bldg Area - Total Sq Ft	4,320
Lot Depth	124	Basement Sq Ft	1,200
Land Use - County	Religious/Church/Synagogue	Basement - Unfinished Sq Ft	1,200
Land Use - CoreLogic	Religious	Basement Type	Full
Stories	1	Condition	Poor

ESTIMATED VALUE

Value As Of	06/21/2020
-------------	------------

LAST MARKET SALE & SALES HISTORY

Settle Date	05/15/1995	Document Number	438-1427
Owner Name	Pentecostal Tabernacle Church(Te)	Deed Type	Deed (Reg)

Sale/Settlement Date: 05/15/1995

Buyer Name	Pentecostal Tabernacle
Buyer Name 2	Church
Document Number	438-1427
Document Type	Deed (Reg)

MORTGAGE HISTORY	
Mortgage Date	12/08/2003
Mortgage Amount	\$43,349
Mortgage Lender	Bank Of America
Mortgage Purpose	Refi
Mortgage Type	Conventional
Mortgage Doc #	46857

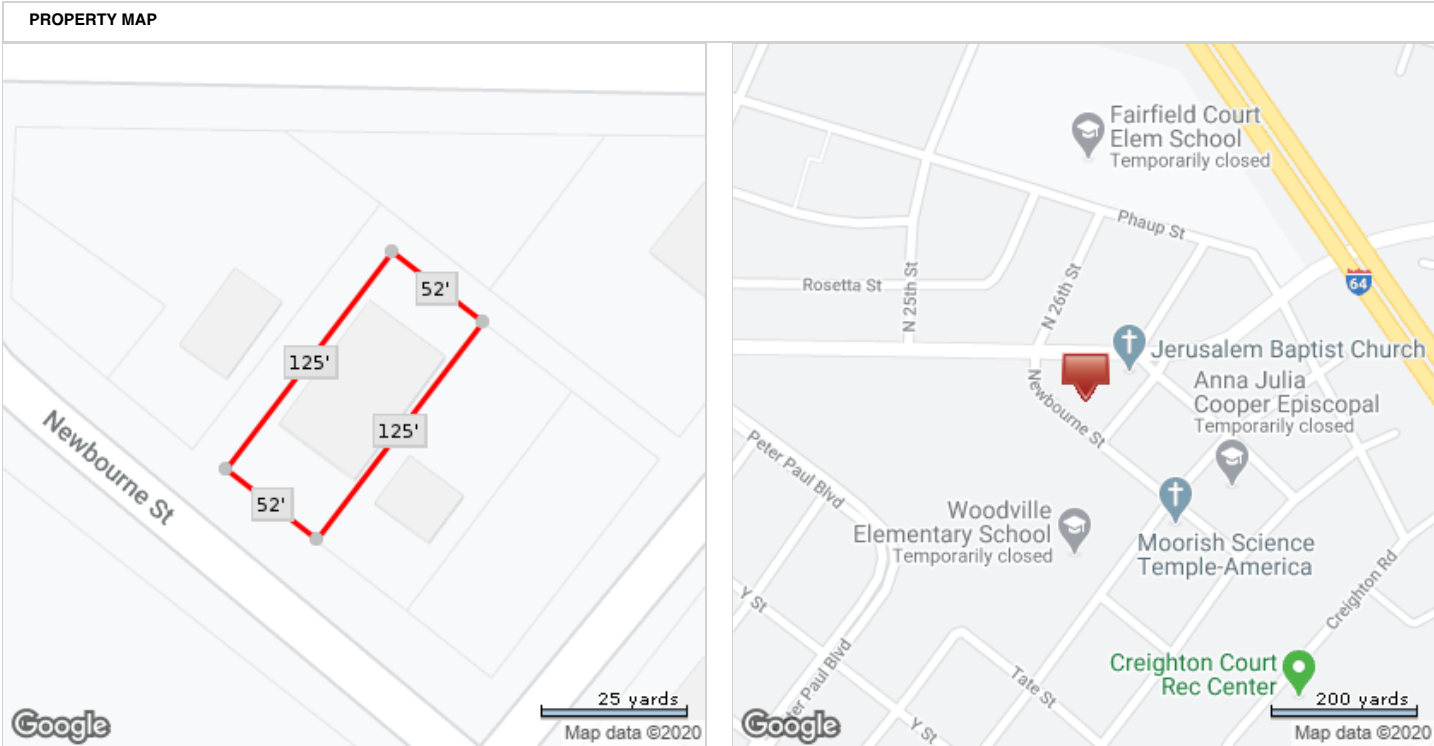

*Lot Dimensions are Estimated