

Property Information Report

City of Lynchburg Assessor's Office
900 Church Street
Lynchburg, VA 24504
Telephone: (434) 455-3830
8:30a.m. - 5:00 p.m. Mon - Fri

Parcel ID:	04610006	Owner:	WEST, JENNY L ESTATE
Property Address:	1421 MAIN ST LYNCHBURG, VA 24504	Mailing Address:	1020 FEDERAL ST LYNCHBURG, VA 24504-3017

Property Descriptions	
Legal Description:	DIAMOND HILL
Neighborhood:	1300 : DOWNTOWN-CENTRAL BUSINESS DIST
Property Class:	402 : COMMERCIAL - RETAIL

Land Information	
Area:	Legal Acreage: 0.096 GIS Acreage: 0.079
Frontage:	0.00ft
Depth:	100ft

Special Assessments	
Participant in Land Use:	NO
Land Use Deferral Amount:	--
Participant in Rehab Program:	NO
Exempt Amount:	--
Participant Until:	--

School Zones	
Elementary School:	SANDUSKY ELEMENTARY
Middle School:	SANDUSKY MIDDLE
High School:	HERITAGE HIGH
Zoning:	Zoning Description:
B-4	Urban Commercial

Ownership History

Sale Date	Sale Amount	Seller's Name	Buyer's Name	Document No	Deed Bk / Pg	Conveyance
9/24/2024	\$0	WEST, JENNY L	WEST, JENNY L ESTATE	240000266		AFFIDAVIT
6/21/2007	\$142,000	SIGLE, DAVID	WEST, JENNY L	070006115		DEED
3/1/1998	\$0	WRIKER, CLYDE L	SIGLE, DAVID		1026 519	
9/26/1991	\$85,000	STOKES, RAYMOND H & MARTH B	WRIKER, CLYDE L		803 159	
9/8/1983	\$28,500	KENNEDY, JOSEPH MICHAEL	STOKES, RAYMOND H & MARTHA B		631 641	
1/19/1978	\$10,000	SANDERSON, F P & GRACE	KENNEDY, JOSEPH MICHAEL			
10/23/1947	\$0	SANDERSON, ORA L EST	SANDERSON, F P & GRACE		254 409	
1/1/1870	\$0	CAMPBELL COUNTY ANNEXATION 1870				

DISCLAIMER: This data is provided without warranty of any kind, either expressed or implied, including but not limited to, the implied warranties of merchantability and fitness for a particular purpose. Any person, firm or corporation which uses this map or any of the enclosed information assumes all risk for the inaccuracy thereof, as the city of Lynchburg expressly disclaims any liability for loss or damage arising from the use of said information by any third party.

Assessment

Year	Land Value	Improvement value	Total Value	Assessment Date	Notes
2025	\$62,700	\$172,300	\$235,000	7/1/2025	Current Assessment
2024	\$62,700	\$162,300	\$225,000	7/1/2024	
2023	\$62,700	\$162,300	\$225,000	7/1/2023	
2022	\$62,700	\$144,700	\$207,400	7/1/2022	
2021	\$62,700	\$144,700	\$207,400	7/1/2021	
2020	\$62,700	\$136,800	\$199,500	7/1/2020	
2019	\$62,700	\$136,800	\$199,500	7/1/2019	
2018	\$45,400	\$113,900	\$159,300	7/1/2018	
2017	\$45,400	\$113,900	\$159,300	7/1/2017	
2016	\$45,400	\$113,900	\$159,300	7/1/2016	
2015	\$45,400	\$113,900	\$159,300	7/1/2015	
2014	\$45,400	\$113,900	\$159,300	7/1/2014	
2013	\$45,400	\$113,900	\$159,300	7/1/2013	
2012	\$45,400	\$113,900	\$159,300	7/1/2012	
2011	\$45,400	\$113,900	\$159,300	7/1/2011	
2010	\$45,400	\$113,900	\$159,300	7/1/2010	
2009	\$45,400	\$113,900	\$159,300	7/1/2009	
2008	\$42,400	\$66,200	\$108,600	7/1/2008	
2007	\$42,400	\$66,200	\$108,600	7/1/2007	
2006	\$34,100	\$58,600	\$92,700	7/1/2006	
2005	\$34,100	\$58,600	\$92,700	7/1/2005	
2004	\$6,300	\$58,700	\$65,000	7/1/2004	
2003	\$6,300	\$58,700	\$65,000	7/1/2003	

Real Estate Property Tax Information

Total Due:
\$2,315.54

Current Year	Type	Date Due	Tax Billed	Penalty Billed	Interest Billed	Tax Paid	Penalty Paid	Interest Paid	Date Paid	Balance Due
Installment #:1	Tax	11/15/24	\$2,002.50	\$200.24	\$112.80	\$0.00	\$0.00	\$0.00		\$2,315.54

History	Type	Tax Billed	Penalty Billed	Interest Billed	Tax Paid	Penalty Paid	Interest Paid	Date Paid	Balance Due
2023	Tax	\$2,002.50	\$0.00	\$0.00	\$2,002.50	\$0.00	\$0.00	4/26/2024	\$0.00
2022	Tax	\$2,260.66	\$0.00	\$0.00	\$2,260.66	\$0.00	\$0.00	5/16/2023	\$0.00
2021	Tax	\$2,302.14	\$0.00	\$0.00	\$2,302.14	\$0.00	\$0.00	10/19/2021	\$0.00
2020	Tax	\$2,214.45	\$0.00	\$0.00	\$2,214.45	\$0.00	\$0.00	5/13/2021	\$0.00
2019	Tax	\$1,684.98	\$42.13	\$7.75	\$1,684.98	\$42.13	\$7.75	4/21/2020	\$0.00
2018	Tax	\$1,238.76	\$0.00	\$0.00	\$1,238.76	\$0.00	\$0.00	3/12/2019	\$0.00
2017	Tax	\$1,238.76	\$0.00	\$0.00	\$1,238.76	\$0.00	\$0.00	4/20/2018	\$0.00
2016	Tax	\$1,238.76	\$0.00	\$0.00	\$1,238.76	\$0.00	\$0.00	5/12/2017	\$0.00
2015	Tax	\$1,238.76	\$0.00	\$0.00	\$1,238.76	\$0.00	\$0.00	5/10/2016	\$0.00
2014	Tax	\$1,238.76	\$123.88	\$17.13	\$1,238.76	\$123.88	\$17.13	6/24/2015	\$0.00
2013	Tax	\$1,238.76	\$100.31	\$18.42	\$1,238.76	\$100.31	\$18.42	6/23/2014	\$0.00
2012	Tax	\$1,238.76	\$30.97	\$23.38	\$1,238.76	\$30.97	\$23.38	1/2/2014	\$0.00
2011	Tax	\$1,672.65	\$0.00	\$0.00	\$1,672.65	\$0.00	\$0.00	11/9/2011	\$0.00
2010	Tax	\$1,672.65	\$117.20	\$96.58	\$1,672.65	\$117.20	\$96.58	11/9/2011	\$0.00
2009	Tax	\$1,672.65	\$58.60	\$102.01	\$1,672.65	\$58.60	\$102.01	11/9/2011	\$0.00
2008	Tax	\$1,140.30	\$0.00	\$0.00	\$1,140.30	\$0.00	\$0.00	10/16/2008	\$0.00
2007	Tax	\$1,140.30	\$0.00	\$0.00	\$1,140.30	\$0.00	\$0.00	10/26/2007	\$0.00
2006	Tax	\$1,028.97	\$102.89	\$37.76	\$1,028.97	\$102.89	\$37.76	6/25/2007	\$0.00
2005	Tax	\$1,028.97	\$102.89	\$150.92	\$1,028.97	\$102.89	\$150.92	6/25/2007	\$0.00

DISCLAIMER: This data is provided without warranty of any kind, either expressed or implied, including but not limited to, the implied warranties of merchantability and fitness for a particular purpose. Any person, firm or corporation which uses this map or any of the enclosed information assumes all risk for the inaccuracy thereof, as the city of Lynchburg expressly disclaims any liability for loss or damage arising from the use of said information by any third party.

Recent Sales Information by Neighborhood COMMERCIAL - RETAIL Property Class

Parcel ID	Property Address	Recorded Sale Date	Sale Amount	Seller's Name	Buyer's Name	Document Num
04610006	1421 MAIN ST	9/24/2024	\$0	WEST, JENNY L	WEST, JENNY L ESTATE	240000266
04606008	1337 MAIN ST	1/18/2024	\$400,000	ELZA LLC	WEST ON MAIN LLC	240000262
04512011	718 COMMERCE ST	12/22/2023	\$0	LONE JACK CONTRACTING INC	CESAFSKY, JON TRS	230007505
02464008	1026 MAIN ST	12/6/2023	\$0	WOOD, THOMAS G	WOOD, DALE BENJAMIN	230000398
02466024	1101 MAIN ST	11/16/2023	\$250,000	STEMMER ENTERPRISES LLC	WEST ON MAIN LLC	230006751
02508007	1225 CHURCH ST	5/31/2023	\$0	1225 CHURCH LLC	1225 CHURCH STREET LLC	230003131
02464009	1024 MAIN ST	1/13/2023	\$820,000	HUMBOLDT SQUID PROPERTIES LLC	WU, XIANJIN & HUANG, LI FANG	230000216
04602006	1213 COMMERCE ST	6/10/2022	\$600,000	PENDLETON, DONALD G JR TRS &	COMMERCE STREET COLLABORATIVE LLC	220004655
02507011	414 12TH ST	1/28/2022	\$233,000	WADE, DANIEL D	AC CAPITAL LLC	220000781
04605001	1300 MAIN ST	1/10/2022	\$1	1300 MAIN LLC	HAGUE, DANIEL & POOLE, DAVID & RIEHL, LESLIE M	220000243
04605001	1300 MAIN ST	1/10/2022	\$1	HAGUE, DANIEL & POOLE, DAVID & RIEHL, LESLIE M	RISE UP PROPERTIES LLC & POOLE, DAVID & RIEHL, LESLIE M	220000244
04605001	1300 MAIN ST	1/10/2022	\$1,800,000	RISE UP PROPERTIES LLC & POOLE, DAVID & RIEHL, LESLIE M	RISE UP PROPERTIES LLC	220000245
02463008	1011 MAIN ST	7/22/2021	\$495,000	MARKETPLACE OF LYNCHBURG LLC	WEST ON CHURCH & MAIN LLC	210006576
02463013	1031 MAIN ST	7/22/2021	\$1,400,000	SCHEWEL GENERAL INVESTMENT PAR	WEST ON CHURCH & MAIN LLC	210006575
04606008	1337 MAIN ST	3/15/2021	\$0	MONK, JOSEPH H & CHARLENE W	ELZA LLC	210002252
04516007	1008 COMMERCE ST	5/26/2020	\$0	COMMERCE STREET PARTNERS LLC	JJIL LLC	200003382
04602011	1210 MAIN ST	2/13/2020	\$750,000	MCCRAW, BUSEY T JR & JUDY D	JMH DEVELOPMENT LLC	200001010
02508007	1225 CHURCH ST	12/5/2019	\$600,000	RISE UP PROPERTIES LLC	1225 CHURCH LLC	190007493
04605006	1306 MAIN ST	11/18/2019	\$950,000	FARMER'S SEED & SUPPLY CO INC	THIRTEEN MAIN HOLDINGS LLC	190007178
02463012	1021 MAIN ST	10/28/2019	\$0	SHALLOW CREEK ENTERPRISES LLC	1021 MAIN STREET LLC	190006676
02467006	1117 CHURCH ST	1/17/2019	\$0	THORNHILL, J TAYLOR III TRS	THORNHILL, WILLIAM EARNEST	190000299
02463012	1021 MAIN ST	7/26/2018	\$275,000	COBLE, GRAHAM V & JANIS L	SHALLOW CREEK ENTERPRISES LLC	180004673
04602005	1209 COMMERCE ST	6/20/2018	\$470,000	CALFEE, DARYL & CALFEE, JOHANNA &	JAY B AND B LLC	180003895
02467006	1117 CHURCH ST	5/29/2018	\$0	THORNHILL, J T III	THORNHILL, J TAYLOR III TRS	180003350
04602006	1213 COMMERCE ST	2/20/2018	\$0	PENDLETON, DONALD G JR &	PENDLETON, DONALD G JR TRS &	180000967
02466005	1103 MAIN ST	2/8/2018	\$118,250	PICKERAL, DOUGLAS B JR	H & B PROPERTIES LLC	180000755
02466025	1103 1/2 MAIN ST	2/8/2018	\$156,740	PICKERAL, DOUGLAS B JR	H & B PROPERTIES LLC	180000755
04516007	1008 COMMERCE ST	12/14/2017	\$0	JJIL LLC	COMMERCE STREET PARTNERS LLC	170007907
02466023	1104 CHURCH ST	10/4/2017	\$0	BRYANT, C PRESTON & BRYANT, STEPHEN	BRYANT, STEPHEN A & JAMIE W	170006284
02466023	1104 CHURCH ST	9/22/2017	\$30,000	BRYANT, C PRESTON	BRYANT, C PRESTON & BRYANT, STEPHEN	170005961

DISCLAIMER: This data is provided without warranty of any kind, either expressed or implied, including but not limited to, the implied warranties of merchantability and fitness for a particular purpose. Any person, firm or corporation which uses this map or any of the enclosed information assumes all risk for the inaccuracy thereof, as the city of Lynchburg expressly disclaims any liability for loss or damage arising from the use of said information by any third party.

Improvement: FEDERAL HOUSE ANTIQUES

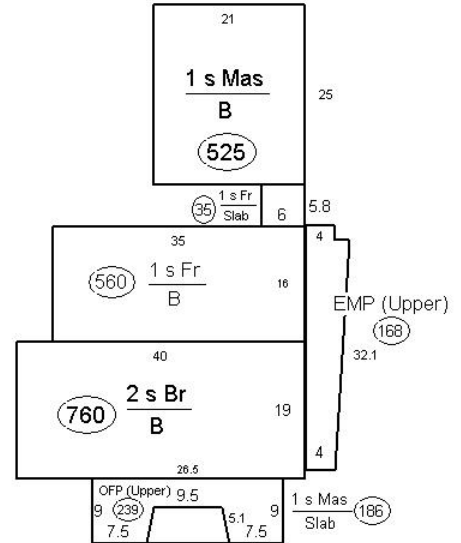

General Retail:001

Year: 1850
Size: 4671
Stories: 2

Heated Area: 0
Frame: Wood Frame
Roof Description: METAL
Rooms: 2

Feature: Open Frame Porch
Feature Size: 239
Feature: Enclosed Masonry Porch
Feature Size: 168

The City of Lynchburg, VA

Legend

- Addresses
- Street Labels
-  wPressureZone
-  Ingress Egress
-  Prescriptive
-  Private Road
-  Cluster Open Space
-  Stream Restoration
-  Conservation, Agriculture
-  Conservation, Forest
-  Historic, Agriculture
-  Other
-  Legal Lot Lines
-  Vacated Right of Way
-  Parcels
-  Owner Undetermined
-  Survey Gap
-  Assessed By County

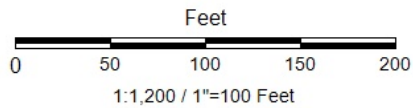
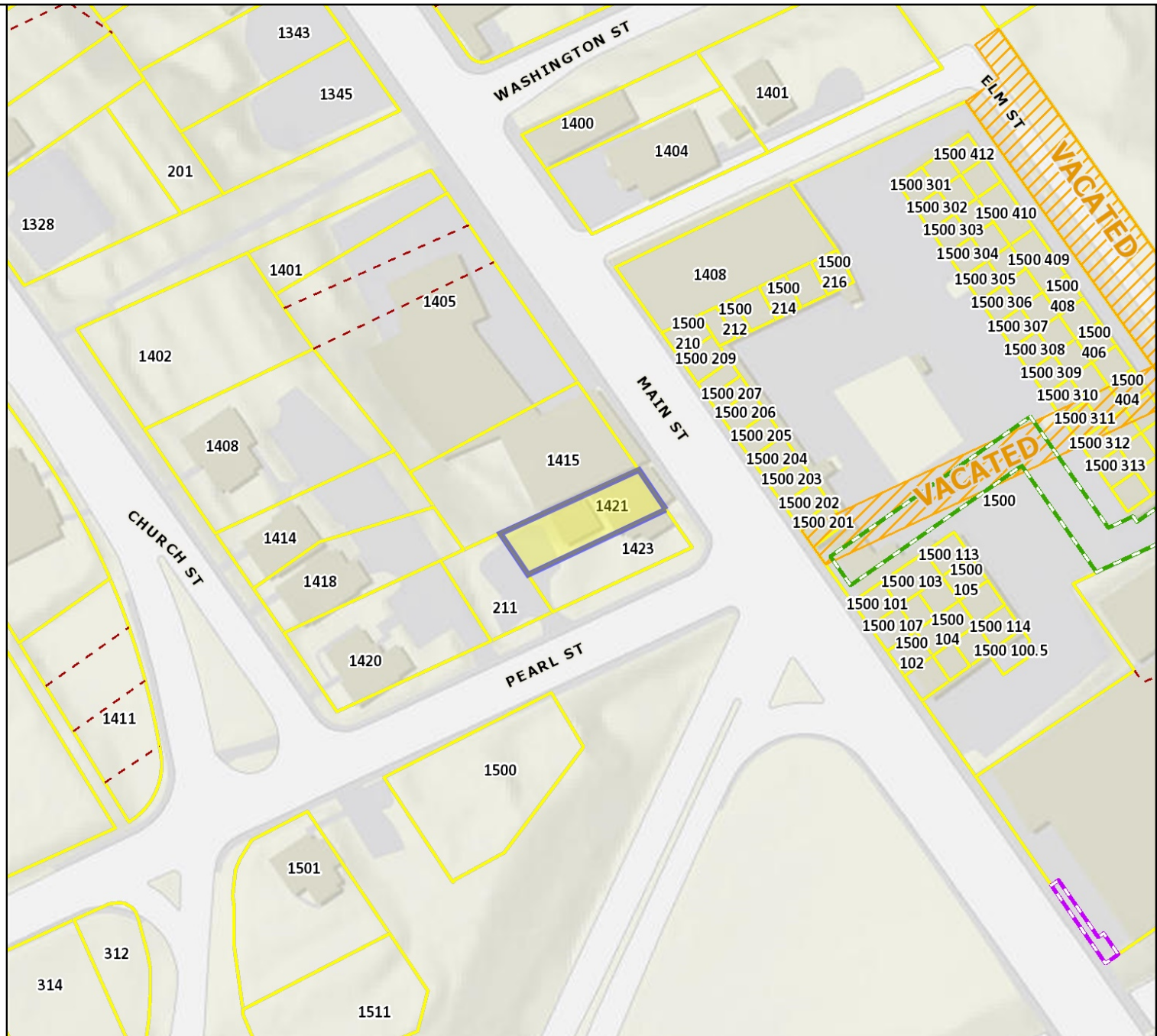

Parcels

8/27/2025

DISCLAIMER: This drawing is neither a legally recorded map nor a survey and is not intended to be used as such. The information displayed is a compilation of records, information, and data obtained from various sources, and the City of Lynchburg is not responsible for its accuracy or how current it may be.

