

Print Date: 11/04/2023

# SCOTT COUNTY VA

**Map#:** 147 A 74  
**Acreage:** 140.00  
**Record:** 4250 **Card:** 1  
**Sale Price:** 0  
**Grantor:** PORTER, MELINDA

**Owner:** PORTER, MELINDA LEE  
**911 Adr:** 1927 NOTTINGHAM RD  
**GIS Pin:**  
**Sale Date:** 11 / 1 / 1994 **Ratio:** 0



**Occupancy:** DWELLING **Interior Walls:** UNKNOWN **Stories:** 2.00  
**Right of Way:** PUBLIC **Year Built:** 1900 **Age:** 122  
**Pavement:** GRAVEL **Flooring:** VINYL **Public Gas:** N **Electric:** Y  
**Terrain:** ABOVE **Foundation:** BRICK  
**Characteristic:** ROLLING/SLOPING **Total Rooms:** 7 **Exterior Walls:** FRAME  
**Water Source:** WELL **Bed Rooms:** 2  
**Sewer:** SEPTIC **Bath Rooms:** 1 F / 0 H **Roof Type:** GABLE  
**Zoning:** **Heat Type:** HEAT PUMP **Roofing:** COMP SHG  
**Use Class:** 6 AGR/UNDEV 100 **Fuel:** ELECTRIC **Air Condition:** Y

Land Description	Unit Size	Unit Value	Methd	Unit Adj	Unit Total	Uty Value
HOMESITE	1.000	15,000	H	0	15,000	8,000
CUTOVER	120.000	500	P	0	60,000	0
WOODED	19.000	800	P	0	15,200	0

Improvement	Length	Width	Condition	Deprc.	Total Value
MH HOOKUP	0.0	0.0	A	0	4,000
SHEDS-MISC	0.0	0.0	P	0	0
PORCH-MH	20.0	8.0	A	0	1,120

Description	Story	Size	Class	Factor	Rate	Value
A - BASE SECTION	2.00	1,280	C	0.00	0.00	0
B - ADDITION	1.00	676	C	0.00	0.00	0
C - PORCH	2.00	192	C	0.00	25.00	4,800

## Structural Element

	% Area	Area SF	Rate SF		
Building		1,956 @	54.11 =		105,839
Basement		NONE @	=		0
Fin, Bsmt.	0.00	0 @	0.00 =		0

**Bath Rooms:** 1 F / 0 H **Plumbing Value:** -2,000  
**Heat Type:** **Heating Value:** 0  
**Air Condition:** Y **A/C Value:** 4,401  
**0 FP, 0 Stack, NV** **Fireplace Value:** 0  
**0 Flue, 0 Stack, 0 Metal** **Flue Value:** 0  
**Built in Garage:** 0  
**Interior Improvements:** 0  
**Total S/W/Landscape:** 0  
**Extra Kitchen Value:** 0  
**Total Structure Addition:** 4,800

**Sub Total:** 113,040

**Adj Factor:** 0.00 **Adj. Fctor:** 1.00 **113,040**  
**Class:** C **Phys. Depr.** 0.60 **-67,824**  
**Condition:** P **Func. Depr.** 0.00 **0**  
**Year Built:** 1900 **Econ. Depr.** 0.00 **0**  
**Age:** 122 **Fair Value** N/A

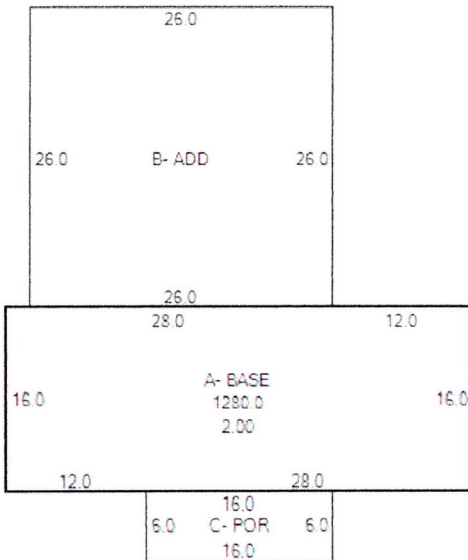

**Instrument #**  
0 0  
**Deed Book**  
541 - 1671  
**User Codes:**  
M  
R  
**Date Inspected**  
9212021  
**At Home**  
O  
**Initials**  
RC

Value Summary		Total Main Structure:	45,200
<b>Date of Value</b>	1 / 1 / 2022	<b>NbrHood Adj.</b>	0.00 0
		<b>Perc Comp.</b>	0.00
		<b>L/S Adj.</b>	N/A 0
		<b>Total Other</b>	5,120
<b>% Chg</b>	0.1227 Bldg	<b>Total Imp.</b>	50,300
	-0.066 Land	<b>Total Land</b>	98,200
	<b>Total</b> 150,000	<b>Total Prop.</b>	148,500
		<b>Land Use Value</b>	0

Remarks: MH ON SITE

RED TAG-ADDN TO BE RAZED; NO CHG