

**Summary**

Parcel ID 0820030  
 Tax ID 0820030  
 Neighborhood 10  
 Property Address 301 Mansion Dr  
 Hopewell, VA 23860  
 Legal Description LOTS 9 TO 12 & PT OF 13-16-17 BLK 2 SUBDIVISION: WESTOVER HILLS  
 (Note: Not to be used on legal documents)  
 Acreage N/A  
 Class 1 - 1 Single Family Urban  
 Tax District/Area 03

[View Map](#)



**Owner**

Primary Owner  
 Weyland Anthony J III Or Amanda M  
 301 Mansion Dr  
 Hopewell, VA 23860

**Site Description**

Zoning R1

**Land**

Land Type	Soil ID	Actual Front	Acreage	Effect. Front	Effect. Depth	Prod Factor	Depth Factor	Meas Sq Ft	Base Rate	Adj Rate	Extended Value	Influ. Factor	Value
Homestead		100.000	0.000	100.000	142.000	1.00	1.12		45,000.00	45,000.00	40,500.00	L -8%	37,300.00

Land Detail Value Sum 37,300.00

**Residential Dwellings**

Card 01  
 Residential Dwelling 1  
 Occupancy  
 Story Height 1.0  
 Roofing Material: Asphalt shingles  
 Attic None  
 Basement Type 3/4  
 Basement Rec Room None  
 Finished Rooms 7  
 Bedrooms 3  
 Family Rooms 0  
 Dining Rooms 1  
 Full Baths 1; 3-Fixt.  
 Half Baths 1; 2-Fixt.  
 4 Fixture Baths 0; 0-Fixt.  
 5 Fixture Baths 0; 0-Fixt.  
 Kitchen Sinks 1; 1-Fixt.  
 Water Heaters 1; 1-Fixt.  
 Central Air Yes  
 Primary Heat Forced hot air  
 Extra Fixtures 0  
 Total Fixtures 7  
 Fireplace Yes  
 Features Masonry fireplace  
 Porches and Decks Open Masonry Porch 144  
 Yd Item/Spc Fture/Outbldg Wood frame w/sheathing Residential Shed - Small Utility 120 SF  
 Last Updated 2/3/2021

Construction	Exterior Cover	Floor	Base Area (sf)	Fin. Area (sf)
Wood frame	Brick	1.0	1603	1603
Concrete block		B	1173	0
	Crawl		392	0
	Total		2776	1603

## Improvements

Card 01

ID	Use	Stry Hgt	Const Type	Grade	Year Const	Eff Year	Cond	Base Rate	Features	Adj Rate	Size/ Area	Cost Value	Phys Depr	Obsol Depr	Mrkt Adj	% Comp	Value
D	DWELL			C+	1953	1972	AV	0.00	MAS	0	1603	215660	30	0	92	100	125000
01	UTLSHED	10	Wood frame w/sheathing	C	2018	2018	G	15.20		15.2	10 x 12	1820	0	0	92	100	1700

## Transfers

Date	Owner 1	Owner 2	Book & Page	Document #	Amount
2/17/2006	WEYLAND ANTHONY J OR JUDITH R			060000574	\$84,000
6/1/1999			324/608		\$55,000
11/1/1953			001/001		\$1

## Valuation

Assessment Year		01/01/2021	01/01/2019	01/01/2017	01/01/2015	01/01/2013
Reason for Change		Reassessment	Reassessment	Reassessment	Reassessment	Reassessment
<b>VALUATION</b>	Land	\$37,300	\$40,500	\$40,900	\$40,900	\$41,900
<b>(Assessed Value)</b>	Improvements	\$126,700	\$95,300	\$101,300	\$110,700	\$112,700
	<b>Total</b>	<b>\$164,000</b>	<b>\$135,800</b>	<b>\$142,200</b>	<b>\$151,600</b>	<b>\$154,600</b>

## Photos



## Sketches

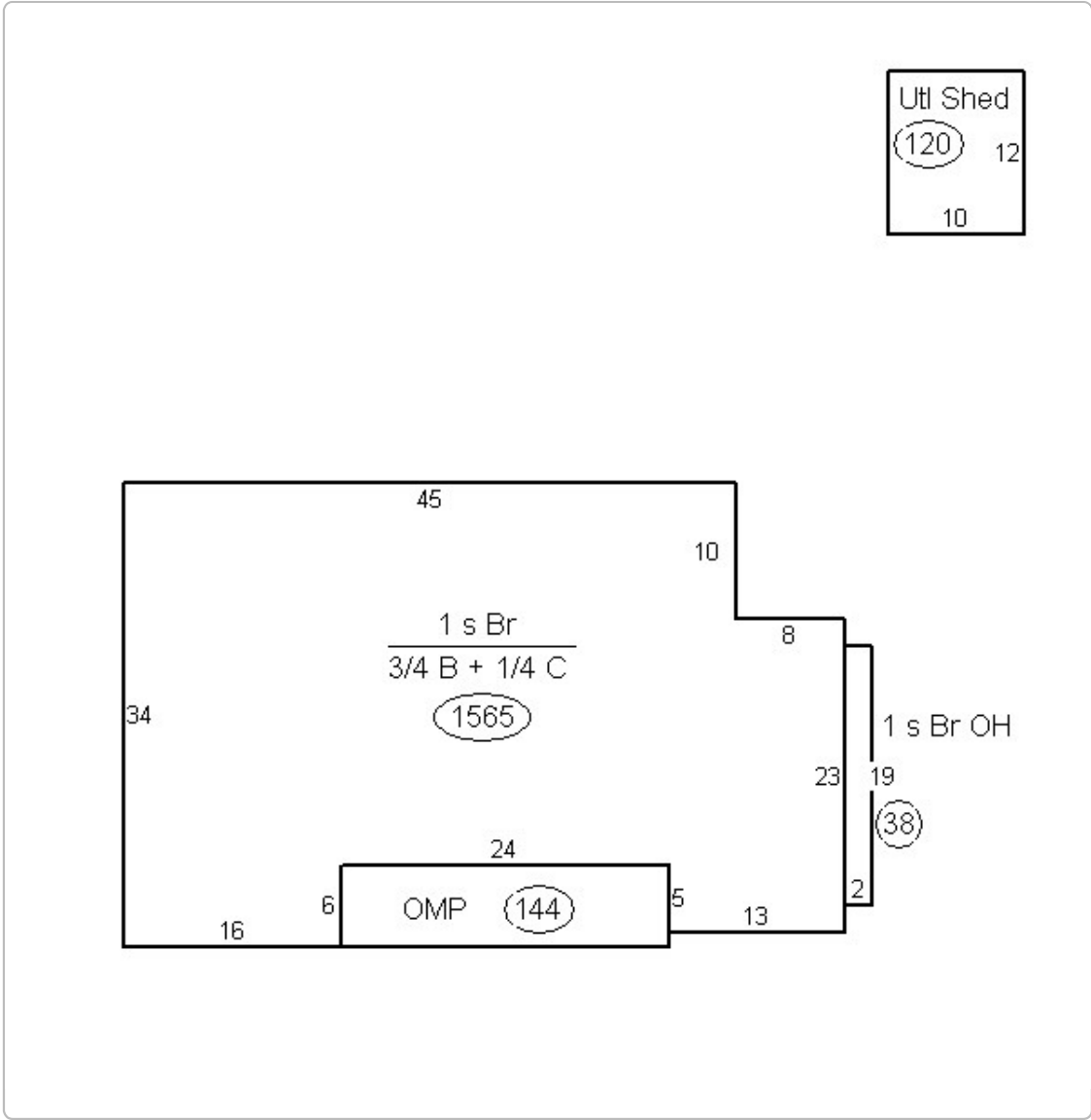

No data available for the following modules: Commercial Buildings.

The City of Hopewell Assessor's Office makes every effort to produce the most accurate information possible. No warranties, expressed or implied, are provided for the data herein, its use or interpretation.

[User Privacy Policy](#)  
[GDPR Privacy Notice](#)

Last Data Upload: 9/26/2022, 5:35:29 AM

Version 2.3.223

Developed by  
 Schneider  
 GEOSPATIAL