

**Layer: Parcels**  
**Link:** 86-14A  
**LRS Num:** 15643  
**RPC:** 25685  
**Loc.Addr.:** 4919 CATAWBA RD  
**Loc.City:** TROUTVILLE  
**Loc.Zip:** 24175  
**Owner1:** NIXON PROPERTIES LLC  
**Mail Addr:** 335 KEESLING AVE  
**Mail City:** SALEM  
**Mail State:** VA  
**Mail Zip:** 241532128  
**Tax Acct.:** 86-14A  
**Legal Acres:** 0.2  
**PCDesc:** B-2  
**Zoning:** 27  
**Legal:** MT UNION  
**Land Value:** 36000  
**Bldg Value:** 138600  
**Total Value:** 174600  
**Sale Date:** 11/03/1999  
**Doc1 Ref:** 576 1344  
**Doc2 Ref:** 576 1344  
**Electric:** Y  
**Street Type:** Paved  
**Num.Other:** 7  
**Num.Imp.:** 7

<b>Layer: Elementary School</b>	<b>Name:</b> Greenfield Elementary
<b>Layer: Middle School</b>	<b>Name:</b> Read Mountain MS
<b>Layer: High School</b>	<b>Name:</b> Lord Botetourt HS
<b>Layer: Elec.Service Area</b>	<b>Company:</b> American Electric Power
<b>Layer: Rescue</b>	<b>RESC_DESC:</b> Fincastle
<b>Layer: Fire</b>	<b>FIRE_DESC:</b> Fincastle
<b>Layer: Magisterial Dist.</b>	<b>Dist. Name:</b> AMSTERDAM
<b>Layer: Trash Hauler</b>	<b>Haulers:</b> Kelley's Garbage Collection Service, LLC
<b>Layer: VA House District</b>	<b>SLDLST10:</b> 019

**Disclaimer:** The information contained on this page is NOT to be construed or used as a survey or legal description. Map information is believed to be accurate but accuracy is not guaranteed.

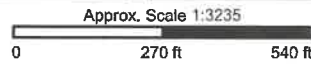

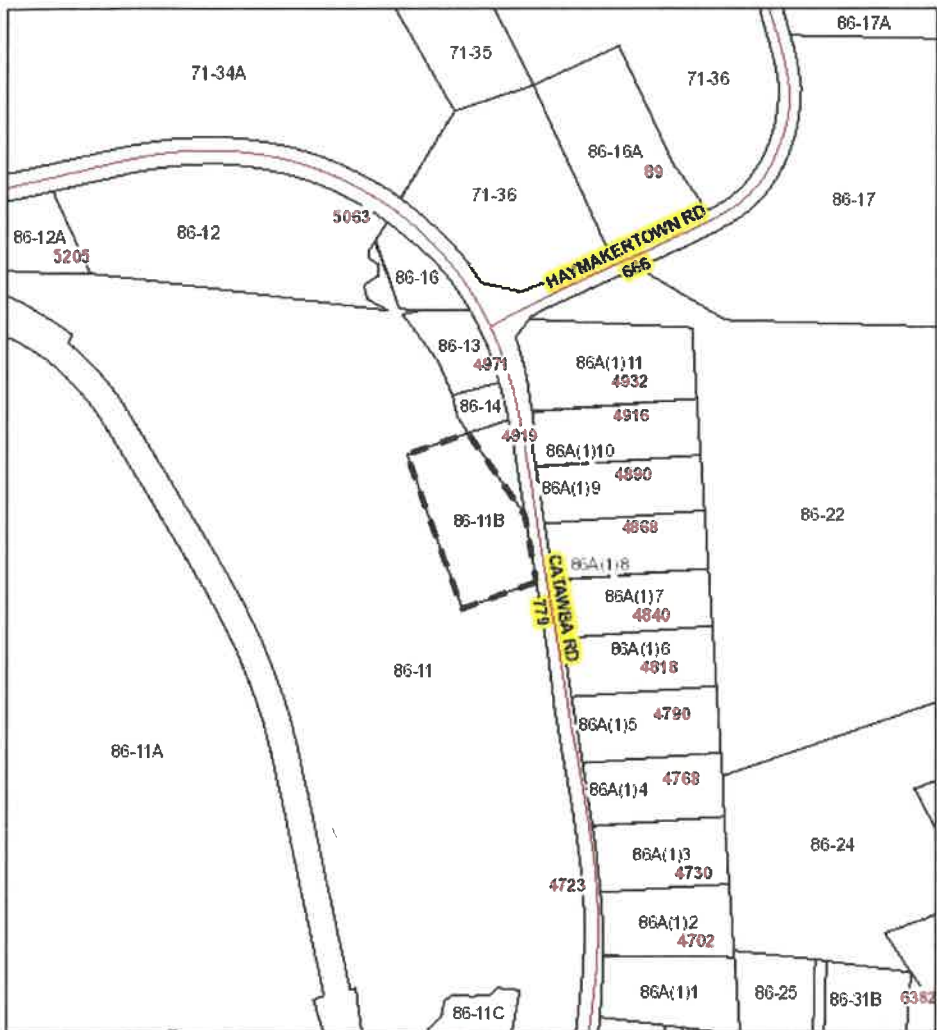

**Disclaimer:** The information contained on this page is NOT to be construed or used as a survey or legal description. Map information is believed to be accurate but accuracy is not guaranteed.

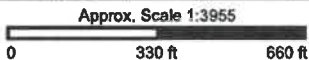

**Layer: Parcels**

**Link:** 86-11B  
**LRS Num:** 15637  
**RPC:** 25679  
**Loc.Addr.:** CATAWBA RD  
**Loc.City:** TROUTVILLE  
**Loc.Zip:** 24175  
**Owner1:** NIXON PROPERTIES LLC  
**Mail Addr:** 335 KEESLING AVE  
**Mail City:** SALEM  
**Mail State:** VA  
**Mail Zip:** 241532128  
**Tax Acct.:** 86-11B  
**Legal Acres:** 1.46  
**PCDesc:** B-2  
**Zoning:** 27  
**Legal:** MT UNION  
**Land Value:** 43800  
**Total Value:** 43800  
**Sale Date:** 11/03/1999  
**Sale Amt.:** 185000  
**Doc1 Ref:** 576 1344  
**Electric:** Y  
**Street Type:** Paved

<b>Layer: Elementary School</b>	<b>Name:</b> Greenfield Elementary
<b>Layer: Middle School</b>	<b>Name:</b> Read Mountain MS
<b>Layer: High School</b>	<b>Name:</b> Lord Botetourt HS
<b>Layer: Elec.Service Area</b>	<b>Company:</b> American Electric Power
<b>Layer: Rescue</b>	<b>RESC_DESC:</b> Fincastle
<b>Layer: Fire</b>	<b>FIRE_DESC:</b> Fincastle
<b>Layer: Magisterial Dist.</b>	<b>Dist. Name:</b> AMSTERDAM
<b>Layer: Trash Hauler</b>	<b>Haulers:</b> Kelley's Garbage Collection Service, LLC
<b>Layer: VA House District</b>	<b>SLDLST10:</b> 019