

Owner

BRUNSON DONALD
237 MOUNT LAUREL DR
DALLAS, GA 30132

Summary

Parcel Number 139.3.3.066.0000
 Account/Realkey 56347
 Location Address 237 MT LAUREL DR
 Zip Code 30132
 (Note: Not to be used on legal documents)
 Class R3-Residential
 (Note: This is for tax purposes only. Not to be used for zoning.)
 Zoning
 Tax District DALLAS
 Millage Rate 33.87
 Acres 0.27
 Neighborhood BLUE RIDGE PARK (007770)
 Homestead Exemption Yes
 Landlot / District / Section 409 / 2 / 3
 Subdivision BLUE RIDGE PARK
 Lot # 21



Accessory Information

Description	Year Built	Dimensions/Units	Identical Units
PAVING - CONCRETE	2006	0x0 / 830	1

Land

Type	Description	Calculation Method	Square Footage	Frontage	Depth	Acres	Lots
Residential	RES 30	Lot	0	0	0	0.27	1

Residential Improvement Information

Style	2 Story
Heated Square Feet	1874
Interior Walls	Drywall
Exterior Walls	Vinyl Siding
Foundation	Poured Concrete
Attic Square Feet	0
Basement Square Feet	782 Unfinished
Year Built	2006
Roof Type	Composition Shng
Flooring Type	Carpet / Vinyl
Heating Type	Forced Air Gas/AC
Number Of Rooms	5
Number Of Bedrooms	3
Value	\$183,400
Condition	Average
Fireplaces\Misc	Bath - Full 2 Bath - Half 1
House Address	One Plus Story Prefabricated F 1 237 MT LAUREL DR

Valuation

	2021
Previous Value	\$214,700
Land Value	\$30,000
+ Improvement Value	\$182,300
+ Accessory Value	\$1,100
= Current Value	\$213,400

Photos



Sketches

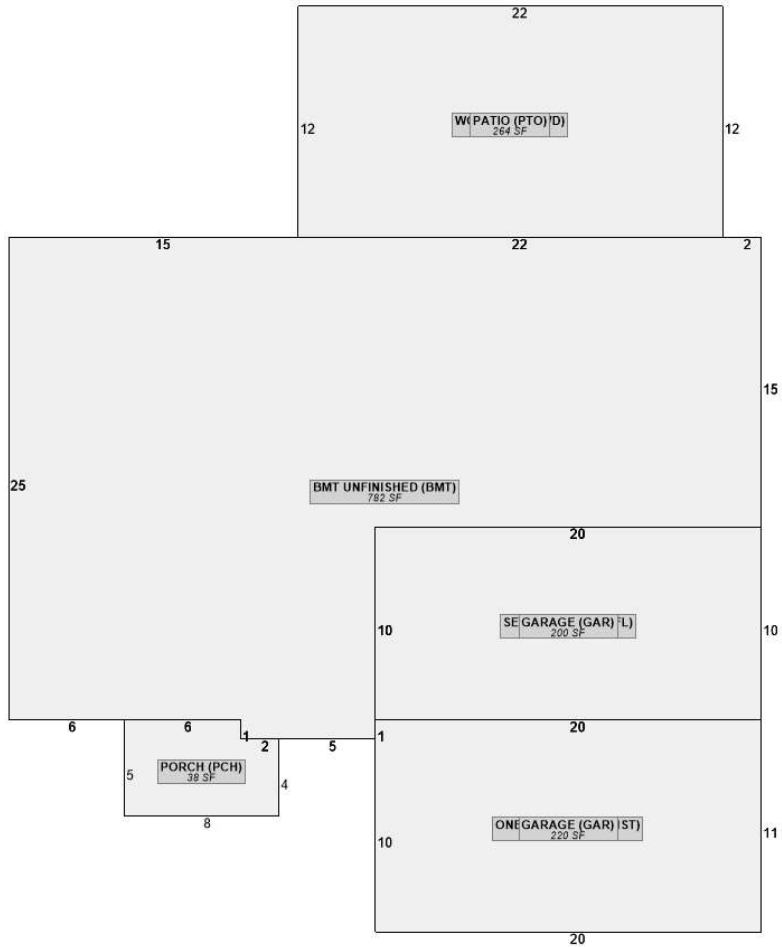

Sales

Sale Date	Deed Book / Page	Plat Book / Page	Sale Price	Reason	Grantor	Grantee	Instrument
1/22/2013	3102 / 319	38 / 41	\$82,000	JG	SECRETARY OF HOUSING & URBAN DEVELOPMENT	BRUNSON DONALD	SWD
7/3/2012	3069 / 908	38 / 41	\$174,136	B	BANK OF AMERICA NA	SECRETARY OF HOUSING & URBAN DEVELOPMENT	SWD
7/3/2012	3044 / 758	38 / 41	\$174,136	F	SHANK JONES RAKESHA L	BANK OF AMERICA NA	DUP
6/30/2006	2199 / 366	38 / 41	\$152,900	Z	LIFESTYLE HOMEBUILDERS LLC	SHANK RAKESHA L	LWD
7/30/2002	1203 / 480	38 / 41	\$34,000	M	LARRY HUNTER DEVELOPMENT CO INC	LIFESTYLE HOMEBUILDERS LLC	WD

No data available for the following modules: Rural Land, Conservation Use Rural Land, Commercial Improvement Information, Mobile Homes, Prebill Mobile Homes.

The Assessor's Office makes every effort to produce the most accurate information possible. No warranties, expressed or implied, are provided for the data herein, its use or interpretation.

The assessment information is from the last certified tax roll. All data is subject to change before the next certified tax roll.

[User Privacy Policy](#)

[GDPR Privacy Notice](#)

[Last Data Upload: 1/25/2022, 7:02:57 PM](#)

Developed by



Version 2.3.173