

**Composite Summary**

Parcel Number 16120500460  
 Location Address 64 WORTHINGTON DR NE  
 Property Class R3 - Residential Lots  
 Total Acres 0  
 Total Land SqFt 0  
 Neighborhood 16070113 - SEWELL MANOR  
 Tax District (9) UNINCORPORATED  
 Subdivision 0113-SEWELL MANOR

[View Map](#)



**Owner**

Mccurley Martha C  
 64 WORTHINGTON DR  
 MARIETTA GA 30068

**Appraised Values**

Year	Property Class	LUC	Appraised Land	Appraised Building Value	Total Appraised Value
2021	R3	101	\$50,000	\$202,880	\$252,880

[⊞ Show Historical Appraised Values](#)

**Assessed Values**

Year	Assessed Land	Assessed Building Value	Total Assessed Value
2021	\$20,000	\$81,152	\$101,152

[⊞ Show Historical Assessed Values](#)

**Residential Improvement Information**

Card 1  
 Stories 1.7  
 Exterior Wall 2 SIDE BRICK OR STONE  
 Style TWO STORY  
 Basement CRAWL  
 Res Sq Ft 2715  
 Rec Room 0  
 Finished Bsmt Sqft 0  
 Year Built 1966  
 Total Rooms 7  
 Bedrooms 4  
 Bathrooms 1  
 Half Bathrooms 1  
 Fireplaces 0  
 Att Garage Sq Ft 0  
 Bsmt Garage (# of Cars)

**Accessory Information**

Card 1

Description	Year Built	Area
DET GARAGE	2006	528
FRAME SHED	2006	336

**Permits**

Date	Number	Amount	Purpose	Status
08/25/2005	0509851	\$0	REPERMIT	C - Closed Permit
06/10/2005	0506443	\$7,920	ADDITION	C - Closed Permit

Photos



Sketches

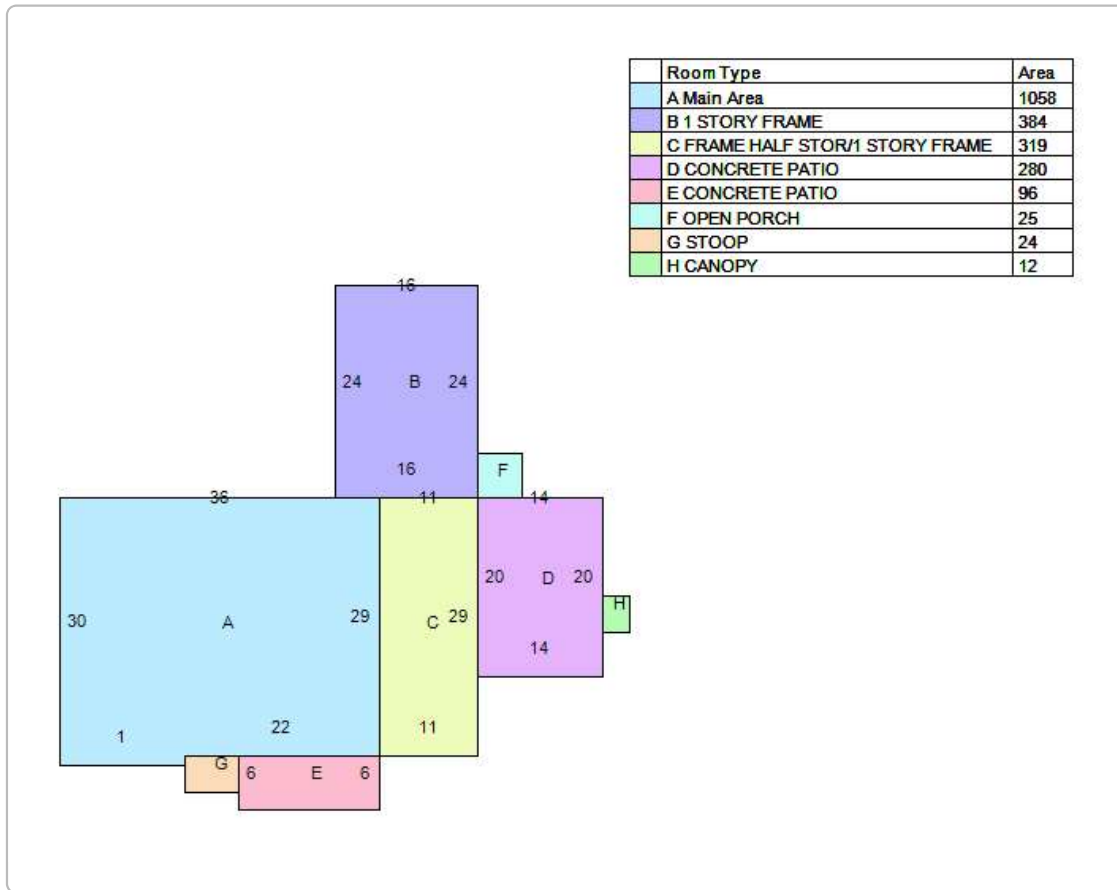

No data available for the following modules: 2021 Undeliverable Notices, Upcoming Visits, Summary - Personal Property, Appraised Values - Personal Property, Commercial Improvement Information, Appeals, Sales Information.

Ownership and characteristic data are the most current information available. All appraised/assessed values are as of Jan 1, 2020.

[User Privacy Policy](#)  
[GDPR Privacy Notice](#)

Last Data Upload: [10/4/2021, 2:39:16 AM](#)

Developed by  
 Schneider  
 GEOSPATIAL

Version 2.3.150