

PROPERTY ADDRESS:
136 SEVEN FORKS TRAIL
MARTIN, GA 30557

NOTE:
I.P.S. = Iron Pin Set
I.P.F. = Iron Pin Found
C.M.F. = Concrete Marker Found
C.M.S. = Concrete Marker Set
PL = Property Line
CL = Center Line
T.L. = Traverse Line

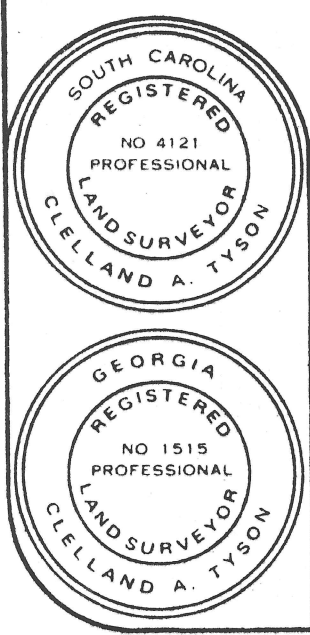

GRAPHIC SCALE

SURVEY FOR:

JOHN W. HALL & SHARON L. HALL

LOT 7, SECTION 1,
SEVEN FORKS CROSSING
TOWNSHIP:
GMD: MARTIN, GA
COUNTY: STEPHENS, GA
SURVEYED: 25 AUG. 1986
SCALE: 1" = 100'

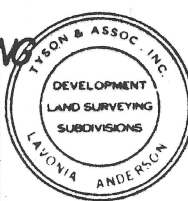

REVISED:
CC: BT
DRWN: PA
CHKD: CT
JOB NO. 6319
FILE NO:

IN MY OPINION THIS IS A CORRECT REPRESENTATION OF
LAND PLATTED AND HAS BEEN PREPARED IN CONFORMITY
WITH MINIMUM STANDARDS AND REQUIREMENTS OF LAW.

Signature

MEM. GA. ASSN. REG. LAND SURVEYORS LOCATION MAP