

# Henry County, GA

## Summary

Parcel ID 117-03005000  
Location Address 1573 CRUMBLEY RD  
Millage Group 0001 (County/UnIncorp)  
Property Usage S F RESIDENTIAL (0100)  
Total Acres 2.69  
Landlot / District 42 / 11  
Subdivision  
Lot/Block  
Plat Book  
Plat Page

Exemptions: L9

## Owners

PLANT R MILTON  
1573 CRUMBLEY ROAD  
MCDONOUGH, GA 30252

## Valuation

	2023	2022	2021
+ Building Value	\$322,200	\$265,600	\$229,300
+ OB/Misc	\$20,300	\$20,700	\$21,100
+ Land Value	\$37,800	\$34,900	\$29,900
= Total Assessment	\$380,300	\$321,200	\$280,300

Exemptions: L9

## Assessment Notices 2024

[2024 Assessment Notice \(PDF\)](#)

## Land Information

Land Use	Number of Units	Unit Type
SMALL AC IMP (000180)	2.69	ACRES

## Buildings

Building # 1  
ConstructionType SGL FAM  
Actual Year Built 1986  
Effective Area 3,720  
Heated Area 2,325  
Bedrooms 3  
Baths 2  
Wall Height 0

## Miscellaneous Data

Description	Length	Width	Units	Year Built
B-45	0	0	1,088	1985
BAY - C	0	0	1	1986
B-21	0	0	2,025	2001
B-45	0	0	576	2001

## Sales Information

Sale Date	Deed Book/Page	Sale Price	Instrument	Reason	Grantor	Grantee
3/11/2021	17975-151	\$0	AFFIDAVIT	D OF ASSNT	PLANT R MILTON & ISABEL Z	PLANT R MILTON
5/1/1983	521-276	\$6,800	WARRANTY DEED			PLANT R M & ISABEL Z

## Map



## Generate Owner List by Radius

The Property Address option is unavailable for Henry County

Distance:

100

Fee



### Use Address From:

Owner  Property

Select export file format:

Address labels (5160)



Show All Owners

Show Parcel ID on Label

Skip Labels

0

International mailing labels that exceed 5 lines are not supported on the Address labels (5160). For international addresses, please use the xlsx, csv or tab download formats.

Download

## Sketches

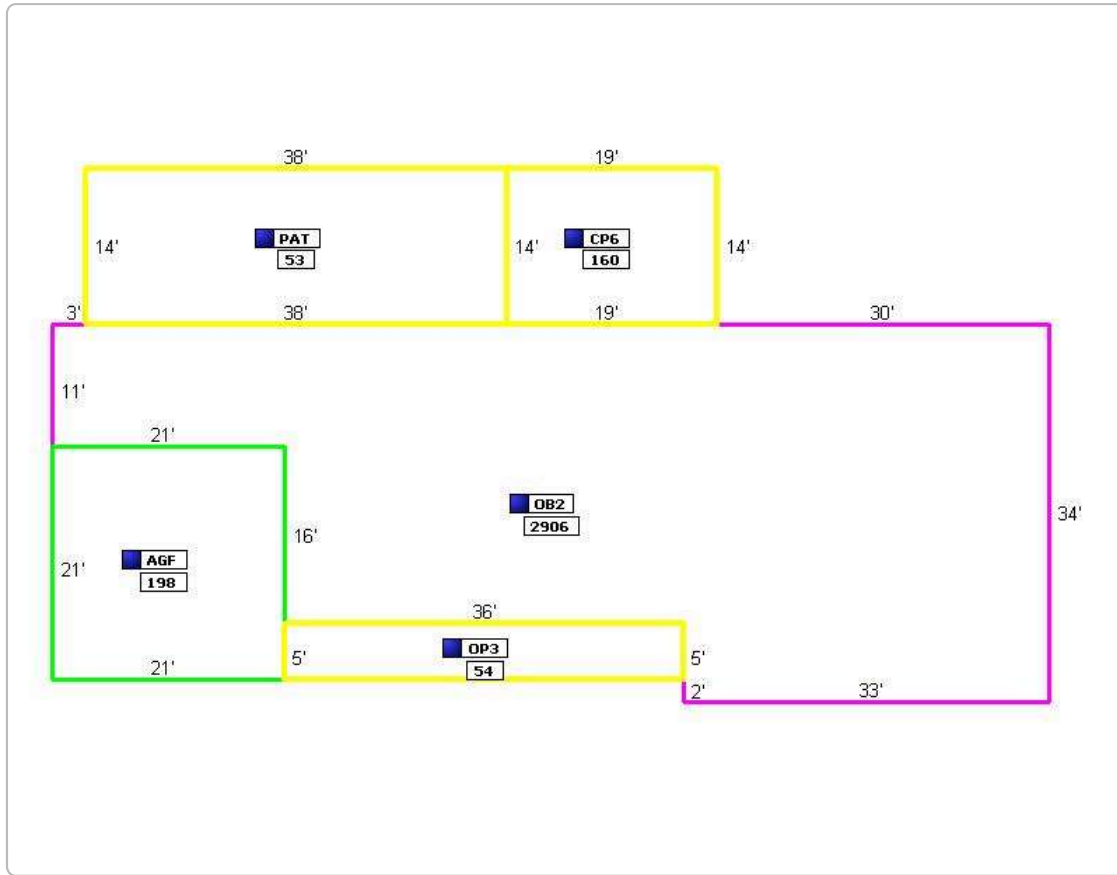

Data contained on this website represent a work in progress toward completion of the annual tax digest. As such, data is subject to change at any time. Ownership and map information correspond with the most current information processed by our office. Search deed records at the Henry County Courthouse to ensure the most current ownership information. Parcel lines depicted on the maps do not reflect a true and exact representation of property boundaries. Contact 770-288-7526 to verify zoning.

| [User Privacy Policy](#) | [GDPR Privacy Notice](#)  
 Last Data Upload: 5/18/2024, 3:56:54 PM

[Contact Us](#)

Developed by  
 **Schneider**  
 GEOSPATIAL