

HOUSE LOCATION
 LOT 7A
 LORDWILLING FARM SUBD.
 STEVENSBURG MAG. DISTRICT
 CULPEPER COUNTY, VIRGINIA

SCALE: 1" = 200' JUNE 12, 1995

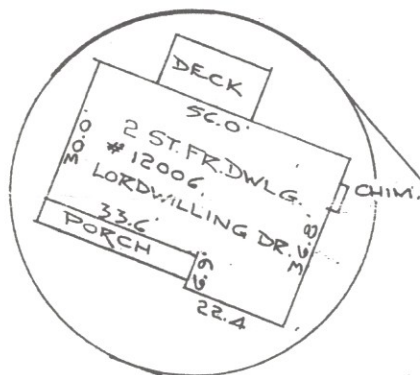
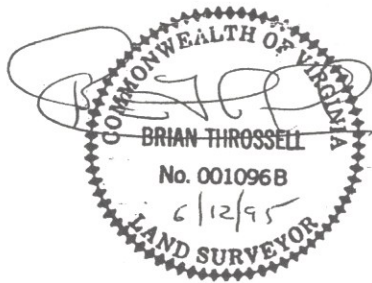

Boundary data taken from a plat in Plat Cabinet 3, Slide 114.

This course should be
 S.68°44'21"W., 71.70'

Improvements shown have been located by field survey and, unless otherwise indicated, there are no apparent encroachments either way across the property lines. Visible easements are shown, and the dwelling is not in a H.U.D. defined Flood Hazard Area.

	1	2
RAD.	254.31'	455.93'
ARC	12.51'	165.16'
DELTA	2°49'05"	20°45'18"

BRIAN THROSSELL
 LAND SURVEYOR
 CULPEPER, VIRGINIA

This survey has been prepared without the benefit of a Title Report and does not therefore necessarily indicate all encumbrances on the property.

