

City of Chesapeake, Virginia

Parcel Number: 0482001000070
Property Address (Primary): 448 BATTLEFIELD BLVD N
 CHESAPEAKE , 23320
Parcel Class: 4353
Parcel Class Description: COMMERCIAL - RETAIL

Summary

Property Owner	CHURCHLAND JWLRS & PAWN SHOP INC
Owner Address Address	448 BATTLEFIELD BLVD N STE B CHESAPEAKE , VA 23320-3992
Zoning	B2: General Business
Acreage	0.263
Legal Description	OAK GROVE .263 AC

Site Information

Neighborhood Number	0001
Neighborhood Description	COMMERCIAL
Borough:	WASHINGTON
Building Name	CHURCHLAND JEWELERS & PAWN
Frontage Length	144.88
Other Dimensions	X89.60X100.16X96.80
Land Use Participant	No

Assessment Information

Date	Fiscal Year	Land Value	Land Use Value	Improvement Value	Total Value
7/1/2019	2020	\$210,400		\$346,600	\$557,000
7/1/2018	2019	\$184,100		\$345,200	\$529,300
7/1/2017	2018	\$157,800		\$345,200	\$503,000
7/1/2016	2017	\$157,800		\$345,200	\$503,000
7/1/2015	2016	\$144,700		\$321,400	\$466,100
7/1/2014	2015	\$144,700		\$321,400	\$466,100
7/1/2013	2014	\$124,900		\$137,600	\$262,500
7/1/2012	2013	\$124,900		\$137,600	\$262,500
7/1/2011	2012	\$124,900		\$128,800	\$253,700
7/1/2010	2011	\$124,900		\$123,900	\$248,800
7/1/2009	2010	\$124,900		\$128,800	\$253,700
7/1/2008	2009	\$118,400		\$127,900	\$246,300
7/1/2007	2008	\$105,200		\$99,000	\$204,200
7/1/2006	2007	\$92,100		\$89,000	\$181,100
7/1/2005	2006	\$78,900		\$89,000	\$167,900

Ownership Information

Buyer Name	Seller Name	Sale Date	Sale Amount	Deed Book	Deed Page	Map Book/Page
CHURCHLAND JWLRS & PAWN SHOP INC	BARNARD PROPERTIES LLC	10/22/2013	\$415,000	9245	408	12240183
BARNARD PROPERTIES LLC	LOXLEY JEAN F	2/10/2005	\$	5838	188	12240183
LOXLEY JEAN F	LOXLEY SIDNEY S & JEAN F	3/24/1993	\$	2881	219	12240183
LOXLEY SIDNEY S & JEAN F	GRUCHACZ STEVEN T & LYNDA S	4/1/1982	\$	1945	351	12240183
GRUCHACZ STEVEN T & LYNDA S	GRUCHACZ STEVEN T & LYNDA S	3/17/1980	\$65,000	1881	552	12240183
GRUCHACZ STEVEN T & LYNDA S	HODGES H LEON TRUSTEE	3/17/1980	\$65,000	1881	552	00730011
HODGES H LEON TRUSTEE		7/25/1973	\$	1663	705	00000000

Commercial Improvement

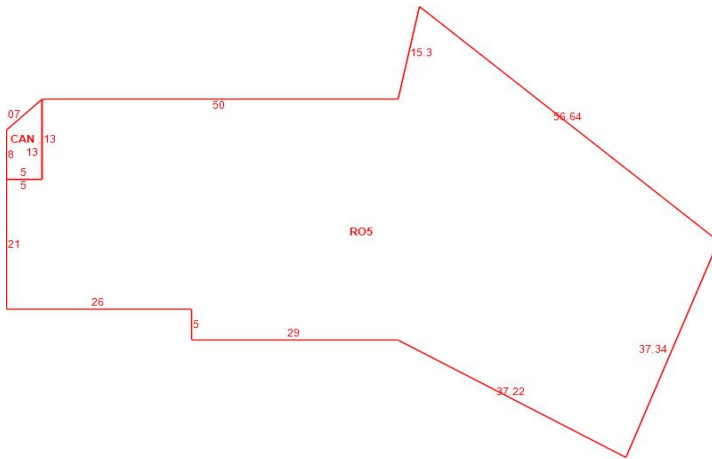

Year Built :	1961
Effecie Size:	5825
Number of Stories :	1.5
Elevator :	
Number of Elevators :	
HVAC/AC :	
HVAC/AC 2 :	
HVAC/AC 3 :	

Front Wall :	
Front Wall 2:	
Side Wall :	
Side Wall 2 :	
Rear Wall :	
Rear Wall 2 :	
Sprinklers :	

Segments Information

Building # 1

Segment Code	Segment Description	Square Feet
CAN	CANOPY	57
RO5	504-RETAIL >=5,000 <15,000 SQFT	3,883

Outbuilding Information

Building Description	Year Built	Square Feet
PAVING	1900	3400

Real Estate Tax

Current Year	Bill Number	Year	Installment	Date Due	Tax Billed	Tax Paid	Balance Due
2020	13757	2020	INSTALLMENT #1	9/30/2019	\$1,462.13	\$0.00	
2020	13757	2020	INSTALLMENT #2	12/31/2019	\$1,462.13	-\$1,462.13	\$4,386.39
2020	13757	2020	INSTALLMENT #3	3/31/2020	\$1,462.13	\$0.00	

DISCLAIMER: This data is provided without warranty of any kind, either expressed or implied, including but not limited to, the implied warranties of merchantability and fitness for a particular purpose. Any person, firm or corporation which uses this map or any of the enclosed information assumes all risk for the inaccuracy thereof, as City of Chesapeake expressly disclaims any liability for loss or damage arising from the use of said information by any third party.

2020	13757	2020	INSTALLMENT #4	6/5/2020	\$1,462.13	\$0.00	
------	-------	------	----------------	----------	------------	--------	--

Please contact the Treasurer's Office at (757) 382-6281 if you have questions regarding Tax Paid or Balance Due. Storm Water Fees and prior balances do not show on this tab.

Real Estate Notes

Note
1-DB 1945-351 FORCL \$67500.
2-PHY SUR PER MB 73-11 FOR 82-83.
3-BP 55470 7-82 \$5500 1-83. (11-82)
4-TABOR ANTIQUES-THE CHATTER BOX, DONS WATCH SHOP-GREAT BRIDGE PRESS.
5-HODGES H LEON TRUSTEE 072573 1663-705 00000000 00000000
6-DB9245 PG412 CREDIT LINE D/T \$518,800 RECORDED 10/22/13. 10/30/2013. DAJ
888-GRUCHACZ STEVEN T & LYNDA S S 031780 000065000 1881 552 1224 0183

City of Chesapeake, Virginia

Legend

- Parcels
- City Boundary

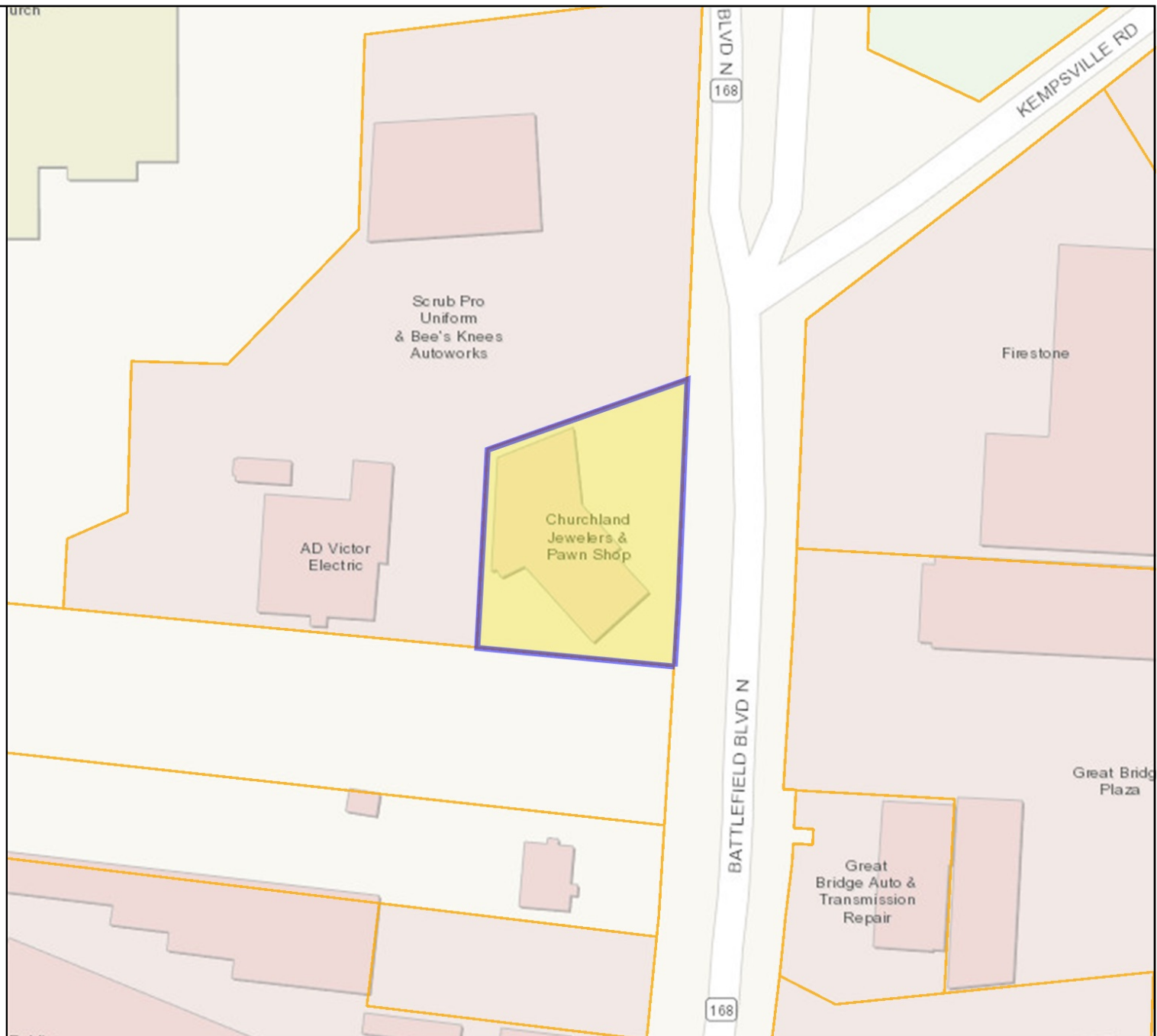

Parcel Number: 0482001000070

Date: 1/29/2020

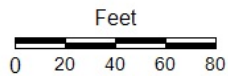

DISCLAIMER: This drawing is neither a legally recorded map nor a survey and is not intended to be used as such. The information displayed is a compilation of records, information, and data obtained from various sources, and City of Chesapeake is not responsible for its accuracy or how current it may be.