

# Property Record Card - Williams County, Ohio

Generated 6/23/2017 11:36:03 AM

General Parcel Information	
Parcel	073-060-00-008.001
Owner	PAMIDA SPE REAL ESTATE LLC
Address	1625 E MAIN ST
Mailing Address Line 1	PAMIDA SPE REAL ESTATE
Mailing Address Line 2	2727 N HARWOOD SUITE 300
Mailing Address Line 3	DALLAS TX 75201
Land Use	429 - OTHER RETAIL STRUCTURES
Legal Description	3-7-6 TR.11 S.PT; LOTS 6 W.PT THRU 9 E.PT SHADY GARDENS 4.00AC
Tax District	151
School District	MONTPELIER EXEMPTED VILLAGE SCHOOL DISTRICT
Township	MONTPELIER VILLAGE
City	MONTPELIER

Valuation Details						
Appraised Land Value	Assessed Land Value	Appraised Improvements Value	Assessed Improvements Value	Appraised CAUV Value	Assessed CAUV Value	Taxable Value
\$75,000	\$26,250	\$1,329,200	\$465,220	\$0	\$0	\$491,470

Land Details					
Land Type	Acreage	Depth	Frontage	Depth Factor	Value
CP - Commercial Acreage	1	0	0	100	\$30,000
CS - Commercial Acreage	3	0	0	100	\$45,000

Agricultural Details				
Soil Type	Land Usage	Land Type	Acres	Value
No Agricultural Information Available				

Sales Details			
Date	Buyer	Seller	Price
2/8/2006	PAMIDA SPE REAL ESTATE LLC	PAMIDA INC	\$1,600,000
8/9/1999	PAMIDA INC	**PARCEL CREATED	\$60,000
8/9/1999	**PARCEL CREATED	Unknown	\$60,000

Card 1 - Additions			
Description	Area	Year Built	Value
632-Superstructure	678	0	\$14,143
632-Superstructure	540	0	\$18,608

Card 1 - Improvements					
Code	Description	Year Built	Dimensions	Area	Value
525	Paving Asphalt	2000	0 x 0	50500	\$53,030
526	Paving Concrete	2000	0 x 0	3575	\$6,440

Card 1 - Commercial			
Description	Value	Unit Count	Value
Retail Store		0	
Year Built	2000	Section Number	1
Year Remodeled	0	Section Area	32437

# Card 1 - Sketch

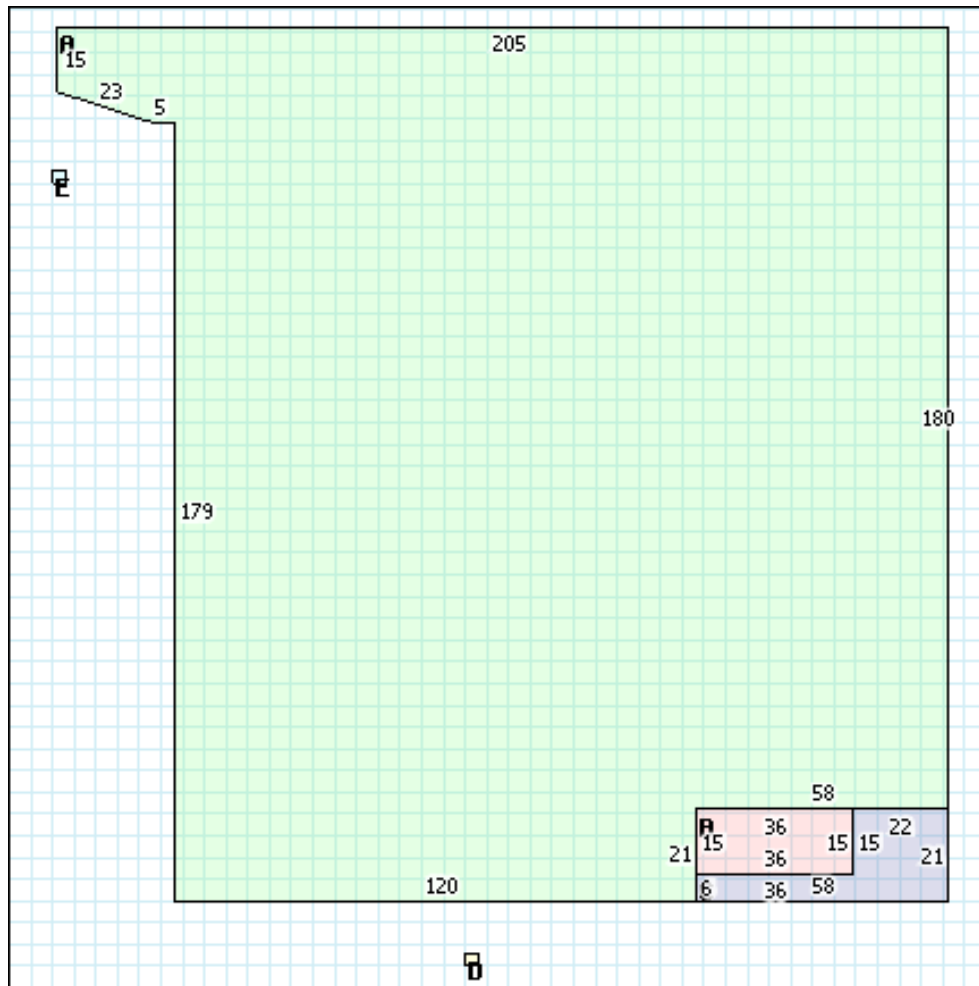

Scale: 5ft

Columns: S | AS | BC | A | EF | TB



**A** 1 s CB/Slab

35079 sqft



**B** PR2

540 sqft



**C** PR3

678 sqft



**D** 01



**E** 02

121141

121145

121147

121149

SURE FOUNDATION PROPERTIES LLC

ANDERSON RICHARD C

391.8

276.58

(14)

28.96

(13)

001

ANDERSON RICHARD C

2.83Ac

(12)

100

(11)

170

170

186.77

(10)

271.46

391.97

358.16

1625

4Ac

PAMIDA SPE REAL ESTATE LLC

502.81

5.49Ac

(9)

(8)

(7)

(6)

(5)

(4)

(3)

SNYDER NED D

182.37

178.61

15

14.83

ST. RTE 107

107

29.7