



Kathy Ramsey  
Cushman & Wakefield of California, Inc.  
315 Montgomery, Mezzanine Level  
San Francisco, California 94101

Submitted Electronically: [kathy.ramsey@cushwake.com](mailto:kathy.ramsey@cushwake.com)

Subject:

Asbestos Complete Interior Survey  
Bank of America – Gridley Branch  
901 Hazel Street  
Gridley, California 95948  
Mail Code: CA2-103

Dear Ms. Ramsey:

ARCADIS U.S., Inc. (ARCADIS) conducted a Complete Interior Survey (CIS) of asbestos-containing materials (ACMs) at the above-referenced site for Bank of America. The survey was requested to identify the location and quantity of ACMs in the building as part of the Remote Capture Project. The focus of the survey was to identify visible and accessible suspect ACMs. Background information on the site, a summary of the asbestos survey, and the inspector's qualifications are provided below.

#### **BACKGROUND INFORMATION**

The site is a one-story plus mezzanine level banking center located at the corner of Hazel and Virginia Streets, is owned by Bank of America, and is managed by Cushman & Wakefield. The building totals 5,950 square feet and includes an open parking area. The building was reportedly constructed in 1962.

#### **ASBESTOS SURVEY**

Prior to the commencement of the CIS, ARCADIS conducted a review of the existing asbestos data (if available) located in IDEA, Bank of America's environmental management database. If asbestos data was available in IDEA, additional samples were collected to fill the gaps in the existing data. Reliable previous asbestos survey

ARCADIS U.S., Inc.  
2000 Powell Street  
7th Floor  
Emeryville  
California 94608  
Tel. 925.953-3395  
Fax. 925.274.1103  
[www.arcadis-us.com](http://www.arcadis-us.com)

ENVIRONMENT

Date:  
January 22, 2012

Contact:  
Mark Williams

Phone:  
925.953.3395

Email:  
[mark.williams@arcadis-us.com](mailto:mark.williams@arcadis-us.com)

Our ref:  
HT120256.0046  
Task 00001

data was input into a Homogeneous Application Table (HAT) along with the data generated during this survey.

On January 5, 2012, Mr. Salvador Mendoza, a California Certified Asbestos Consultant (CAC), performed the CIS. A copy of Mr. Mendoza's certifications are provided in Attachment A. During the inspection, a total of 51 homogeneous applications (HAs) were identified and a total of 78 bulk samples were collected and submitted for laboratory analysis. The laboratory testing results for 41 bulk samples from past surveys are also included in the HAT. The results of the CIS are presented in the attachments to this report as follows:

- Attachment B – Homogeneous Application Table
- Attachment C – Laboratory Analytical Reports and Chain of Custody Form(s)
- Attachment D – Sample Location Figure(s)
- Attachment E – Photographic Log

Consistent with Bank of America's scope for a CIS, unless noted herein, intrusive or destructive testing was not performed at the site to identify materials that may be hidden or obstructed from normal view. Examples of potentially hidden or obstructed areas include, but are not limited to: wall cavity interiors, pipe chases, spaces above fixed ceilings, grout/adhesive beneath ceramic tiles/marble tiles/granite, sub floors, and adhesives behind wall-mounted mirrors, etc. The survey did not include roofing and the exterior of the building. Refer to the site's Asbestos Operations and Maintenance (O&M) Program in IDEA regarding potentially hidden, obstructed or non-sampled suspect ACMs.

## CONCLUSIONS

Based upon our review of the previous asbestos survey data currently available in IDEA, and as presented in the HAT in Attachment B, the results of the CIS **identified confirmed and suspect** ACMs in the building.

When reviewing the HAT, in general, materials confirmed as ACMs are identified by the National Emission Standards for Hazardous Air Pollutants (NESHAP) categories provided below (refer to the NESHAP column of the HAT).

- Friable ACM
- CAT 1 Non-friable ACM
- CAT 2 Non-friable ACM
- ACCM

In some cases, materials which may be ACMs could not be sampled and are identified as "Suspect ACM, Not Sampled" in the HAT. These would include materials that would require intrusive or destructive sampling or materials that could not safely be accessed and sampled. Until determined otherwise, suspect and not sampled ACMs should be managed as asbestos-containing in accordance with the site's Asbestos O&M Program (refer to the Asbestos O&M Program in IDEA).

Materials confirmed as non-ACMs are identified by the NESHAP categories:

- Non-ACM, Sampled
- Non-Suspect ACM, Not Sampled

## **RECOMMENDATIONS**

In accordance with United States Environmental Protection Agency (U.S. EPA) and Occupational Safety and Health Administration (OSHA) regulations and recommended guidance, ARCADIS recommends that all suspect and confirmed ACMs, if present, be managed in accordance with Bank of America's O&M Program. In most cases, when an ACM is in "Good" condition, we anticipate that the material may be managed in-place, with abatement only being required when materials will be, or are anticipated to be disturbed (e.g. renovation and some maintenance activities).

All of the materials observed during the CIS were reported to be in good condition.

ACMs that are assessed as "Damaged" or "Significantly Damaged" may present a greater risk of releasing asbestos fibers than those that are in good condition. Therefore, these materials should be further evaluated to determine if they require repair or abatement, or if the materials can be effectively managed in place. If the materials are repaired or abated, the HAT should be updated to reflect this modification. Contact the site's Property Manager to determine what actions are necessary with respect to "Damaged" or "Significantly Damaged" ACMs, if present.

## **CLOSING**

The CIS described herein was conducted by the undersigned. This investigation consisted solely of the activities described herein and is subject to the Limitations and Service Constraints in Attachment F. Prior to performing renovation or demolition activities, the existing asbestos data in IDEA should be reviewed to confirm all building materials which may be impacted have been evaluated to determine if they

are ACMs, and that the existing data is complete and complies with all laws and regulations governing asbestos. In some cases, additional testing, including intrusive or destructive testing, may be required prior to demolition or renovation activities, especially with respect to potentially hidden, obstructed or inaccessible non-sampled ACMs. Contact the Property Manager if you have any questions regarding this data and/or the need for additional sampling.

Thank you for your time and consideration on this project. Please do not hesitate to call if you have questions regarding the results of this CIS or if you require additional information.

Sincerely,

ARCADIS U.S., Inc.

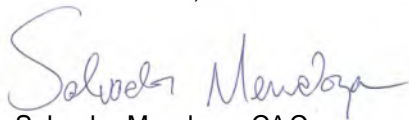

Salvador Mendoza, CAC  
AHERA Certified Asbestos Inspector



Mark Williams, CAC  
West Regional Representative  
Certified Asbestos Consultant 02-4239

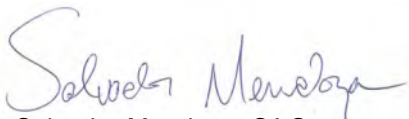

Salvador Mendoza, CAC  
Quality Control Reviewer  
Certified Asbestos Consultant 03-3386

Attachments:

- A Inspector Qualifications
- B Homogeneous Application Table
- C Laboratory Analytical Reports and Chain of Custody Form(s)
- D Sample Location Figure(s)
- E Photographic Log
- F Limitations and Service Constraints



Attachment A

Inspector Qualifications

DEPARTMENT OF INDUSTRIAL RELATIONS

Division of Occupational Safety and Health

Asbestos Unit

2211 Park Towne Circle, Suite 1

Sacramento, CA 95825-0414

(916) 574-2993 Office (916) 483-0572 Fax

<http://www.dir.ca.gov/dir/databases.html> [actu@dir.ca.gov](mailto:actu@dir.ca.gov)

306063386C

254

May 25, 2011

Arcadis

Salvador Mendoza

1410 Rocky Ridge Drive, #330

Roseville ' CA 95661

Dear Certified Asbestos Consultant or Technician:

Enclosed is your certification card. **To maintain your certification, you must abide by the rules printed on the back of the certification card.**

Your certification is valid for a period of one year. If you wish to renew your certification, you must apply for renewal at least 60 days before the expiration date shown on your card. [8 CCR 341.15(h)(1)].

Please hold and do not send copies of your required AHERA refresher renewal certificates to our office until you apply for renewal of your certification.

Certificates must be kept current if you are actively working as a CAC or CSST. The grace period is only for those who are not actively working as an asbestos consultant or site surveillance technician.

Please inform our office at the above address, fax number or email; of any changes in your contact/ mailing information within 15 days of the change.

Sincerely,

Jeff Ferrell

Senior Industrial Hygienist

Attachment: Certification Card

cc: File

Renewal – Card Attached (Revised 01/04/2011)

State of California  
Division of Occupational Safety and Health  
**Certified Asbestos Consultant**

**Salvador Mendoza**

Name

Certification No. **03-3386**Expires on **06/25/12**

This certification was issued by the Division of Occupational Safety and Health as authorized by Sections 7180 et seq. of the Business and Professions Code.

## DEPARTMENT OF INDUSTRIAL RELATIONS

Division of Occupational Safety and Health  
Asbestos Unit

2211 Park Towne Circle, Suite 1

Sacramento, CA 95825-0414

(916) 574-2993 Office (916) 483-0572 Fax

<http://www.dir.ca.gov/dir/databases.html> [actu@dir.ca.gov](mailto:actu@dir.ca.gov)

707024239C

304

July 25, 2011

Mark Brian Williams

P O Box 1002

San Ramon

CA 94583

Dear Certified Asbestos Consultant or Technician:

Enclosed is your certification card. **To maintain your certification, you must abide by the rules printed on the back of the certification card.**

Your certification is valid for a period of one year. If you wish to renew your certification, you must apply for renewal at least 60 days before the expiration date shown on your card. [8 CCR 341.15(h)(1)].

Please hold and do not send copies of your required AHERA refresher renewal certificates to our office until you apply for renewal of your certification.

Certificates must be kept current if you are actively working as a CAC or CSST. The grace period is only for those who are not actively working as an asbestos consultant or site surveillance technician.

Please inform our office at the above address, fax number or email; of any changes in your contact/mailling information within 15 days of the change.

Sincerely,

Jeff Ferrell

Senior Industrial Hygienist

Attachment: Certification Card

cc: File

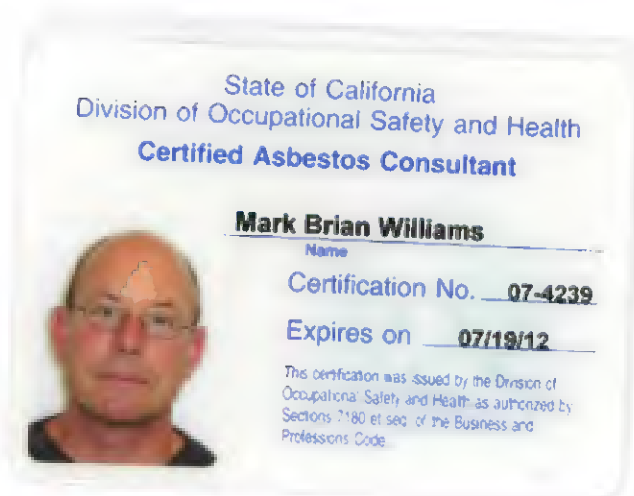



Attachment **B**

Homogeneous Application Table



<b>Data Extraction Date</b>	2012-01-09 5:15:44 PM	<b>Do Not Modify</b>
<b>Mail Code</b>	CA2-103	
<b>Address</b>	901 Hazel St.	
<b>City</b>	Gridley	
<b>State</b>	CA	
<b>Survey Date</b>	1/22/2012	
<b>Survey Type</b>	Complete Interior Survey	
<b>Floors</b>	1,M	e.g. 1,2,6
<b>Overwrite Existing HAT</b>	Yes	<b>If you choose "yes" all existing HA data in IDEA will be lost! Any ACM data from previous surveys that you wish to save must be included in</b>

Homogeneous Application Table  
CA2-103

HA No.	Material Type	Primary Color	Texture	Description	NESHAP Cat.	Floor	Rooms	Location	Condition	Amt.	Units	Status	Modified Date	Description	PK	ModDate
1	M - Joint Compound (associated with wall/ceiling board/panels)	White	Rough	Joint Compound (Painted)	ACCM (California Only)	1, M	Throughout Walls and Part Ceilings	Multiple	Good	4500	SF	Manage in-place			465855	#####
2	S - Wall - Textured Paints/Coatings	White	Rough	Wall Texture	ACCM (California Only)	1, M	R.R.'s, Supply Room, Mechanical Room Closet, Janitor's Closet	Wall	Damaged	2100	SF	Manage in-place		Per email from Mark Williams, CAL OSHA ACCM work issue - recommend managing in-place. Sent email to Cushman Wakefield 6/23/11 to determine if area will be renovated in the future, otherwise manage in place for the time.	465837	#####
3	M - Floor - Vinyl Sheet Flooring (e.g. Linoleum)	Gray	Smooth	Sheet Flooring Gray With White Specks	Non-ACM, Sampled	M	Restrooms, Supply Room	Floor	Good	0		n/a		Not Quantified	465788	#####
4	T - Insulation - Misc. (Add description)	White	Rough	Cloth over Fiberglass Insulation on HVAC Ducts	Non-ACM, Sampled	M	Mechanical Room HVAC Equipment	Other	Good	0		n/a		Not Quantified	465878	#####
5	T - Thermal Taping Compounds	Tan	Rough	Tape over HVAC Duct Joints	Non-ACM, Sampled	M	Mechanical Room HVAC Equipment	Other	Good	0		n/a		Not Quantified	465918	#####
6	M - Sink Undercoating	Black	Rough	Sink Undercoating	Non-ACM, Sampled	M	Break Room Sink	Other	Good	1	EA	n/a			466008	#####
7	M - Carpet Glue/Mastic	Yellow	Rough	Associated with Red Carpet	Non-ACM, Sampled	1	Teller Line	Floor	Good	2000	SF	n/a			465265	#####
8	M - Floor Tile - 12" x 12"	Brown	Smooth	12" x 12" Brown with White Streaks Floor Tile	Non-ACM, Sampled	1	ATM Room-(Fill-In Tiles), NER	Floor	Good	4	SF	n/a			466109	#####
9	M - Floor Tile - 12" x 12"	White	Smooth	12" x 12" White with Brown Streaks Floor Tile	CAT 1 Non-friable ACM	1	Safe Deposit Booth's	Floor	Good	40	SF	Manage in-place			466111	#####
10	M - Floor Tile - Mastic/Adhesive	Black	Rough	Black Mastic Associated with HA-11	CAT 1 Non-friable ACM	1	Safe Deposit Booth (Beneath SDB), Storage Room	Floor	Good	350	SF	Manage in-place			465942	#####
11	M - Floor Tile - 9" x 9"	Tan	Smooth	9" x 9" Tan with Brown/ White Streaks Floor Tile	CAT 1 Non-friable ACM	1	Safe Deposit Booth (Beneath SDB), Storage Room	Floor	Good	350	SF	Manage in-place			466131	#####
12	M - Floor Tile - 12" x 12"	Tan	Smooth	12" x 12" Tan with Brown Streaks Floor Tile	Non-ACM, Sampled	1, M	Conference Room, Hallway, Lobby, Teller Area, Break Room, Stairs, ATM Room	Floor	Good	2500	SF	n/a			466110	#####
13	M - Floor Tile - Mastic/Adhesive	Black	Rough	Black Mastic Associated with HA-12	CAT 1 Non-friable ACM	1, M	Conference Room, Hallway, Lobby, Teller Area, Break Room	Floor	Good	2500	SF	Manage in-place			465943	#####
14	M - Floor Tile - Mastic/Adhesive	Yellow	Rough	Yellow/Black Mastic Associated with HA-8	CAT 1 Non-friable ACM	1	ATM Room-(Fill-In Tiles), NER	Floor	Good	4	SF	Manage in-place			465945	#####
15	M - Floor Tile - Mastic/Adhesive	Black	Rough	Black Mastic Associated with HA-9	CAT 1 Non-friable ACM	1	Safe Deposit Booth's	Floor	Good	40	SF	Manage in-place			465940	#####
16	M - Ceiling Tile - 2' x 4'	White	Fissured	2' x 4' Suspended by "T" Bar	Non-ACM, Sampled	1	Throughout 1st Floor	Ceiling	Good	2890	SF	n/a			466066	#####
17	M - Floor Tile - 12" x 12"	White	Smooth	12" x 12" White with Tan Streaks Floor Tile	Non-ACM, Sampled	1	Vault, SDB	Floor	Good	120	SF	n/a			466112	#####
18	M - Floor Tile - Mastic/Adhesive	Black	Rough	Black Mastic Associated with HA-17	Non-ACM, Sampled	1	Vault, SDB	Floor	Good	120	SF	n/a		Lab Note: "No Black mastic found." Lab denoted color as brown	465944	#####
19	M - Ceiling Tile - 1' x 1'	White	Fissured	1' x 1' - Glue On	Non-ACM, Sampled	M	Break Room - Above False Ceiling Panels)	Ceiling	Good	0		n/a		Not Quantified	465329	#####
20	M - Cove Base Mastic	Clear	Rough	Cove Base Mastic Associated with HA-21	Non-ACM, Sampled	1, M	Throughout Branch	Wall	Good	0		n/a		Not Quantified	465492	#####
21	M - Cove Base	Black	Smooth	4" Rubber Cove Base	Non-ACM, Sampled	1, M	Throughout Branch	Wall	Good	0		n/a		Not Quantified	466168	#####
22	NSM - Carpet	Red	Rough	24" x 24" Carpet Tiles	Non-Suspect ACM, Not Sampled	1	Platform	Floor	Good	0		n/a			466167	#####
23	M - Carpet Glue/Mastic	Black	Not Applicable	Black/Yellow/ Gray under HA-22	CAT 1 Non-friable ACM	1	Platform	Floor	Good	1000	SF	Manage in-place			465264	#####
24	M - Floor Tile - Other Size	Tan	Not Applicable	Brown & White Specks Floor Tile	Non-ACM, Sampled	1	Concealed under Red Carpet for Teller Line and Platform, Lobby, Safe Deposit Lobby	Floor	Good	4500	SF	n/a			465206	#####
25	M - Floor Tile - Mastic/Adhesive	Black	Not Applicable	Black Mastic Associated with HA-24	CAT 1 Non-friable ACM	1	Concealed under Red Carpet for Teller Line and Platform, Lobby, Safe Deposit Lobby	Floor	Good	4500	SF	Manage in-place			465941	#####

Homogeneous Application Table  
CA2-103

HA No.	Material Type	Primary Color	Texture	Description	NESHAP Cat.	Floor	Rooms	Location	Condition	Amt.	Units	Status	Modified Date	Description	PK	ModDate
26	M - Gypsum Board (walls and ceilings)	White	Smooth	Drywall Associated with HA-1	Non-ACM, Sampled	1,M	Throughout Walls and Part Ceilings	Multiple	Good	0		n/a		Drywall is non-ACM; joint compound is ACCM	465611	#####
27	M - Floor Tile - 12" x 12"	Beige	Smooth	12" x 12" Beige with Large Brown Streaks Floor Tile	CAT 1 Non-friable ACM	1	ATM, NER	Floor	Good	300	SF	Manage in-place				
28	M - Floor Tile - Mastic/Adhesive	Black	Rough	Floor Tile Mastic Associated with HA-27	CAT 1 Non-friable ACM	1	ATM, NER	Floor	Good	300	SF	Manage in-place				
29	M - Floor - Leveling Compound	White	Rough	Levalastic Beneath HA-HA-27/HA-28	Non-ACM, Sampled	1	ATM, NER	Floor	Good	5	SF	n/a				
30	M - Construction Mastics - Describe	Not Visible	Not Visible	Mastic Associated with HA-48	Suspect ACM, Not Sampled	1	ATM, NER	Wall	Good	300	SF	Manage in-place		Destructive Testing Required - Not Sampled		
31	M - Floor - Leveling Compound	Gray	Rough	Levalastic Beneath HA-12/HA-13	Non-ACM, Sampled	1	ATM, NER	Floor	Good	300	SF	n/a				
32	M - Floor Tile - Mastic/Adhesive	Black	Rough	Floor Tile Mastic Associated with HA-8 (Patch)	CAT 1 Non-friable ACM	1	ATM, NER	Floor	Good	6	SF	Manage in-place				
33	M - Ceiling Tile - Glue/Adhesive	Brown	Rough	Ceiling Tile Glue Associated with HA-19	Non-ACM, Sampled	M	Break Room	Ceiling	Good	900	SF	n/a				
34	M - Cove Base Mastic	Brown	Rough	Cove Base Mastic Associated with HA-21	Non-ACM, Sampled	1,M	Throughout Bank Branch	Wall	Good	1000	LF	n/a				
35	M - Cove Base Mastic	White	Rough	Cove Base Mastic Associated with HA-21	Non-ACM, Sampled	1,M	Throughout Bank Branch	Wall	Good	1000	LF	n/a				
36	M - Cove Base	Brown	Smooth	4" Cove Base	Non-ACM, Sampled	1	ATM, NER, Storage Room	Wall	Good	400	LF	n/a				
37	M - Cove Base Mastic	Brown	Rough	Cove Base Mastic Associated with HA-36	CAT 1 Non-friable ACM	1	ATM, NER, Storage Room	Wall	Good	400	LF	Manage in-place				
38	M - Wall Paper Adhesive	Clear	Rough	Wall Paper Glue Associated with HA-49	Non-ACM, Sampled	1,M	ATM, NER, Break Room, Restrooms	Wall	Good	800	SF	n/a				
39	M - Wall - Ceramic Tile	Blue	Smooth	4" x 6" Ceramic Wall Tile/Cove Base	Non-Suspect ACM, Not Sampled	M	Restrooms	Wall	Good	0		n/a				
40	M - Wall - Ceramic Tile - Adhesive	Not Visible	Not Visible	Tile Adhesive Associated with HA-39	Suspect ACM, Not Sampled	M	Restrooms	Wall	Good	400	SF	Manage in-place		Destructive Testing Required - Not Sampled		
41	M - Wall - Ceramic Tile - Grout	White	Rough	Tile Grout Associated with HA-39	Non-ACM, Sampled	M	Restrooms	Wall	Good	400	SF	n/a				
42	M - Floor - Ceramic Tile	Beige	Smooth	1" x 1" Ceramic Floor Tile/Cove Base	Non-ACM, Sampled	M	Restrooms	Floor	Good	200	SF	n/a				
43	M - Floor - Ceramic Tile - Adhesive	White	Rough	Tile Adhesive Associated with HA-42	Non-ACM, Sampled	M	Restrooms	Floor	Good	200	SF	n/a				
44	M - Floor - Ceramic Tile - Grout	White	Rough	Tile Grout Associated with HA-42	Non-ACM, Sampled	M	Restrooms	Floor	Good	200	SF	n/a				
45	M - Floor - Vinyl Sheet Flooring (e.g. Linoleum)	Beige	Smooth	Sheet Flooring	Non-ACM, Sampled	M	Break Room, Restroom Hallway, Coat Closet	Floor	Good	1000	SF	n/a				
46	M - Floor Backing	Brown	Rough	Sheet Floor Backing	Non-ACM, Sampled	M	Break Room, Restroom Hallway, Coat Closet	Floor	Good	1000	SF	n/a				
47	M - Mastic behind Mirror	Not Visible	Not Visible	Mirror Mastic	Suspect ACM, Not Sampled	M	Restrooms	Wall	Good	30	SF	Manage in-place		Destructive Testing Required - Not Sampled		
48	M - Wall Panel - Acoustical	Gray	Rough	Sound Wall	Non-Suspect ACM, Not Sampled	1	ATM, NER	Wall	Good	0		n/a				
49	M - Wall Paper	Beige	Smooth	Wall Paper	Non-Suspect ACM, Not Sampled	1,M	ATM, NER, Break Room, Restrooms	Wall	Good	0		n/a				
50	NSM - Batt Insulation - Fiberglass/Mineral Wool	Pink	Rough	Fiberglass Batt Insulation	Non-Suspect ACM, Not Sampled	1,M	Ceiling Plenum	Other	Good	0		n/a				
51	NSM - Duct Insulation - Fiberglass	Black	Smooth	Black Plastic-Wrapped Fiberglass Duct Insulation	Non-Suspect ACM, Not Sampled	1,M	Ceiling Plenum	Other	Good	0		n/a				

Results of Sample Analyses

CA2-103

HA No.	Material Type	Id	Location	Content	Type	Friable	Sample Date	Consultant	Method	Lab	Comments / Details	PK	ModDate
1	M - Joint Compound (associated with wall/ceiling board/panels)	001	Mech Room	0.1% to <1%	Chrysotile	No	1/10/2008	ATC	PLM Point Count	Hygeia		7813085	
1	M - Joint Compound (associated with wall/ceiling board/panels)	002	Supply	0.1% to <1%	Chrysotile	No	1/10/2008	ATC	PLM Point Count	Hygeia		7813086	
1	M - Joint Compound (associated with wall/ceiling board/panels)	003	Janitor's Closet	0.1% to <1%	Chrysotile	No	1/10/2008	ATC	PLM Point Count	Hygeia		7813087	
2	S - Wall - Textured Paints/Coatings	004	Mech Room	0.1% to <1%	Chrysotile	No	1/10/2008	ATC	PLM Point Count	Hygeia		7813088	
2	S - Wall - Textured Paints/Coatings	005	Men's Restroom	0.1% to <1%	Chrysotile	No	1/10/2008	ATC	PLM Point Count	Hygeia		7813089	
2	S - Wall - Textured Paints/Coatings	006	Women's Restroom	0.1% to <1%	Chrysotile	No	1/10/2008	ATC	PLM Point Count	Hygeia		7813090	
2	S - Wall - Textured Paints/Coatings	007	Closet	0.1% to <1%	Chrysotile	No	1/10/2008	ATC	PLM Point Count	Hygeia		7813091	
2	S - Wall - Textured Paints/Coatings	008	Supply	0.1% to <1%	Chrysotile	No	1/10/2008	ATC	PLM Point Count	Hygeia		7813092	
3	M - Floor - Vinyl Sheet Flooring (e.g. Linoleum)	009	Men's Restroom	ND		No	1/10/2008	ATC	PLM	Hygeia		7813322	
3	M - Floor - Vinyl Sheet Flooring (e.g. Linoleum)	010	Women's Restroom	ND		No	1/10/2008	ATC	PLM	Hygeia		7813323	
3	M - Floor - Vinyl Sheet Flooring (e.g. Linoleum)	011	Supply	ND		No	1/10/2008	ATC	PLM	Hygeia		7813324	
4	T - Insulation - Misc. (Add description)	012	Mech Room	ND		No	1/10/2008	ATC	PLM	Hygeia		7813325	
4	T - Insulation - Misc. (Add description)	013	Mech Room	ND		No	1/10/2008	ATC	PLM	Hygeia		7813326	
4	T - Insulation - Misc. (Add description)	014	Mech Room	ND		No	1/10/2008	ATC	PLM	Hygeia		7813327	
5	T - Thermal Taping Compounds	015	Mech Room	ND		No	1/10/2008	ATC	PLM	Hygeia		7813328	
5	T - Thermal Taping Compounds	016	Mech Room	ND		No	1/10/2008	ATC	PLM	Hygeia		7813329	
5	T - Thermal Taping Compounds	017	Mech Room	ND		No	1/10/2008	ATC	PLM	Hygeia		7813330	
6	M - Sink Undercoating	018	Break Room	ND		Yes	1/10/2008	ATC	PLM	Hygeia		7814584	
7	M - Carpet Glue/Mastic	019	Operations	ND		No	1/10/2008	ATC	PLM	Hygeia		7813331	
7	M - Carpet Glue/Mastic	020	New Accounts	ND		No	1/10/2008	ATC	PLM	Hygeia		7813332	
7	M - Carpet Glue/Mastic	021	New Accounts	ND		No	1/10/2008	ATC	PLM	Hygeia		7813333	

Results of Sample Analyses

CA2-103

HA No.	Material Type	Id	Location	Content	Type	Friable	Sample Date	Consultant	Method	Lab	Comments / Details	PK	ModDate
8	M - Floor Tile - 12" x 12"	022	ATM	ND		No	1/10/2008	ATC	PLM	Hygeia		7813334	
9	M - Floor Tile - 12" x 12"	023	Safe Deposit	0.1% to <1%	Chrysotile	No	1/10/2008	ATC	PLM	Hygeia		7813082	
9	M - Floor Tile - 12" x 12"	024	Safe Deposit	0.1% to <1%	Chrysotile	No	1/10/2008	ATC	PLM	Hygeia		7813083	
9	M - Floor Tile - 12" x 12"	025	Safe Deposit	0.1% to <1%	Chrysotile	No	1/10/2008	ATC	PLM	Hygeia		7813084	
10	M - Floor Tile - Mastic/Adhesive	15A	SDB (Beneath SDB) storage room	Not Analyzed		No	1/5/2012	ARCADIS	PLM	EMSL	Insufficient Material		
10	M - Floor Tile - Mastic/Adhesive	15B	SDB (Beneath SDB) storage room	>1%-10%	Chrysotile	No	1/5/2012	ARCADIS	PLM	EMSL			
10	M - Floor Tile - Mastic/Adhesive	15C	SDB (Beneath SDB) storage room	Pos Stop		No	1/5/2012	ARCADIS	PLM	EMSL			
11	M - Floor Tile - 9" x 9"	11A	SDB (Beneath SDB) storage room	0.1% to <1%	Chrysotile	No	1/5/2012	ARCADIS	PLM	EMSL			
11	M - Floor Tile - 9" x 9"	11B	SDB (Beneath SDB) storage room	0.1% to <1%	Chrysotile	No	1/5/2012	ARCADIS	PLM	EMSL			
11	M - Floor Tile - 9" x 9"	11C	SDB (Beneath SDB) storage room	0.1% to <1%	Chrysotile	No	1/5/2012	ARCADIS	PLM	EMSL			
12	M - Floor Tile - 12" x 12"	12A	Conf. rm, hallway, breakroom, lobby, teller area	ND		No	1/5/2012	ARCADIS	PLM	EMSL			
12	M - Floor Tile - 12" x 12"	12B	Conf. rm, hallway, breakroom, lobby, teller area	ND		No	1/5/2012	ARCADIS	PLM	EMSL			
12	M - Floor Tile - 12" x 12"	12C	Conf. rm, hallway, breakroom, lobby, teller area	ND		No	1/5/2012	ARCADIS	PLM	EMSL			
13	M - Floor Tile - Mastic/Adhesive	13A YELLOW MASTIC	Conf. rm, hallway, breakroom, lobby, teller area	ND		No	1/5/2012	ARCADIS	PLM	EMSL			
13	M - Floor Tile - Mastic/Adhesive	13A BLACK MASTIC	Conf. rm, hallway, breakroom, lobby, teller area	>1%-10%	Chrysotile	No	1/5/2012	ARCADIS	PLM	EMSL			
13	M - Floor Tile - Mastic/Adhesive	13B YELLOW MASTIC	Conf. rm, hallway, breakroom, lobby, teller area	ND		No	1/5/2012	ARCADIS	PLM	EMSL			
13	M - Floor Tile - Mastic/Adhesive	13B BLACK MASTIC	Conf. rm, hallway, breakroom, lobby, teller area	Pos Stop		No	1/5/2012	ARCADIS	PLM	EMSL			
13	M - Floor Tile - Mastic/Adhesive	13C YELLOW MASTIC	Conf. rm, hallway, breakroom, lobby, teller area	ND		No	1/5/2012	ARCADIS	PLM	EMSL			
13	M - Floor Tile - Mastic/Adhesive	13C BLACK MASTIC	Conf. rm, hallway, breakroom, lobby, teller area	Pos Stop		No	1/5/2012	ARCADIS	PLM	EMSL			
14	M - Floor Tile - Mastic/Adhesive	022	ATM	>1%-10%	Chrysotile	No	1/10/2008	ATC	PLM	Hygeia		7812976	
14	M - Floor Tile - Mastic/Adhesive	14A	ATM/NER	ND		No	1/5/2012	ARCADIS	PLM	EMSL			

Results of Sample Analyses

CA2-103

HA No.	Material Type	Id	Location	Content	Type	Friable	Sample Date	Consultant	Method	Lab	Comments / Details	PK	ModDate
15	M - Floor Tile - Mastic/Adhesive	023	Safe Deposit	>1%-10%	Chrysotile	No	1/10/2008	ATC	PLM	Hygeia		7812977	
15	M - Floor Tile - Mastic/Adhesive	024	Safe Deposit	>1%-10%	Chrysotile	No	1/10/2008	ATC	PLM	Hygeia		7812978	
15	M - Floor Tile - Mastic/Adhesive	025	Safe Deposit	>1%-10%	Chrysotile	No	1/10/2008	ATC	PLM	Hygeia		7812979	
16	M - Ceiling Tile - 2' x 4'	16A	Throughout 1st floor	ND		Yes	1/5/2012	ARCADIS	PLM	EMSL			
16	M - Ceiling Tile - 2' x 4'	16B	Throughout 1st floor	ND		Yes	1/5/2012	ARCADIS	PLM	EMSL			
16	M - Ceiling Tile - 2' x 4'	16C	Throughout 1st floor	ND		Yes	1/5/2012	ARCADIS	PLM	EMSL			
17	M - Floor Tile - 12" x 12"	17A	Vault & SDB	ND		No	1/5/2012	ARCADIS	PLM	EMSL			
17	M - Floor Tile - 12" x 12"	17B	Vault & SDB	ND		No	1/5/2012	ARCADIS	PLM	EMSL			
17	M - Floor Tile - 12" x 12"	17C	Vault & SDB	ND		No	1/5/2012	ARCADIS	PLM	EMSL			
18	M - Floor Tile - Mastic/Adhesive	18A	Vault & SDB	ND		No	1/5/2012	ARCADIS	PLM	EMSL	Lab Note: "No Black mastic found." Lab denoted color as brown		
18	M - Floor Tile - Mastic/Adhesive	18B	Vault & SDB	ND		No	1/5/2012	ARCADIS	PLM	EMSL	Lab Note: "No Black mastic found." Lab denoted color as brown		
18	M - Floor Tile - Mastic/Adhesive	18C	Vault & SDB	ND		No	1/5/2012	ARCADIS	PLM	EMSL	Lab Note: "No Black mastic found." Lab denoted color as brown		
19	M - Ceiling Tile - 1' x 1'	19A	Above the false ceiling panels - breakroom	ND		Yes	1/5/2012	ARCADIS	PLM	EMSL			
19	M - Ceiling Tile - 1' x 1'	19B	Above the false ceiling panels - breakroom	ND		Yes	1/5/2012	ARCADIS	PLM	EMSL			
19	M - Ceiling Tile - 1' x 1'	19C	Above the false ceiling panels - breakroom	ND		Yes	1/5/2012	ARCADIS	PLM	EMSL			
21	M - Cove Base	21A	Throughout	ND		No	1/5/2012	ARCADIS	PLM	EMSL			
21	M - Cove Base	21B	Throughout	ND		No	1/5/2012	ARCADIS	PLM	EMSL			
21	M - Cove Base	21C	Throughout	ND		No	1/5/2012	ARCADIS	PLM	EMSL			
23	M - Carpet Glue/Mastic	23A	PLATFORM/CONCEALED UNDER RED 24X24 CARPET TILE	>1%-10%	Chrysotile	No	9/28/2010	ATC	PLM	EMSL		7813014	
23	M - Carpet Glue/Mastic	23B	PLATFORM/CONCEALED UNDER RED 24X24 CARPET TILE	>1%-10%	Chrysotile	No	9/28/2010	ATC	PLM	EMSL		7813015	
23	M - Carpet Glue/Mastic	23C	PLATFORM/CONCEALED UNDER RED 24X24 CARPET TILE	>1%-10%	Chrysotile	No	9/28/2010	ATC	PLM	EMSL		7813016	

Results of Sample Analyses

CA2-103

HA No.	Material Type	Id	Location	Content	Type	Friable	Sample Date	Consultant	Method	Lab	Comments / Details	PK	ModDate
24	M - Floor Tile - Other Size	24A-Floor Tile	SAFE DEPOSIT LOBBY	ND		No	9/28/2010	ATC	PLM	EMSL		7813849	
24	M - Floor Tile - Other Size	24B-Floor Tile	LOBBY	ND		No	9/28/2010	ATC	PLM	EMSL		7813850	
24	M - Floor Tile - Other Size	24C-Floor Tile	TELLER LINE UNDER CARPET	ND		No	9/28/2010	ATC	PLM	EMSL		7813851	
25	M - Floor Tile - Mastic/Adhesive	24A-Mastic	SAFE DEPOSIT LOBBY	>1%-10%	Chrysotile	No	9/28/2010	ATC	PLM	EMSL		7813017	
25	M - Floor Tile - Mastic/Adhesive	24B-Mastic	LOBBY	Pos Stop		No	9/28/2010	ATC	PLM	EMSL		7815298	
25	M - Floor Tile - Mastic/Adhesive	24C-Mastic	TELLER LINE UNDER CARPET	Pos Stop		No	9/28/2010	ATC	PLM	EMSL		7815299	
25	M - Floor Tile - Mastic/Adhesive	25A	Beneath carpet for teller & platform	>1%-10%	Chrysotile	No	1/5/2012	ARCADIS	PLM	EMSL			
26	M - Gypsum Board (walls and ceilings)	001-GB	Mech Room	ND		No	1/10/2008	ATC	PLM	Hygeia		7815188	
26	M - Gypsum Board (walls and ceilings)	002-GB	Supply	ND		No	1/10/2008	ATC	PLM	Hygeia		7815189	
26	M - Gypsum Board (walls and ceilings)	003-GB	Janitor's Closet	ND		No	1/10/2008	ATC	PLM	Hygeia		7815190	
27	M - Floor Tile - 12" x 12"	27A	ATM/NER	>1%-10%	Chrysotile	No	1/5/2012	ARCADIS	PLM	EMSL			
27	M - Floor Tile - 12" x 12"	27B	ATM/NER	Pos Stop		No	1/5/2012	ARCADIS	PLM	EMSL			
27	M - Floor Tile - 12" x 12"	27C	ATM/NER	Pos Stop		No	1/5/2012	ARCADIS	PLM	EMSL			
28	M - Floor Tile - Mastic/Adhesive	28A	ATM/NER	>1%-10%	Chrysotile	No	1/5/2012	ARCADIS	PLM	EMSL			
28	M - Floor Tile - Mastic/Adhesive	28B	ATM/NER	Pos Stop		No	1/5/2012	ARCADIS	PLM	EMSL			
28	M - Floor Tile - Mastic/Adhesive	28C	ATM/NER	Pos Stop		No	1/5/2012	ARCADIS	PLM	EMSL			
29	M - Floor - Leveling Compound	29A	ATM/NER	ND		Yes	1/5/2012	ARCADIS	PLM	EMSL			
29	M - Floor - Leveling Compound	29B	ATM/NER	ND		Yes	1/5/2012	ARCADIS	PLM	EMSL			
29	M - Floor - Leveling Compound	29C	ATM/NER	ND		Yes	1/5/2012	ARCADIS	PLM	EMSL			
31	M - Floor - Leveling Compound	31A	ATM/NER	ND		Yes	1/5/2012	ARCADIS	PLM	EMSL			
31	M - Floor - Leveling Compound	31C	ATM/NER	ND		Yes	1/5/2012	ARCADIS	PLM	EMSL			

Results of Sample Analyses

CA2-103

HA No.	Material Type	Id	Location	Content	Type	Friable	Sample Date	Consultant	Method	Lab	Comments / Details	PK	ModDate
32	M - Floor Tile - Mastic/Adhesive	32A	ATM/NER	>1%-10%	Chrysotile	No	1/5/2012	ARCADIS	PLM	EMSL			
33	M - Ceiling Tile - Glue/Adhesive	33A	Breakroom	ND		Yes	1/5/2012	ARCADIS	PLM	EMSL			
33	M - Ceiling Tile - Glue/Adhesive	33B	Breakroom	ND		Yes	1/5/2012	ARCADIS	PLM	EMSL			
33	M - Ceiling Tile - Glue/Adhesive	33C	Breakroom	ND		Yes	1/5/2012	ARCADIS	PLM	EMSL			
34	M - Cove Base Mastic	34A	Throughout	ND		No	1/5/2012	ARCADIS	PLM	EMSL			
34	M - Cove Base Mastic	34B	Throughout	ND		No	1/5/2012	ARCADIS	PLM	EMSL			
34	M - Cove Base Mastic	34C	Throughout	ND		No	1/5/2012	ARCADIS	PLM	EMSL			
35	M - Cove Base Mastic	35A	Throughout	ND		No	1/5/2012	ARCADIS	PLM	EMSL			
35	M - Cove Base Mastic	35B	Throughout	ND		No	1/5/2012	ARCADIS	PLM	EMSL			
35	M - Cove Base Mastic	35C	Throughout	ND		No	1/5/2012	ARCADIS	PLM	EMSL			
36	M - Cove Base	36A	ATM/NER, storage room	ND		No	1/5/2012	ARCADIS	PLM	EMSL			
36	M - Cove Base	36B	ATM/NER, storage room	ND		No	1/5/2012	ARCADIS	PLM	EMSL			
36	M - Cove Base	36C	ATM/NER, storage room	ND		No	1/5/2012	ARCADIS	PLM	EMSL			
37	M - Cove Base Mastic	37A	ATM/NER, storage room	>1%-10%	Chrysotile	No	1/5/2012	ARCADIS	PLM	EMSL			
37	M - Cove Base Mastic	37B	ATM/NER, storage room	Pos Stop		No	1/5/2012	ARCADIS	PLM	EMSL			
37	M - Cove Base Mastic	37C	ATM/NER, storage room	Pos Stop		No	1/5/2012	ARCADIS	PLM	EMSL			
38	M - Wall Paper Adhesive	38A	ATM/NER, break room, restrooms	ND		No	1/5/2012	ARCADIS	PLM	EMSL			
38	M - Wall Paper Adhesive	38B	ATM/NER, break room, restrooms	ND		No	1/5/2012	ARCADIS	PLM	EMSL			
38	M - Wall Paper Adhesive	38C	ATM/NER, break room, restrooms	ND		No	1/5/2012	ARCADIS	PLM	EMSL			
41	M - Wall - Ceramic Tile - Grout	41A	Men's & women's restrooms	ND		Yes	1/5/2012	ARCADIS	PLM	EMSL			
41	M - Wall - Ceramic Tile - Grout	41B	Men's & women's restrooms	ND		Yes	1/5/2012	ARCADIS	PLM	EMSL			



Results of Sample Analyses

CA2-103

HA No.	Material Type	Id	Location	Content	Type	Friable	Sample Date	Consultant	Method	Lab	Comments / Details	PK	ModDate
41	M - Wall - Ceramic Tile - Grout	41C	Men's & women's restrooms	ND		Yes	1/5/2012	ARCADIS	PLM	EMSL			
42	M - Floor - Ceramic Tile	42A	Men's & women's restrooms	ND		Yes	1/5/2012	ARCADIS	PLM	EMSL			
42	M - Floor - Ceramic Tile	42B	Men's & women's restrooms	ND		Yes	1/5/2012	ARCADIS	PLM	EMSL			
42	M - Floor - Ceramic Tile	42C	Men's & women's restrooms	ND		Yes	1/5/2012	ARCADIS	PLM	EMSL			
43	M - Floor - Ceramic Tile - Adhesive	43A	Men's & women's restrooms	ND		Yes	1/5/2012	ARCADIS	PLM	EMSL			
43	M - Floor - Ceramic Tile - Adhesive	43B	Men's & women's restrooms	ND		Yes	1/5/2012	ARCADIS	PLM	EMSL			
43	M - Floor - Ceramic Tile - Adhesive	43C	Men's & women's restrooms	ND		Yes	1/5/2012	ARCADIS	PLM	EMSL			
44	M - Floor - Ceramic Tile - Grout	44A	Men's & women's restrooms	ND		Yes	1/5/2012	ARCADIS	PLM	EMSL			
44	M - Floor - Ceramic Tile - Grout	44B	Men's & women's restrooms	ND		Yes	1/5/2012	ARCADIS	PLM	EMSL			
44	M - Floor - Ceramic Tile - Grout	44C	Men's & women's restrooms	ND		Yes	1/5/2012	ARCADIS	PLM	EMSL			
45	M - Floor - Vinyl Sheet Flooring (e.g. Linoleum)	45A	Breakroom, restroom, hallway coat closet	ND		No	1/5/2012	ARCADIS	PLM	EMSL			
45	M - Floor - Vinyl Sheet Flooring (e.g. Linoleum)	45B	Breakroom, restroom, hallway coat closet	ND		No	1/5/2012	ARCADIS	PLM	EMSL			
45	M - Floor - Vinyl Sheet Flooring (e.g. Linoleum)	45C	Breakroom, restroom, hallway coat closet	ND		No	1/5/2012	ARCADIS	PLM	EMSL			
46	M - Floor Backing	46A	Breakroom, restroom, hallway coat closet	ND		Yes	1/5/2012	ARCADIS	PLM	EMSL			
46	M - Floor Backing	46B	Breakroom, restroom, hallway coat closet	ND		Yes	1/5/2012	ARCADIS	PLM	EMSL			
46	M - Floor Backing	46C	Breakroom, restroom, hallway coat closet	ND		Yes	1/5/2012	ARCADIS	PLM	EMSL			





**Attachment C**

Laboratory Analytical Reports  
and Chain of Custody Form(s)



**EMSL Analytical, Inc.**

200 Route 130 North, Cinnaminson, NJ 08077

Phone: (800) 220-3675 Fax: (856) 786-5974 Email: [cinnaslab@EMSL.com](mailto:cinnaslab@EMSL.com)

Attn: **SAL MENDOZA**  
**ARCADIS U.S., Inc.**  
**194 Forbes Road**  
**Braintree, MA 02184**

Customer ID: ACAD78J  
Customer PO: 20208  
Received: 01/06/12 9:00 AM  
EMSL Order: 041200350

Fax: Phone: (781) 356-7300  
Project: **ARCADIS; BANK OF AMERICA CA2-103 901 HAZEL**  
**STREET, GRIDLEY, CALIF - HT117883.0085 - SAL**  
**MENDOZ**

EMSL Proj:  
Analysis Date: 1/9/2012

**Test Report: Asbestos Analysis of Bulk Materials via EPA 600/R-93/116 and/or EPA 600/M4-82-020 Method(s) using Polarized Light Microscopy**

Sample	Description	Appearance	Non-Asbestos		Asbestos
			% Fibrous	% Non-Fibrous	% Type
11A 041200350-0001	SDB (Beneath SDB) storage room - 9"x9" floor tile	Tan Non-Fibrous Homogeneous		100% Non-fibrous (other)	<1% Chrysotile
			HA: 11 HA Number: 11 Material Type: M - Floor Tile - 9" x 9" Friable: No		
11B 041200350-0002	SDB (Beneath SDB) storage room - 9"x9" floor tile	Tan Non-Fibrous Homogeneous		100% Non-fibrous (other)	<1% Chrysotile
			HA: 11 HA Number: 11 Material Type: M - Floor Tile - 9" x 9" Friable: No		
11C 041200350-0003	SDB (Beneath SDB) storage room - 9"x9" floor tile	Tan Non-Fibrous Homogeneous		100% Non-fibrous (other)	<1% Chrysotile
			HA: 11 HA Number: 11 Material Type: M - Floor Tile - 9" x 9" Friable: No		

Initial report from 01/09/2012 14:03:08

Analyst(s)  
\_\_\_\_\_  
Jennifer Keeling (2)                      Kenneth Dunbar (63)  
Jorge Leon (5)

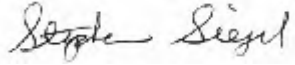
  
\_\_\_\_\_  
Stephen Siegel, CIH, Laboratory Manager  
or other approved signatory

EMSL maintains liability limited to the cost of analysis. This report relates only to the samples reported above and may not be reproduced, except in full, without written approval by EMSL. EMSL bears no responsibility for sample collection activities or analytical method limitations. Interpretation and use of test results are the responsibility of the client. This report must not be used by the client to claim product certification, approval or endorsement by NVLAP, NIST or any agency of the federal government. The test results contained within this report meet the requirements of NELAC unless otherwise specified. Samples received in good condition unless otherwise noted. Estimated accuracy, precision and uncertainty data available upon request.  
Samples analyzed by EMSL Analytical, Inc San Leandro, CA



**EMSL Analytical, Inc.**

200 Route 130 North, Cinnaminson, NJ 08077

Phone: (800) 220-3675 Fax: (856) 786-5974 Email: [cinnaslab@EMSL.com](mailto:cinnaslab@EMSL.com)

Attn: **SAL MENDOZA**  
**ARCADIS U.S., Inc.**  
**194 Forbes Road**  
**Braintree, MA 02184**

Customer ID: ACAD78J  
Customer PO: 20208  
Received: 01/06/12 9:00 AM  
EMSL Order: 041200350

Fax: Phone: (781) 356-7300  
Project: **ARCADIS; BANK OF AMERICA CA2-103 901 HAZEL**  
**STREET, GRIDLEY, CALIF - HT117883.0085 - SAL**  
**MENDOZ**

EMSL Proj:  
Analysis Date: 1/9/2012

**Test Report: Asbestos Analysis of Bulk Materials via EPA 600/R-93/116 and/or EPA 600/M4-82-020 Method(s) using Polarized Light Microscopy**

Sample	Description	Appearance	Non-Asbestos		Asbestos
			% Fibrous	% Non-Fibrous	% Type
15A <i>041200350-0004</i>	SDB (Beneath SDB) storage room - Mastic to HA11				Insufficient Material
			HA: 15 HA Number: 15 Material Type: M - Floor Tile - Mastic/Adhesive Friable: No		
15B <i>041200350-0005</i>	SDB (Beneath SDB) storage room - Mastic to HA11	Black Non-Fibrous Homogeneous		90% Non-fibrous (other)	10% Chrysotile
			HA: 15 HA Number: 15 Material Type: M - Floor Tile - Mastic/Adhesive Friable: No		
15C <i>041200350-0006</i>	SDB (Beneath SDB) storage room - Mastic to HA11				Stop Positive (Not Analyzed)
			HA: 15 HA Number: 15 Material Type: M - Floor Tile - Mastic/Adhesive Friable: No		

Initial report from 01/09/2012 14:03:08

Analyst(s)  
Jennifer Keeling (2)                      Kenneth Dunbar (63)  
Jorge Leon (5)

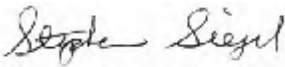
  
\_\_\_\_\_  
Stephen Siegel, CIH, Laboratory Manager  
or other approved signatory

EMSL maintains liability limited to the cost of analysis. This report relates only to the samples reported above and may not be reproduced, except in full, without written approval by EMSL. EMSL bears no responsibility for sample collection activities or analytical method limitations. Interpretation and use of test results are the responsibility of the client. This report must not be used by the client to claim product certification, approval or endorsement by NVLAP, NIST or any agency of the federal government. The test results contained within this report meet the requirements of NELAC unless otherwise specified. Samples received in good condition unless otherwise noted. Estimated accuracy, precision and uncertainty data available upon request.  
Samples analyzed by EMSL Analytical, Inc San Leandro, CA



**EMSL Analytical, Inc.**

200 Route 130 North, Cinnaminson, NJ 08077

Phone: (800) 220-3675 Fax: (856) 786-5974 Email: [cinnaslab@EMSL.com](mailto:cinnaslab@EMSL.com)

Attn: **SAL MENDOZA**  
**ARCADIS U.S., Inc.**  
**194 Forbes Road**  
**Braintree, MA 02184**

Customer ID: ACAD78J  
Customer PO: 20208  
Received: 01/06/12 9:00 AM  
EMSL Order: 041200350

Fax: Phone: (781) 356-7300  
Project: **ARCADIS; BANK OF AMERICA CA2-103 901 HAZEL**  
**STREET, GRIDLEY, CALIF - HT117883.0085 - SAL**  
**MENDOZ**

EMSL Proj:  
Analysis Date: 1/9/2012

**Test Report: Asbestos Analysis of Bulk Materials via EPA 600/R-93/116 and/or EPA 600/M4-82-020 Method(s) using Polarized Light Microscopy**

Sample	Description	Appearance	Non-Asbestos		Asbestos
			% Fibrous	% Non-Fibrous	% Type
12A 041200350-0007	Conf. rm, hallway, breakroom, lobby, teller area - Vinyl Floor Tile 12"x12" w/ brown streaking	Tan Non-Fibrous Homogeneous		100% Non-fibrous (other)	None Detected
			HA: 12 HA Number: 12 Material Type: M - Floor Tile - 12" x 12" Friable: No		
12B 041200350-0008	Conf. rm, hallway, breakroom, lobby, teller area - Vinyl Floor Tile 12"x12" w/ brown streaking	Tan Non-Fibrous Homogeneous		100% Non-fibrous (other)	None Detected
			HA: 12 HA Number: 12 Material Type: M - Floor Tile - 12" x 12" Friable: No		
12C 041200350-0009	Conf. rm, hallway, breakroom, lobby, teller area - Vinyl Floor Tile 12"x12" w/ brown streaking	Tan Non-Fibrous Homogeneous		100% Non-fibrous (other)	None Detected
			HA: 12 HA Number: 12 Material Type: M - Floor Tile - 12" x 12" Friable: No		

Initial report from 01/09/2012 14:03:08

Analyst(s)  
Jennifer Keeling (2)                      Kenneth Dunbar (63)  
Jorge Leon (5)

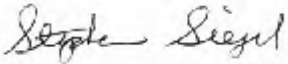
  
\_\_\_\_\_  
Stephen Siegel, CIH, Laboratory Manager  
or other approved signatory

EMSL maintains liability limited to the cost of analysis. This report relates only to the samples reported above and may not be reproduced, except in full, without written approval by EMSL. EMSL bears no responsibility for sample collection activities or analytical method limitations. Interpretation and use of test results are the responsibility of the client. This report must not be used by the client to claim product certification, approval or endorsement by NVLAP, NIST or any agency of the federal government. The test results contained within this report meet the requirements of NELAC unless otherwise specified. Samples received in good condition unless otherwise noted. Estimated accuracy, precision and uncertainty data available upon request.  
Samples analyzed by EMSL Analytical, Inc San Leandro, CA



**EMSL Analytical, Inc.**

200 Route 130 North, Cinnaminson, NJ 08077

Phone: (800) 220-3675 Fax: (856) 786-5974 Email: [cinnaslab@EMSL.com](mailto:cinnaslab@EMSL.com)

Attn: **SAL MENDOZA**  
**ARCADIS U.S., Inc.**  
**194 Forbes Road**  
**Braintree, MA 02184**

Customer ID: ACAD78J  
Customer PO: 20208  
Received: 01/06/12 9:00 AM  
EMSL Order: 041200350

Fax: Phone: (781) 356-7300  
Project: **ARCADIS; BANK OF AMERICA CA2-103 901 HAZEL**  
**STREET, GRIDLEY, CALIF - HT117883.0085 - SAL**  
**MENDOZ**

EMSL Proj:  
Analysis Date: 1/9/2012

**Test Report: Asbestos Analysis of Bulk Materials via EPA 600/R-93/116 and/or EPA 600/M4-82-020 Method(s) using Polarized Light Microscopy**

Sample	Description	Appearance	Non-Asbestos		Asbestos
			% Fibrous	% Non-Fibrous	% Type
13A YELLOW MASTIC <small>041200350-0010</small>	Conf. rm, hallway, breakroom, lobby, teller area - Mastic To HA-12	Yellow Non-Fibrous Homogeneous		100% Non-fibrous (other)	None Detected
<small>HA: 13 HA Number: 13 Material Type: M - Floor Tile - Mastic/Adhesive Friable: No</small>					
13A BLACK MASTIC <small>041200350-0010A</small>	Conf. rm, hallway, breakroom, lobby, teller area - Mastic To HA-12	Black Non-Fibrous Homogeneous		95% Non-fibrous (other)	5% Chrysotile
<small>HA: 13 HA Number: 13 Material Type: M - Floor Tile - Mastic/Adhesive Friable: No</small>					
13B YELLOW MASTIC <small>041200350-0011</small>	Conf. rm, hallway, breakroom, lobby, teller area - Mastic To HA-12	Yellow Non-Fibrous Heterogeneous		100% Non-fibrous (other)	None Detected
<small>HA: 13 HA Number: 13 Material Type: M - Floor Tile - Mastic/Adhesive Friable: No</small>					

Initial report from 01/09/2012 14:03:08

Analyst(s)

Jennifer Keeling (2)  
Jorge Leon (5)

Kenneth Dunbar (63)

Stephen Siegel, CIH, Laboratory Manager  
or other approved signatory

EMSL maintains liability limited to the cost of analysis. This report relates only to the samples reported above and may not be reproduced, except in full, without written approval by EMSL. EMSL bears no responsibility for sample collection activities or analytical method limitations. Interpretation and use of test results are the responsibility of the client. This report must not be used by the client to claim product certification, approval or endorsement by NVLAP, NIST or any agency of the federal government. The test results contained within this report meet the requirements of NELAC unless otherwise specified. Samples received in good condition unless otherwise noted. Estimated accuracy, precision and uncertainty data available upon request.  
Samples analyzed by EMSL Analytical, Inc San Leandro, CA



**EMSL Analytical, Inc.**

200 Route 130 North, Cinnaminson, NJ 08077

Phone: (800) 220-3675 Fax: (856) 786-5974 Email: [cinnaslab@EMSL.com](mailto:cinnaslab@EMSL.com)

Attn: **SAL MENDOZA**  
**ARCADIS U.S., Inc.**  
**194 Forbes Road**  
**Braintree, MA 02184**

Customer ID: ACAD78J  
Customer PO: 20208  
Received: 01/06/12 9:00 AM  
EMSL Order: 041200350

Fax: Phone: (781) 356-7300  
Project: **ARCADIS; BANK OF AMERICA CA2-103 901 HAZEL**  
**STREET, GRIDLEY, CALIF - HT117883.0085 - SAL**  
**MENDOZ**

EMSL Proj:  
Analysis Date: 1/9/2012

**Test Report: Asbestos Analysis of Bulk Materials via EPA 600/R-93/116 and/or EPA 600/M4-82-020 Method(s) using Polarized Light Microscopy**

Sample	Description	Appearance	Non-Asbestos		Asbestos
			% Fibrous	% Non-Fibrous	% Type
13B BLACK MASTIC <i>041200350-0011A</i>	Conf. rm, hallway, breakroom, lobby, teller area - Mastic To HA-12				Stop Positive (Not Analyzed)
			HA: 13 HA Number: 13 Material Type: M - Floor Tile - Mastic/Adhesive Friable: No		
13C YELLOW MASTIC <i>041200350-0012</i>	Conf. rm, hallway, breakroom, lobby, teller area - Mastic To HA-12	Yellow Non-Fibrous Homogeneous		100% Non-fibrous (other)	None Detected
			HA: 13 HA Number: 13 Material Type: M - Floor Tile - Mastic/Adhesive Friable: No		
13C BLACK MASTIC <i>041200350-0012A</i>	Conf. rm, hallway, breakroom, lobby, teller area - Mastic To HA-12				Stop Positive (Not Analyzed)
			HA: 13 HA Number: 13 Material Type: M - Floor Tile - Mastic/Adhesive Friable: No 999999		

Initial report from 01/09/2012 14:03:08

Analyst(s)  
Jennifer Keeling (2)                      Kenneth Dunbar (63)  
Jorge Leon (5)

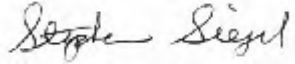
  
\_\_\_\_\_  
Stephen Siegel, CIH, Laboratory Manager  
or other approved signatory

EMSL maintains liability limited to the cost of analysis. This report relates only to the samples reported above and may not be reproduced, except in full, without written approval by EMSL. EMSL bears no responsibility for sample collection activities or analytical method limitations. Interpretation and use of test results are the responsibility of the client. This report must not be used by the client to claim product certification, approval or endorsement by NVLAP, NIST or any agency of the federal government. The test results contained within this report meet the requirements of NELAC unless otherwise specified. Samples received in good condition unless otherwise noted. Estimated accuracy, precision and uncertainty data available upon request.  
Samples analyzed by EMSL Analytical, Inc San Leandro, CA





**EMSL Analytical, Inc.**

200 Route 130 North, Cinnaminson, NJ 08077

Phone: (800) 220-3675 Fax: (856) 786-5974 Email: [cinnaslab@EMSL.com](mailto:cinnaslab@EMSL.com)

Attn: **SAL MENDOZA**  
**ARCADIS U.S., Inc.**  
**194 Forbes Road**  
**Braintree, MA 02184**

Customer ID: ACAD78J  
Customer PO: 20208  
Received: 01/06/12 9:00 AM  
EMSL Order: 041200350

Fax: Phone: (781) 356-7300  
Project: **ARCADIS; BANK OF AMERICA CA2-103 901 HAZEL**  
**STREET, GRIDLEY, CALIF - HT117883.0085 - SAL**  
**MENDOZ**

EMSL Proj:  
Analysis Date: 1/9/2012

**Test Report: Asbestos Analysis of Bulk Materials via EPA 600/R-93/116 and/or EPA 600/M4-82-020 Method(s) using Polarized Light Microscopy**

Sample	Description	Appearance	Non-Asbestos		Asbestos
			% Fibrous	% Non-Fibrous	% Type
14A 041200350-0013	ATM/NER - Mastic To HA-8	Yellow Non-Fibrous Homogeneous		100% Non-fibrous (other)	None Detected
HA: 14 HA Number: 14 Material Type: M - Floor Tile - Mastic/Adhesive Friable: No					
25A 041200350-0014	Beneath carpet for teller & platform - Mastic To HA-24	Black Non-Fibrous Homogeneous		92% Non-fibrous (other)	8% Chrysotile
HA: 25 HA Number: 25 Material Type: M - Floor Tile - Mastic/Adhesive Friable: No					
16A 041200350-0015	Throughout 1st floor - 2'x4' suspended Ceiling Tile	White Fibrous Homogeneous	70% Cellulose 20% Glass	10% Non-fibrous (other)	None Detected
HA: 16 HA Number: 16 Material Type: M - Ceiling Tile - 2' x 4' Friable: Yes					
16B 041200350-0016	Throughout 1st floor - 2'x4' suspended Ceiling Tile	White Fibrous Homogeneous	70% Cellulose 20% Glass	10% Non-fibrous (other)	None Detected
HA: 16 HA Number: 16 Material Type: M - Ceiling Tile - 2' x 4' Friable: Yes					

Initial report from 01/09/2012 14:03:08

Analyst(s)  
Jennifer Keeling (2)                      Kenneth Dunbar (63)  
Jorge Leon (5)

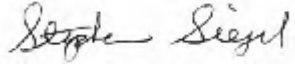
  
\_\_\_\_\_  
Stephen Siegel, CIH, Laboratory Manager  
or other approved signatory

EMSL maintains liability limited to the cost of analysis. This report relates only to the samples reported above and may not be reproduced, except in full, without written approval by EMSL. EMSL bears no responsibility for sample collection activities or analytical method limitations. Interpretation and use of test results are the responsibility of the client. This report must not be used by the client to claim product certification, approval or endorsement by NVLAP, NIST or any agency of the federal government. The test results contained within this report meet the requirements of NELAC unless otherwise specified. Samples received in good condition unless otherwise noted. Estimated accuracy, precision and uncertainty data available upon request.  
Samples analyzed by EMSL Analytical, Inc San Leandro, CA



**EMSL Analytical, Inc.**

200 Route 130 North, Cinnaminson, NJ 08077

Phone: (800) 220-3675 Fax: (856) 786-5974 Email: [cinnaslab@EMSL.com](mailto:cinnaslab@EMSL.com)

Attn: **SAL MENDOZA**  
**ARCADIS U.S., Inc.**  
**194 Forbes Road**  
**Braintree, MA 02184**

Customer ID: ACAD78J  
Customer PO: 20208  
Received: 01/06/12 9:00 AM  
EMSL Order: 041200350

Fax: Phone: (781) 356-7300  
Project: **ARCADIS; BANK OF AMERICA CA2-103 901 HAZEL**  
**STREET, GRIDLEY, CALIF - HT117883.0085 - SAL**  
**MENDOZ**

EMSL Proj:  
Analysis Date: 1/9/2012

**Test Report: Asbestos Analysis of Bulk Materials via EPA 600/R-93/116 and/or EPA 600/M4-82-020 Method(s) using Polarized Light Microscopy**

Sample	Description	Appearance	Non-Asbestos		Asbestos
			% Fibrous	% Non-Fibrous	% Type
16C 041200350-0017	Throughout 1st floor - 2'x4' suspended Ceiling Tile	White Fibrous Homogeneous	70% Cellulose 20% Glass	10% Non-fibrous (other)	None Detected
			HA: 16 HA Number: 16 Material Type: M - Ceiling Tile - 2' x 4' Friable: Yes		
17A 041200350-0018	Vault & SDB - 12"x12" tan streaks Vinyl Floor tile	Tan/White Non-Fibrous Homogeneous		100% Non-fibrous (other)	None Detected
			HA: 17 HA Number: 17 Material Type: M - Floor Tile - 12" x 12" Friable: No		
17B 041200350-0019	Vault & SDB - 12"x12" tan streaks Vinyl Floor tile	Tan/White Non-Fibrous Homogeneous		100% Non-fibrous (other)	None Detected
			HA: 17 HA Number: 17 Material Type: M - Floor Tile - 12" x 12" Friable: No		

Initial report from 01/09/2012 14:03:08

Analyst(s)  
\_\_\_\_\_  
Jennifer Keeling (2)                      Kenneth Dunbar (63)  
Jorge Leon (5)

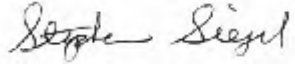
  
\_\_\_\_\_  
Stephen Siegel, CIH, Laboratory Manager  
or other approved signatory

EMSL maintains liability limited to the cost of analysis. This report relates only to the samples reported above and may not be reproduced, except in full, without written approval by EMSL. EMSL bears no responsibility for sample collection activities or analytical method limitations. Interpretation and use of test results are the responsibility of the client. This report must not be used by the client to claim product certification, approval or endorsement by NVLAP, NIST or any agency of the federal government. The test results contained within this report meet the requirements of NELAC unless otherwise specified. Samples received in good condition unless otherwise noted. Estimated accuracy, precision and uncertainty data available upon request.  
Samples analyzed by EMSL Analytical, Inc San Leandro, CA



**EMSL Analytical, Inc.**

200 Route 130 North, Cinnaminson, NJ 08077

Phone: (800) 220-3675 Fax: (856) 786-5974 Email: [cinnaslab@EMSL.com](mailto:cinnaslab@EMSL.com)

Attn: **SAL MENDOZA**  
**ARCADIS U.S., Inc.**  
**194 Forbes Road**  
**Braintree, MA 02184**

Customer ID: ACAD78J  
Customer PO: 20208  
Received: 01/06/12 9:00 AM  
EMSL Order: 041200350

Fax: Phone: (781) 356-7300  
Project: **ARCADIS; BANK OF AMERICA CA2-103 901 HAZEL**  
**STREET, GRIDLEY, CALIF - HT117883.0085 - SAL**  
**MENDOZ**

EMSL Proj:  
Analysis Date: 1/9/2012

**Test Report: Asbestos Analysis of Bulk Materials via EPA 600/R-93/116 and/or EPA 600/M4-82-020 Method(s) using Polarized Light Microscopy**

Sample	Description	Appearance	Non-Asbestos		Asbestos
			% Fibrous	% Non-Fibrous	% Type
17C <i>041200350-0020</i>	Vault & SDB - 12"x12" tan streaks Vinyl Floor tile	Tan/Black Non-Fibrous Homogeneous		100% Non-fibrous (other)	None Detected
			HA: 17 HA Number: 17 Material Type: M - Floor Tile - 12" x 12" Friable: No		
18A <i>041200350-0021</i>	Vault & SDB - Mastic To HA-17	Brown Non-Fibrous Homogeneous		100% Non-fibrous (other)	None Detected
			HA: 18 HA Number: 18 Material Type: M - Floor Tile - Mastic/Adhesive Friable: No No Black mastic found		
18B <i>041200350-0022</i>	Vault & SDB - Mastic To HA-17	Brown Non-Fibrous Homogeneous		100% Non-fibrous (other)	None Detected
			HA: 18 HA Number: 18 Material Type: M - Floor Tile - Mastic/Adhesive Friable: No No Black mastic found		

Initial report from 01/09/2012 14:03:08

Analyst(s)  
Jennifer Keeling (2)                      Kenneth Dunbar (63)  
Jorge Leon (5)

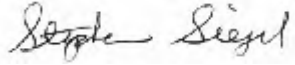
  
\_\_\_\_\_  
Stephen Siegel, CIH, Laboratory Manager  
or other approved signatory

EMSL maintains liability limited to the cost of analysis. This report relates only to the samples reported above and may not be reproduced, except in full, without written approval by EMSL. EMSL bears no responsibility for sample collection activities or analytical method limitations. Interpretation and use of test results are the responsibility of the client. This report must not be used by the client to claim product certification, approval or endorsement by NVLAP, NIST or any agency of the federal government. The test results contained within this report meet the requirements of NELAC unless otherwise specified. Samples received in good condition unless otherwise noted. Estimated accuracy, precision and uncertainty data available upon request.  
Samples analyzed by EMSL Analytical, Inc San Leandro, CA



**EMSL Analytical, Inc.**

200 Route 130 North, Cinnaminson, NJ 08077

Phone: (800) 220-3675 Fax: (856) 786-5974 Email: [cinnaslab@EMSL.com](mailto:cinnaslab@EMSL.com)

Attn: **SAL MENDOZA**  
**ARCADIS U.S., Inc.**  
**194 Forbes Road**  
**Braintree, MA 02184**

Customer ID: ACAD78J  
Customer PO: 20208  
Received: 01/06/12 9:00 AM  
EMSL Order: 041200350

Fax: Phone: (781) 356-7300  
Project: **ARCADIS; BANK OF AMERICA CA2-103 901 HAZEL**  
**STREET, GRIDLEY, CALIF - HT117883.0085 - SAL**  
**MENDOZ**

EMSL Proj:  
Analysis Date: 1/9/2012

**Test Report: Asbestos Analysis of Bulk Materials via EPA 600/R-93/116 and/or EPA 600/M4-82-020 Method(s) using Polarized Light Microscopy**

Sample	Description	Appearance	Non-Asbestos		Asbestos
			% Fibrous	% Non-Fibrous	% Type
18C 041200350-0023	Vault & SDB - Mastic To HA-17	Brown Non-Fibrous Homogeneous		100% Non-fibrous (other)	None Detected
			HA: 18 HA Number: 18 Material Type: M - Floor Tile - Mastic/Adhesive Friable: No No Black mastic found		
19A 041200350-0024	Above the false ceiling panels - breakroom - 1'x1' Ceiling Tiles	White Fibrous Homogeneous	90% Glass	10% Non-fibrous (other)	None Detected
			HA: 19 HA Number: 19 Material Type: M - Ceiling Tile - 1' x 1' Friable: Yes		
19B 041200350-0025	Above the false ceiling panels - breakroom - 1'x1' Ceiling Tiles	White Fibrous Homogeneous	90% Glass	10% Non-fibrous (other)	None Detected
			HA: 19 HA Number: 19 Material Type: M - Ceiling Tile - 1' x 1' Friable: Yes		

Initial report from 01/09/2012 14:03:08

Analyst(s)  
\_\_\_\_\_  
Jennifer Keeling (2)                      Kenneth Dunbar (63)  
Jorge Leon (5)

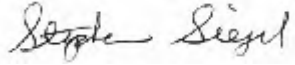
  
\_\_\_\_\_  
Stephen Siegel, CIH, Laboratory Manager  
or other approved signatory

EMSL maintains liability limited to the cost of analysis. This report relates only to the samples reported above and may not be reproduced, except in full, without written approval by EMSL. EMSL bears no responsibility for sample collection activities or analytical method limitations. Interpretation and use of test results are the responsibility of the client. This report must not be used by the client to claim product certification, approval or endorsement by NVLAP, NIST or any agency of the federal government. The test results contained within this report meet the requirements of NELAC unless otherwise specified. Samples received in good condition unless otherwise noted. Estimated accuracy, precision and uncertainty data available upon request.  
Samples analyzed by EMSL Analytical, Inc San Leandro, CA



**EMSL Analytical, Inc.**

200 Route 130 North, Cinnaminson, NJ 08077

Phone: (800) 220-3675 Fax: (856) 786-5974 Email: [cinnaslab@EMSL.com](mailto:cinnaslab@EMSL.com)

Attn: **SAL MENDOZA**  
**ARCADIS U.S., Inc.**  
**194 Forbes Road**  
**Braintree, MA 02184**

Customer ID: ACAD78J  
Customer PO: 20208  
Received: 01/06/12 9:00 AM  
EMSL Order: 041200350

Fax: Phone: (781) 356-7300  
Project: **ARCADIS; BANK OF AMERICA CA2-103 901 HAZEL**  
**STREET, GRIDLEY, CALIF - HT117883.0085 - SAL**  
**MENDOZ**

EMSL Proj:  
Analysis Date: 1/9/2012

**Test Report: Asbestos Analysis of Bulk Materials via EPA 600/R-93/116 and/or EPA 600/M4-82-020 Method(s) using Polarized Light Microscopy**

Sample	Description	Appearance	Non-Asbestos		Asbestos
			% Fibrous	% Non-Fibrous	% Type
19C 041200350-0026	Above the false ceiling panels - breakroom - 1'x1' Ceiling Tiles	White Non-Fibrous Homogeneous	90% Glass	10% Non-fibrous (other)	None Detected
			HA: 19 HA Number: 19 Material Type: M - Ceiling Tile - 1' x 1' Friable: Yes		
21A 041200350-0027	Throughout - 4" cove bases	Black Non-Fibrous Homogeneous		100% Non-fibrous (other)	None Detected
			HA: 21 HA Number: 21 Material Type: M - Cove Base Friable: No		
21B 041200350-0028	Throughout - 4" cove bases	Black Non-Fibrous Homogeneous		100% Non-fibrous (other)	None Detected
			HA: 21 HA Number: 21 Material Type: M - Cove Base Friable: No		
21C 041200350-0029	Throughout - 4" cove bases	Black Non-Fibrous Homogeneous		100% Non-fibrous (other)	None Detected
			HA: 21 HA Number: 21 Material Type: M - Cove Base Friable: No		

Initial report from 01/09/2012 14:03:08

Analyst(s)  
\_\_\_\_\_  
Jennifer Keeling (2)                      Kenneth Dunbar (63)  
Jorge Leon (5)

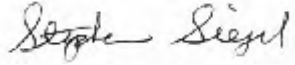
  
\_\_\_\_\_  
Stephen Siegel, CIH, Laboratory Manager  
or other approved signatory

EMSL maintains liability limited to the cost of analysis. This report relates only to the samples reported above and may not be reproduced, except in full, without written approval by EMSL. EMSL bears no responsibility for sample collection activities or analytical method limitations. Interpretation and use of test results are the responsibility of the client. This report must not be used by the client to claim product certification, approval or endorsement by NVLAP, NIST or any agency of the federal government. The test results contained within this report meet the requirements of NELAC unless otherwise specified. Samples received in good condition unless otherwise noted. Estimated accuracy, precision and uncertainty data available upon request.  
Samples analyzed by EMSL Analytical, Inc San Leandro, CA



**EMSL Analytical, Inc.**

200 Route 130 North, Cinnaminson, NJ 08077

Phone: (800) 220-3675 Fax: (856) 786-5974 Email: [cinnaslab@EMSL.com](mailto:cinnaslab@EMSL.com)

Attn: **SAL MENDOZA**  
**ARCADIS U.S., Inc.**  
**194 Forbes Road**  
**Braintree, MA 02184**

Customer ID: ACAD78J  
Customer PO: 20208  
Received: 01/06/12 9:00 AM  
EMSL Order: 041200350

Fax: Phone: (781) 356-7300  
Project: **ARCADIS; BANK OF AMERICA CA2-103 901 HAZEL**  
**STREET, GRIDLEY, CALIF - HT117883.0085 - SAL**  
**MENDOZ**

EMSL Proj:  
Analysis Date: 1/9/2012

**Test Report: Asbestos Analysis of Bulk Materials via EPA 600/R-93/116 and/or EPA 600/M4-82-020 Method(s) using Polarized Light Microscopy**

Sample	Description	Appearance	Non-Asbestos		Asbestos
			% Fibrous	% Non-Fibrous	% Type
27A 041200350-0030	ATM/NER - 12"x12" w/ large brown streaks Floor Tile	Beige Non-Fibrous Homogeneous		98% Non-fibrous (other)	2% Chrysotile
			HA: 27 HA Number: 27 Material Type: M - Floor Tile - 12" x 12" Friable: No		
27B 041200350-0031	ATM/NER - 12"x12" w/ large brown streaks Floor Tile				<b>Stop Positive (Not Analyzed)</b>
			HA: 27 HA Number: 27 Material Type: M - Floor Tile - 12" x 12" Friable: No		
27C 041200350-0032	ATM/NER - 12"x12" w/ large brown streaks Floor Tile				<b>Stop Positive (Not Analyzed)</b>
			HA: 27 HA Number: 27 Material Type: M - Floor Tile - 12" x 12" Friable: No		

Initial report from 01/09/2012 14:03:08

Analyst(s)  
\_\_\_\_\_  
Jennifer Keeling (2)                      Kenneth Dunbar (63)  
Jorge Leon (5)

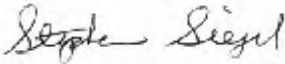
  
\_\_\_\_\_  
Stephen Siegel, CIH, Laboratory Manager  
or other approved signatory

EMSL maintains liability limited to the cost of analysis. This report relates only to the samples reported above and may not be reproduced, except in full, without written approval by EMSL. EMSL bears no responsibility for sample collection activities or analytical method limitations. Interpretation and use of test results are the responsibility of the client. This report must not be used by the client to claim product certification, approval or endorsement by NVLAP, NIST or any agency of the federal government. The test results contained within this report meet the requirements of NELAC unless otherwise specified. Samples received in good condition unless otherwise noted. Estimated accuracy, precision and uncertainty data available upon request.  
Samples analyzed by EMSL Analytical, Inc San Leandro, CA



**EMSL Analytical, Inc.**

200 Route 130 North, Cinnaminson, NJ 08077

Phone: (800) 220-3675 Fax: (856) 786-5974 Email: [cinnaslab@EMSL.com](mailto:cinnaslab@EMSL.com)

Attn: **SAL MENDOZA**  
**ARCADIS U.S., Inc.**  
**194 Forbes Road**  
**Braintree, MA 02184**

Customer ID: ACAD78J  
Customer PO: 20208  
Received: 01/06/12 9:00 AM  
EMSL Order: 041200350

Fax: Phone: (781) 356-7300  
Project: **ARCADIS; BANK OF AMERICA CA2-103 901 HAZEL**  
**STREET, GRIDLEY, CALIF - HT117883.0085 - SAL**  
**MENDOZ**

EMSL Proj:  
Analysis Date: 1/9/2012

**Test Report: Asbestos Analysis of Bulk Materials via EPA 600/R-93/116 and/or EPA 600/M4-82-020 Method(s) using Polarized Light Microscopy**

Sample	Description	Appearance	Non-Asbestos		Asbestos
			% Fibrous	% Non-Fibrous	% Type
28A 041200350-0033	ATM/NER - Mastic To HA-27	Black Non-Fibrous Homogeneous		95% Non-fibrous (other)	5% Chrysotile
			HA: 28 HA Number: 28 Material Type: M - Floor Tile - Mastic/Adhesive Friable: No		
28B 041200350-0034	ATM/NER - Mastic To HA-27				Stop Positive (Not Analyzed)
			HA: 28 HA Number: 28 Material Type: M - Floor Tile - Mastic/Adhesive Friable: No		
28C 041200350-0035	ATM/NER - Mastic To HA-27				Stop Positive (Not Analyzed)
			HA: 28 HA Number: 28 Material Type: M - Floor Tile - Mastic/Adhesive Friable: No		
29A 041200350-0036	ATM/NER - Beneath HA-27 Levelastic	White Non-Fibrous Homogeneous		100% Non-fibrous (other)	None Detected
			HA: 29 HA Number: 29 Material Type: M - Floor - Leveling Compound Friable: Yes		

Initial report from 01/09/2012 14:03:08

Analyst(s)

Jennifer Keeling (2)  
Jorge Leon (5)

Kenneth Dunbar (63)

Stephen Siegel, CIH, Laboratory Manager  
or other approved signatory

EMSL maintains liability limited to the cost of analysis. This report relates only to the samples reported above and may not be reproduced, except in full, without written approval by EMSL. EMSL bears no responsibility for sample collection activities or analytical method limitations. Interpretation and use of test results are the responsibility of the client. This report must not be used by the client to claim product certification, approval or endorsement by NVLAP, NIST or any agency of the federal government. The test results contained within this report meet the requirements of NELAC unless otherwise specified. Samples received in good condition unless otherwise noted. Estimated accuracy, precision and uncertainty data available upon request.

Samples analyzed by EMSL Analytical, Inc San Leandro, CA



**EMSL Analytical, Inc.**

200 Route 130 North, Cinnaminson, NJ 08077

Phone: (800) 220-3675 Fax: (856) 786-5974 Email: [cinnaslab@EMSL.com](mailto:cinnaslab@EMSL.com)

Attn: **SAL MENDOZA**  
**ARCADIS U.S., Inc.**  
**194 Forbes Road**  
**Braintree, MA 02184**

Customer ID: ACAD78J  
Customer PO: 20208  
Received: 01/06/12 9:00 AM  
EMSL Order: 041200350

Fax: Phone: (781) 356-7300  
Project: **ARCADIS; BANK OF AMERICA CA2-103 901 HAZEL**  
**STREET, GRIDLEY, CALIF - HT117883.0085 - SAL**  
**MENDOZ**

EMSL Proj:  
Analysis Date: 1/9/2012

**Test Report: Asbestos Analysis of Bulk Materials via EPA 600/R-93/116 and/or EPA 600/M4-82-020 Method(s) using Polarized Light Microscopy**

Sample	Description	Appearance	Non-Asbestos		Asbestos
			% Fibrous	% Non-Fibrous	% Type
29B 041200350-0037	ATM/NER - Beneath HA-27 Levelastic	White Non-Fibrous Homogeneous		100% Non-fibrous (other)	None Detected
			HA: 29 HA Number: 29 Material Type: M - Floor - Leveling Compound Friable: Yes		
29C 041200350-0038	ATM/NER - Beneath HA-27 Levelastic	White Non-Fibrous Homogeneous		100% Non-fibrous (other)	None Detected
			HA: 29 HA Number: 29 Material Type: M - Floor - Leveling Compound Friable: Yes		
30 NOT SAMPLED 041200350-0039	ATM/NER- NOT SAMPLED - To sound wall				Not Submitted
			HA: 30 HA Number: 30 Material Type: M - Construction Mastics - Describe Friable: No		
31A 041200350-0040	ATM/NER - Beneath HA-12 & 13 Levelastic	Gray Non-Fibrous Homogeneous		100% Non-fibrous (other)	None Detected
			HA: 31 HA Number: 31 Material Type: M - Floor - Leveling Compound Friable: Yes		

Initial report from 01/09/2012 14:03:08

Analyst(s)  
Jennifer Keeling (2)                      Kenneth Dunbar (63)  
Jorge Leon (5)

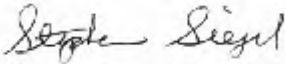
  
\_\_\_\_\_  
Stephen Siegel, CIH, Laboratory Manager  
or other approved signatory

EMSL maintains liability limited to the cost of analysis. This report relates only to the samples reported above and may not be reproduced, except in full, without written approval by EMSL. EMSL bears no responsibility for sample collection activities or analytical method limitations. Interpretation and use of test results are the responsibility of the client. This report must not be used by the client to claim product certification, approval or endorsement by NVLAP, NIST or any agency of the federal government. The test results contained within this report meet the requirements of NELAC unless otherwise specified. Samples received in good condition unless otherwise noted. Estimated accuracy, precision and uncertainty data available upon request.  
Samples analyzed by EMSL Analytical, Inc San Leandro, CA





**EMSL Analytical, Inc.**

200 Route 130 North, Cinnaminson, NJ 08077

Phone: (800) 220-3675 Fax: (856) 786-5974 Email: [cinnaslab@EMSL.com](mailto:cinnaslab@EMSL.com)

Attn: **SAL MENDOZA**  
**ARCADIS U.S., Inc.**  
**194 Forbes Road**  
**Braintree, MA 02184**

Customer ID: ACAD78J  
Customer PO: 20208  
Received: 01/06/12 9:00 AM  
EMSL Order: 041200350

Fax: Phone: (781) 356-7300  
Project: **ARCADIS; BANK OF AMERICA CA2-103 901 HAZEL**  
**STREET, GRIDLEY, CALIF - HT117883.0085 - SAL**  
**MENDOZ**

EMSL Proj:  
Analysis Date: 1/9/2012

**Test Report: Asbestos Analysis of Bulk Materials via EPA 600/R-93/116 and/or EPA 600/M4-82-020 Method(s) using Polarized Light Microscopy**

Sample	Description	Appearance	Non-Asbestos		Asbestos
			% Fibrous	% Non-Fibrous	% Type
31C 041200350-0041	ATM/NER - Beneath HA-12 & 13 Levelastic	Gray Non-Fibrous Homogeneous		100% Non-fibrous (other)	None Detected
			HA: 31 HA Number: 31 Material Type: M - Floor - Leveling Compound Friable: Yes		
32A 041200350-0042	ATM/NER - Beneath HA-8 patch Residual Mastic	Black Non-Fibrous Homogeneous		95% Non-fibrous (other)	5% Chrysotile
			HA: 32 HA Number: 32 Material Type: M - Construction Mastics - Describe Friable: No		
33A 041200350-0043	Breakroom - Ceiling tile mastic To HA-19	Brown Non-Fibrous Homogeneous		100% Non-fibrous (other)	None Detected
			HA: 33 HA Number: 33 Material Type: M - Ceiling Tile - Glue/Adhesive Friable: Yes		
33B 041200350-0044	Breakroom - Ceiling tile mastic To HA-19	Brown Non-Fibrous Homogeneous		100% Non-fibrous (other)	None Detected
			HA: 33 HA Number: 33 Material Type: M - Ceiling Tile - Glue/Adhesive Friable: Yes		

Initial report from 01/09/2012 14:03:08

Analyst(s)  
Jennifer Keeling (2)                      Kenneth Dunbar (63)  
Jorge Leon (5)

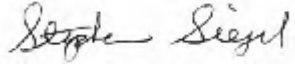
  
\_\_\_\_\_  
Stephen Siegel, CIH, Laboratory Manager  
or other approved signatory

EMSL maintains liability limited to the cost of analysis. This report relates only to the samples reported above and may not be reproduced, except in full, without written approval by EMSL. EMSL bears no responsibility for sample collection activities or analytical method limitations. Interpretation and use of test results are the responsibility of the client. This report must not be used by the client to claim product certification, approval or endorsement by NVLAP, NIST or any agency of the federal government. The test results contained within this report meet the requirements of NELAC unless otherwise specified. Samples received in good condition unless otherwise noted. Estimated accuracy, precision and uncertainty data available upon request.  
Samples analyzed by EMSL Analytical, Inc San Leandro, CA



**EMSL Analytical, Inc.**

200 Route 130 North, Cinnaminson, NJ 08077

Phone: (800) 220-3675 Fax: (856) 786-5974 Email: [cinnaslab@EMSL.com](mailto:cinnaslab@EMSL.com)

Attn: **SAL MENDOZA**  
**ARCADIS U.S., Inc.**  
**194 Forbes Road**  
**Braintree, MA 02184**

Customer ID: ACAD78J  
Customer PO: 20208  
Received: 01/06/12 9:00 AM  
EMSL Order: 041200350

Fax: Phone: (781) 356-7300  
Project: **ARCADIS; BANK OF AMERICA CA2-103 901 HAZEL**  
**STREET, GRIDLEY, CALIF - HT117883.0085 - SAL**  
**MENDOZ**

EMSL Proj:  
Analysis Date: 1/9/2012

**Test Report: Asbestos Analysis of Bulk Materials via EPA 600/R-93/116 and/or EPA 600/M4-82-020 Method(s) using Polarized Light Microscopy**

Sample	Description	Appearance	Non-Asbestos		Asbestos
			% Fibrous	% Non-Fibrous	% Type
33C 041200350-0045	Breakroom - Ceiling tile mastic To HA-19	Brown Non-Fibrous Homogeneous		100% Non-fibrous (other)	None Detected
			HA: 33 HA Number: 33 Material Type: M - Ceiling Tile - Glue/Adhesive Friable: Yes		
34A 041200350-0046	Throughout - 4" black cove base mastic to HA-21	Brown Non-Fibrous Homogeneous		100% Non-fibrous (other)	None Detected
			HA: 34 HA Number: 34 Material Type: M - Cove Base Mastic Friable: No		
34B 041200350-0047	Throughout - 4" black cove base mastic to HA-21	Brown Non-Fibrous Homogeneous		100% Non-fibrous (other)	None Detected
			HA: 34 HA Number: 34 Material Type: M - Cove Base Mastic Friable: No		
34C 041200350-0048	Throughout - 4" black cove base mastic to HA-21	Brown Non-Fibrous Homogeneous		100% Non-fibrous (other)	None Detected
			HA: 34 HA Number: 34 Material Type: M - Cove Base Mastic Friable: No		

Initial report from 01/09/2012 14:03:08

Analyst(s)  
Jennifer Keeling (2)                      Kenneth Dunbar (63)  
Jorge Leon (5)

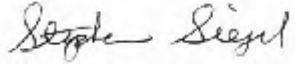
  
Stephen Siegel, CIH, Laboratory Manager  
or other approved signatory

EMSL maintains liability limited to the cost of analysis. This report relates only to the samples reported above and may not be reproduced, except in full, without written approval by EMSL. EMSL bears no responsibility for sample collection activities or analytical method limitations. Interpretation and use of test results are the responsibility of the client. This report must not be used by the client to claim product certification, approval or endorsement by NVLAP, NIST or any agency of the federal government. The test results contained within this report meet the requirements of NELAC unless otherwise specified. Samples received in good condition unless otherwise noted. Estimated accuracy, precision and uncertainty data available upon request.  
Samples analyzed by EMSL Analytical, Inc San Leandro, CA



**EMSL Analytical, Inc.**

200 Route 130 North, Cinnaminson, NJ 08077

Phone: (800) 220-3675 Fax: (856) 786-5974 Email: [cinnaslab@EMSL.com](mailto:cinnaslab@EMSL.com)

Attn: **SAL MENDOZA**  
**ARCADIS U.S., Inc.**  
**194 Forbes Road**  
**Braintree, MA 02184**

Customer ID: ACAD78J  
Customer PO: 20208  
Received: 01/06/12 9:00 AM  
EMSL Order: 041200350

Fax: Phone: (781) 356-7300  
Project: **ARCADIS; BANK OF AMERICA CA2-103 901 HAZEL**  
**STREET, GRIDLEY, CALIF - HT117883.0085 - SAL**  
**MENDOZ**

EMSL Proj:  
Analysis Date: 1/9/2012

**Test Report: Asbestos Analysis of Bulk Materials via EPA 600/R-93/116 and/or EPA 600/M4-82-020 Method(s) using Polarized Light Microscopy**

Sample	Description	Appearance	Non-Asbestos		Asbestos
			% Fibrous	% Non-Fibrous	% Type
35A <i>041200350-0049</i>	Throughout - 4" black cove base mastic to HA-21	White Non-Fibrous Homogeneous		100% Non-fibrous (other)	<b>None Detected</b>
			HA: 35 HA Number: 35 Material Type: M - Cove Base Mastic Friable: No		
35B <i>041200350-0050</i>	Throughout - 4" black cove base mastic to HA-21	White Non-Fibrous Homogeneous		100% Non-fibrous (other)	<b>None Detected</b>
			HA: 35 HA Number: 35 Material Type: M - Cove Base Mastic Friable: No		
35C <i>041200350-0051</i>	Throughout - 4" black cove base mastic to HA-21	White Non-Fibrous Homogeneous		100% Non-fibrous (other)	<b>None Detected</b>
			HA: 35 HA Number: 35 Material Type: M - Cove Base Mastic Friable: No		
36A <i>041200350-0052</i>	ATM/NER, storage room - 4" cove base	Brown Non-Fibrous Homogeneous		100% Non-fibrous (other)	<b>None Detected</b>
			HA: 36 HA Number: 36 Material Type: M - Cove Base Friable: No		

Initial report from 01/09/2012 14:03:08

Analyst(s)  
Jennifer Keeling (2)      Kenneth Dunbar (63)  
Jorge Leon (5)

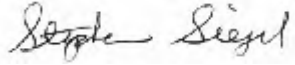
  
\_\_\_\_\_  
Stephen Siegel, CIH, Laboratory Manager  
or other approved signatory

EMSL maintains liability limited to the cost of analysis. This report relates only to the samples reported above and may not be reproduced, except in full, without written approval by EMSL. EMSL bears no responsibility for sample collection activities or analytical method limitations. Interpretation and use of test results are the responsibility of the client. This report must not be used by the client to claim product certification, approval or endorsement by NVLAP, NIST or any agency of the federal government. The test results contained within this report meet the requirements of NELAC unless otherwise specified. Samples received in good condition unless otherwise noted. Estimated accuracy, precision and uncertainty data available upon request.  
Samples analyzed by EMSL Analytical, Inc San Leandro, CA



EMSL Analytical, Inc.

200 Route 130 North, Cinnaminson, NJ 08077

Phone: (800) 220-3675 Fax: (856) 786-5974 Email: cinnaslab@EMSL.com

Attn: SAL MENDOZA
ARCADIS U.S., Inc.
194 Forbes Road
Braintree, MA 02184

Customer ID: ACAD78J
Customer PO: 20208
Received: 01/06/12 9:00 AM
EMSL Order: 041200350

Fax: Phone: (781) 356-7300
Project: ARCADIS; BANK OF AMERICA CA2-103 901 HAZEL
STREET, GRIDLEY, CALIF - HT117883.0085 - SAL
MENDOZ

EMSL Proj:
Analysis Date: 1/9/2012

Test Report: Asbestos Analysis of Bulk Materials via EPA 600/R-93/116 and/or EPA
600/M4-82-020 Method(s) using Polarized Light Microscopy

Table with 6 columns: Sample, Description, Appearance, % Fibrous, % Non-Fibrous, % Type. Rows include samples 36B, 36C, 37A, and 37B with their respective analysis results.

Initial report from 01/09/2012 14:03:08

Analyst(s)

Jennifer Keeling (2)
Jorge Leon (5)

Kenneth Dunbar (63)

Handwritten signature of Stephen Siegel

Stephen Siegel, CIH, Laboratory Manager
or other approved signatory

EMSL maintains liability limited to the cost of analysis. This report relates only to the samples reported above and may not be reproduced, except in full, without written approval by EMSL.

Samples analyzed by EMSL Analytical, Inc San Leandro, CA



**EMSL Analytical, Inc.**

200 Route 130 North, Cinnaminson, NJ 08077

Phone: (800) 220-3675 Fax: (856) 786-5974 Email: [cinnaslab@EMSL.com](mailto:cinnaslab@EMSL.com)

Attn: **SAL MENDOZA**  
**ARCADIS U.S., Inc.**  
**194 Forbes Road**  
**Braintree, MA 02184**

Customer ID: ACAD78J  
Customer PO: 20208  
Received: 01/06/12 9:00 AM  
EMSL Order: 041200350

Fax: Phone: (781) 356-7300

EMSL Proj:  
Analysis Date: 1/9/2012

Project: **ARCADIS; BANK OF AMERICA CA2-103 901 HAZEL STREET, GRIDLEY, CALIF - HT117883.0085 - SAL MENDOZ**

**Test Report: Asbestos Analysis of Bulk Materials via EPA 600/R-93/116 and/or EPA 600/M4-82-020 Method(s) using Polarized Light Microscopy**

Sample	Description	Appearance	Non-Asbestos		Asbestos
			% Fibrous	% Non-Fibrous	% Type
37C 041200350-0057	ATM/NER, storage room - Mastic to HA-36				Stop Positive (Not Analyzed)
			HA: 37 HA Number: 37 Material Type: M - Cove Base Mastic Friable: No		
38A 041200350-0058	ATM/NER, break room, restrooms - Wallpaper glue	Clear Non-Fibrous Homogeneous		100% Non-fibrous (other)	None Detected
			HA: 38 HA Number: 38 Material Type: M - Cove Base Mastic Friable: No		
38B 041200350-0059	ATM/NER, break room, restrooms - Wallpaper glue	Clear Non-Fibrous Homogeneous		100% Non-fibrous (other)	None Detected
			HA: 38 HA Number: 38 Material Type: M - Cove Base Mastic Friable: No		
38C 041200350-0060	ATM/NER, break room, restrooms - Wallpaper glue	Clear Non-Fibrous Homogeneous		100% Non-fibrous (other)	None Detected
			HA: 38 HA Number: 38 Material Type: M - Cove Base Mastic Friable: No		

Initial report from 01/09/2012 14:03:08

Analyst(s)  
Jennifer Keeling (2)                      Kenneth Dunbar (63)  
Jorge Leon (5)

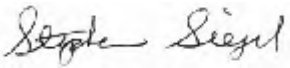
  
Stephen Siegel, CIH, Laboratory Manager  
or other approved signatory

EMSL maintains liability limited to the cost of analysis. This report relates only to the samples reported above and may not be reproduced, except in full, without written approval by EMSL. EMSL bears no responsibility for sample collection activities or analytical method limitations. Interpretation and use of test results are the responsibility of the client. This report must not be used by the client to claim product certification, approval or endorsement by NVLAP, NIST or any agency of the federal government. The test results contained within this report meet the requirements of NELAC unless otherwise specified. Samples received in good condition unless otherwise noted. Estimated accuracy, precision and uncertainty data available upon request.  
Samples analyzed by EMSL Analytical, Inc San Leandro, CA



**EMSL Analytical, Inc.**

200 Route 130 North, Cinnaminson, NJ 08077

Phone: (800) 220-3675 Fax: (856) 786-5974 Email: [cinnaslab@EMSL.com](mailto:cinnaslab@EMSL.com)

Attn: **SAL MENDOZA**  
**ARCADIS U.S., Inc.**  
**194 Forbes Road**  
**Braintree, MA 02184**

Customer ID: ACAD78J  
Customer PO: 20208  
Received: 01/06/12 9:00 AM  
EMSL Order: 041200350

Fax: Phone: (781) 356-7300  
Project: **ARCADIS; BANK OF AMERICA CA2-103 901 HAZEL**  
**STREET, GRIDLEY, CALIF - HT117883.0085 - SAL**  
**MENDOZ**

EMSL Proj:  
Analysis Date: 1/9/2012

**Test Report: Asbestos Analysis of Bulk Materials via EPA 600/R-93/116 and/or EPA 600/M4-82-020 Method(s) using Polarized Light Microscopy**

Sample	Description	Appearance	Non-Asbestos		Asbestos
			% Fibrous	% Non-Fibrous	% Type
39 NOT SAMPLED 041200350-0061	Men's & women's restrooms- NOT SAMPLED - 4"x6" wall & cove base tiles				Not Submitted
			HA: 39 HA Number: 39 Material Type: M - Floor - Ceramic Tile Friable: Yes		
40 NOT SAMPLED 041200350-0062	Men's & women's restrooms- NOT SAMPLED - 4"x6" wall & cove base tiles				Not Submitted
			HA: 40 HA Number: 40 Material Type: M - Mortar - See Description Friable: Yes		
41A 041200350-0063	Men's & women's restrooms - Grout To HA-39	White Non-Fibrous Homogeneous		100% Non-fibrous (other)	None Detected
			HA: 41 HA Number: 41 Material Type: M - Floor - Ceramic Tile - Grout Friable: Yes		

Initial report from 01/09/2012 14:03:08

Analyst(s)  
\_\_\_\_\_  
Jennifer Keeling (2)                      Kenneth Dunbar (63)  
Jorge Leon (5)

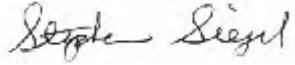
  
\_\_\_\_\_  
Stephen Siegel, CIH, Laboratory Manager  
or other approved signatory

EMSL maintains liability limited to the cost of analysis. This report relates only to the samples reported above and may not be reproduced, except in full, without written approval by EMSL. EMSL bears no responsibility for sample collection activities or analytical method limitations. Interpretation and use of test results are the responsibility of the client. This report must not be used by the client to claim product certification, approval or endorsement by NVLAP, NIST or any agency of the federal government. The test results contained within this report meet the requirements of NELAC unless otherwise specified. Samples received in good condition unless otherwise noted. Estimated accuracy, precision and uncertainty data available upon request.  
Samples analyzed by EMSL Analytical, Inc San Leandro, CA



**EMSL Analytical, Inc.**

200 Route 130 North, Cinnaminson, NJ 08077

Phone: (800) 220-3675 Fax: (856) 786-5974 Email: [cinnaslab@EMSL.com](mailto:cinnaslab@EMSL.com)

Attn: **SAL MENDOZA**  
**ARCADIS U.S., Inc.**  
**194 Forbes Road**  
**Braintree, MA 02184**

Customer ID: ACAD78J  
Customer PO: 20208  
Received: 01/06/12 9:00 AM  
EMSL Order: 041200350

Fax: Phone: (781) 356-7300  
Project: **ARCADIS; BANK OF AMERICA CA2-103 901 HAZEL**  
**STREET, GRIDLEY, CALIF - HT117883.0085 - SAL**  
**MENDOZ**

EMSL Proj:  
Analysis Date: 1/9/2012

**Test Report: Asbestos Analysis of Bulk Materials via EPA 600/R-93/116 and/or EPA 600/M4-82-020 Method(s) using Polarized Light Microscopy**

Sample	Description	Appearance	Non-Asbestos		Asbestos
			% Fibrous	% Non-Fibrous	% Type
41B 041200350-0064	Men's & women's restrooms - Grout To HA-39	White Non-Fibrous Homogeneous		100% Non-fibrous (other)	None Detected
			HA: 41 HA Number: 41 Material Type: M - Floor - Ceramic Tile - Grout Friable: Yes		
41C 041200350-0065	Men's & women's restrooms - Grout To HA-39	White Non-Fibrous Homogeneous		100% Non-fibrous (other)	None Detected
			HA: 41 HA Number: 41 Material Type: M - Floor - Ceramic Tile - Grout Friable: Yes		
42A 041200350-0066	Men's & women's restrooms - 1"x1" ceramic floor tiles	Blue Non-Fibrous Homogeneous		100% Non-fibrous (other)	None Detected
			HA: 42 HA Number: 42 Material Type: M - Floor - Ceramic Tile Friable: Yes		
42B 041200350-0067	Men's & women's restrooms - 1"x1" ceramic floor tiles	Beige Non-Fibrous Homogeneous		100% Non-fibrous (other)	None Detected
			HA: 42 HA Number: 42 Material Type: M - Floor - Ceramic Tile Friable: Yes		

Initial report from 01/09/2012 14:03:08

Analyst(s)  
Jennifer Keeling (2)                      Kenneth Dunbar (63)  
Jorge Leon (5)

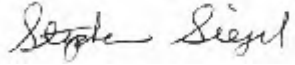
  
\_\_\_\_\_  
Stephen Siegel, CIH, Laboratory Manager  
or other approved signatory

EMSL maintains liability limited to the cost of analysis. This report relates only to the samples reported above and may not be reproduced, except in full, without written approval by EMSL. EMSL bears no responsibility for sample collection activities or analytical method limitations. Interpretation and use of test results are the responsibility of the client. This report must not be used by the client to claim product certification, approval or endorsement by NVLAP, NIST or any agency of the federal government. The test results contained within this report meet the requirements of NELAC unless otherwise specified. Samples received in good condition unless otherwise noted. Estimated accuracy, precision and uncertainty data available upon request.  
Samples analyzed by EMSL Analytical, Inc San Leandro, CA



**EMSL Analytical, Inc.**

200 Route 130 North, Cinnaminson, NJ 08077

Phone: (800) 220-3675 Fax: (856) 786-5974 Email: [cinnaslab@EMSL.com](mailto:cinnaslab@EMSL.com)

Attn: **SAL MENDOZA**  
**ARCADIS U.S., Inc.**  
**194 Forbes Road**  
**Braintree, MA 02184**

Customer ID: ACAD78J  
Customer PO: 20208  
Received: 01/06/12 9:00 AM  
EMSL Order: 041200350

Fax: Phone: (781) 356-7300  
Project: **ARCADIS; BANK OF AMERICA CA2-103 901 HAZEL**  
**STREET, GRIDLEY, CALIF - HT117883.0085 - SAL**  
**MENDOZ**

EMSL Proj:  
Analysis Date: 1/9/2012

**Test Report: Asbestos Analysis of Bulk Materials via EPA 600/R-93/116 and/or EPA 600/M4-82-020 Method(s) using Polarized Light Microscopy**

Sample	Description	Appearance	Non-Asbestos		Asbestos
			% Fibrous	% Non-Fibrous	% Type
42C <i>041200350-0068</i>	Men's & women's restrooms - 1"x1" ceramic floor tiles	Beige Non-Fibrous Homogeneous		100% Non-fibrous (other)	None Detected
			HA: 42 HA Number: 42 Material Type: M - Floor - Ceramic Tile Friable: Yes		
43A <i>041200350-0069</i>	Men's & women's restrooms - Mortar To HA-42	White Non-Fibrous Homogeneous		100% Non-fibrous (other)	None Detected
			HA: 43 HA Number: 43 Material Type: M - Mortar - See Description Friable: Yes		
43B <i>041200350-0070</i>	Men's & women's restrooms - Mortar To HA-42	White Non-Fibrous Homogeneous		100% Non-fibrous (other)	None Detected
			HA: 43 HA Number: 43 Material Type: M - Mortar - See Description Friable: Yes		
43C <i>041200350-0071</i>	Men's & women's restrooms - Mortar To HA-42	White Non-Fibrous Homogeneous		100% Non-fibrous (other)	None Detected
			HA: 43 HA Number: 43 Material Type: M - Mortar - See Description Friable: Yes		

Initial report from 01/09/2012 14:03:08

Analyst(s)  
Jennifer Keeling (2)      Kenneth Dunbar (63)  
Jorge Leon (5)

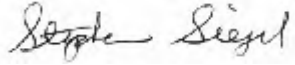
  
Stephen Siegel, CIH, Laboratory Manager  
or other approved signatory

EMSL maintains liability limited to the cost of analysis. This report relates only to the samples reported above and may not be reproduced, except in full, without written approval by EMSL. EMSL bears no responsibility for sample collection activities or analytical method limitations. Interpretation and use of test results are the responsibility of the client. This report must not be used by the client to claim product certification, approval or endorsement by NVLAP, NIST or any agency of the federal government. The test results contained within this report meet the requirements of NELAC unless otherwise specified. Samples received in good condition unless otherwise noted. Estimated accuracy, precision and uncertainty data available upon request.  
Samples analyzed by EMSL Analytical, Inc San Leandro, CA





EMSL Analytical, Inc.

200 Route 130 North, Cinnaminson, NJ 08077

Phone: (800) 220-3675 Fax: (856) 786-5974 Email: cinnaslab@EMSL.com

Attn: SAL MENDOZA
ARCADIS U.S., Inc.
194 Forbes Road
Braintree, MA 02184

Customer ID: ACAD78J
Customer PO: 20208
Received: 01/06/12 9:00 AM
EMSL Order: 041200350

Fax: Phone: (781) 356-7300
Project: ARCADIS; BANK OF AMERICA CA2-103 901 HAZEL
STREET, GRIDLEY, CALIF - HT117883.0085 - SAL
MENDOZ

EMSL Proj:
Analysis Date: 1/9/2012

Test Report: Asbestos Analysis of Bulk Materials via EPA 600/R-93/116 and/or EPA
600/M4-82-020 Method(s) using Polarized Light Microscopy

Table with 6 columns: Sample, Description, Appearance, % Fibrous, % Non-Fibrous, % Type. Rows include samples 44A, 44B, 44C, and 45A with detailed descriptions and analysis results.

Initial report from 01/09/2012 14:03:08

Analyst(s)
Jennifer Keeling (2) Kenneth Dunbar (63)
Jorge Leon (5)

Signature of Stephen Siegel
Stephen Siegel, CIH, Laboratory Manager
or other approved signatory

EMSL maintains liability limited to the cost of analysis. This report relates only to the samples reported above and may not be reproduced, except in full, without written approval by EMSL. EMSL bears no responsibility for sample collection activities or analytical method limitations. Interpretation and use of test results are the responsibility of the client. This report must not be used by the client to claim product certification, approval or endorsement by NVLAP, NIST or any agency of the federal government. The test results contained within this report meet the requirements of NELAC unless otherwise specified. Samples received in good condition unless otherwise noted. Estimated accuracy, precision and uncertainty data available upon request.
Samples analyzed by EMSL Analytical, Inc San Leandro, CA



**EMSL Analytical, Inc.**

200 Route 130 North, Cinnaminson, NJ 08077

Phone: (800) 220-3675 Fax: (856) 786-5974 Email: [cinnaslab@EMSL.com](mailto:cinnaslab@EMSL.com)

Attn: **SAL MENDOZA**  
**ARCADIS U.S., Inc.**  
**194 Forbes Road**  
**Braintree, MA 02184**

Customer ID: ACAD78J  
Customer PO: 20208  
Received: 01/06/12 9:00 AM  
EMSL Order: 041200350

Fax: Phone: (781) 356-7300  
Project: **ARCADIS; BANK OF AMERICA CA2-103 901 HAZEL**  
**STREET, GRIDLEY, CALIF - HT117883.0085 - SAL**  
**MENDOZ**

EMSL Proj:  
Analysis Date: 1/9/2012

**Test Report: Asbestos Analysis of Bulk Materials via EPA 600/R-93/116 and/or EPA 600/M4-82-020 Method(s) using Polarized Light Microscopy**

Sample	Description	Appearance	Non-Asbestos		Asbestos
			% Fibrous	% Non-Fibrous	% Type
45B 041200350-0076	Breakroom, restroom, hallway coat closet - Sheet Flooring Beneath H-12	Beige Fibrous Homogeneous	90% Cellulose	10% Non-fibrous (other)	None Detected
			HA: 45 HA Number: 45 Material Type: M - Floor - Vinyl Sheet Flooring (e.g. Linoleum) Friable: No		
45C 041200350-0077	Breakroom, restroom, hallway coat closet - Sheet Flooring Beneath H-12	Beige Fibrous Homogeneous	90% Cellulose	10% Non-fibrous (other)	None Detected
			HA: 45 HA Number: 45 Material Type: M - Floor - Vinyl Sheet Flooring (e.g. Linoleum) Friable: No		
46A 041200350-0078	Breakroom, restroom, hallway coat closet - Backing Material To HA-45	Brown Non-Fibrous Homogeneous	40% Cellulose	60% Non-fibrous (other)	None Detected
			HA: 46 HA Number: 46 Material Type: M - Floor Backing Friable: Yes		

Initial report from 01/09/2012 14:03:08

Analyst(s)

Jennifer Keeling (2)  
Jorge Leon (5)

Kenneth Dunbar (63)

Stephen Siegel, CIH, Laboratory Manager  
or other approved signatory

EMSL maintains liability limited to the cost of analysis. This report relates only to the samples reported above and may not be reproduced, except in full, without written approval by EMSL. EMSL bears no responsibility for sample collection activities or analytical method limitations. Interpretation and use of test results are the responsibility of the client. This report must not be used by the client to claim product certification, approval or endorsement by NVLAP, NIST or any agency of the federal government. The test results contained within this report meet the requirements of NELAC unless otherwise specified. Samples received in good condition unless otherwise noted. Estimated accuracy, precision and uncertainty data available upon request.

Samples analyzed by EMSL Analytical, Inc San Leandro, CA



**EMSL Analytical, Inc.**

200 Route 130 North, Cinnaminson, NJ 08077

Phone: (800) 220-3675 Fax: (856) 786-5974 Email: [cinnaslab@EMSL.com](mailto:cinnaslab@EMSL.com)

Attn: **SAL MENDOZA**  
**ARCADIS U.S., Inc.**  
**194 Forbes Road**  
**Braintree, MA 02184**

Customer ID: ACAD78J  
Customer PO: 20208  
Received: 01/06/12 9:00 AM  
EMSL Order: 041200350

Fax: Phone: (781) 356-7300  
Project: **ARCADIS; BANK OF AMERICA CA2-103 901 HAZEL**  
**STREET, GRIDLEY, CALIF - HT117883.0085 - SAL**  
**MENDOZ**

EMSL Proj:  
Analysis Date: 1/9/2012

**Test Report: Asbestos Analysis of Bulk Materials via EPA 600/R-93/116 and/or EPA 600/M4-82-020 Method(s) using Polarized Light Microscopy**

Sample	Description	Appearance	Non-Asbestos		Asbestos
			% Fibrous	% Non-Fibrous	% Type
46B 041200350-0079	Breakroom, restroom, hallway coat closet - Backing Material To HA-45	Brown Non-Fibrous Homogeneous	40% Cellulose	60% Non-fibrous (other)	None Detected
			HA: 46 HA Number: 46 Material Type: M - Floor Backing Friable: Yes		
46C 041200350-0080	Breakroom, restroom, hallway coat closet - Backing Material To HA-45	Brown Non-Fibrous Homogeneous	40% Cellulose	60% Non-fibrous (other)	None Detected
			HA: 46 HA Number: 46 Material Type: M - Floor Backing Friable: Yes		
47 NOT SAMPLED 041200350-0081	Restrooms- NOT SAMPLED - Mirror mastic				Not Submitted
			HA: 47 HA Number: 47 Material Type: M - Mastic behind Mirror Friable: No		

Initial report from 01/09/2012 14:03:08

Analyst(s)  
\_\_\_\_\_  
Jennifer Keeling (2)                      Kenneth Dunbar (63)  
Jorge Leon (5)

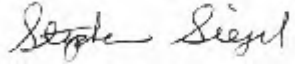
  
\_\_\_\_\_  
Stephen Siegel, CIH, Laboratory Manager  
or other approved signatory

EMSL maintains liability limited to the cost of analysis. This report relates only to the samples reported above and may not be reproduced, except in full, without written approval by EMSL. EMSL bears no responsibility for sample collection activities or analytical method limitations. Interpretation and use of test results are the responsibility of the client. This report must not be used by the client to claim product certification, approval or endorsement by NVLAP, NIST or any agency of the federal government. The test results contained within this report meet the requirements of NELAC unless otherwise specified. Samples received in good condition unless otherwise noted. Estimated accuracy, precision and uncertainty data available upon request.  
Samples analyzed by EMSL Analytical, Inc San Leandro, CA

*041200350*

ARCADIS PROJECT NO.:  
PROJECT NAME:

*041200350* Mail Code #  
PAGE 1 OF 1

Mail Results To:			Mail Invoice To:			
Name: <u>Sal Mendoza</u> Company: <u>ARCADIS</u> Street: <u>Roseville, CA</u> City, State Zip: <u>95661</u> Phone #: <u>916.747.6495</u> Fax #: <u>916.786.0366</u>			Name: _____ Company: _____ Street: _____ City, State Zip: _____ Phone #: _____ Fax #: _____			
Email PDF Reports to: <u>sal.mendoza@arcadis-us.com</u>			Email EDD Reports to:			
Site Address:  <u>CA2-103 located at 901 Hazel Street in Gridley, CA</u> <i>#1117883-0085</i>			Sample Number Sequence:  Various			
Samples Collected By: <u>SM</u> Date(s) Collected: <u>01-04-2012</u> Sample Type: <u>Bulks</u>			Analysis Turnaround Time: <b>3 Day</b> Date Emailed Results Required: Date Typed Results Required: <u>01-09-2012</u>			
<input type="checkbox"/> Analyze All Samples			<input checked="" type="checkbox"/> Positive Stop			
	Printed Name	Signature	Affiliation	Date & Time	# of Samples	Task for Person Handling COC
Remitted	<i>Sal Mendoza</i>	<i>[Signature]</i>	ARCADIS	<i>1/5/12 1600</i>		FEDEXED to Lab
Received	<i>Alanzing</i>	<i>[Signature]</i>	EMSL	<i>1/4/11 0900</i>		
Remitted						
Received						
Remitted						
Received						
<b>Comments:</b> Please call the ARCADIS employee named above in the "Mail Result To:" line if the laboratory has <u>ANY</u> questions about the samples, sample analysis, or chain-of-custody.						
<b>PLEASE SEE ATTACHED FIELD FORMS FOR SAMPLE DESCRIPTION AND TYPE OF ANALYSIS.</b>						

Homogeneous Application Table  
 Mail Code:

HA No.	Material Type	Primary Color	Texture	Description	Sample IDs	Floor	Rooms	Location	Condition	Amt.	Units
27	FLOOR TILES	BEIGE	S	12x12" w/ LAZURE BEA GRESOLS	a b c	1	ATM/NSE	FLOOR	G	300	SF
28	MASTIC	BLACK	R	TO HA-27	a b c	1			G	↓	
29	LEVLASTIC	WHT	S	BEKATH HA-27	a b c	1	↓	↓	G	5	SF
30	MASTIC	7	R	TO SOUTH WALL	NOT SAMPLED (WOOD CASE SIG. DAMAGES)	1	ATM/NSE	WALL	S	300	SF
31	LEVLASTIC	GRAY	R	RESIDUAL HA-12 #13	a b c		↓	FLOOR	G	↓	SF
32	RESIDUAL MASTIC	BLACK	R	BEKATH HA-8 PATCH	a		↓	↓	G	6	SF
33	CEILING TILE MASTIC	BROWN	R	TO HA-19	a b c	M	BREAK ROOM	CEILING	G	900	SF
34	MASTIC	BROWN		4" TO HA-21 BLACK "CONCRETE" MASTIC	a b c	1 & M	THROUGHOUT	FLOOR	G	1000	LF
35	↓	WHTS	↓	↓	a b c	↓	THROUGHOUT	↓	↓	↓	↓
36	VINYL CONCRETE	BROWN	S	4" CONCRETE	a b c	1	ATM/NSE, STORAGE ROOM	FLOOR	G	400	LF
37	MASTIC	↓	R	MASTIC TO HA-36	a b c	1	↓	↓	↓	↓	↓
38	MASTIC	CLEAR	R	WALL PAPER GLUE	a b c	1 & M	ATM/NSE, BREAK ROOM, REST ROOMS	WALL	G	800	SF



CAZ-103

HT17882.0085

HA No.	Material Type	Primary Color	Texture	Description	Sample IDs	Floor	Rooms	Location	Condition	Amt.	Units
11	VINYL FLOOR TILES	TAN	NA	9"x9" Square Tiles	a b c	1st M	SDB (3rd FLOOR SDB) STORAGE ROOM	Floor	G	350	SF
10 - See note below <del>15</del>	MASTIC	Black	R	To HA-11	a b c	↓	↓	↓	↓	↓	↓
12	VINYL FLOOR TILES	TAN	NA	12"x12" w/BEAN STREAK	a b c	1st M	↑ Ant. Room, Hallway Break Room W/STAIR TOWER AREA	Floor	G	2500	SF
13	MASTIC	Black	NA	To HA-12	a b c	↓	↓	↓	↓	↓	↓
14	MASTIC	Yellow	R	To HA-8	a	1	ATTN/ NISE	Floor	G	5	SF
25	MASTIC	Black	R	To HA-24	a	1	BEHIND CARPET JOE TELECOM & PURCHASER	Floor	G	4500	SF
16	CERAMIC TILES	White	R	2'x4' SUSPENDED	a b c	1	THROUGHOUT 1st FLOOR	C	G	2870	SF
17	VINYL FLOOR TILES	White	S	12"x12" TAN STREAK	a b c	1	VAULT & SDB	I	G	120	SF
18	MASTIC	BLK	R	To HA-17	a b c	↓	↓	↓	↓	↓	↓
19	Ceiling Tiles	White	NA	1'x1' Tiles	a b c	M	(ALONG THE FALSB) CEILING PANELS BEHIND ROOM	C	G	900	SF
21	CONCRETE BASE	Black	S	4" CONCRETE BASE	a b c	1, M	THROUGHOUT	W	G	1,600	LF



Attachment **D**

Sample Location Figure(s)



1  
North

Jul 12

Approx. Scale

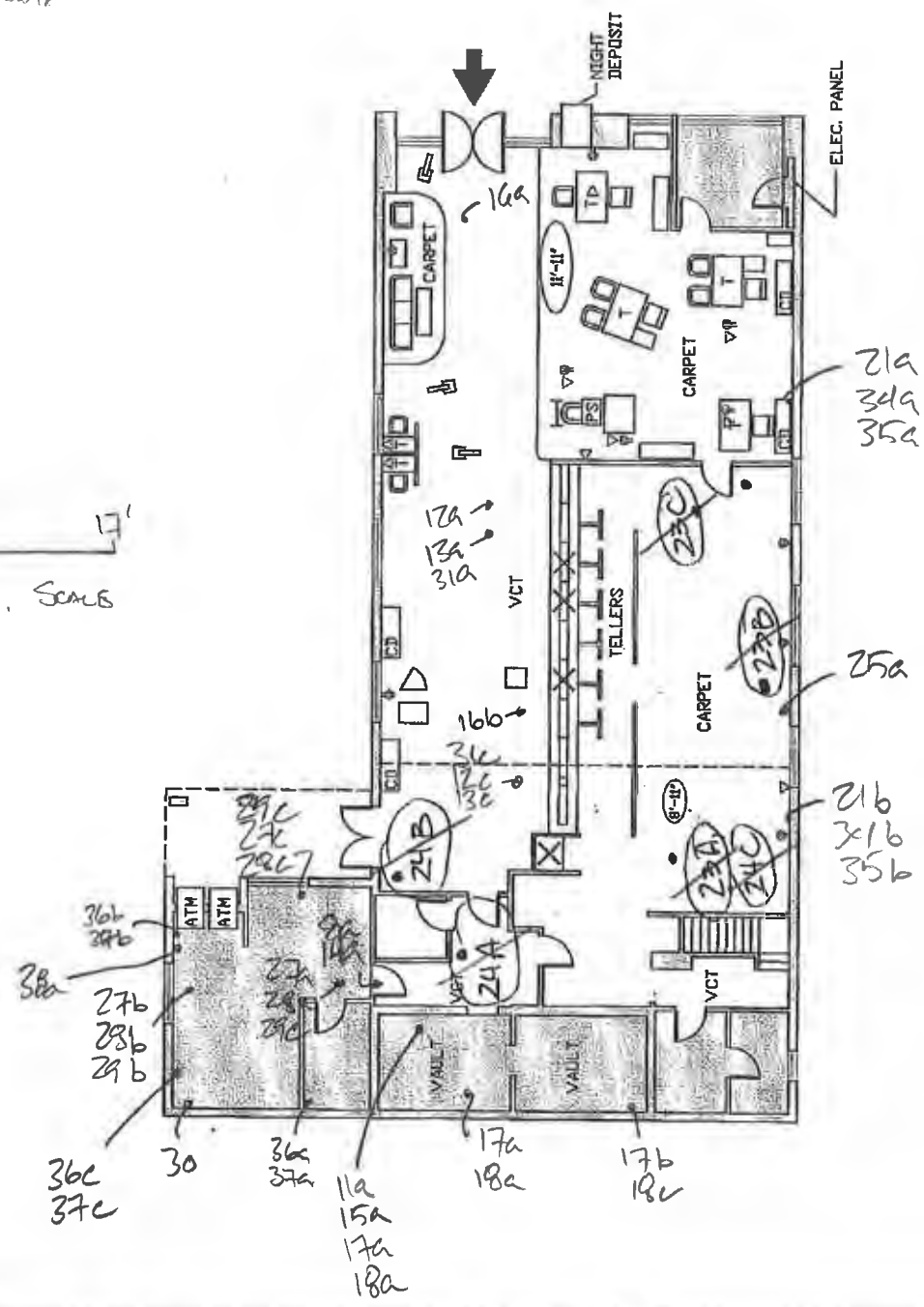

ATC Associates, Inc.  
 6602 Owens Drive, Suite 100  
 Pleasanton, CA 94588

**Floor Plans**  
 Gridley Banking Center  
 901 Hazel Street  
 Gridley, California  
 Mail Code: CA2-103

PROJECT NO: 35.09072.0001, Task 07501		
DRAWN BY: JE	SCALE: Not to Scale	FILE: 35.09072.00001

1/4/12  
Su

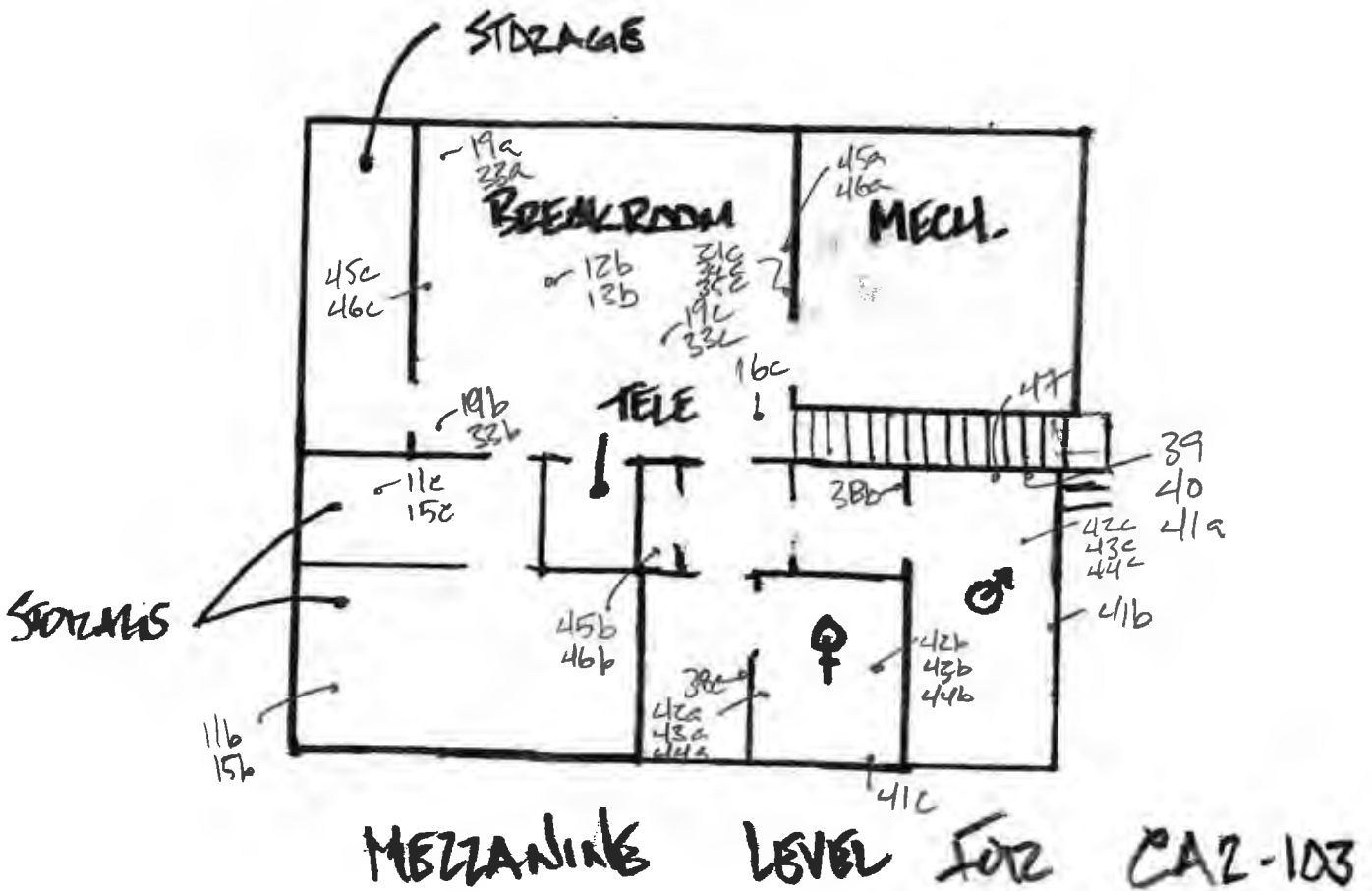
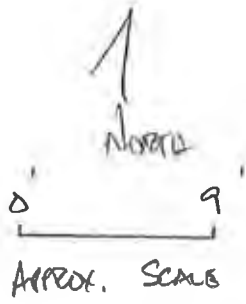



Attachment **E**

Photographic Log



**View of the front of the building**



**HA-8: 12" x 12" Brown with white streaks floor tiles**

**HA-14: Yellow/black floor tile mastic**

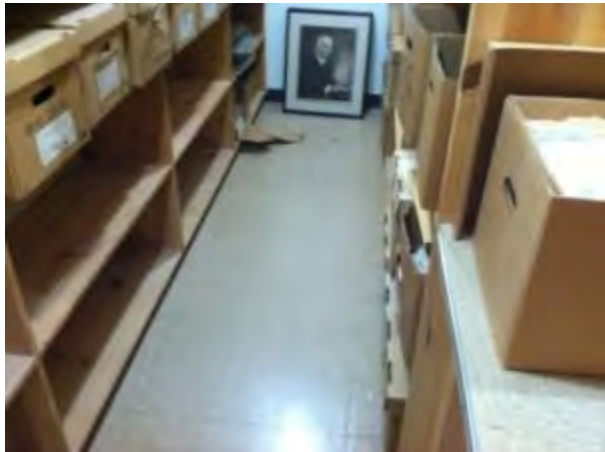

**HA-9: 12" x 12" White with brown streaks floor tiles  
HA-15: Black floor tile mastic**



**HA-10: Black floor tile mastic  
HA-11: 9" Tan floor tiles**



**HA-12: 12" x 12" Tan with brown streaks floor tiles  
HA-13: Black floor tile mastic**



**HA-16: 2' x 4' Suspended by "T" Bar**



**HA-17: 12" x 12" White with tan streaks floor tiles  
HA-18: Black floor tile mastic**



**HA-19: 1' x 1' Ceiling tiles - Glue On  
HA-33: Brown ceiling tile glue**



**HA-20: Clear cove base mastic  
HA-21: Black 4" rubber cove base  
HA-34: Brown cove base mastic**



**HA-24: Brown & white specks floor tiles (Under  
Carpet)  
HA-25: Black floor tile mastic**



**HA-27: 12" x 12" Beige with large brown streaks floor  
tiles  
HA-28: Black floor tile mastic  
HA-29: White levalastic beneath HA-27/HA-28**



**HA-30: Mastic associated with HA-48  
HA-48: Gray sound wall**



**HA-36: Brown 4" cove base  
HA-37: Brown cove base mastic**



**HA-38: Clear wallpaper glue associated with HA-49  
HA-49: Beige wallpaper**



**HA-39: Blue 4" x 6" ceramic wall tiles/cove base  
HA-40: Tile adhesive  
HA-41: White tile grout**



**HA-42: Beige 1" x 1" ceramic floor tiles  
HA-43: White tile adhesive  
HA-44: White tile grout**



**HA-45: Beige sheet flooring (beneath vinyl floor tiles)  
HA-46: Brown sheet floor backing**



**HA-47: Mirror mastic**



**HA-50: Pink fiberglass batt insulation  
HA-51: Black plastic-wrapped fiberglass duct  
insulation**



Attachment F

Limitations and Service  
Constraints



## LIMITATIONS AND SERVICE CONSTRAINTS Asbestos Related Services

All professional opinions presented in this report are based on information made available to us either by review of data provided by others or data gathered by ARCADIS personnel.

ARCADIS affirms that data gathered and presented by ARCADIS in this report was collected in an appropriate manner in accordance with generally accepted methods and practices. ARCADIS cannot be responsible for decisions made by our client solely on the basis of economic factors.

Conditions described in this report are as found at the time of investigation, unless otherwise stated.

ARCADIS analyzed only the substances, conditions and locations described in the report at the time indicated. No inferences regarding other substances, conditions, location or time can be made unless specifically stated in this report.

No recommendations were provided for materials containing less than one percent asbestos. Materials containing less than one percent asbestos do not meet either the generally accepted industry definition of asbestos-containing material (any material containing greater than one percent asbestos) or the EPA definition of friable ACM (any material containing more than one percent (1%) asbestos as analyzed by Polarized Light Microscopy that, when dry, can be crumbled, pulverized or reduced to powder by hand pressure.) ARCADIS, however, makes no statement, implied or explicit, about the hazards of materials containing less than one percent asbestos.

This report is intended for the use listed in the introduction of this report. The use of this report in any manner other than that listed in the introduction requires the written consent of ARCADIS. This report must be presented in its entirety.