



Summary

Parcel Number	0630280001
Location Address	2265 CREST CIR
Legal Description	CREST CIR 424A
	(Note: Not to be used on legal documents)
Class	R3-Residential
	(Note: This is for tax purposes only. Not to be used for zoning.)
Tax District	COUNTY (District 01)
Millage Rate	45.61
Acres	0.16
Homestead Exemption	No (S0)
Landlot/District	330 / 16
Water	Public
Sewer	Septic Tank
Electric	Electricity
Gas	No Gas
Topography	Rolling
Drainage	Good
Road Class	County
Parcel Road Access	Paved



[View Map](#)

Owner

GAINES JO ANN
2261 CREST CIRCLE, NE
CONYERS, GA 30012

Land

Type	Description	Calculation Method	Square Footage	Frontage	Depth	Acres	Lots
RES	HI ROC SHORES MH	Lot	7,636	77	92	0.16	1

Residential Improvement Information

Style	One Family
Heated Square Feet	1904
Interior Walls	Sheetrock
Exterior Walls	Wood
Attic Square Feet	0
Basement Square Feet	0
Year Built	1970
Roof Type	Asphalt Shingles
Flooring Type	Carpet
Heating Type	Central Heat/AC
Number Of Rooms	6
Number Of Bedrooms	3
Number Of Full Bathrooms	2
Number Of Half Bathrooms	0
Number Of Plumbing Extras	3
Value	\$18,200
Condition	Fair
Number Of Fireplaces	1

Sales

Sale Date	Sale Price	Grantor	Grantee
➤ 12/1/2008	\$35,000	FLOWERS LONNIE	GAINES JO ANN
➤ 4/1/2008	\$0	GAINES JO ANN	FLOWERS LONNIE
➤ 9/18/2002	\$40,000	FLOWERS LONNIE	CARROLL RAY
➤ 3/13/2002	\$35,000	FIRST NATION BANK	FLOWERS LONNIE
➤ 1/2/2002	\$0	MORRIS JAMES K	FIRST NATION BANK
➤ 5/2/2000	\$36,000		MORRIS JAMES K
➤ 8/21/1992	\$0		SHERWOOD MICHAEL L
➤ 8/1/1981	\$0		STULTZ THOMAS E & MELBA J
➤ 9/1/1978	\$0		ROBERTS GEORGE E & BEVERLY S
➤ 1/1/1974	\$0		ROBERTS GEORGE E
➤ 1/1/1970	\$0		KNIGHT JAMES C
➤ 1/1/1970	\$0		HOLLOWAY HENRY L
➤ 1/1/1969	\$0		HALL MARION F & DORIS
➤ 1/1/1966	\$0		JORDON FRANK W

Area Sales Report

Recent Sales in Area

Recent Sales in Neighborhood

Valuation

	2016
Previous Value	\$21,200
Land Value	\$3,000
+ Improvement Value	\$18,200
+ Accessory Value	\$0
= Current Value	\$21,200

Photos



Sketches

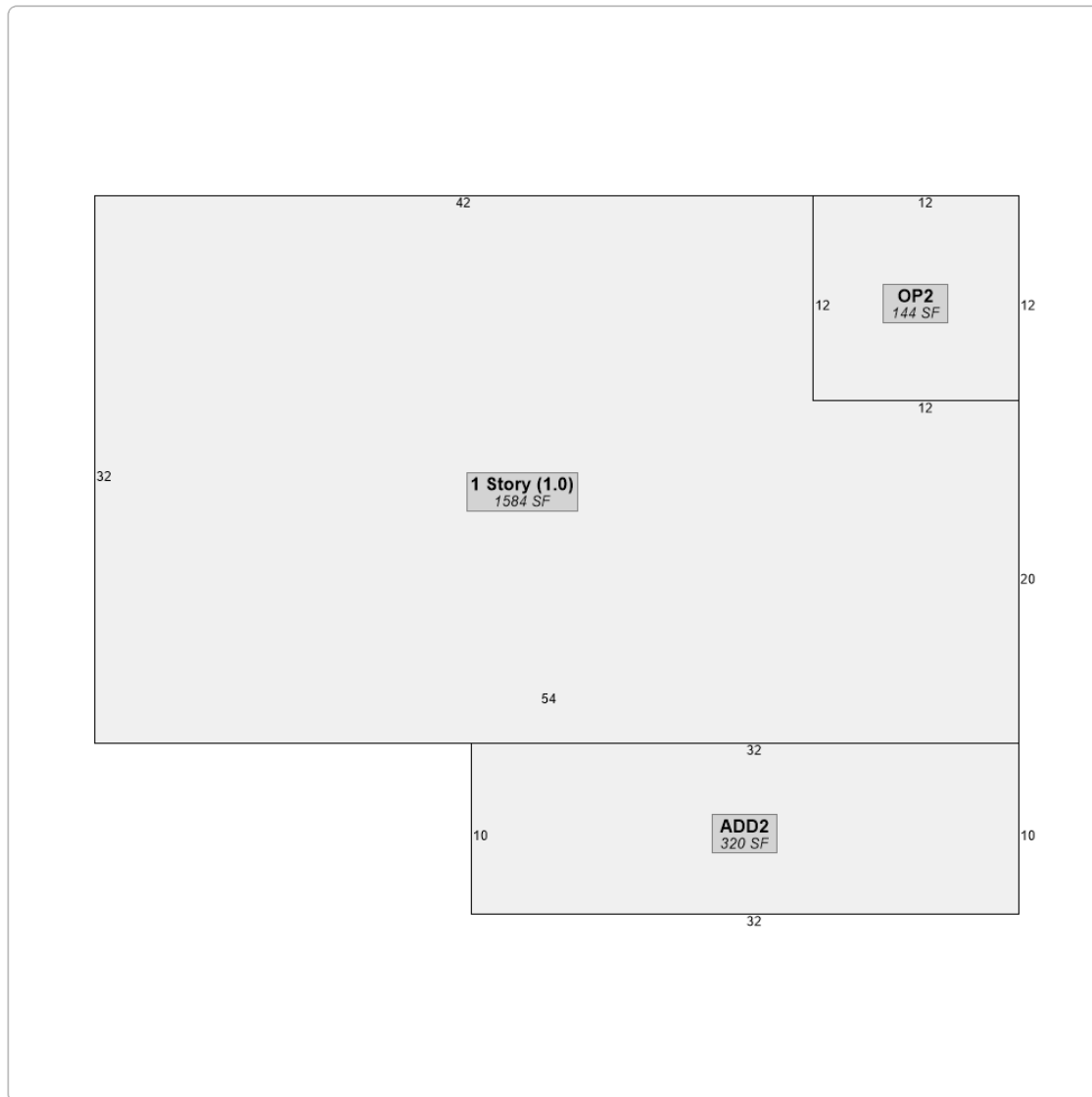

No data available for the following modules: Rural Land, Conservation Use Rural Land, Commercial Improvement Information, Mobile Homes, Accessory Information, Prebill Mobile Homes, Permits.

The Rockdale County Board of Assessors Office makes every effort to produce the most accurate information possible. Due to the time lapse between sales and deeds being recorded, no warranties, expressed or implied, are provided for the data herein, its use, or interpretation. The assessment values are from the Preliminary 2016 tax digest. All data is subject to change at any time.