



Yakima County WA, Property Record Card

Yakima County WA, Property Record Card

171422-24406

Owners: Dave E Trepanier

Assessed Value

Un-Assigned

\$61,200

PROPERTY DETAILS

Parcel Number	171422-24406
Situs Address	Un-Assigned
Property Use	91 Undeveloped Land
Tax Code Area	502
Property Size	0.68
Neighborhood	483
Owners	Dave E Trepanier
Legal Description	SP 83-152 LOT 2
Fire District	Yakima County Fire District 1
School District	Highland School District #203
Total Bldg SQFT	-

UTILITY INFORMATION

Gas	No	Electricity	Yes	Water	Well
Sewer / Septic	Septic				

SITE INFORMATION

Property Type	Residential	Zoning	R10/5	Street Type	Private
Street Finish	Dirt	Traffic	Light	Side Walk	No
Curbs	No	Location	Road-Frntage		

LAND

DETAILS FOR LAND RECORD #1

Land Flag	Mdl	Soil Class	Prime	Calc CU	No
Water Source	Well	Sewer Source	Septic	Flood Plain	No
Lot Shape	Rectangle	Topography	Level	Land View	No View
Landscaping	None	Value Method	Acres	Lots	1
Square Feet	29,437 sqft		Acre(s)	0.680	

RESIDENTIAL

No data to display

COMMERCIAL

No data to display

DETACHED STRUCTURES

No data to display

AGRICULTURE

No data to display

EXCISE TRANSACTIONS

EXCISE #	GRANTOR NAME	EXCISE DATE	SALE PRICE	DOCUMENT TYPE	PORTION (Y/N)	PARCEL(S) SOLD
388782	Trepanier, Joseph Nels	11/28/2006	\$0	Statutory Warranty Deed	N	-

VALUES

VALUE TYPE	2025	2024	2023	2022	2021	2020	2019
Taxable Value Regular	\$61,200	\$55,200	\$51,100	\$50,000	\$46,500	\$38,300	\$38,300
Taxable Value Excess	\$61,200	\$55,200	\$51,100	\$50,000	\$46,500	\$38,300	\$38,300
Market Land	\$61,200	\$55,200	\$51,100	\$50,000	\$46,500	\$38,300	\$38,300

TAX BREAKDOWN

DISTRICT	TAX RATE	ASSESSED VALUE	TAX
County Ems	0.250000000000000	\$55,200	\$13.80
County Flood Control	0.05513604680100	\$55,200	\$3.04
Highland School	1.66239640772800	\$55,200	\$91.76
Highland School Bonds	0.000000000000000	\$55,200	\$0.00
Highland School Technology Improvement	1.34066986476700	\$55,200	\$74.00
State School Levy	1.43728317636200	\$55,200	\$79.34
State School Levy Part 2	0.77100703019800	\$55,200	\$42.56
Yakima County	0.97798948507300	\$55,200	\$53.99
Yakima County Fire District 1	0.68986971054400	\$55,200	\$38.08
Yakima County Fire District 1 Bonds	0.19146681311600	\$55,200	\$10.57
Yakima County Road	1.30049520483300	\$55,200	\$71.79
Yakima Valley Regional Library	0.29320895483300	\$55,200	\$16.19

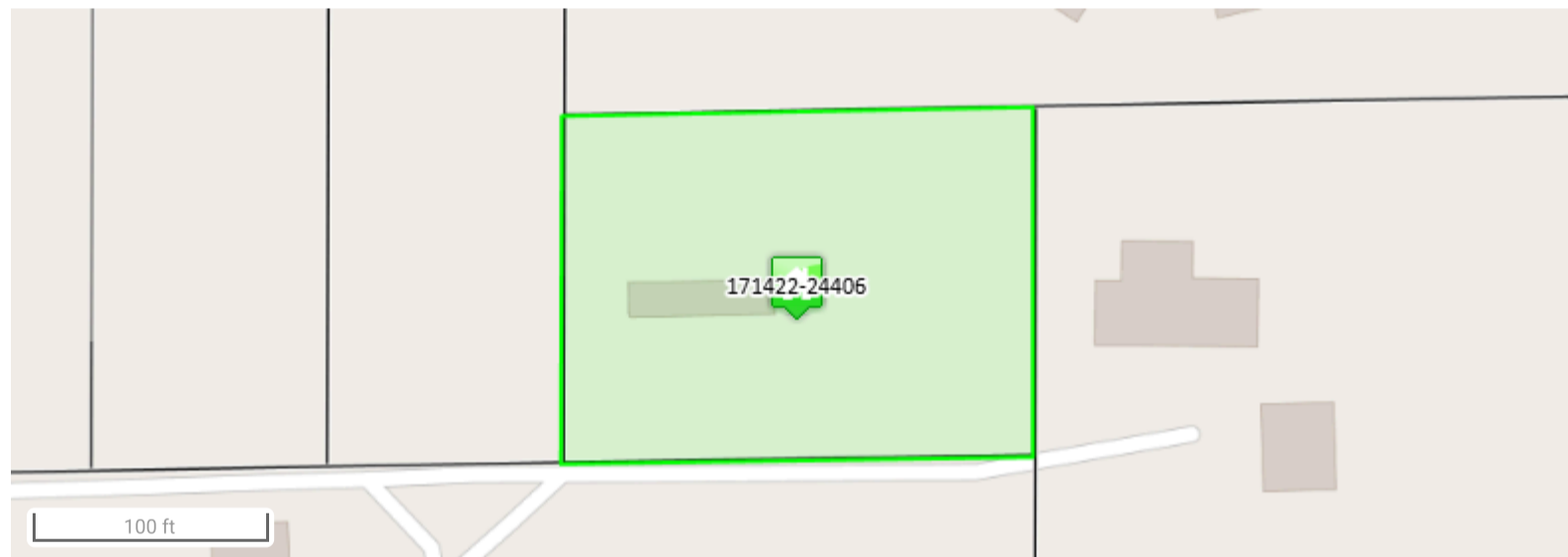



UN-ASSIGNED ,



UN-ASSIGNED ,

Data last updated: 04/07/2025