



Yakima County WA, Property Record Card

Yakima County WA, Property Record Card

171422-24405

Owners: Dave E Trepanier

Assessed Value

8943 Naches Heights Rd

\$101,900

PROPERTY DETAILS

Parcel Number	171422-24405
Situs Address	8943 Naches Heights Rd
Property Use	18 Other Residential
Tax Code Area	502
Property Size	1.63
Neighborhood	483
Owners	Dave E Trepanier
Legal Description	SP 83-152 LOT 1
Fire District	Yakima County Fire District 1
School District	Highland School District #203
Total Bldg SQFT	-

UTILITY INFORMATION

Gas	No	Electricity	Yes	Water	Well
Sewer / Septic	Septic				

SITE INFORMATION

Property Type	Residential	Zoning	Rldp	Street Type	Two-Way
Street Finish	Paved/Asphlt	Traffic	Heavy	Side Walk	No
Curbs	No		Location	Road-Frntage	

LAND

DETAILS FOR LAND RECORD #1

Land Flag	Mdl	Soil Class	-	Calc CU	No
Water Source	Well	Sewer Source	Septic	Flood Plain	No
Lot Shape	Irregular	Topography	Level	Land View	No View
Landscaping	Minimal	Value Method	Acres	Lots	1
Square Feet	-		Acre(s)	1.630	

RESIDENTIAL

No data to display

COMMERCIAL

No data to display

DETACHED STRUCTURES

DETAILS FOR DETACHED STRUCTURE #1

Structure Type	Utility-Bldg	Quality	Fair/Average	Condition	Fair
Construction	Wood-Frame	Construction Type	Frame	Foundation	Utility-Bldg
Ext. Wall Type	Wood	Roof Type	Gable	Roofing Material	Metal
Flooring	Cncrt-Slab	Year Built	1977	Measure 1	2,632
Measure 2	-		Main Finished	2,632	

AGRICULTURE

No data to display

EXCISE TRANSACTIONS

EXCISE #	GRANTOR NAME	EXCISE DATE	SALE PRICE	DOCUMENT TYPE	PORTION (Y/N)	PARCEL(S) SOLD
388782	Trepanier, Joseph Nels	11/28/2006	\$0	Statutory Warranty Deed	N	-

VALUES

VALUE TYPE	2025	2024	2023	2022	2021	2020	2019
Taxable Value Regular	\$101,900	\$96,600	\$86,900	\$81,700	\$74,200	\$65,800	\$58,700
Taxable Value Excess	\$101,900	\$96,600	\$86,900	\$81,700	\$74,200	\$65,800	\$58,700
Market Land	\$74,400	\$68,100	\$61,400	\$60,000	\$55,600	\$45,700	\$45,700
Market Improvement	\$27,500	\$28,500	\$25,500	\$21,700	\$18,600	\$20,100	\$13,000

TAX BREAKDOWN

DISTRICT	TAX RATE	ASSESSED VALUE	TAX
County Ems	0.250000000000000	\$96,600	\$24.15
County Flood Control	0.05513604680100	\$96,600	\$5.33
Highland School	1.66239640772800	\$96,600	\$160.59
Highland School Bonds	0.000000000000000	\$96,600	\$0.00
Highland School Technology Improvement	1.34066986476700	\$96,600	\$129.51
State School Levy	1.43728317636200	\$96,600	\$138.84
State School Levy Part 2	0.77100703019800	\$96,600	\$74.48
Yakima County	0.97798948507300	\$96,600	\$94.47
Yakima County Fire District 1	0.68986971054400	\$96,600	\$66.64
Yakima County Fire District 1 Bonds	0.19146681311600	\$96,600	\$18.50
Yakima County Road	1.30049520483300	\$96,600	\$125.63
Yakima Valley Regional Library	0.29320895483300	\$96,600	\$28.32

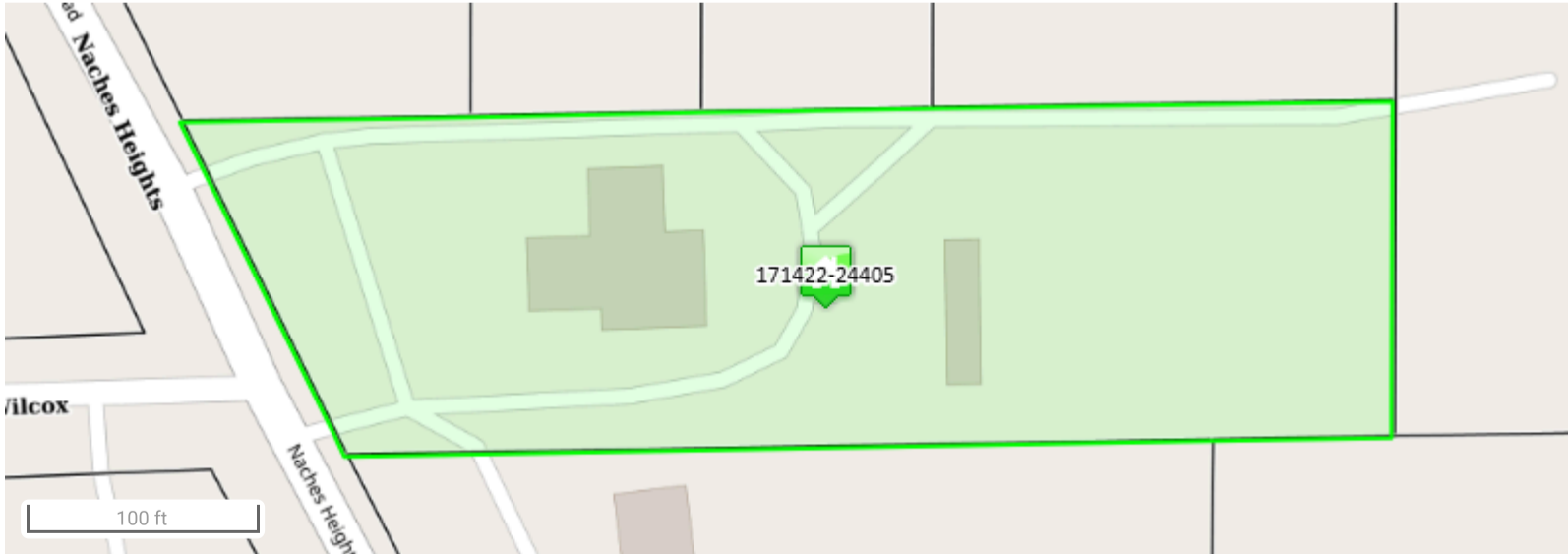



8943 NACHES HEIGHTS RD , WA



8943 NACHES HEIGHTS RD , WA



8943 NACHES HEIGHTS RD , WA



8943 NACHES HEIGHTS RD , WA



8943 NACHES HEIGHTS RD , WA