



# Yakima County WA, Property Record Card

## Yakima County WA, Property Record Card

171422-31401  
8925 Naches Heights Rd

Owners: Dave E Trepanier

Assessed Value  
\$107,100

### PROPERTY DETAILS

Parcel Number	171422-31401
Situs Address	8925 Naches Heights Rd
Property Use	11 Single Unit
Tax Code Area	502
Property Size	1.79
Neighborhood	483
Owners	Dave E Trepanier
Legal Description	SP 85-158 LOT 1 1983 LANDMARK 52X28 SER# 7357
Fire District	Yakima County Fire District 1
School District	Highland School District #203
Total Bldg SQFT	1,248

### UTILITY INFORMATION

Gas	No	Electricity	Yes	Water	Well
Sewer / Septic	Septic				

### SITE INFORMATION

Property Type	Residential	Zoning	Rldp	Street Type	Two-Way
Street Finish	Paved/Asphlt	Traffic	Medium	Side Walk	No
Curbs	No		Location	Road-Frntage	

### LAND

#### DETAILS FOR LAND RECORD #1

Land Flag	Mdl	Soil Class	-	Calc CU	No
Water Source	Well	Sewer Source	Septic	Flood Plain	No
Lot Shape	Irregular	Topography	Level	Land View	No View
Landscaping	Minimal	Value Method	Acres	Lots	1
Square Feet	-		Acre(s)	1.790	

### RESIDENTIAL

DETAILS FOR RESIDENCE SECTION #1

Building Type	Manufactured Hse	Quality	Fair	Condition	Average
Year Built	1983	Stories	1.00	Bedrooms	3
Main Floor	1,248	Upper Floor	-	Addl. Area	-
Full Baths	2	3/4 Baths	-	Half Baths	-
Fixtures	8	Basement	-	Finished Bsmt	-
Attached Garage	-	Built in Garage	-	Wood Deck	-
Patio	-	Cover	-	Masonry Trim	-
Roof Type	Gable	Roof Material	Mf_Metal Roof	Flooring	Carpet
Exterior Wall	Wood-Siding	Foundation	Pit Set	Fuel Type	Electric
Heat Type	Forced-Duct	Central Air	-	Wood Stove	-
Fireplace	-		Prefab Fireplace	-	

COMMERCIAL

No data to display

DETACHED STRUCTURES

No data to display

AGRICULTURE

No data to display

EXCISE TRANSACTIONS

EXCISE #	GRANTOR NAME	EXCISE DATE	SALE PRICE	DOCUMENT TYPE	PORTION (Y/N)	PARCEL(S) SOLD
370054	Pr Of Estate Of Pauline A Trepanier	01/13/2005	\$0	Personal Representative Deed	N	-
388782	Trepanier, Joseph Nels	11/28/2006	\$0	Statutory Warranty Deed	N	-

VALUES

VALUE TYPE	2025	2024	2023	2022	2021	2020	2019
Taxable Value Regular	\$107,100	\$102,300	\$91,500	\$84,100	\$81,400	\$80,500	\$81,200
Taxable Value Excess	\$107,100	\$102,300	\$91,500	\$84,100	\$81,400	\$80,500	\$81,200
Market Land	\$75,800	\$69,600	\$62,600	\$61,100	\$56,700	\$46,500	\$46,500
Market Improvement	\$31,300	\$32,700	\$28,900	\$23,000	\$24,700	\$34,000	\$34,700

TAX BREAKDOWN

DISTRICT	TAX RATE	ASSESSED VALUE	TAX
County Ems	0.25000000000000	\$102,300	\$25.58
County Flood Control	0.05513604680100	\$102,300	\$5.64
Highland School	1.66239640772800	\$102,300	\$170.06
Highland School Bonds	0.00000000000000	\$102,300	\$0.00
Highland School Technology Improvement	1.34066986476700	\$102,300	\$137.15
State School Levy	1.43728317636200	\$102,300	\$147.03
State School Levy Part 2	0.77100703019800	\$102,300	\$78.87
Yakima County	0.97798948507300	\$102,300	\$100.05
Yakima County Fire District 1	0.68986971054400	\$102,300	\$70.57
Yakima County Fire District 1 Bonds	0.19146681311600	\$102,300	\$19.59
Yakima County Road	1.30049520483300	\$102,300	\$133.04
Yakima Valley Regional Library	0.29320895483300	\$102,300	\$30.00



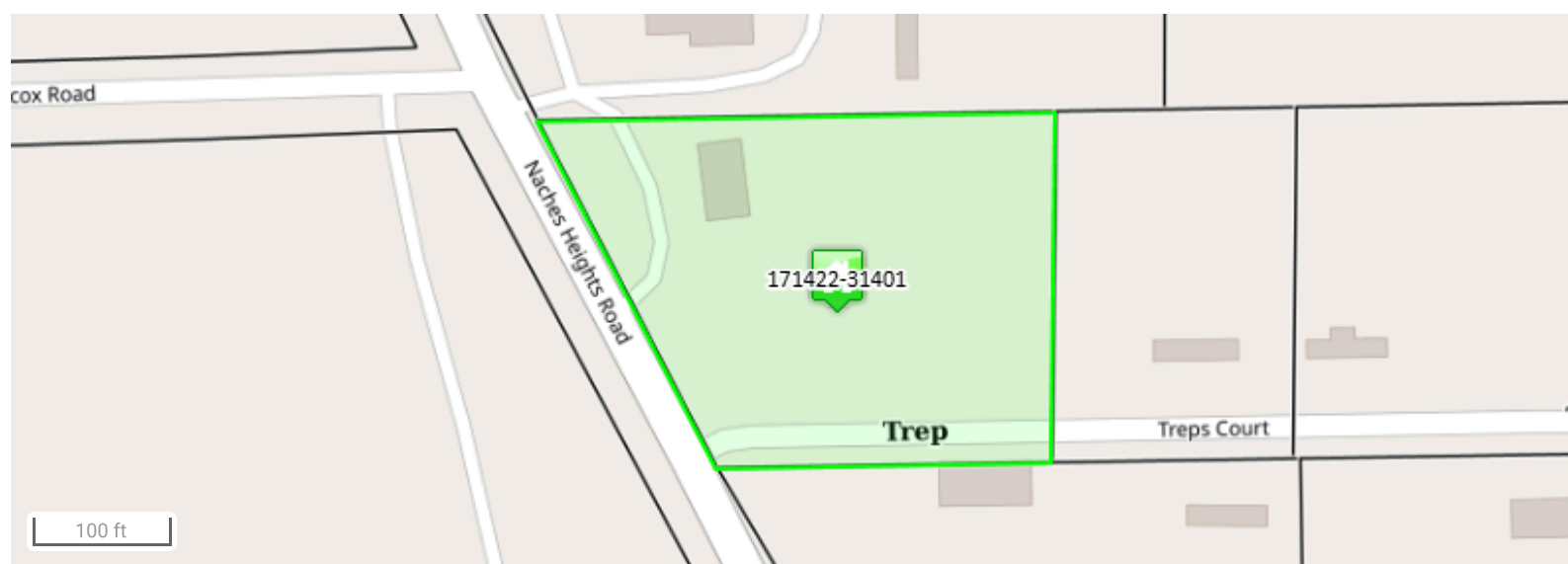

**8925 NACHES HEIGHTS RD , WA**





**8925 NACHES HEIGHTS RD , WA**

Residence 1

LM - Main Living

