



Yakima County WA, Property Record Card

Yakima County WA, Property Record Card

300000-06313
91 Trepanier Ct

Owners: Dave E Trepanier

Assessed Value
\$13,000

PROPERTY DETAILS

Parcel Number	300000-06313
Situs Address	91 Trepanier Ct
Property Use	11 Single Unit
Tax Code Area	502
Property Size	-
Neighborhood	483
Owners	Dave E Trepanier
Legal Description	1978 HILLCREST 60X12 SER# 02950506L
Fire District	Yakima County Fire District 1
School District	Highland School District #203
Total Bldg SQFT	672

UTILITY INFORMATION

No data to display

SITE INFORMATION

Property Type	Mobile-Home	Zoning	-	Street Type	Private
Street Finish	Gravel	Traffic	None	Side Walk	No
Curbs	No	Location		Road-Frntage	

LAND

DETAILS FOR LAND RECORD

Land Flag	-	Soil Class	-	Calc CU	-
Water Source	-	Sewer Source	-	Flood Plain	-
Lot Shape	-	Topography	-	Land View	-
Landscaping	-	Value Method	-	Lots	-
Square Feet	-	Acre(s)	-		

RESIDENTIAL

No data to display

COMMERCIAL

No data to display

DETACHED STRUCTURES

No data to display

AGRICULTURE

No data to display

EXCISE TRANSACTIONS

EXCISE #	GRANTOR NAME	EXCISE DATE	SALE PRICE	DOCUMENT TYPE	PORTION (Y/N)	PARCEL(S) SOLD
388780	Trepanier, Edward J	11/28/2006	\$0	Mobile Home Title Transfer	N	-

VALUES

VALUE TYPE	2025	2024	2023	2022	2021	2020	2019
Taxable Value Regular	\$13,000	\$11,400	\$9,600	\$9,300	\$9,100	\$8,800	\$8,000
Taxable Value Excess	\$13,000	\$11,400	\$9,600	\$9,300	\$9,100	\$8,800	\$8,000
Market Improvement	\$13,000	\$11,400	\$9,600	\$9,300	\$9,100	\$8,800	\$8,000

TAX BREAKDOWN

DISTRICT	TAX RATE	ASSESSED VALUE	TAX
County Ems	0.250000000000000	\$11,400	\$2.85
County Flood Control	0.05513604680100	\$11,400	\$0.63
Highland School	1.66239640772800	\$11,400	\$18.95
Highland School Bonds	0.000000000000000	\$11,400	\$0.00
Highland School Technology Improvement	1.34066986476700	\$11,400	\$15.28
State School Levy	1.43728317636200	\$11,400	\$16.39
State School Levy Part 2	0.77100703019800	\$11,400	\$8.79
Yakima County	0.97798948507300	\$11,400	\$11.15
Yakima County Fire District 1	0.68986971054400	\$11,400	\$7.86
Yakima County Fire District 1 Bonds	0.19146681311600	\$11,400	\$2.18
Yakima County Road	1.30049520483300	\$11,400	\$14.83
Yakima Valley Regional Library	0.29320895483300	\$11,400	\$3.34

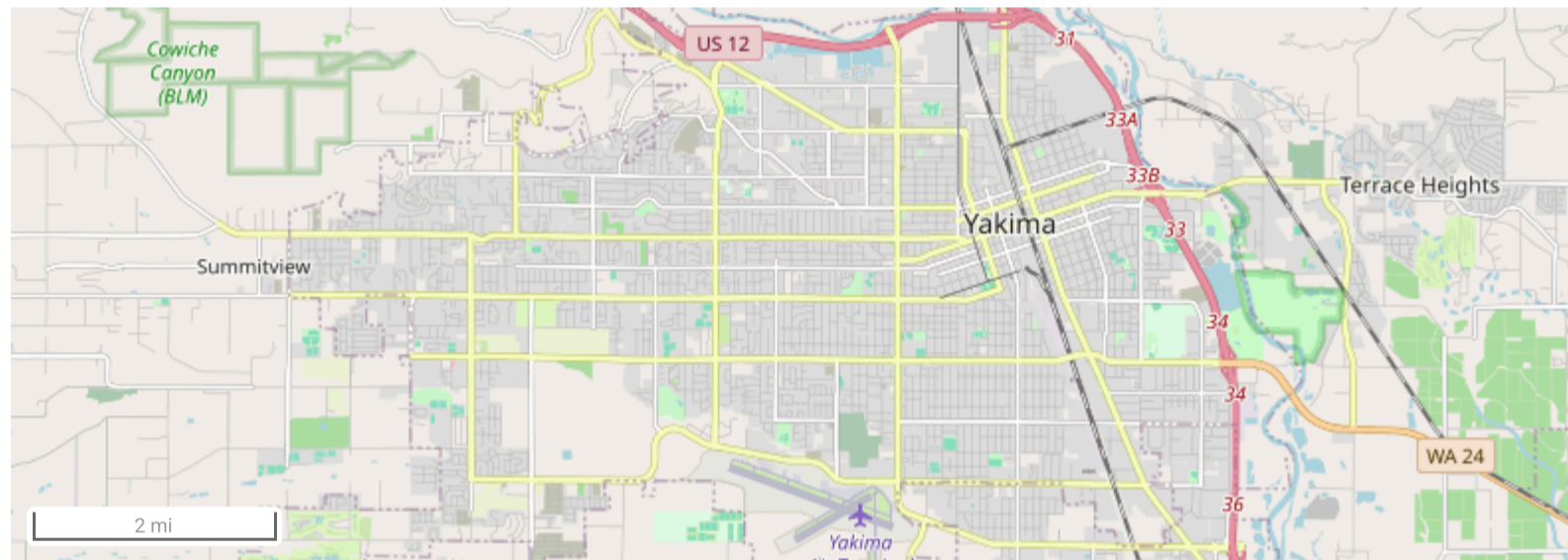



P.P. MH located on 171422-31403

OCT 19 2007



8925 NACHES HTS RD COWICHE, WA 98923



91 TREPANIER CT COWICHE, WA 98923

Mobile Home 1

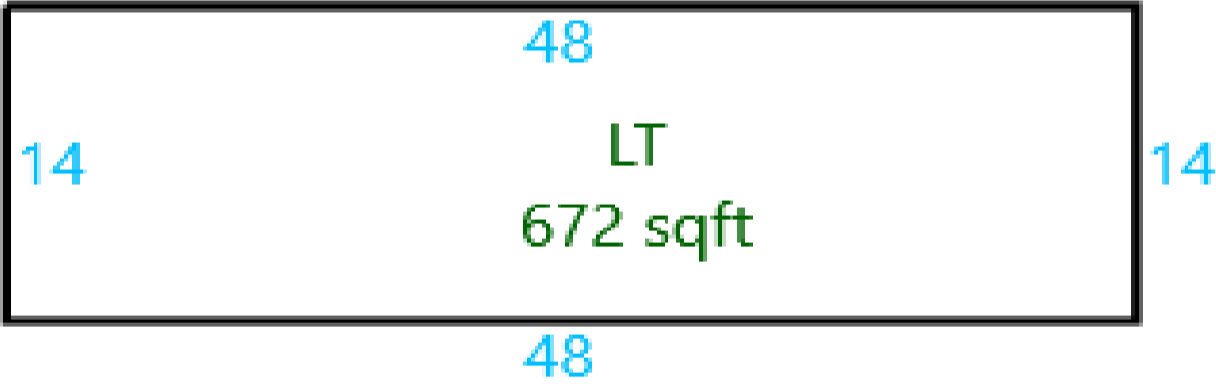

Data last updated: 04/07/2025