



Yakima County WA, Property Record Card

Yakima County WA, Property Record Card

171422-31405
100 Trepanier Ct

Owners: Dave E Trepanier

Assessed Value
\$66,500

PROPERTY DETAILS

Parcel Number	171422-31405
Situs Address	100 Trepanier Ct
Property Use	91 Undeveloped Land
Tax Code Area	502
Property Size	1.00
Neighborhood	483
Owners	Dave E Trepanier
Legal Description	SP 85-159 LOT 2
Fire District	Yakima County Fire District 1
School District	Highland School District #203
Total Bldg SQFT	-

UTILITY INFORMATION

Gas	No	Electricity	Yes	Water	Well
Sewer / Septic	Septic				

SITE INFORMATION

Property Type	Residential	Zoning	R10/5	Street Type	Private
Street Finish	Gravel	Traffic	Light	Side Walk	No
Curbs	No	Location	Road-Frntage		

LAND

DETAILS FOR LAND RECORD #1

Land Flag	Mdl	Soil Class	Prime	Calc CU	No
Water Source	Well	Sewer Source	Septic	Flood Plain	No
Lot Shape	Square	Topography	Level	Land View	No View
Landscaping	Minimal	Value Method	Acres	Lots	1
Square Feet	-	Acre(s)	1.000		

RESIDENTIAL

No data to display

COMMERCIAL

No data to display

DETACHED STRUCTURES

No data to display

AGRICULTURE

No data to display

EXCISE TRANSACTIONS

EXCISE #	GRANTOR NAME	EXCISE DATE	SALE PRICE	DOCUMENT TYPE	PORTION (Y/N)	PARCEL(S) SOLD
-	-	-	-	-	-	-

VALUES

VALUE TYPE	2025	2024	2023	2022	2021	2020	2019
Taxable Value Regular	\$66,500	\$60,500	\$55,200	\$54,000	\$50,100	\$41,300	\$41,300
Taxable Value Excess	\$66,500	\$60,500	\$55,200	\$54,000	\$50,100	\$41,300	\$41,300
Market Land	\$66,500	\$60,500	\$55,200	\$54,000	\$50,100	\$41,300	\$41,300

TAX BREAKDOWN

DISTRICT	TAX RATE	ASSESSED VALUE	TAX
County Ems	0.250000000000000	\$60,500	\$15.13
County Flood Control	0.05513604680100	\$60,500	\$3.34
Highland School	1.66239640772800	\$60,500	\$100.57
Highland School Bonds	0.000000000000000	\$60,500	\$0.00
Highland School Technology Improvement	1.34066986476700	\$60,500	\$81.11
State School Levy	1.43728317636200	\$60,500	\$86.96
State School Levy Part 2	0.77100703019800	\$60,500	\$46.65
Yakima County	0.97798948507300	\$60,500	\$59.17
Yakima County Fire District 1	0.68986971054400	\$60,500	\$41.74
Yakima County Fire District 1 Bonds	0.19146681311600	\$60,500	\$11.58
Yakima County Road	1.30049520483300	\$60,500	\$78.68
Yakima Valley Regional Library	0.29320895483300	\$60,500	\$17.74

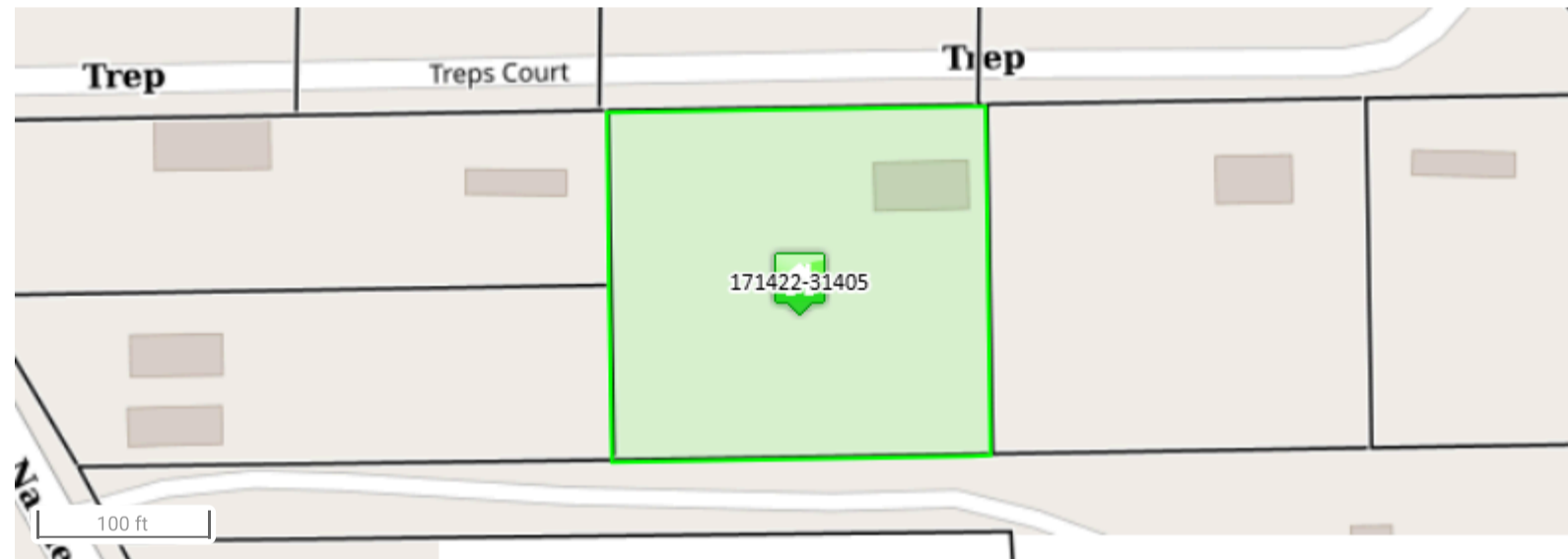



100 TREPANIER CT , WA





100 TREPANIER CT , WA



100 TREPANIER CT , WA

Data last updated: 03/16/2025