



Yakima County WA, Property Record Card

Yakima County WA, Property Record Card

300000-06681

Owners: Dave E Trepanier

Assessed Value

8851 Naches Heights Rd

\$16,400

PROPERTY DETAILS

Parcel Number	300000-06681
Situs Address	8851 Naches Heights Rd
Property Use	11 Single Unit
Tax Code Area	502
Property Size	-
Neighborhood	483
Owners	Dave E Trepanier
Legal Description	79 EMBASSY 60X14 SERIAL #8514
Fire District	Yakima County Fire District 1
School District	Highland School District #203
Total Bldg SQFT	840

UTILITY INFORMATION

No data to display

SITE INFORMATION

Property Type	Mobile-Home	Zoning	-	Street Type	Private
Street Finish	Gravel	Traffic	None	Side Walk	No
Curbs	No	Location		Road-Frntage	

LAND

DETAILS FOR LAND RECORD

Land Flag	-	Soil Class	-	Calc CU	-
Water Source	-	Sewer Source	-	Flood Plain	-
Lot Shape	-	Topography	-	Land View	-
Landscaping	-	Value Method	-	Lots	-
Square Feet	-	Acre(s)		-	

RESIDENTIAL

No data to display

COMMERCIAL

No data to display

DETACHED STRUCTURES

No data to display

AGRICULTURE

No data to display

EXCISE TRANSACTIONS

EXCISE #	GRANTOR NAME	EXCISE DATE	SALE PRICE	DOCUMENT TYPE	PORTION (Y/N)	PARCEL(S) SOLD
-	-	-	-	-	-	-

VALUES

VALUE TYPE	2025	2024	2023	2022	2021	2020	2019
Taxable Value Regular	\$16,400	\$14,300	\$12,000	\$11,700	\$11,400	\$11,100	\$10,100
Taxable Value Excess	\$16,400	\$14,300	\$12,000	\$11,700	\$11,400	\$11,100	\$10,100
Market Improvement	\$16,400	\$14,300	\$12,000	\$11,700	\$11,400	\$11,100	\$10,100

TAX BREAKDOWN

DISTRICT	TAX RATE	ASSESSED VALUE	TAX
County Ems	0.250000000000000	\$14,300	\$3.58
County Flood Control	0.05513604680100	\$14,300	\$0.79
Highland School	1.66239640772800	\$14,300	\$23.77
Highland School Bonds	0.000000000000000	\$14,300	\$0.00
Highland School Technology Improvement	1.34066986476700	\$14,300	\$19.17
State School Levy	1.43728317636200	\$14,300	\$20.55
State School Levy Part 2	0.77100703019800	\$14,300	\$11.03
Yakima County	0.97798948507300	\$14,300	\$13.99
Yakima County Fire District 1	0.68986971054400	\$14,300	\$9.87
Yakima County Fire District 1 Bonds	0.19146681311600	\$14,300	\$2.74
Yakima County Road	1.30049520483300	\$14,300	\$18.60
Yakima Valley Regional Library	0.29320895483300	\$14,300	\$4.19

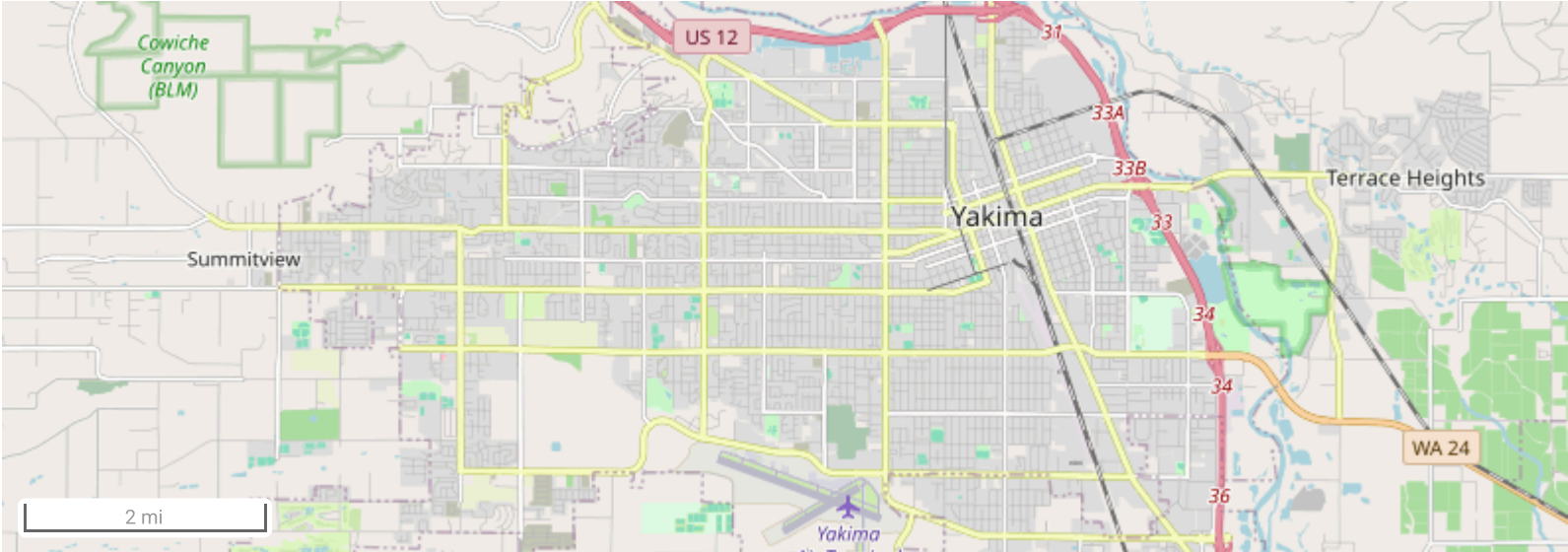



8851 NACHES HEIGHTS RD COWICHE, WA 98923-9755



8851 NACHES HEIGHTS RD COWICHE, WA 98923

Mobile Home 1

WD - Wood Deck

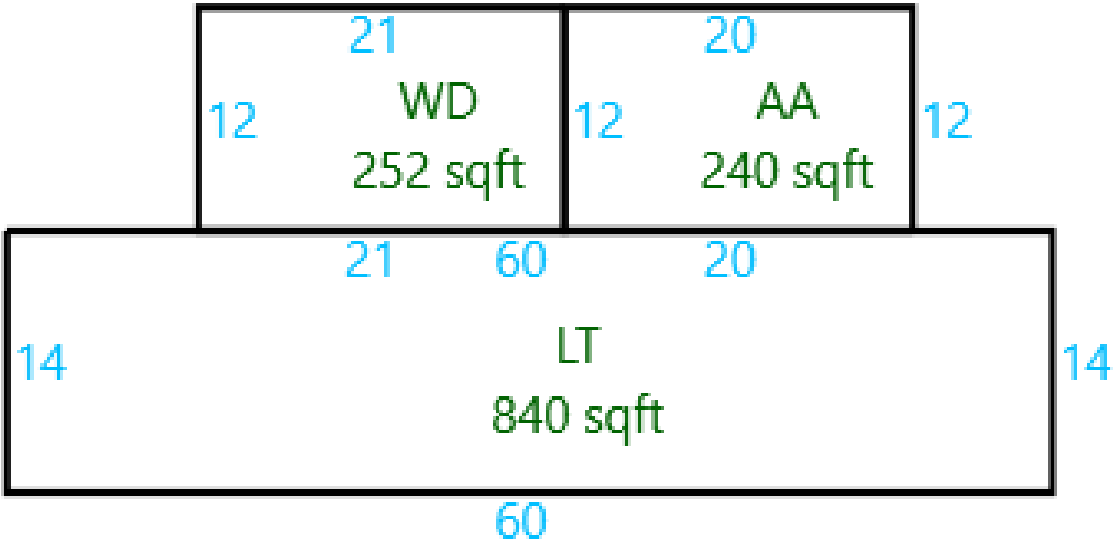

Data last updated: 04/06/2025