

**Summary**

Parcel ID 145-02-08-003-000  
 Account Number 9671  
 Property Address 5 HOUSES-DOUGLAS RD  
 Legal Description 5 HOUSES-DOUGLAS RD SW Plat: BJ - 205  
 (Note: Not to be used on legal documents.)  
 Acres/Lot 1.000  
 Land Use 6RN (6RN)  
 Millage Group 01 - County - Fairfield County  
 Neighborhood SW  
 Zoning R2 : Zone: R2



**Owners**

[EXECUTIVE REAL ESTATE LLC](#)  
 PO BOX 923208  
 NORCROSS GA 30010

**Valuation**

	2022	2021	2020	2019
Market Land Value	\$15,000	\$15,000	\$15,000	\$15,000
+ Market Improvement Value	\$63,300	\$63,300	\$63,300	\$63,300
+ Market Misc Value	\$0	\$0	\$0	\$0
= Total Market Value	\$78,300	\$78,300	\$78,300	\$78,300
- Ag Credit Value	\$0	\$0	\$0	\$0
= Total Taxable Value	\$78,300	\$78,300	\$78,300	*\$78,300
Capped Taxable Value	N/A	N/A	N/A	*\$78,300
= Total Assessed Value	\$4,698	\$4,698	\$4,698	\$4,698

\*This parcel is subject to the value cap

**Land Information**

Land Use	Number of Units	Unit Type	Land Type	Frontage	Depth	Notes
Res NonQ (6RN)	1.00	Lot	SITE	0	0	

**Buildings**

Card	1		Finished Area	820
Building Type	Single-Family		Total Area	946
Year Built	0		Primary Exterior Wall	Vinyl Siding
Effective Year Built	0		Primary Interior Wall	
Stories	1 STORY			

Card	2		Finished Area	614
Building Type	Unknown Building Type		Total Area	629
Year Built	0		Primary Exterior Wall	
Effective Year Built	0		Primary Interior Wall	
Stories	1 STORY			

Card	3		Finished Area	530
Building Type	Unknown Building Type		Total Area	602
Year Built	0		Primary Exterior Wall	
Effective Year Built	0		Primary Interior Wall	
Stories	1 STORY			

Card	4		Finished Area	892
Building Type	Unknown Building Type		Total Area	964
Year Built	0		Primary Exterior Wall	
Effective Year Built	0		Primary Interior Wall	
Stories	1 STORY			

Card 5  
Building Type Unknown Building Type  
Year Built 0  
Effective Year Built 0  
Stories 1 STORY

Finished Area 820  
Total Area 940  
Primary Exterior Wall  
Primary Interior Wall

### Sales

Sale Date	Sale Price	Instrument	Instrument Number	Deed Book	Deed Page
1/31/2019	\$170,000		2-44	1353	26
12/23/2005	\$5		Plat: BJ - 205	690	191
12/30/1985	\$18,650		BJ-205	IN	5

### Sales in Area

Sale date range:

From:

05/02/2020

To:

05/02/2023

Sales by Neighborhood

Sales by Parcel Group

1500

Feet



Sales by Distance

### Photos





Sketches

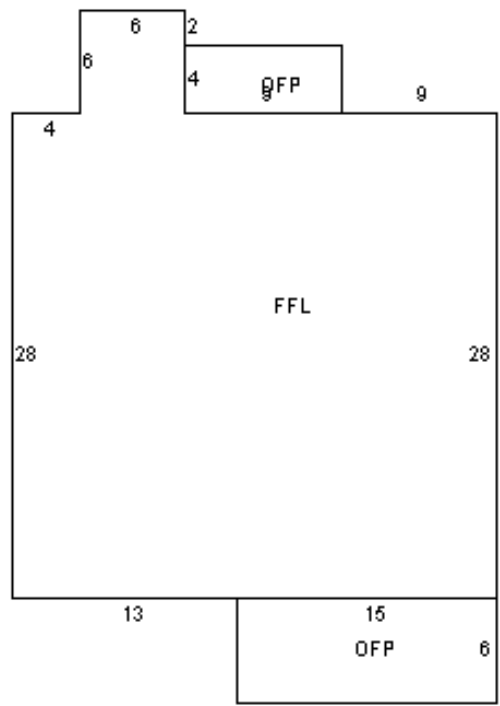

Sum Area By Label :  
 OFF = 126  
 FFL = 820

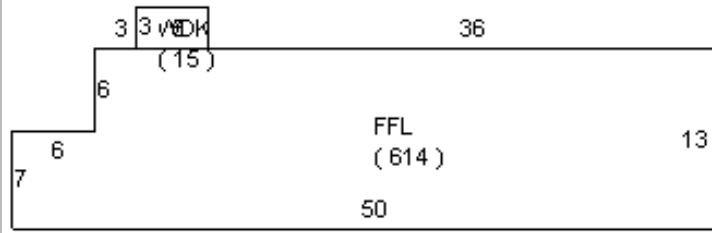

Sum Area By Label :  
 FFL = 614  
 WDK = 15

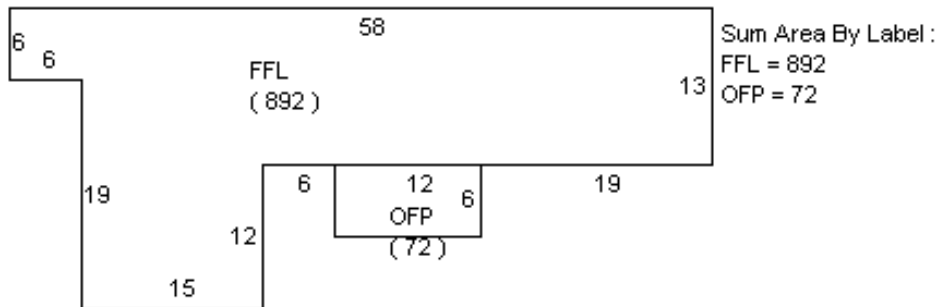
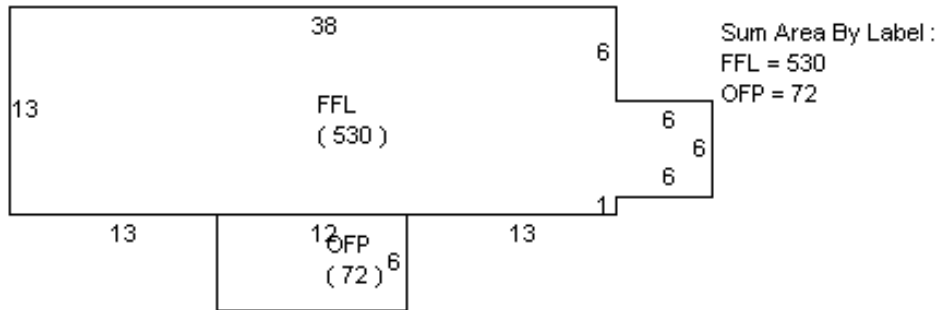

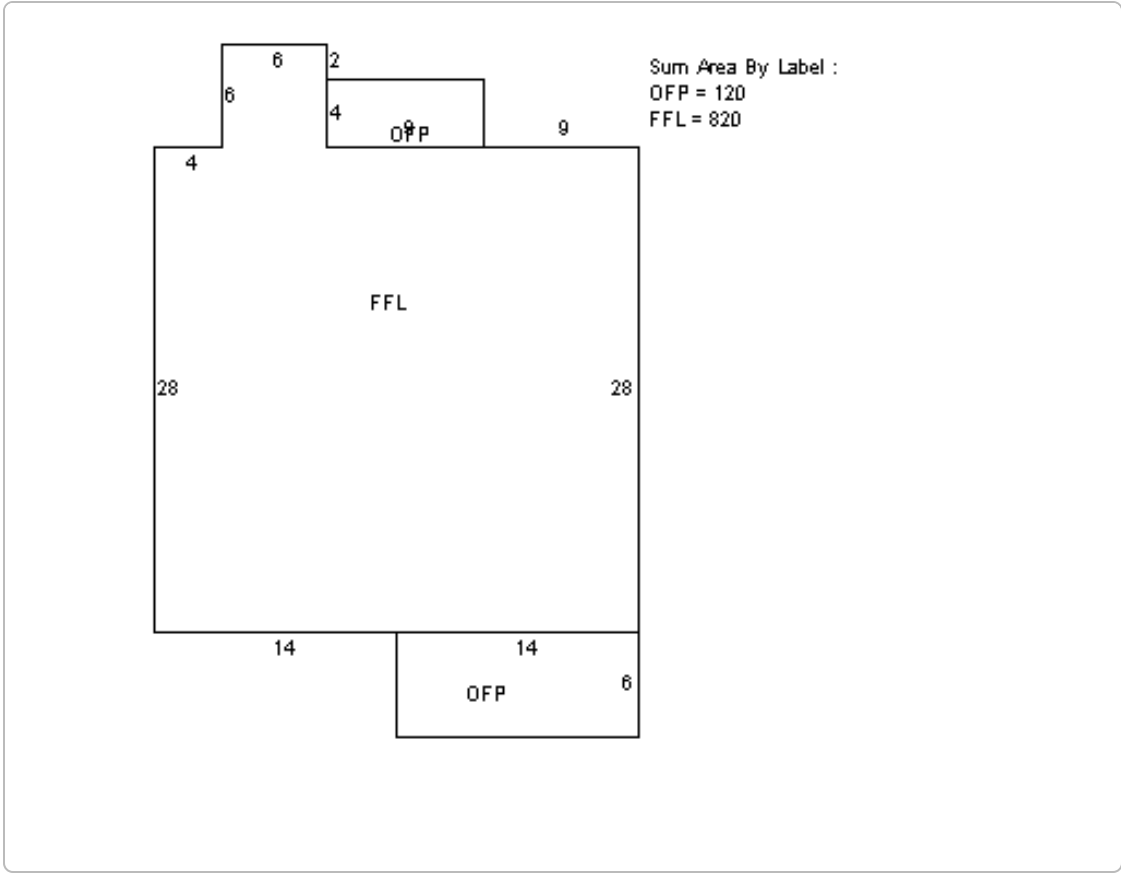

Fairfield County makes every effort to produce the most accurate information possible. No warranties, expressed or implied, are provided for the data herein, its use or interpretation. The assessment information is from the last certified taxroll. All data is subject to change before the next certified taxroll.

[User Privacy Policy](#)  
[GDPR Privacy Notice](#)

Developed by  
 Schneider  
 GEOSPATIAL

[Last Data Upload: 5/2/2023, 5:32:18 PM](#)

Version 3.1.6