

Property Database Search

Values posted are 2019 preliminary values in accordance with RSMo 137.243.1. Notices of Real Estate Assessment will be mailed to each property owner beginning in April. Final values will be certified by July 1, 2019

Please note: Information maintained by this office is for Assessment purposes only and should not be used to verify or transfer ownership. All maps maintained, provided and/or purchased are based on Assessment information and do not represent a legal survey of the parcels shown and shall not be used for conveyance or the establishment of property boundaries.

Property Details

Information is current as of 04/10/2019

Account Number: 011840A000

Parcel ID: 6-009D-B130-00-0003.0000000

Owner(s):

FIRST NATIONAL BANK OF ST
CHARLES
250 RIVERCHASE PKWY E STE 6
BIRMINGHAM, AL 35244-1832

Property Address: 423 1ST CAPITOL DR 63301

School District: St Charles

City: St. Charles

Fire District: St. Charles

Neighborhood Code: 5102

Subdivision:

Legal Description: PT CITY BLK 130

Lot Size: 1.4500 AC

Site Map (<http://map.sccmo.org/Main/index.html?config=property&account=011840A000>)

Building Data

Year Built: 1965

Property Type: IMPROVED COMMERCIAL (C)

Quality Code: C - Not used

Architectural Type:

Bedrooms: 0

Total Area: 4,446

Bathrooms: 0

Base Area: 4,446

Half Bathrooms: 0

Parking Area: 0

Total Rooms: 0

Basement Area: 0

Finished Basement Area: 0

Property Details

Information is current as of 04/10/2019

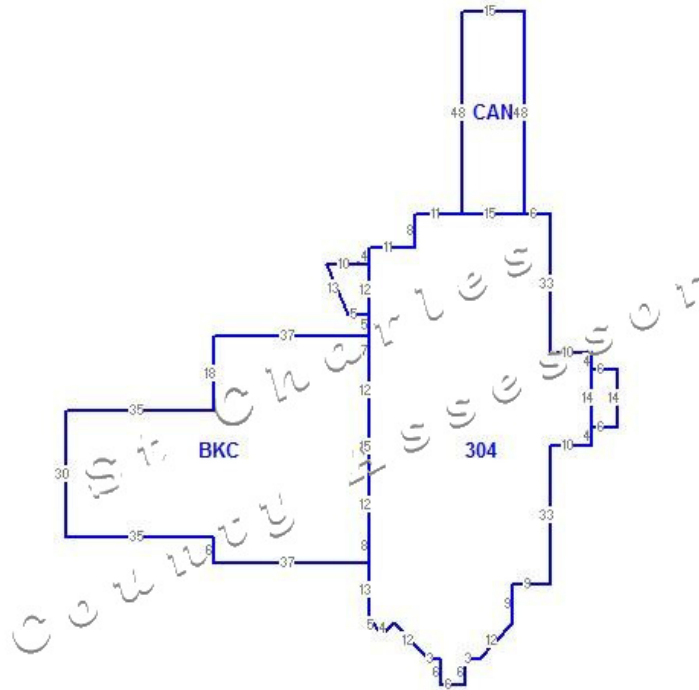

Legend:
 304: BANK
 BKC: BANK CANOPY DRV IN
 CAN: CANOPY ROOF SLAB
 SWP: SOLID WALL PORCH

(<https://lookups.sccmo.org/assessor/sketch/011840A000/1>)

Click to Enlarge (<https://lookups.sccmo.org/assessor/sketch/011840A000/1>)

Assessed Value

Commercial Value: \$339,366	Total Market Value: \$1,060,523
Residential Value: \$0	Land Value: \$1,042,173
Agriculture Value: \$0	

Sales History

Previous Owner(s)	Sale Date	Sale Price	Deed Book & Page	Qualified?
		Adj. Sale Price	U.P.S.F.	

Real Estate Tax Data

Property Tax Data (<http://mo-stcharles-collector.publicaccessnow.com/RealEstateSearch/AccountDetail.aspx?p=011840A000>)

Find Similar Properties

Search (https://lookups.sccmo.org/assessor/search?form_type=advanced&reset_session=true&searchCityCode=206&searchNbhdCode=5102)



Thursday, April 11, 2019

Welcome Contact Us FAQs SCCMO.ORG

Real Estate Search Account Detail

Login

Tax Account Information		
Account #/PIN	Property Type	Last Update
011840A000	Real Property	4/11/2019 2:42:36 AM
Mailing Address: FIRST NATIONAL BANK OF ST CHARLES 250 RIVERCHASE PKWY E STE 6 BIRMINGHAM, AL 35244-1832		SITUS: 423 1ST CAPITOL DR MO 35244-1832
Geo CD: 6-009D-B130-00-0003.0000000		Deed Number: INTERFACE
Legal Description		
PT CITY BLK 130		

Pay Online

Cart: \$0.00

Payment Options

NOTE: Payment for 2016 and prior years' Taxes
 Must be in the form of Cash, Cashier's Check, Money Order or Certified Funds if paid by mail or in person. Credit Card payments are also acceptable for 2016 and prior years' Taxes. Credit Card payments are only accepted online - not at the cashier windows.

No Payments accepted online the first three business days of the month... System needs to update for new penalties.

Tax Bills						
Tax Year	Net Tax	Total Paid	Penalty/Fees	Interest	Due Date	Amount Due
2018	\$19,865.45	\$19,865.45	\$0.00	\$0.00	12/31/2018	\$0.00
2017	\$19,611.58	\$19,611.58	\$0.00	\$0.00	12/31/2017	\$0.00
2016	\$19,521.48	\$19,521.48	\$0.00	\$0.00	12/31/2016	\$0.00
2015	\$19,488.40	\$19,488.40	\$0.00	\$0.00	12/31/2015	\$0.00
Total						\$0.00

Payment Information

Property Tax payment can be made online at this site. Payments made online will typically be posted by noon the following business day. Please note that a convenience fee does apply.

- E-check transactions are charged a flat fee of \$1.50 for payments up to \$60,000.00
- Credit card transactions are charged a fee of 35 cents plus 2.5% of the transaction

NOTE: Convenience fees are charged and retained by the payment processors

Pay By Check
 Please make checks payable to:
 Michelle D. McBride
 St. Charles County Collector

Mailing Address:
 201 N Second St
 Suite 134
 Saint Charles, MO 63301

Dropbox located at 201 North Second Street in Saint Charles

Office Hours:
 Monday – Friday
 8:00am to 5:00pm

The St. Charles County Collector's Office makes every effort to produce and publish the most current and accurate information. No warranties, expressed or implied, are provided for the data herein, or its interpretation. All information provided by this online resource is subject to verification by the St. Charles County Collector's Office.

Important Information

The information on this website is for informational purposes only. It is believed to be reliable, but we do not warrant its completeness, timeliness or accuracy. Please call toll free at 855-245-2906 if you require additional information about a particular account or if you have questions about the use of this site.



Thursday, April 11, 2019

[Welcome](#)
 [Contact Us](#)
 [FAQS](#)
 [SCCMO.ORG](#)

[Real Estate Search](#)
 [Account Detail](#)
 [Bill Detail](#)

[Login](#)

Tax Account Information		
Account #/PIN	Property Type	Status
011840A000	Real Property	Active
Mailing Address: FIRST NATIONAL BANK OF ST CHARLES 250 RIVERCHASE PKWY E STE 6 BIRMINGHAM, AL 35244-1832		SITUS: 423 1ST CAPITOL DR MO 35244-1832
Geo CD: 6-009D-B130-00-0003.0000000		Deed Number: INTERFACE
Legal Description		
PT CITY BLK 130		

Assessments								
Operation	Gross Tax	Credit	Net Tax	Savings				
<u>Ambulance</u>	\$682.04	\$0.00	\$682.04	\$0.00				
<u>City-06: St Charles</u>	\$2,387.38	\$0.00	\$2,387.38	\$0.00				
<u>College-St Charles</u>	\$531.37	\$0.00	\$531.37	\$0.00				
<u>County</u>	\$916.83	\$0.00	\$916.83	\$0.00				
<u>Library</u>	\$528.85	\$0.00	\$528.85	\$0.00				
<u>Sch-R6: St Charles</u>	\$13,412.71	\$0.00	\$13,412.71	\$0.00				
<u>State</u>	\$75.34	\$0.00	\$75.34	\$0.00				
Close								
This is a break down of the "State " funds...								
Authority	Assessed Value	Exemption	Taxable	Net Rate	Gross Tax	Credit	Net Tax	Savings
State	\$251,118.00	\$0.00	\$251,118.00	0.0003000000	\$75.34	\$0.00	\$75.34	\$0.00
Sur Tax			\$1,330.93	\$0.00	\$1,330.93		\$0.00	
Close								
This is a break down of the "Sur Tax " funds...								
Authority	Assessed Value	Exemption	Taxable	Net Rate	Gross Tax	Credit	Net Tax	Savings
Sur Tax	\$251,118.00	\$0.00	\$251,118.00	0.0053000000	\$1,330.93	\$0.00	\$1,330.93	\$0.00
		Sub Total	\$19,865.45	\$0.00	\$19,865.45		\$0.00	
		Total Tax	\$19,865.45	\$0.00	\$19,865.45		\$0.00	

Remaining Installment Balance								
Period	Bill Number	Due Date	Tax Year	Tax	Discount	Penalty/Fee	Interest	Total Due
INST 1	236927	12/31/2018	2018	\$0.00	\$0.00	\$0.00	\$0.00	\$0.00
Total Due:				\$0.00	\$0.00	\$0.00	\$0.00	\$0.00

Payment History					
Tax Year	Bill Number	Receipt Number	Amount Paid	Last Paid	Paid By
2018	236927	U18.51986	\$19,865.45	12/20/2018	CBRE CORP FACILITIES MGMT INC

The St. Charles County Collector's Office makes every effort to produce and publish the most current and accurate information. No warranties, expressed or implied, are provided for the data herein, or its interpretation. All information provided by this online resource is subject to verification by the St. Charles County Collector's Office.

Important Information

The information on this website is for informational purposes only. It is believed to be reliable, but we do not warrant its completeness, timeliness or accuracy. Please call toll free at 855-245-2906 if you require additional information about a particular account or if you have questions about the use of this site.

