

CERTIFICATE OF SURVEY AND ACCURACY

I, CARLTON L. HAWKINS, CERTIFY THAT THIS PLAT WAS DRAWN UNDER MY SUPERVISION FROM AN ACTUAL SURVEY MADE UNDER MY SUPERVISION; THAT THE BOUNDARIES NOT SURVEYED ARE CLEARLY INDICATED AS DRAWN FROM INFORMATION FOUND IN DEED BOOK 5002, PAGE 1364; THAT THE RATIO OF PRECISION AS CALCULATED IS 1:10,000+; THAT THIS PLAT WAS PREPARED IN ACCORDANCE WITH G. S. 47-30 AS AMENDED; THAT THIS SURVEY CREATES A SUBDIVISION WITHIN THE AREA OF A COUNTY OR MUNICIPALITY THAT HAS AN ORDINANCE THAT REGULATES PARCELS OF LAND.

WITNESS MY ORIGINAL SIGNATURE, REGISTRATION NUMBER AND SEAL THIS

19th DAY OF AUGUST, 2002.

Carlton L. Hawkins
PROFESSIONAL LAND SURVEYOR L-3201

CERTIFICATE OF OWNERSHIP AND DEDICATION

I (WE) CERTIFY THAT I AM (WE ARE) THE OWNER(S) OF THE PROPERTY SHOWN AND DESCRIBED HEREON, WHICH WAS CONVEYED TO ME (US) BY A DEED RECORDED IN BOOK 5002, PAGE 1364, AND THAT I (WE) HEREBY ACKNOWLEDGE THIS PLAT AND ALLOTMENT TO BE MY (OUR) FREE ACT AND DEED AND HEREBY ESTABLISH THE MINIMUM BUILDING LINES, AND DEDICATE TO PUBLIC USE AS STREETS, ALLEYS, CROSSWALKS, EASEMENTS, PARKS, AND OTHER SPACES FOREVER AS SHOWN OR INDICATED. FURTHER, I (WE) HEREBY DEDICATE ALL SANITARY SEWER, STORM SEWER AND WATER LINES TO THE TOWN OF GIBSONVILLE.

OWNER: [Signature] DATE: 9-4-02
OWNER: [Signature] DATE: 9-4-02

CURVE TABLE with columns: CURVE, CHORD DIRECTION, CHORD DISTANCE, RADIUS. Lists curves C1 through C25 with their respective measurements.

LINE TABLE with columns: LINE, DIRECTION, DISTANCE. Lists line L1 with direction N87°14'50"W and distance 5.84'.

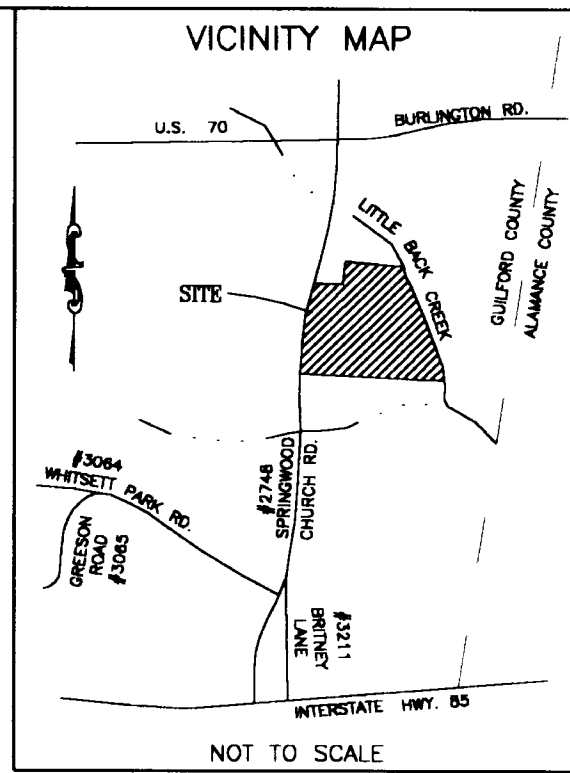

11/21/2002 GUILFORD CO., NC 640764 421.00
LEGEND: CALCULATED POINT X
IRON STAKE •
ALL IRON STAKES ARE SET UNLESS OTHERWISE NOTED.
NO GEODETIC HORIZONTAL CONTROL MONUMENT FOUND WITHIN 2000' OF SUBJECT PROPERTY.

CERTIFICATE OF APPROVAL FOR RECORDING

I HEREBY CERTIFY THAT THE SUBDIVISION PLAT HEREON HAS BEEN FOUND TO COMPLY WITH THE SUBDIVISION REGULATIONS FOR GIBSONVILLE, N.C., AND THAT THIS PLAT HAS BEEN APPROVED BY THE GIBSONVILLE BOARD OF ALDERMAN FOR RECORDING IN THE OFFICE OF THE REGISTER OF DEEDS OF GUILFORD COUNTY. I FURTHER CERTIFY THAT THE GIBSONVILLE BOARD OF ALDERMAN ACCEPTS THE DEDICATION OF STREETS, EASEMENTS, RIGHT-OF-WAY, SEWER, AND WATER LINES AND PUBLIC PARKS SHOWN HEREON, BUT ASSUMES NO RESPONSIBILITY TO OPEN OR MAINTAIN THE SAME UNTIL, IN THE OPINION OF THE GIBSONVILLE BOARD OF ALDERMAN, IT IS IN THE PUBLIC INTEREST TO DO SO.

Planning Board Chairman: [Signature] DATE: 11-18-02
Mayor of Gibsonville: [Signature] DATE: 11-18-02
Town Clerk: [Signature] DATE: 11-18-02

STATE OF NORTH CAROLINA COUNTY OF GUILFORD

REVIEW OFFICER OF GUILFORD COUNTY, CERTIFY THAT THE MAP OR PLAT TO WHICH THIS CERTIFICATION IS AFFIXED MEETS ALL STATUTORY REQUIREMENTS FOR RECORDING.

[Signature] REVIEW OFFICER
DATE: 11/18/02

CERTIFICATE OF ACKNOWLEDGEMENT OF NOTARY PUBLIC BY COUNTY REGISTER OF DEEDS

NORTH CAROLINA - GUILFORD
The foregoing certificate(s) of
A Notary Public of said county is (are) certified to be correct
This KATHERINE LEE PAYNE, Register of Deeds
Deputy, Register of Deeds

TOTAL AREA OF PHASE TWO: 16.291 ACRES
AREA IN STREET R/W: 2.756 ACRES
AREA IN LOTS: 13.535 ACRES
41 LOTS IN PHASE TWO

THIS SUBDIVISION IS A PORTION OF LOT 2, MICHELE RENEE INGLE TYNDALL PROPERTY AS RECORDED IN P.B. 128 PG. 89.

OWNER & DEVELOPER :
ALAMANCE PARTNERS, LLC
200 W. MAIN STREET
GIBSONVILLE, N. C.
TELE. (336) 449-1144
DEED BOOK 5002 PAGE 1364

CERTIFICATE OF APPROVAL OF THE DESIGN AND INSTALLATION OF STREET, UTILITIES AND OTHER REQUIRED IMPROVEMENTS

I HEREBY CERTIFY THAT ALL STREETS, UTILITIES, AND OTHER REQUIRED IMPROVEMENTS HAVE BEEN INSTALLED IN AN ACCEPTABLE MANNER AND ACCORDING TO THE TOWN OF GIBSONVILLE SPECIFICATIONS AND STANDARDS IN THE PHASE ONE, CARSON FARMS SUBDIVISION OR THAT GUARANTEES OF THE INSTALLATION OF THE REQUIRED IMPROVEMENTS IN AN AMOUNT AND MANNER SATISFACTORY TO THE TOWN OF GIBSONVILLE HAS BEEN RECEIVED, AND THAT THE FILING FEE FOR THIS PLAT, IN THE AMOUNT OF \$ [] HAS BEEN PAID.

DATE: Nov. 20 '02 TOWN ADMINISTRATOR: [Signature]

640764
RECORDED
KATHERINE LEE PAYNE
REGISTER OF DEEDS
NOV 21 2002 15:15:39
BOOK 148 PAGE 103

FINAL PLAT
PHASE TWO
CARSON FARMS EAST
TOWN OF GIBSONVILLE
ROCK CREEK TOWNSHIP, GUILFORD COUNTY, N. C.

SCALE: 1"=100' AUGUST 19, 2002

ALLEY, WILLIAMS, CARMEN & KING, INC. ENGINEERS & ARCHITECTS
740 CHAPEL HILL ROAD TELEPHONE: (336) 228-5534
BURLINGTON, N. C. 27216 JOB NO. 99024fp2